

Explanation of Numbers in the Map below

- No 1 Kerr-Brunner's Survey - No. 2 Names of Mrs. Berryman  
 " 3 J. D. Tucker = " 4 Thos C. Warner  
 " 5 R. P. Brown - Pat. Comp. = " 6 B. B. B. & C. R. R. Co.  
 " 7 R. J. Wilson " " = " 8 Sand. Johnson. Pat. E. not returned.  
 " 9 Jas. G. Wood " " = " 10 B. B. B. & C. R. R. Co. Patented  
 " 11 B. B. B. & C. R. R. Co. = " 12 J. Greenwood, Pat. Exemption  
 13 A. C. Outter Pat. Exemption - Mrs. Nancy Singleton  
 15 Sand. Wilson " " = 16 R. J. Wilson " "  
 17 Ann C. Smith " " = 18 A. H. Gates

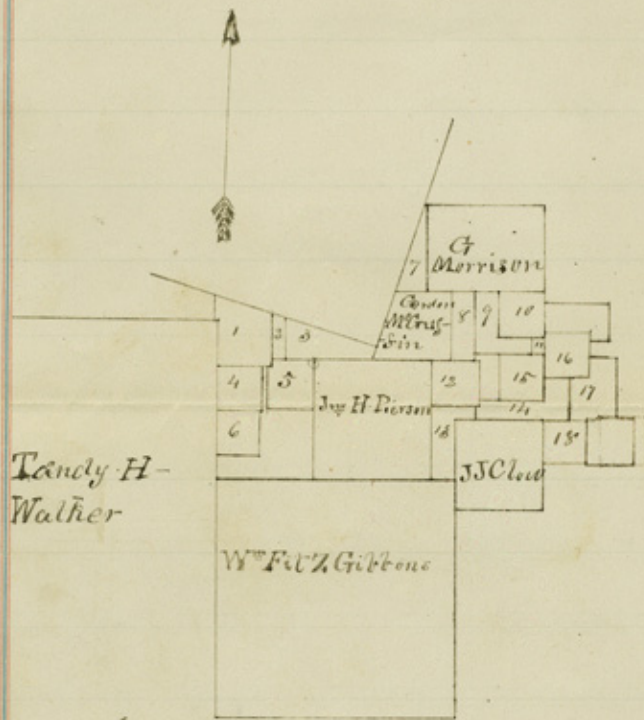

The State of Texas  
 County of Grimes

I Rufus Grimes County Surveyor of Grimes County do hereby certify that the above sketch is a correct representation of the relative position on the ground of certain Surveys in Grimes County - that I find from actual Survey that the John A. Person Survey of Ch. Labors begins on Wm. Fitz Gibbons North boundary 389<sup>1</sup>/<sub>2</sub> - 303 varas from his (Fitz Gibbons) N.E. corner - that in former Maps of Grimes County said Person Survey is represented as beginning at Fitz Gibbons N.E. corner - that the distance by actual measurement from said J. A. Person's North West corner to Kerr Brunner's -

