

Swisher County.

North Hole, & South Swisher
 Sketch showing sure in
 M. J. Williams' 19

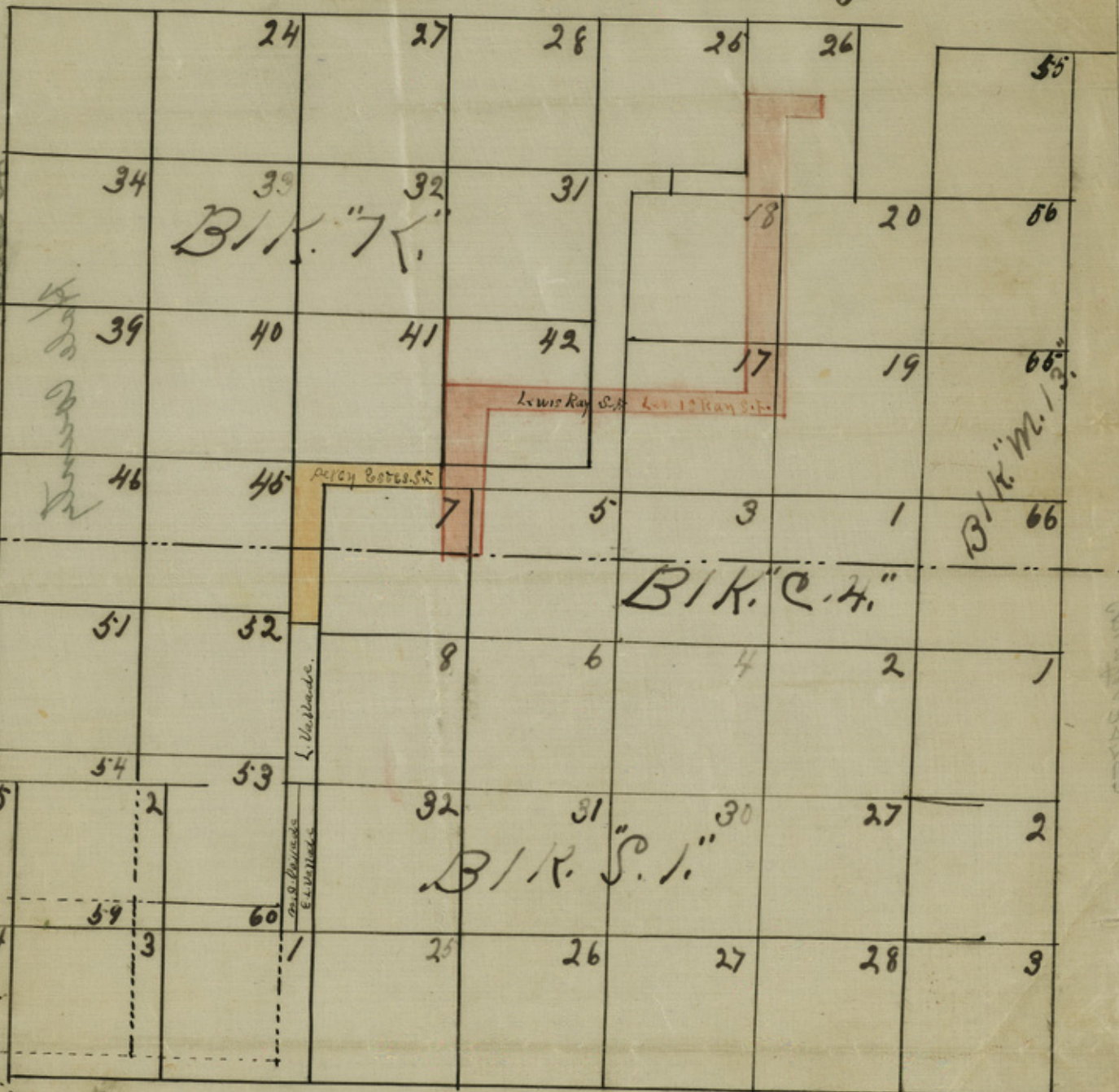

Hale Co. N. part. W. J. Williams. Co. Sm. Counter 24751

W.J. Williams, 19.
 Sketch showing Surs. in
 North Hole, & South Swisher
 No dates.

Hale County



Swisher County

Horse Co.

N. Base

M. J. Williams & Co. Surveyors

Counter 24752