

China Row

						376	365														
						377	364														
						393	378	263	348	333											
	454		422			392	379	262	349	332	303	298	275	264	239	232	203	200			
470	453	440	421	410		391	380	361	350	331	314	287	276	263	240	231	204	199	172	171	
471	452	441	420	411		390	381	366	351	330	315	286	277	262	241	230	206	198	173	170	
472	451	442	419	412		389	382	359	35	329	316	295	278	261	242	229	206	197	174	169	
473	450	443	418	413		388	383	358	353	328	317	294	279	260	243	228	207		175	168	
474	449	444	417	414		387	384	357	354			280									
475	448	445	416	415		386	385	356	355												
476	447	446																			
477																					
479																					
	BB	B + CRIL																			

Grossbeck Creek

A.A. Jones
GF
Bridges
Hall

BB B + CRIL

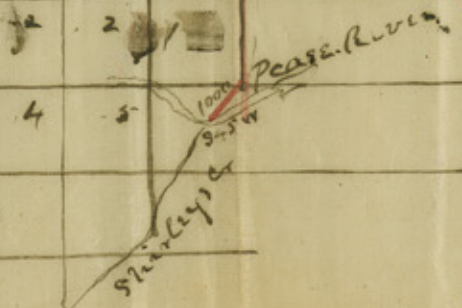

HARDENMAN CO
SKETCH FILE 7

The State of Texas
Wilbarger Co. Dist. } Plat & Field
notes of a Connecting line
in Hardemon County - Texas.

Beginning at the S.E. cor.
of Sur. No 173. Block "H" of N +
N.W. R.R. Co. from which 2. Hack
by. brs S. 81 E. Thence West at
4500 vs cross Groves Creek
at 1900 vs a rock mound -
Thence West 5 miles stake &
mound. Thence N 45 W. 2586 vs
the N.W. cor. of Sur No 296. Block H,
from which a Hack by. br S 16 1/2 W
34 vs a Chittam br S 26 W. 23. vs.
Thence West 1 mile a dirt mound
Thence West 1220 vs cross branch
(C. N. E.) at 2400 vs cross branch
(C. N.) at 3500 cross branch (C. N.)
at 3800 vs a bone pile from which
a bunch Hack by. br East 1500 vs.
Thence West 700 vs cross branch
at 1100 vs cross branch at 1800
vs cross branch at 2400 vs a
point 300 vs south of branch
(C. N. E.). Thence South 300 vs to
a pile of rock from which a
Cave br N. 31 E. 20 vs. at 200 vs. N
51 E. I found remains of a Hack
counter 24998

(D. N. E.)

berry but no marks.

Thence West 4200 vs cross branch
at 3500 cross Camel Creek. at 3700
vs stake + md. The S.W. cor Sur 410
+ S.E. cor 421. Thence S 45 W 2680
vs a stake + md. Thence South
at 3940 vs cross creek course 92. at
4 miles the N.E. cor 446. a fence
mound on South side rocky hill.

Thence South 2400 vs cross branch
at 1350 vs cross branch. at 3920
vs cross branch. at 5280 vs cross
branch. Continue South crossing
Cedar brakes + many deep ra-
vines at 9800 vs a pile rock
on N.B. Pease river from which
a double Cot on opposite side
river on S 80 E - about 2000 vs.
a Cot S. 84 E - about 2200 vs.

Thence S. 45 W 1200 vs a point
on N.B. Pease river, opposite
mouth of Shurleys (Cat Fish)
creek.

Surveyed May 14 to 18th 1884
Bearings Mkd & { F.C. Ratcliff } Chain
Variation 9° 45' E. } R.P. Elliott } Mon

I W. Westmoreland Sur.
Wilbarger Land District do here-
by certify that the foregoing Sur.

ry was actually made on the
ground by me according to
law on the date and with
the Chairman above mentioned
duly qualified and that all
the corners, boundaries, lines
and marks of the same are
true and correctly described
in the foregoing Plat and
Field notes and same are
recorded in Book C. pag 400
& 401. H. J. Westmoreland Sur
Willoughby Land Dist

114

7
Hardeman Co,
Sketch file

WJ Westmorelands con-
necting line & sketch,
Filed June 27, 1884-

Hardeman Co

Filed

June 27/84.

D N Robinson
Chf Clk

Connecting line
and sketch.

county 25001