

2604

Marlin, Texas, October 28, 1907.

Hon. John J. Terrell,  
Commissioner,  
Austin, Texas.

Dear Sir:--

I hand you herewith my report of resurvey of the James Adams survey on Cypress Bayou and Caddo Lake, Harrison County, Texas.

Mr. Behn Cook, County Surveyor of Harrison County, and Mr. Oscar Hope, who has lived within three miles of the Adams survey for the last fifty eight years, were with me and assisted me in making the survey. They both told me that prior to the year 1872 water stood on most all of land between the lines as we run them, and the lake; and that they had both gone in a boat to the corner where the Adams survey call for leaving the lake, and both of the sweet gum trees were there as called for. Mr. Cook and Mr. Hope both expect to be the trial as witnesses for the state.

Yours truly,

R. S. Hummick  
State Surveyor.

14

Report of R.S. Hunnicutt.

James Adams Survey

Harrison County

Filed Oct. 30 1907.

counters 26054

FILE WITH  
HARRISON COSK. FL. 14.

This Report and ac-  
companying sketch,  
signed by R. S. Humicut,  
State Surveyor received  
and filed this 30<sup>th</sup> day  
of October 1907.

John J. Turrell  
Commissioner  
Gen. Land Office.

Counter 26055

23

Marlin, Texas, October 28, 1907.

Hon. John J. Terrell,  
Com. General Land Office,  
Austin, Texas.

Dear Sir:--

In obedience to your instructions of October 10th, 1907, directing me to go to Harrison County, Texas, and resurvey the James Adams survey, and if possible to find the original lines of the same, and the present relative position of the boundary to the edge of the waters of Ferry and Caddo Lakes, I went to the S. W. corner of the James Adams survey (which was shown to me by Mr. Behn Cook, County surveyor of Harrison County, and Mr. Oscar Hope) from which a large pine stump bears S. 45 E. 3 vrs; found no sign of the other bearing tree called for at this corner:

Thence N. 63 E. with a fresh marked line 840 vs. to corner:

Thence N. 16 E. with fresh marked line 950 vrs. to corner:

Thence N. 24 E. with fresh marked line 750 vs. to corner on the East bank of Pine Island Slough.

All three of these lines had very old marks where the timber was old enough to hold them:

Thence N. 17 W. with fresh marked line 900 vs. to a corner;

Thence N. 23 1/2 E. 160 vs. to the East bank of Big Cypress Bayou or Ferry Lake; this line continued would cross the Bayou at this point and continue to get further from it. I did not find any old marks on either of the two last lines. I went back to the end of the third line which is on the East bank of Pine Island Slough;

Thence N. 17 E. (instead of N. 17 W.) at about 40 vs. entered the slough- at 300 vs. the East bank of the slough is 100 vs. to the right- at 550 vs. passed out of the slough, and at 900 vs. a point in the East side of the slough:

The 5th. line in the Adams field notes, or N. 23 1/2 E. 1380 vs. from this point would cross the said slough and Cypress Bayou above where they go together, and would stay west of the Bayou the

J. J. T. - 2 -

entire distance. I returned to the S. W. corner the Adams survey;

Thence S. 65 E. with a very old marked line 3790 vs. to the S. E. corner of Adams survey which is about 10 vs. West of a large black jack tree marked "O H":

Thence with an old marked line N. 65 E. 836 vs. to a corner in the edge of the low land: (The Adams' field notes call for two sweet gum trees at this corner; both are gone.)

Thence N. 60 W. with an old marked line 920 vs. to a corner;

Thence N. 58 W. with fresh marked line and a few old marks 410 vs. to a corner;

Thence N. 23 E. with fresh marked line 1160 vs. to a corner:

Thence N. 33 E. with new marked line and a few old marks 1310 vs. to a stake for corner.

Thence N. 9 1/2 E. with fresh marked line 516 vs. to corner:

Thence S. 23 E. with a fresh marked line 920 vs. to a corner; (About 15 vs. to the West and parallel with this line there is an old marked line.)

Thence S. 74 E. with a new line 960 vs. to a stake in the South West bank of Caddo Lake:

Thence N. 41 W. with a very old and well marked line 2135 vs. to a corner;

Thence N. 47 W. with a new line and some old mark 415 vs. to a corner;

Thence N. 26 E. with new line 400 vs. to a corner;

Thence N. 31 W. with new line and a few old marks 982 vs. to a corner:

Thence N. 25 W. with new line 950 vs. a corner in a small Lake;

Thence West 590 vs. (instead of 880 vs) to the east bank of Cypress Bayou.

All of the above lines (except the 13th. in the Adams' field notes S. 74 W. 960 vs.) which the Adams survey call for "running with waters of the lake" are on high ground, near the dividing line

J. J. T. - 3 -

between high ground and the low land, and in my opinion are the lines that were originally run for the James Adams survey.

I have prepared a map attached hereto and made a part of this which shows the lines as I surveyed them and their relative position to high and low land and to Caddo Lake.

Yours truly,

*R. S. Hummick*

State Surveyor.

①  
Tracing from S.K. on orig. p. n. by surveyor July '38

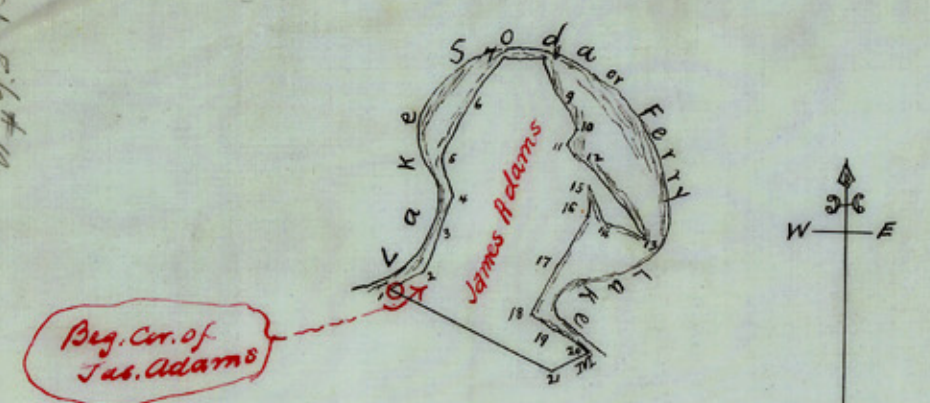

The above used was copied or traced from the sketch on the original field notes by Surveyor Samuel J. Taylor (1844) Surveyor for the County of Shelby, Ark. This refers to the Jas. Adams survey of 15,118.5710 ac. in Harrison Co. (See Shelby T. Co. 176-177)

The beginning corner is identified and the course follows practically the original course: Beginning at the NE cor of a survey made for Obediah Hendrick, which survey includes Baylors Bluff on Lake Sada or Ferry Lake, a stake from which a pine 22" dia. has N 35° E 200' dist. & a pine 20" in dia. S 45° E 300' dist. both marked S.A. These running with the waters of the lake

1. N 63 E 820	no	15. 59° 27' N 516	no
2. N 16 E 950	"	16. 53° 34' N 1310	"
3. N 24 E 750	"	17. 52° 34' N 1160	"
4. N 17 W 900	"	18. 55° 38' E 410	"
5. N 23 W 1380	"	19. 56° 0' E 920	"
6. N 35 E 1130	"		
7. E 880	"		
8. S 25 E 950	"		
9. S 31 E 782	"		
10. S 36 W 400	"		
11. S 47 E 415	"		
12. S 41 E 235	"		
13. N 74 W 960	"		
14. N 23 W 920	"		

② These 15 sec. in a conditional line midline 22 5/8 in. distance from original corner at 83' in a S.W. from which a stake is 17' 5/8 in. distance from original corner to the beginning corner. Surveyed 17 July 1832. 36

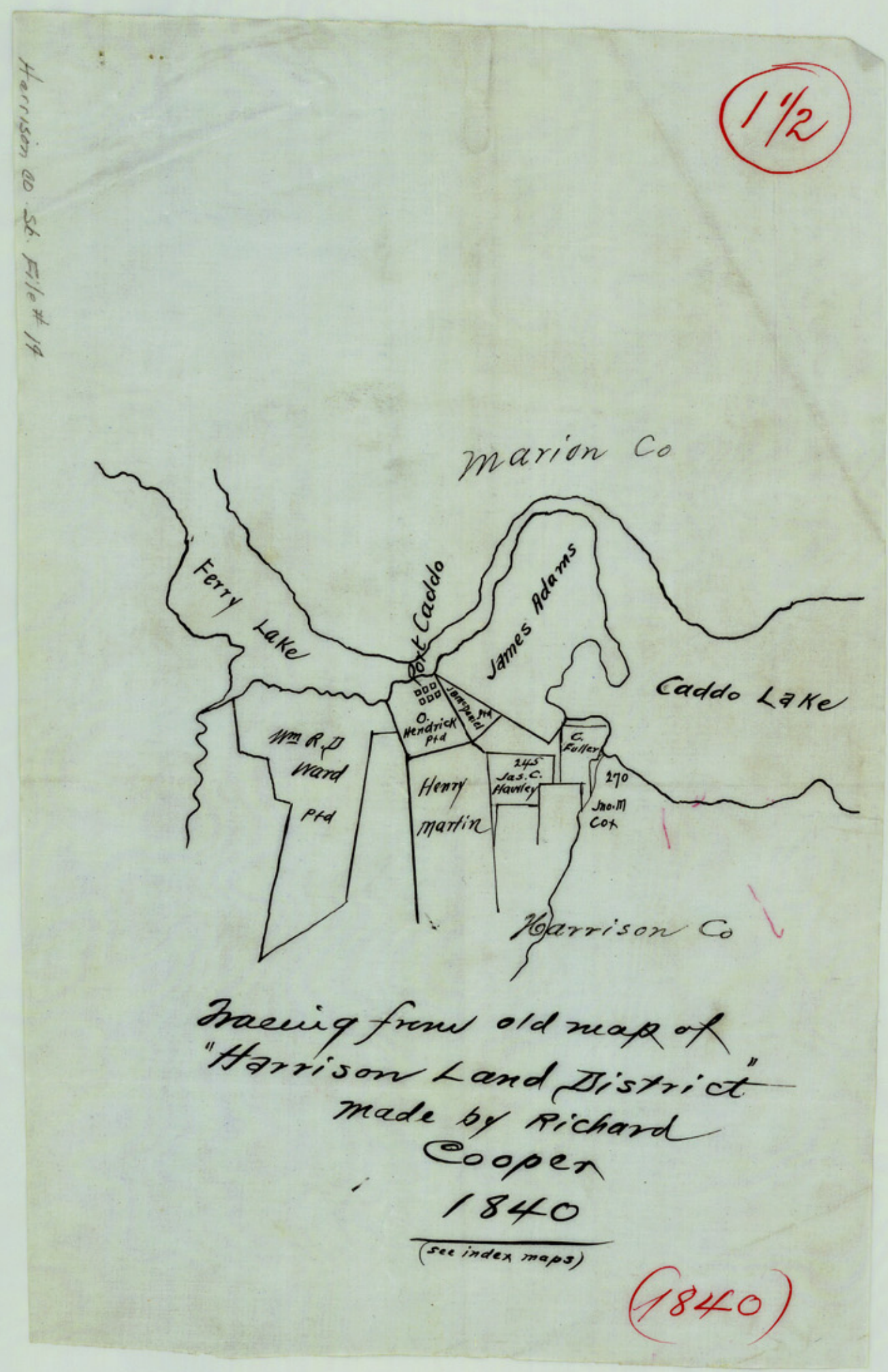

Tracing from old map of Harrison Land District made by Richard Cooper 1840 (see index maps) (1840)

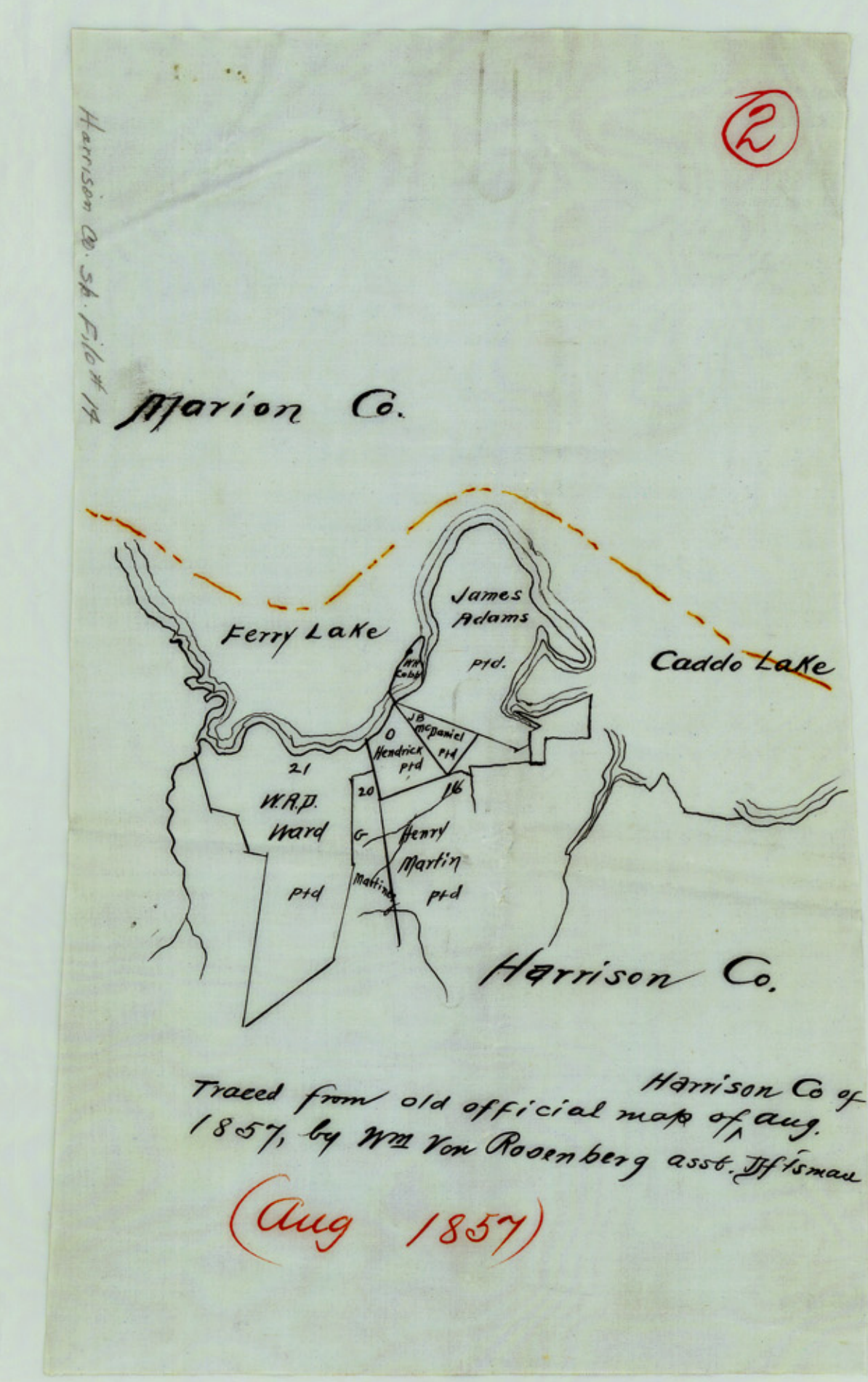
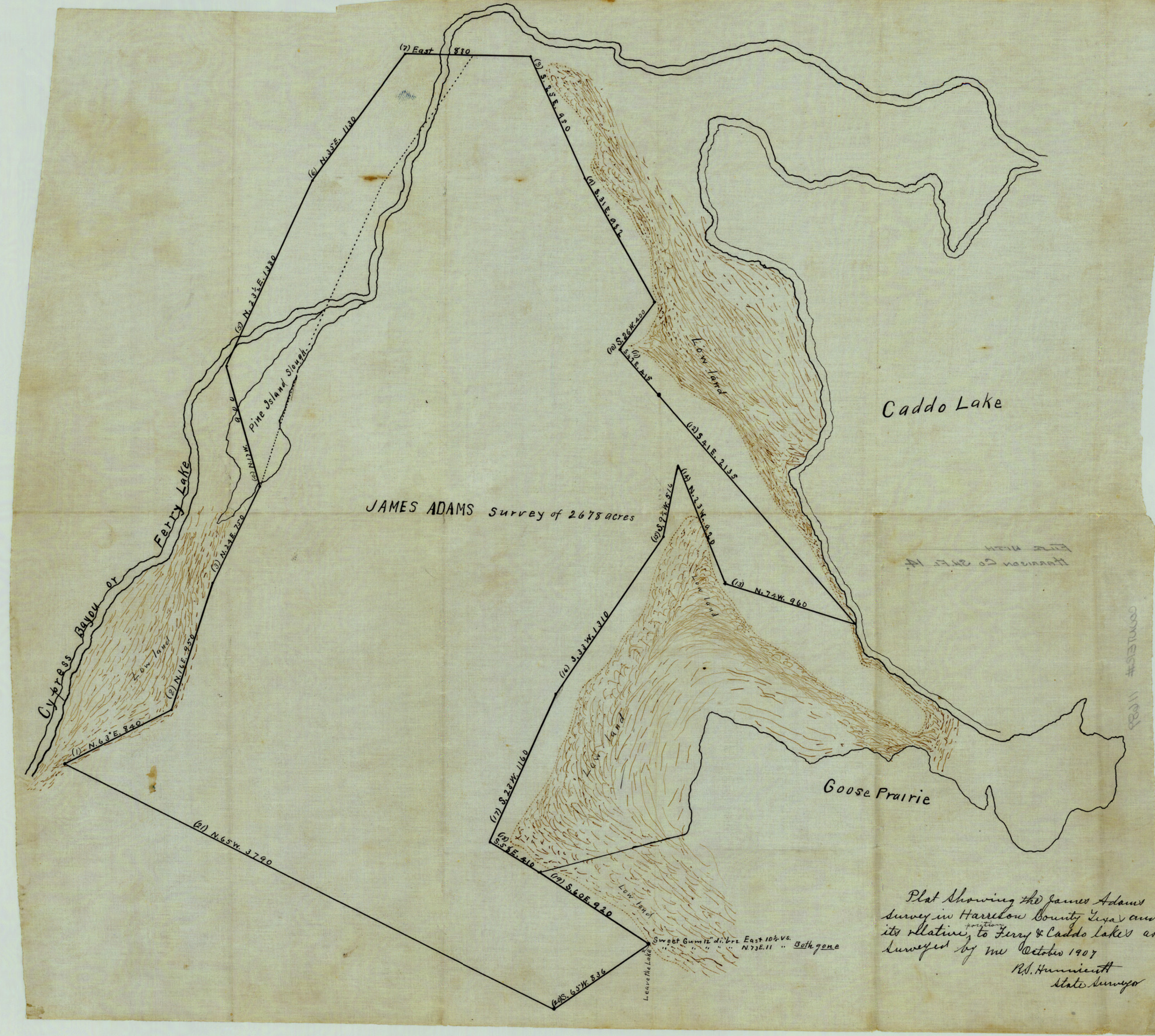

Traced from old official map of Aug. 1857, by Wm. Von Rothenberg asst. J. H. Suman (Aug 1857)

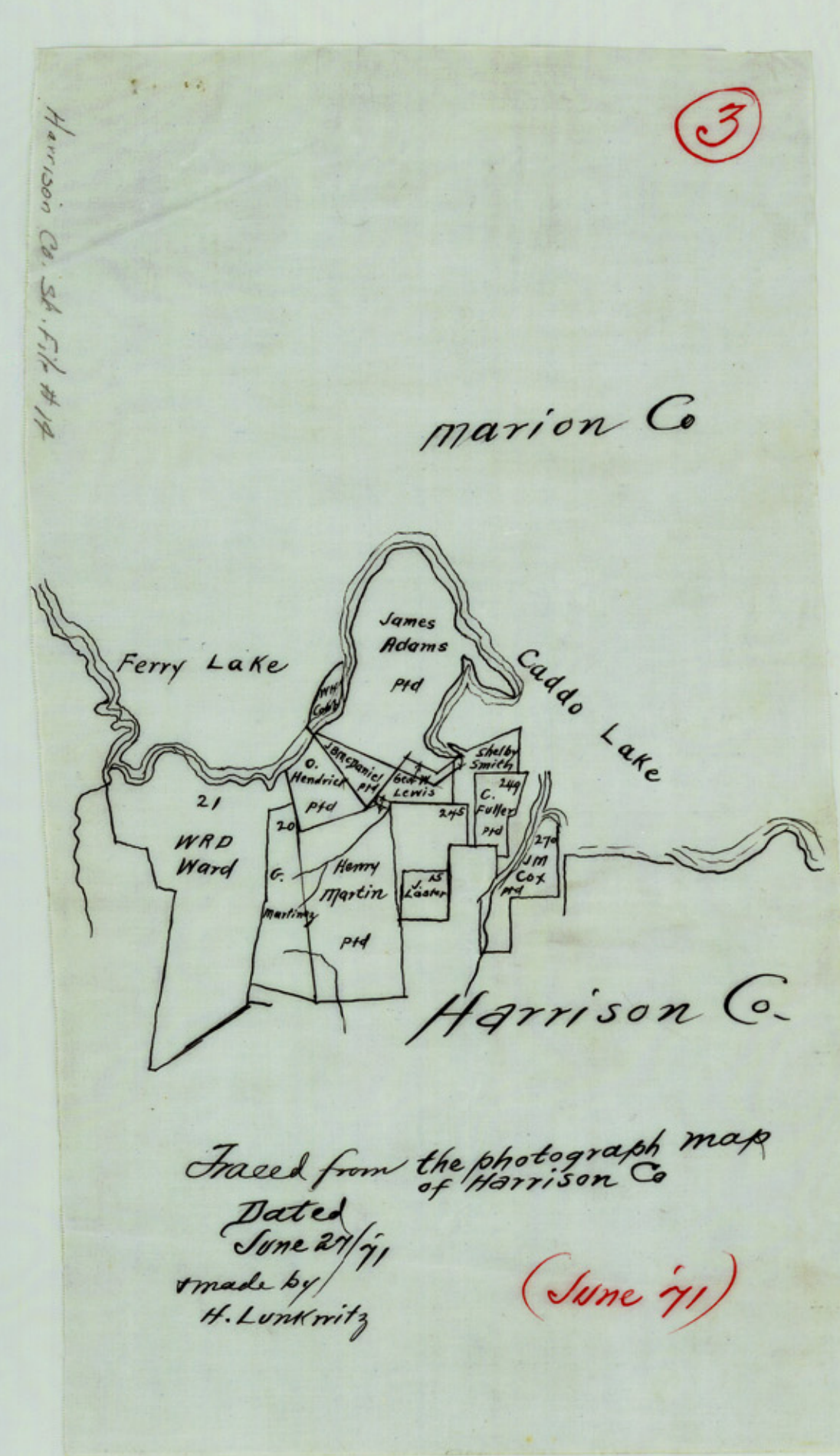

Traced from the photograph map of Harrison Co. Dated June 27/91 & made by H. Lunkwitz (June '91)

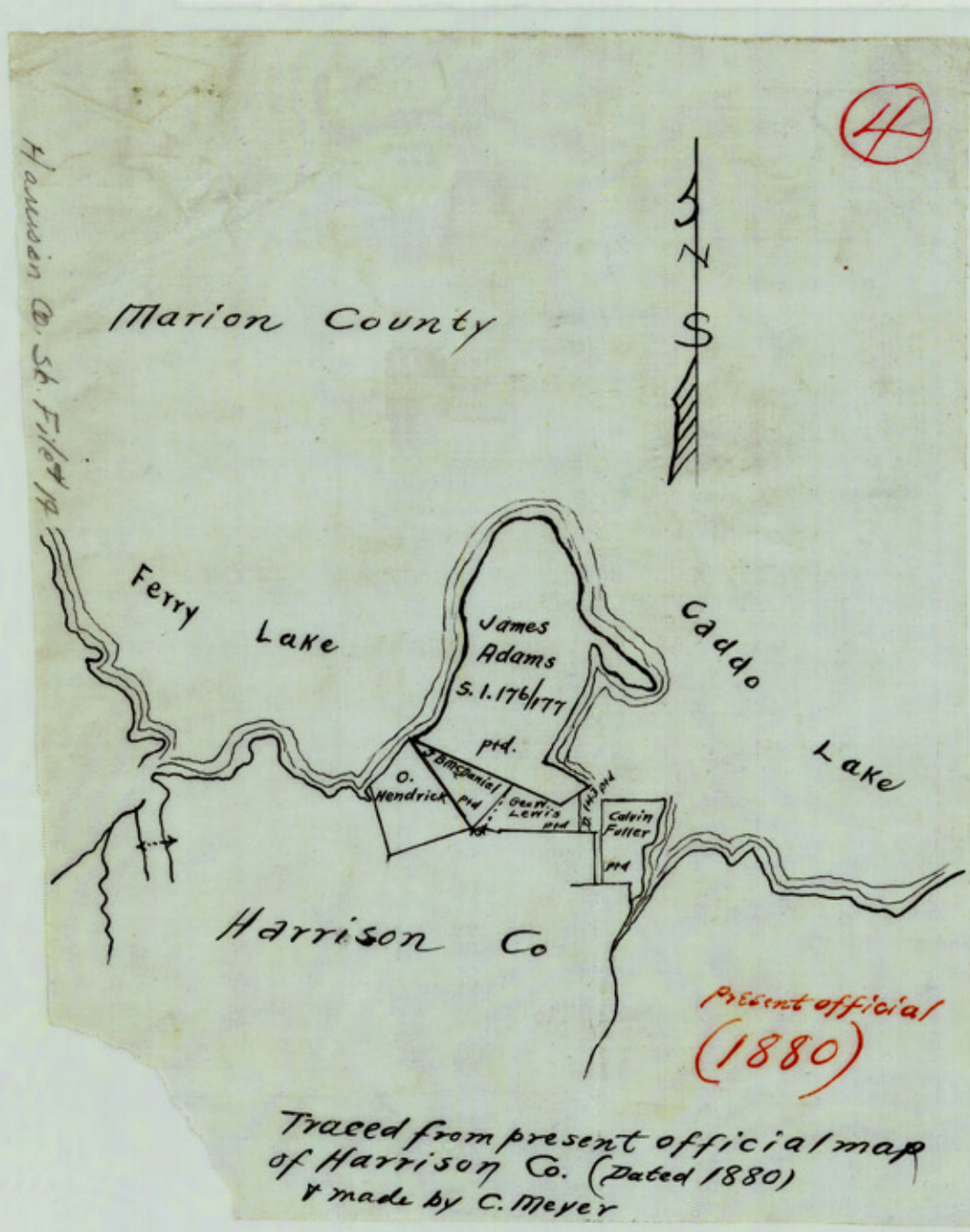

Traced from present official map of Harrison Co. (dated 1880) & made by C. Meyer (1880)