

#.

Waskell Co

Recd January 28/39

Between the junction of
the Brazos and the
Double Mountain fork
West of 10. fork.

county 26/24.

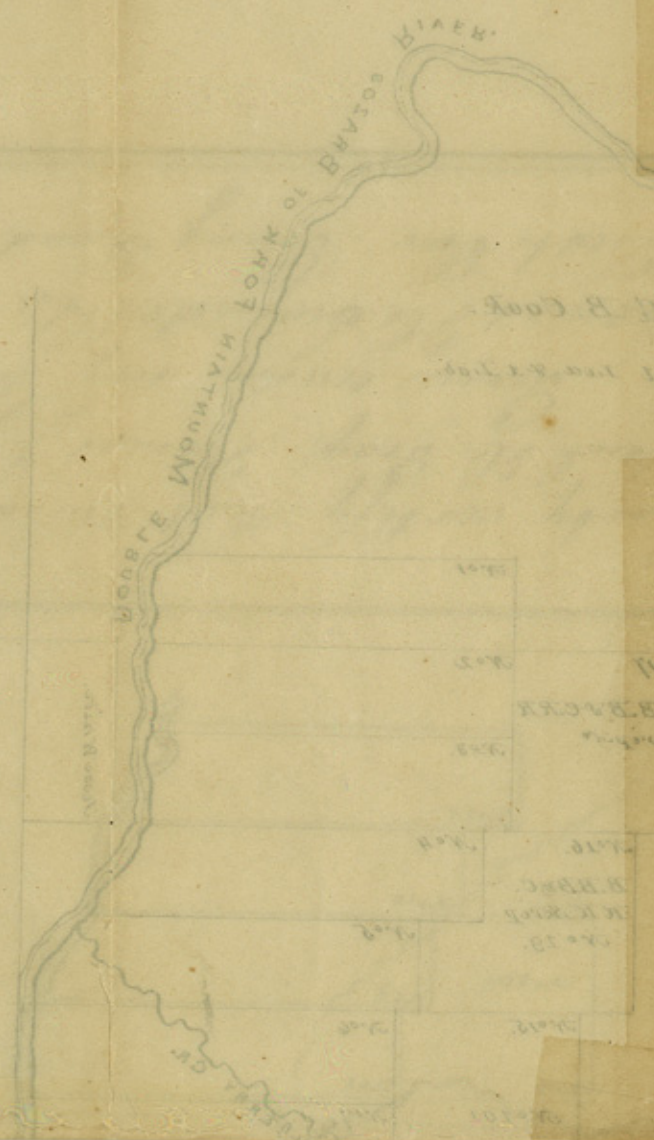

Th'

Scale 2000 vs. to an inch. Var. 70° 30' E.

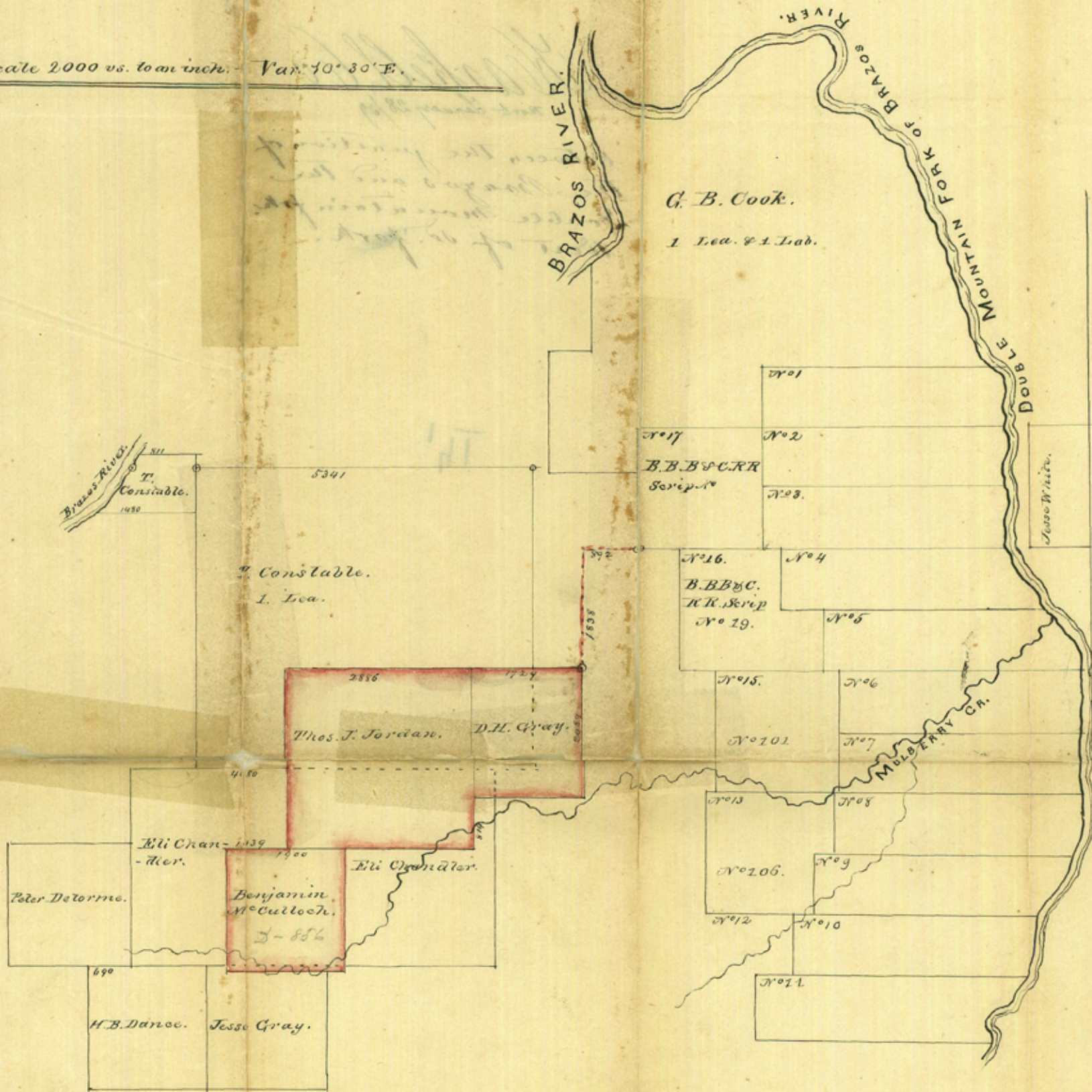

I, James H. Swindell, do hereby certify that the above is a correct sketch of the connections of Paul H. Gray, Thomas J. Jordan, and Benjamin McCulloch surveys, - Given under my hand this 10th Dec, A.D. 1858.

James H. Swindell,
Dist. Sur. Young Land Dist.

Th

counter 26127

Filed Jan. 28/59
E. W. Ryker.