

File # 15
27

Hays County.

22 miles N. 57 W. from
San Marcos.

Schutze's office SK of
Surs, about 22 mi. N 57° W.
from San Marcos.

counter 26237

3600
 343
 3257
 2948
 309



2948
 1280
 4228
 4163
 65

Counter 26238

Plotted March 4/80.
E. Schütz.

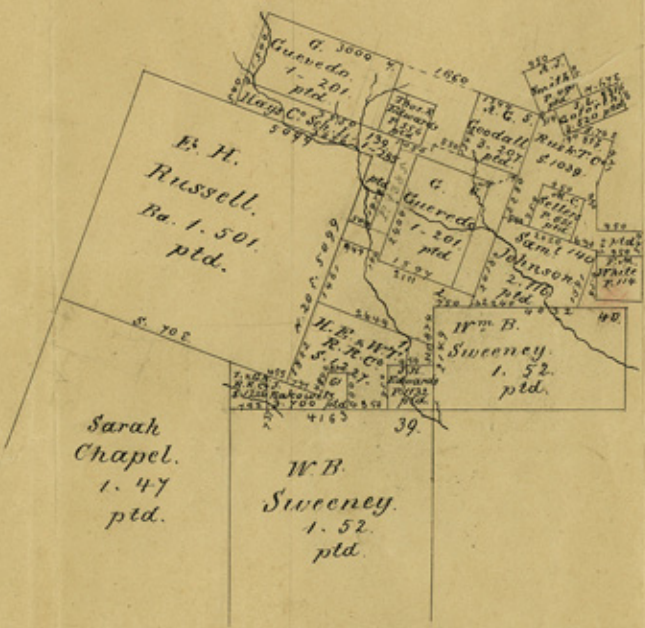

2.0
1.8
40

counter 26239