

State of Texas. Co 3 I Jefe C. Oldham County
County of Henderson Surveyor in the aforesaid
County and State. Say
under my official oath that. On yesterday
I proceeded to re-examine by Running and
measuring in a precise and particular
manner the lines and corners herein after stated
to wit. I proceeded to the Southwest or Lower
Corner of the Nathaniel Addison on Trinity
River and that I had in Company with me
Enoch Spivey & John Spivey Citizens of the above
State & County and Geo M. Bryan of Navarro County
I found at said Corner standing back about
30 feet from the river bank and from the
position calling for a Stake I find a Burr
Oak Tree about 14 Inches in dia standing 2 1/2
to the S. 49° E. and a Hackberry about 12 Inches
in dia br. N 86° E. 7 1/2. Three taking
the course East for the South boundary line
of said Addison Tract. I find the line
in many places very plainly marked
and at 31 7/8 1/2. I found the original Stake
from which a Post Oak 10 Inches in dia br. N. 17 1/2
4 1/2. and a Post Oak about 12 Inches in
dia br. S 80° W. 5 1/2. and that I proceeded to
measure the distance South to the Mrs Liza

South West Corner. and found the distance
150 yrs. only. and then I found two Live Oaks
about 18 or 20 Inches in dia more or less at the
Course and distance as called for in said
Ligan Field Notes at the said South West
Corner. I also found each of the trees
as called for at the S.W. & S.E. Corners of
the Nathaniel Addison marked N. & S.
from the S.E. Corner of said Addison
in running North. I only find the line
marked about 500. or 600 yrs at which
point the marking ceases. Though I find
Large Timber the whole extent of the East
Boundary line of said Addison Survey
measuring in all 6795 yrs. passing the respective
Corners of George Howell & Larkin Groce. I did not
find the Wm Ligan North West Corner.
Nor do I believe that a Corner was ever made
for there is none called for in said Wm Ligan
Patent. The North West Corner of the Larkin
Groce is situated in the South Boundary line
of the Vincent Henrich 400 yrs East of
the S.W. Corner of the. and I find the
Black Jacks at the Course and distance
as called for at the South East Corner of
The Daniel Lacey.

The Black has been thrown down
by a storm within one or two of the last
years. The bark is nearly all ^{off} and if it
was ever marked I could not ascertain
it. And the statement in the original field
notes. as recorded in my office is
true for they state there are no other
Timbers or Trees convenient and there
is both large and small timber within
50. yrs. I find at ^{about} 530. yrs from the S. E
Corner of said Lacey the Port Oak line tree
as called for in the said Record and at
about 1000. yrs. West from the S. E. Corner
of said Lacey I find the South boundary
line of said Lacey plainly marked
I further state I do not believe the East
or north boundary line of the Nathaniel
Addison was never seen or marked. West
as before shown 500 or 600. running north
from the South East Corner of said Addison
And further that there is no conflict
upon the ground in any of the surrounding
surveys. So far as I have been able to
ascertain to all of which statements as above
written I certify to be true. Given under

My Hand this 16th day May 1861. J. C. Claham
C. S. Henderson, C.

J. C. Oldham
C.S.A.C.
20

Certification

L. Green - 1.274 Haulin
G. M. Killeen 3.3600 Naeg
G. Nowell 6.27.1076 Haulin

[Faint, mostly illegible handwritten text, likely bleed-through from the reverse side of the page.]

I, J. H. Blaham
County Foreman of the Jefferson County,
do hereby certify, that from examination
this day made in the County Clerk's
office Book 5 Pages 194 & 5 containing
a Record of the Peter Tolson League
Survey, that said Record exhibits and
shows by patent no. 347 Pat. 4.

that the Western Boundary of said Survey
runs with the meanders of Cedar Creek

and I do further certify that by reference
to Book 9 Pages 18 & 19 that I there find
Patent no. 655 Pat. 8. I there find

Record in favor of A. Adrian and

that the Eastern boundary line of said
Patent runs a due north course through-

out its entire extent and that there are
no timbers at the North East Corner of
said Adrian Survey, to compare or to
particularize or compare said Corner

And I do further certify that
by reference to the Wm. Logan League Patent
No 555 Pat. 9. being a matter of Record
in the County Clerk's office of this
Jefferson County, that I there find

the Western boundary of said Wm. Logan
League running in a due north direction
and that there is no timber call for at
the N W Corner thereof to particularize
said Corner, and I further certify

that by examination and reference to
Record Book E. Pages 468 & 49, in
which the Vincent Heinrich Patent
is Recorded - that the Eastern boundary

of said survey, and is contained in
 the records of Cedar Creek,
 and that also, I further Certify that by
 reference to the record of the Nathaniel Addison
 Patent as a proviso beginning at the S E
 Corner of the Daniel Lacy 1/3 league Survey,
 that said Addison Patent calls for running
 South 40° E 1/2 M. ~~and so on~~
 to Pass D. Page's B 142. I then find recorded
 in this County Clerk's office a patent to Mat-
 well Steel the Eastern Boundary line
 running with Cedar Creek and that the
 accompanying Sketch shows the true
 position on the ground of Maxwell Steel
 Vincent Heinrich Peter Tumlinson Wm Ligan
 Nathaniel Addison George Maxwell Larson
 Gold G M Willian and Daniel Lacy
 surveys. All of which I Certify to
 be true and correct to the best
 of my knowledge & belief.

This Sept 29, A.D. 1860
 J. C. Oldham
 J. C. H. C.

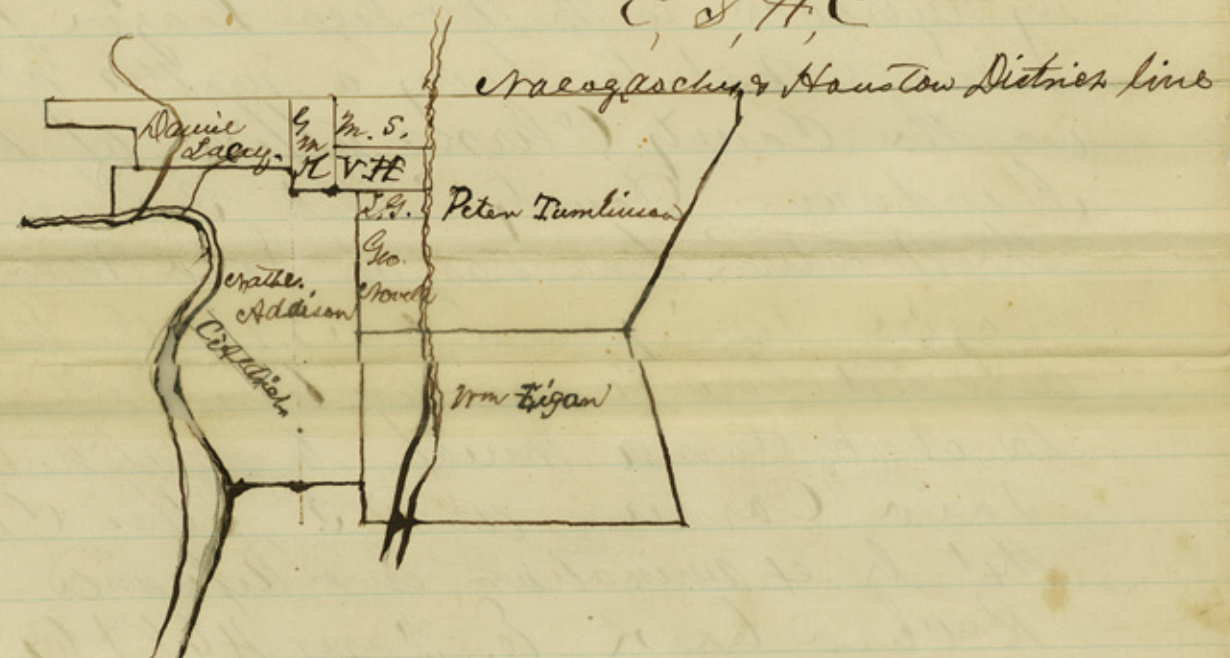

Jb⁵

counter 26339

Henderson Co. St. File #8a

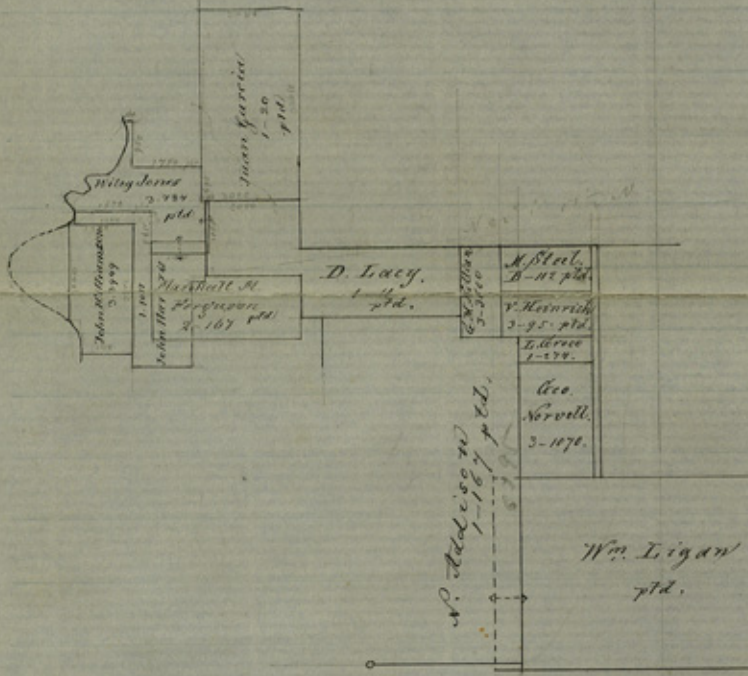
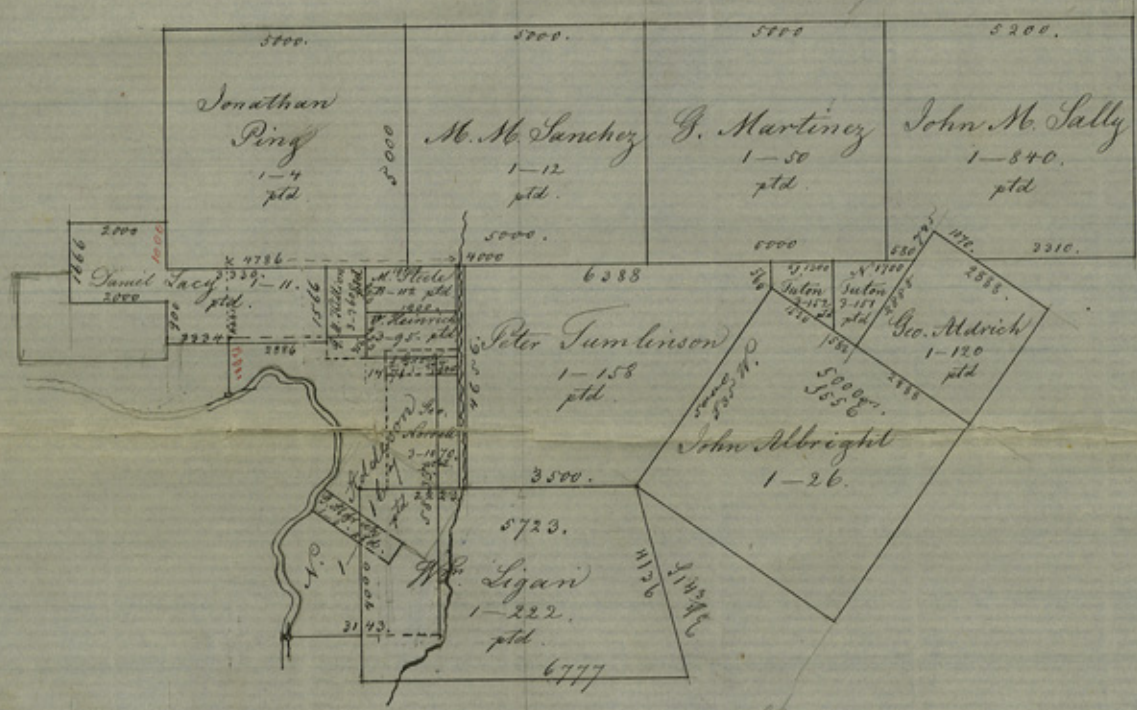

Plotted according to the
 statement hereto attached
 dated " May 16th 1861;
 of J. C. Oldham Co. Suro.
 of Henderson Co.
 May 29/61. W. Pennington

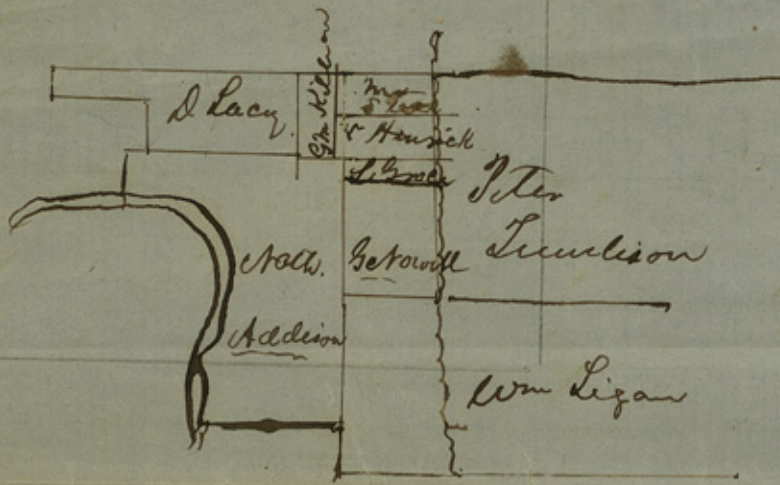

State of Texas
 County of Henderson }
 } L. M. O'Brien County
 } Surveyor of Henderson
 } County, Texas. Certify
 That the above Sketch or Sketches show
 correctly the Condition of the Land
 according to actual view or measure-
 ment on the ground and that the
 Record of the Maxwelle Still & Vincent
 Henrich are both bounded on the
 East by Cedar Creek and that the
 three surveys made by me on 640
 for Geo. Nowell Henr. one for Larkin
 Groce & one for Geo. H. Stillion are
 all truly designated in the Sketch or
 Sketch above as will appear
 by reference to the several Patents
 on Record in the County Clerk's office
 This County of the surrounding tract.
 Advice also appear by the records at the
 Genl. Land office given under
 my Hand This 25th Nov. 1857

L. M. O'Brien
 S. S. H. C.

File #
108
82

Sketch Showing
the Connections of
Several Surveys.

Filed May 11/68

Henderson Co
between Trinity River & Cedar
Co.

1. Rec'd. Somersby 1857
2. Compeled in Office Oct 18/60
3. filed Oct 18/60
4. filed May 29/61.

W. & S.W. of Athens.

counter 26342

368