



RECEIVED
 JAN 09 1987
 GENERAL LAND OFFICE

Granada Management Corporation

10900 Richmond Avenue
 P.O. Box 42298
 Houston, Texas 77242-2298
 713/783-1310
 Telex: 790399 GRANADA HOU

7 January 1987

Mr. Herman Forbes
 Texas General Land Office
 S. F. Austin Building
 Austin, Texas 78701

Dear Mr. Forbes,

Please find enclosed copies from the book, A History of Hill County, Texas by the Hill County Historical Society. On pages 42, 43 and 245 a short history is written about the community of Scott's Chapel.

Also enclosed is the General Highway Map of Hill County prepared by the State Department of Highways. On this map the Scott's Chapel Cemetery, which was donated by John Coleman Burris Scott, has been preserved.

I trust that this is sufficient evidence for making the correction to the Survey Map (October 7, 1983) by Jana Brod.

It is our desire to have the name preserved as a matter of importance to Texas history.

Our thanks for your time and consideration to this matter.

Respectfully,

Michael A. Reese

Michael A. Reese

File No. *Sketch File 28* County *Hill*
 Change *Schappell to Scott's Chapel*
 Filed *Jan 9* 19 *87*
 By *Douglas Howard*
 GARRY MAURO, Com'r

counter 26530

RECEIVED
JAN 09 1987
GENERAL LAND OFFICE

File No. Sketch File 28 County
Hill
Change Schappell to Scott's Chapel
Filed Mar. 9, 1987 19
By GARRY MAURO, Com'r
Douglas Howard

A HISTORY of HILL COUNTY, TEXAS 1853 - 1980

*One generation passeth another, and
another generation cometh, but the
earth abideth forever.*

Ecclesiastes 1:4-5

By
Members, Hill County Historical Commission
Residents of Communities
Editorial Staff:
Miss Ruth B. Reed
Mrs. Walton Smith
Dr. Celeste Varnell Dodd, Chairman

*Printed
1980*

Nevertheless, there is still community spirit as evidenced by the large turnout at the Mayfield homecoming the past two years. Plans are being made to have homecoming again this year.

MENLOW AND SCOTTS CHAPEL

by

Mrs. Lewis Janda, Jr.

Driving down F.M. road 1304 from Abbott to Aquilla, you make a couple of curves in the road, and see the sign "Menlow." There is little to indicate that this was once a thriving community. If you looked in the pasture on the south side of the road, you would find some slabs of concrete; that's where the cotton gin once stood, and there are about five old, dilapidated, vacant houses around.

Things were quite different around the turn of the century. At one time there were three churches (a Methodist, Baptist, and a Church of Christ), a school, a gin, 2 grocery stores, a blacksmith, a barber shop, a veterinarian (Dr. Griffin), and a medical doctor (Dr. F.D. Simms).

But looking back even farther, the first community settled here was a couple of miles to the west of Menlow. Scotts Chapel school and church organized around 1866.

Mr. and Mrs. P.G. Scott came to Scotts Chapel in 1852 when this county was part of Navarro County. They were full of determination to succeed in life and were ready to battle the wilds of the West. Many hardships were undergone, for this country was full of Indians, bear, and buffalo, but the fascinations of a new country more than paid for their hardships. They lived in the Scotts Chapel community for 40 years and raised a large family of 11 children. He donated land for the school and church and his brother, Burrell Scott, donated land for the cemetery. He died in 1892. She fell from a train while going to visit one of their children and never fully recovered.

There is a natural spring about ½ mile north of Scotts Chapel school grounds on land now owned by Edward Stacy. This area was evidently once an Indian campground because of numerous arrowheads that have been found there.

Another pioneer family, Mr. and Mrs. W.W. Treadwell, moved here in 1866 from Navarro County. "Uncle Wint" as he was called, was married January, 1864, to Cornelia Evelyn Garner, (who was of direct blood to the Henry Clay and John Nance Garner families).

They brought with them from Navarro County remnants of a herd of cattle Mr. Treadwell owned before going to war (Civil War). Only a few of the original herd was left. They placed these on their land and in order to get their ranch stocked more quickly, raised cattle on shares for neighbors and friends.

building served for both purposes. Many were the laymen who built and organized churches which represented their particular beliefs. This act was the dream which culminated in the symbol of their individual rights for which they had sought this new county.

Each community historian has included in his remarks the establishment and functioning of its own churches.

CEMETERIES

Most churches had their own cemeteries and there were many small family cemeteries. Many cemeteries over the county have been disturbed by the installation of lakes. Mrs. Odette Bottom of Abbott has made an exhaustive study of the county cemeteries, those that have been lost and those that have been removed because of the lake water encroaching on the cemetery. She gives the following account:

Eugene and Odette Kennedy Bottom and Milford and Mayvette Kennedy Willis started in November, 1975, listing the cemeteries and graves in Hill County. Three years later we had them listed, arranged in alphabetical order and typed — 82 cemeteries. Some small family plots, others with thousands of markers.

For some, all that was needed was lots of paper, pencils and clip boards. Others required boots, hoes, clipping shears (for briars) and something to probe for stones that had fallen and were covered with dirt. Boxes and boxes of chalk to read the old and worn markers. In one cemetery we wrapped our legs with newspapers because of grass burrs.

Some were easy to locate with the aid of a map of Hill County. Others we had to have help to find. Mr. Ellis Bailey helped locate the ones near Itasca. John and Martelia (Watson) Cochran went with us in the Irene area. After 3 attempts to find Stiener Valley Cemetery, Mr. Ray McNeely led the way.

Some of the small family plots are no longer there. The Stembridge Cemetery that dated back to 1850 and had 5 graves (some say seven) has been demolished, the markers all moved. It was located on the Joe Mikeska farm southwest of Abbott.

Abandoned cemeteries:

Burris west of Malone
 Rienzi northwest of Malone
 Zollicoffer near Irene
 Walling Family near Brandon
 Eureka north of Hillsboro
 Copperhead west of Aquilla
 Simons near Bethel

Neglected cemeteries, where only a few lots are cared for:

Abbott

Jessie-Chatt

Scott's Chapel southeast of Aquilla

Rockwall southeast of Itasca

There is a small cemetery near Latham Springs (formerly known as Otfield Springs) that has one marker left. Others have been destroyed. The lone marker is that of Millerville Jeter, who died in 1866. Some of the old timers in the area say the other graves are of an Elliott family.

Lone graves — I found these graves with the help of letters and too many phone calls to list:

F.A. Vaughan, wife of W.M., 1852 — Nov. 10, 1879. The marker has been moved, ground plowed over. We found the marker in weeds along a fence row.

Haire, B., York District South Carolina, Mar. 2, 1788 — Died Apr. 25, 1861. His grave is in a pasture on Mrs. R.D. Mash's farm north of Hill Jr. College.

Victoria Mayes — died on a train about 1900. Grave is located on the Howard farm. Information was given to us by Larry Wright.

Mary C. Cash, wife of Eli Cash, Age 32, d. Nov. 7, 1876. Grave is on a farm southeast of Rockwall Cemetery, southeast of Itasca. There is another grave beside this one, unmarked, said to Mrs. Cash's mother.

Josephine Bottoms, Nov. 6, 1888 — Nov. 6, 1900. Located in field on Deerwood Griffin Ranch. Her mother's name was Harriet _____. Mrs. Ruby Schulze helped us find this grave.

John Stubblefield — born in Orange Co., Va., Nov. 1, 1804, died Apr. 3, 1877. Grave is east of Itasca on the Turner (Couch) Ranch.

Mrs. A.P. Butler, born Oct. 13, 1851 — June 7, 1904, daughter of Jessie Butler Guiwn. Grave is in a pasture east of highway 933, between Aquilla and Whitney. Another grave beside this one. Mrs. Tine Hart says a small Mexican boy is buried there.

Janus Shields, son of Thomas and M.J. Hooker, b. Sept. 14, 1855 — died 1869. Grave is in a field northeast of the Prairie Grove Cemetery southwest of Aquilla.

Phillip Nolan, (born in Ireland, first came to Texas and established residence at Nacogdoches in 1791.) When killed was resident of Natchez, Miss. Killed near Blum, Texas, Mar. 21, 1801 by Spaniards and buried by his Negro slaves, Caesar and Robert. His death aroused a wave of indignation that led to the independence of Texas.

There are other lone graves scattered about the county but do not have markers.

Cemeteries moved when Lake Whitney Dam was constructed: (From the records of U.S. Army Engineer, Fort Worth District.)

Captain Wilson, DeGraffenreid, Walling Bend, Towash (White) and two small Shuler Cemeteries were moved to Whitney. Towash (Colored) was moved to a new location east of Whitney.

Allen Bend, Cedron Creek, Powell, Pogue and Kimball Bend were moved to a new Kimball Cemetery, across the Brazos River into Bosque County, also a small Heasley Cemetery with no identifiable graves.

Fort Graham South and West these were two small cemeteries near the larger Fort Graham Cemetery.) G.W. Webb, Benson and Phelps were moved to a plot just west of the Steiner Valley Cemetery (in poor condition - but fenced), separate from Steiner Valley.

TOURIST ATTRACTIONS

In 1968 the Texas Historical Survey Committee and the Texas Highway Department designated 75 miles of highway in Hill County a part of the Texas

county 26533

2660

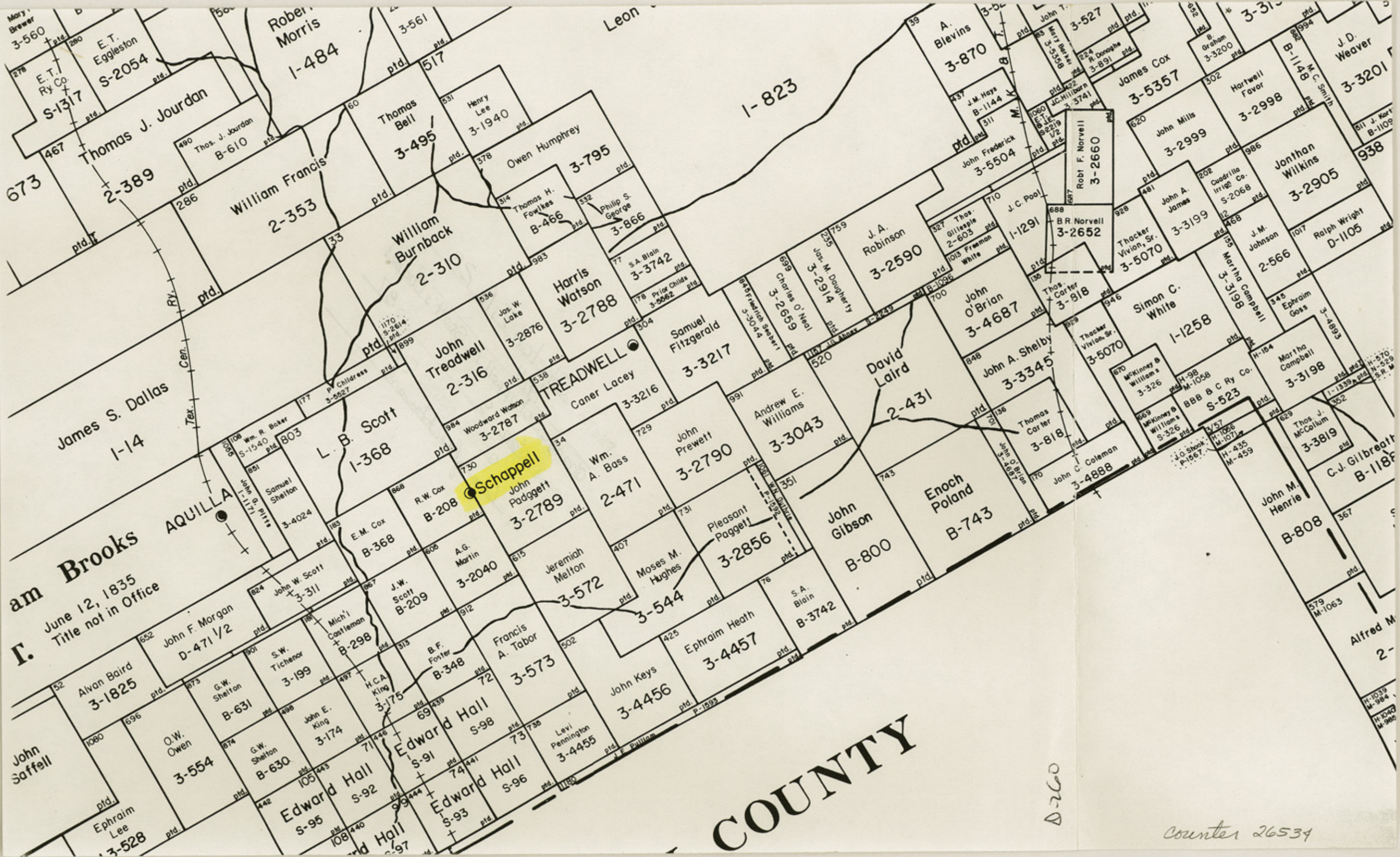

D-260

Counter 26534

Michael A. Reese
Granada Corporation
P. O. Box 42298
Houston, Texas 77242-2298



RECEIVED
JAN 09 1987
GENERAL LAND OFFICE

0-260

first class

Mr. Herman Forbes
Texas General Land Office
S. F. Austin Building
1700 North Congress Ave.
Austin, Texas 78701

first class

counter 26535

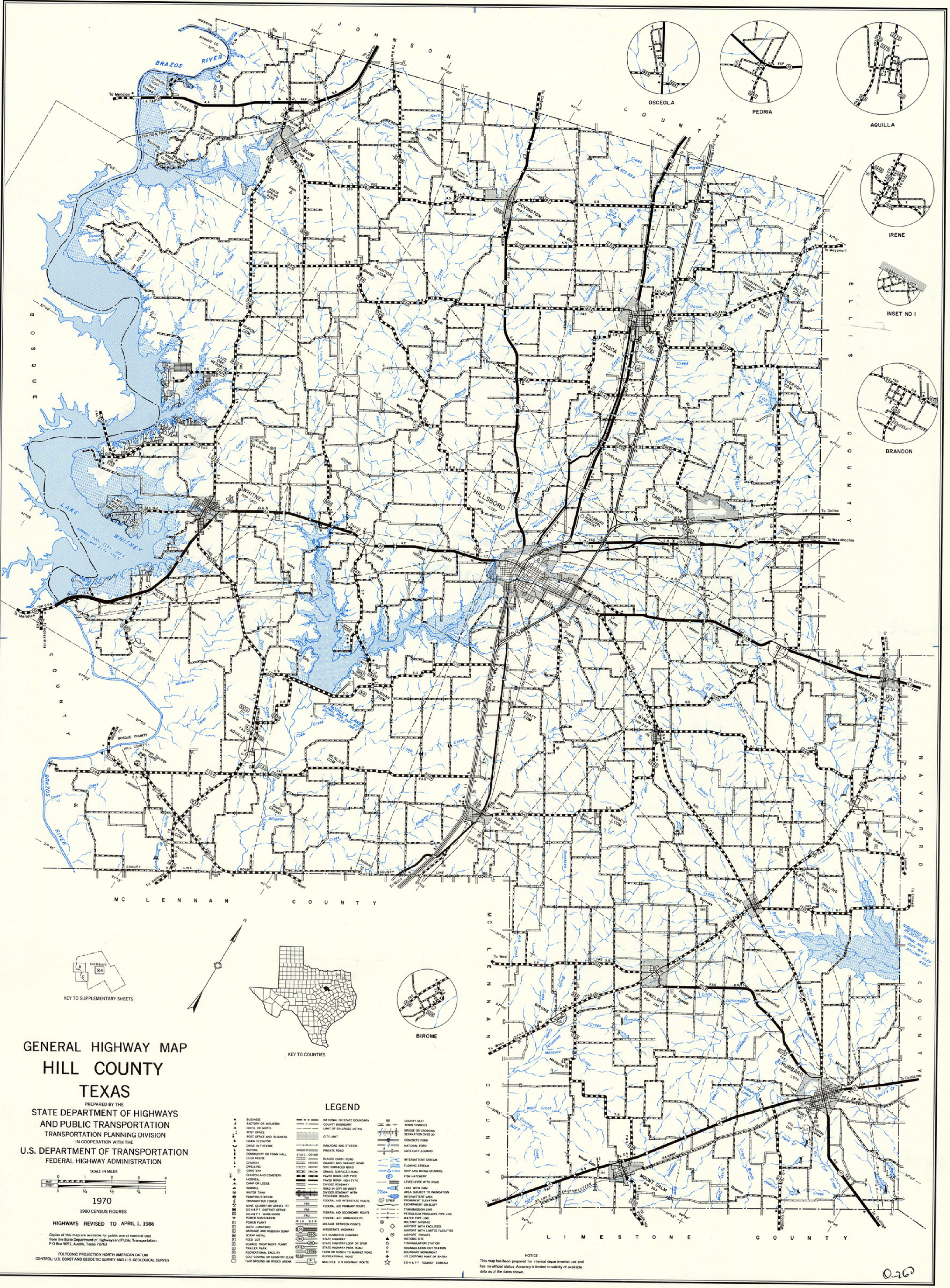

**GENERAL HIGHWAY MAP
HILL COUNTY
TEXAS**

PREPARED BY THE
**STATE DEPARTMENT OF HIGHWAYS
AND PUBLIC TRANSPORTATION
AND TRANSPORTATION PLANNING DIVISION**
IN COOPERATION WITH THE
**U.S. DEPARTMENT OF TRANSPORTATION
FEDERAL HIGHWAY ADMINISTRATION**

SCALE IN MILES
1970
1980 CENSUS FIGURES
HIGHWAYS REVISED TO APRIL 1, 1986

Copies of this map are available for public use at nominal cost from the State Department of Highways and Public Transportation, P.O. Box 5021, Austin, Texas 78763.

LEGEND

- BUSINESS
- FACTORY OR INDUSTRY
- HOTEL OR MOTEL
- POST OFFICE
- POST OFFICE AND BUSINESS
- GRAIN ELEVATOR
- CHURCH
- COMMUNITY OR TOWN HALL
- CLUB HOUSE
- SCHOOL
- CAMP OR LODGE
- HOSPITAL
- CAMP OR LODGE
- SHARPLEY
- WATER TANK
- PUMPING STATION
- TRANSMISSION TOWER
- MINING QUARRY OR GRAVEL PIT
- SOLID P.T. DISTRICT OFFICE
- 150 x 150 FT. WAREHOUSE
- POWER SUBSTATION
- POWER PLANT
- AUTO JUNKYARD
- GARAGE AND RUBBER DUMP
- FEED LOT
- SEWAGE TREATMENT PLANT
- TRAILER PARK
- RECREATIONAL FACILITY
- GOLF COURSE OR COUNTRY CLUB
- FAIR GROUND OR RODEO ARENA
- NATIONAL OR STATE BOUNDARY
- COUNTY BOUNDARY
- LIMIT OF ENLARGED DETAIL
- CITY LIMIT
- RAILROAD AND STATION
- PRIVATE ROAD
- GRAVELD EARTH ROAD
- GRAVELD AND GRAVELD ROAD
- SOIL SURFACED ROAD
- GRAVEL SURFACED ROAD
- PAVED ROAD LOW TYPE
- PAVED ROAD HIGH TYPE
- CRUISED ROADWAY
- ROAD IN CITY OR TOWN
- CRUISED ROADWAY WITH FRONTAGE ROADS
- FEDERAL AID INTERSTATE ROUTE
- FEDERAL AID PRIMARY ROUTE
- FEDERAL AID SECONDARY ROUTE
- FEDERAL AID URBAN ROUTE
- MILEAGE BETWEEN POINTS
- U.S. NUMBERED HIGHWAY
- STATE HIGHWAY
- STATE HIGHWAY LOOP OR SPUR
- STATE HIGHWAY PARK ROAD
- FARM OR RANCH TO MARKET ROAD
- RECREATIONAL ROAD
- MULTIPLE U.S. HIGHWAY ROUTE
- COUNTY SEAT
- TOWN SYMBOLS
- BRIDGE OR CROSSING
- SEPARATION OVER JO
- CONCRETE FORD
- NATURAL FORD
- GATE CATTLEGUARD
- INTERMITTENT STREAM
- FLOWING STREAM
- SHIP AND BARGE CHANNEL
- FISH HATCHERY
- LEVEE LEVEE WITH ROAD
- LAKE WITH DAM
- AREA SUBJECT TO INUNDATION
- INTERMITTENT LAKE
- PROMINENT ELEVATION
- ESCAPMENT OR BLUFF
- TRANSMISSION LINE
- PETROLEUM PRODUCTS PIPE LINE
- WATER PIPE LINE
- MILITARY AIRBASE
- AIRPORT WITH FACILITIES
- AIRPORT WITH LIMITED FACILITIES
- HISTORIC SITE
- TRANSLATION STATION
- TRANSLATION CUT STATION
- BOUNDARY MONUMENT
- U.S. CUSTOMS PORT OF ENTRY
- S.D.H.P.T. TOURIST BUREAU

HILL COUNTY TEXAS 110