

otherwise by the Courts

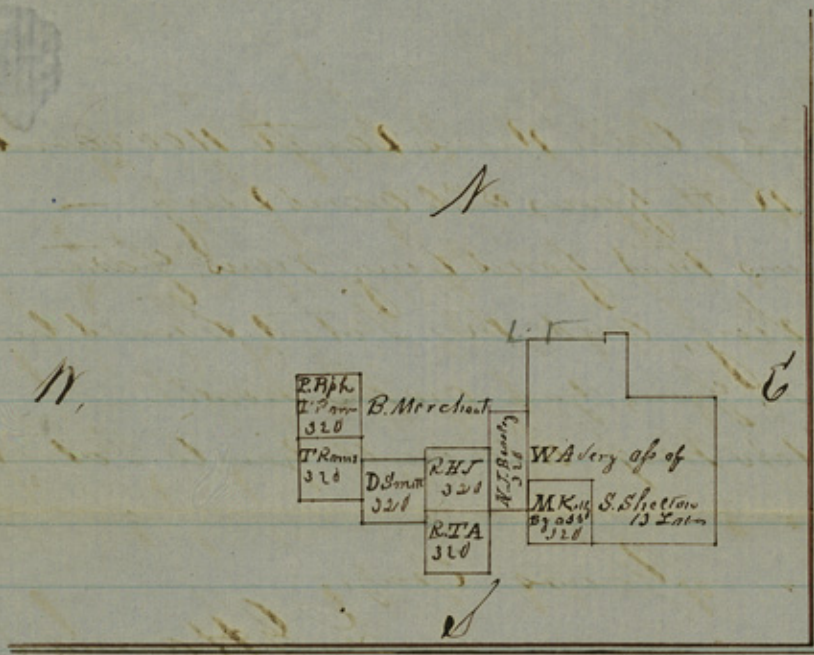

The State of Texas 3
 District of Hopkins 3
 District Surveyor Hopkins District do hereby Certify
 that the foregoing Sketch Map, is correct as plotted from
 the records of my Office and shows correctly the
 location of N. J. Beasley's Survey for 320 acres in Hopkins
 County, about 14 miles S. W. from Tarrant.

Given under my hand at Tarrant, this
 15th day of October 1838

L. G. Hamman
 D. S. H. T.

Tarrant, 13th October 1838

H. M. White, Comr Surveyor

You will see that the Beasley Field Note Begins at
 the S. E. corner of a Survey of 320 acres in the name of
 W. H. Emberson, which is marked on the Plot R. H. J. —
 resurveyed for R. H. Jones, and Runs East 875 yards
 to the N. B. line of a Survey of 320 acres in the name
 of Brown, marked and this Sketch Map M. Kelly, by apt
 A. S. Gray, The Emberson Survey is resurvey for Jones, and
 the Brown Survey is resurveyed in the name of M. Kelly
 by apt A. S. Gray. I also send you the Patent issued to M. W.
 Matthews upon the Patent gives one Range Call which is
 the 2^d Call.

You will see that the 3^d Call Runs South 1100 yards
 to the N.W. corner of R. H. Jones 320 acres Survey —
 the Sketch map shows that Jones Survey runs farther
 North than Smiths Survey, and the Patent should be
 corrected, let me hear from you on this matter —
 I hope that the Sketch map will enable you to Patent
 the N. J. Beasley Survey.

Yours Truly,
 L. G. Hamman

P.S.

You will please forward the Patent as soon as it is
 issued, to me, at Summit, Hopkiss County, and send
 me an act. of all the money deposits by me in the
 and what claims have been charged to my acc.

Yours Truly,
 L. G. Hamman

File # 13

15

Hopkins Co.

The letter should be filed
 with the sketch on the
 Department's record.
 12 miles S 70° E from
 Sulphur Springs
 L. G. Hamman's letter.
 Dated Oct 15, 1858.

The N. J. Beasley claim is under for patenting
 from the survey made according to the record of
 the survey. Your sketch does not at all agree
 with the actual notes of the Beasley Survey. See
 my St. Charles, the paper, be understood. The sur-
 vey is correct is correct and is a good one. The
 notes, and must be very good and will be returned