

The State of Texas  
County of Hopkins

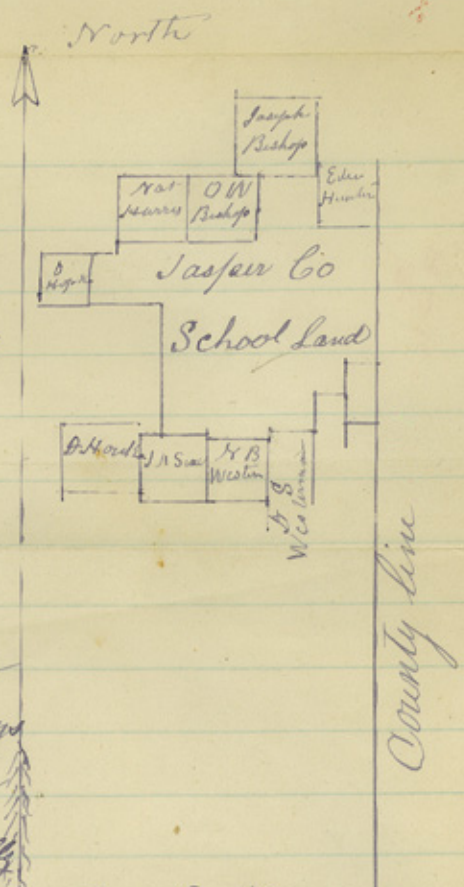

I W W Barker J. S. A. S. J.  
do hereby Certify that I  
have carefully resurveyed  
the Jasper Co School Land  
and the accompanying  
plat is a faithful represen-  
tation of the adjoining surveys.  
The attention of the Com-  
Gen Land Office is especially  
directed to the position of the David Housd survey,  
the North East corner of which is 160 varas  
North of the North West corner of the J. A Sinclair  
The J. A Sinclair and two Westerman surveys  
also the Geo B Halyard on the ground are  
about 715 varas South of the position assigned  
there upon the late maps of this County.

The Noah Shoffell South East corner I  
found 170 varas West from the North West  
corner of the Israel Dawson the field notes  
of which shall be corrected as suggested  
by you

W W Barker J. S. A. S. J.

Dec 7<sup>th</sup> 1869

P. #

~~17~~ 16<sup>a</sup>

Hopkins Co.

~~Jasper County Sketch~~

Filed March 14<sup>th</sup> 1870

Thick paper

N. E. Corner,

WW Barker's cert, in re,  
to surs, around the Jas-  
per Co. Sch<sup>l</sup>-Land.