

HOWARD TRIGG  
COUNTY SURVEYOR

2276

*Failed to enclose*

*R/P*

*1/27/22*

*Hullup*

RECEIVED

AMARILLO, TEXAS.

Jan 25" 1922

Hon. J. T. Robison,  
Austin, Texas.

JAN 27 1922

Referred to Map

Dear Sir:-

I have just recently resurveyed twenty sections in Hutchinson Co. and am enclosing two copies of each to you for your examination and approval. When examined and approved will place the carbon copy on record at the County seat ~~or~~ in book form and receive them in that way.

These block Z surveys have been located from the original surveys in Block 47 H & T C R R Co. Surveys 1 and 2 Block I have been located along the east line of Block X O 2 and the N.W. corner of No. 2 at the N.E. corner of Survey No. 16 Block X O 2. In the resurvey of sections 22 to 26 Block 47 H & T C R R Co. I have located them with reference to the original West line of Survey No. 16 which is determined by the Original Maddox corner in Sec. 18 and all the excess E. & W. has been given to Sec. 25. *22 25 26*

I am enclosing blue print which will be of some assistance in examining them.

Let me have your report on this as soon as possible.

Respectfully,

*Howard S. Trigg.*

*over*

*Wt*

counter 27254



18 of the Sm. have been filed correct, with  
the exception of sect 36 Blk M. 23. where the acres  
have been corrected to 472 acres instead of 427.9 acres  
Sm. of Sects. 23 & 25 Blk 47 are returned for correction

The Board of Commissioners

4/10 22 M.

Wk<sup>1</sup>

Hutchinson Co. St. File # 24

counter 27257



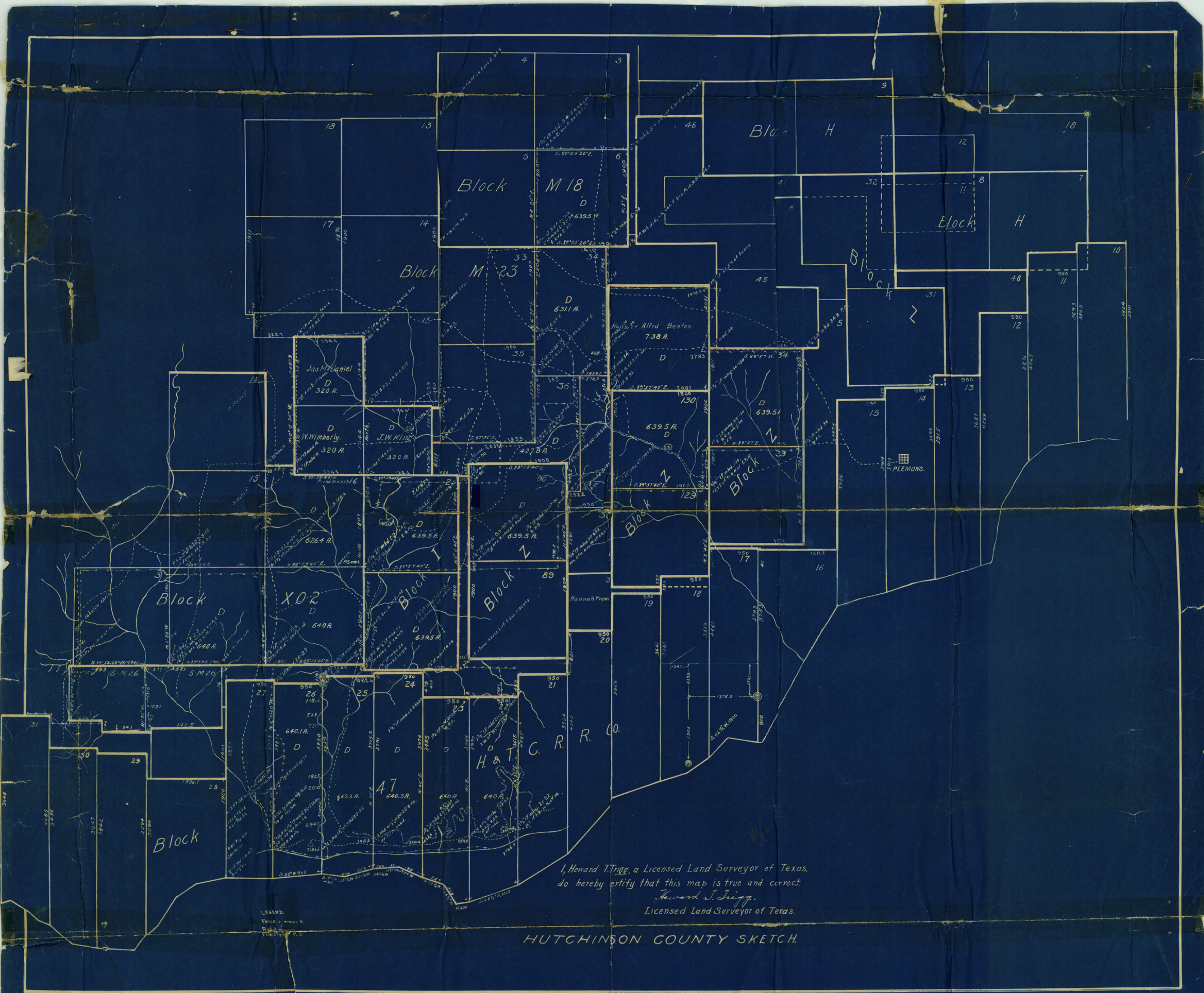

I, Howard T. Trigg, a Licensed Land Surveyor of Texas,  
do hereby certify that this map is true and correct.  
Howard T. Trigg,  
Licensed Land Surveyor of Texas.

HUTCHINSON COUNTY SKETCH.

LEGEND.  
Fence ---  
R.R. ---  
File 317 P.D.