

North

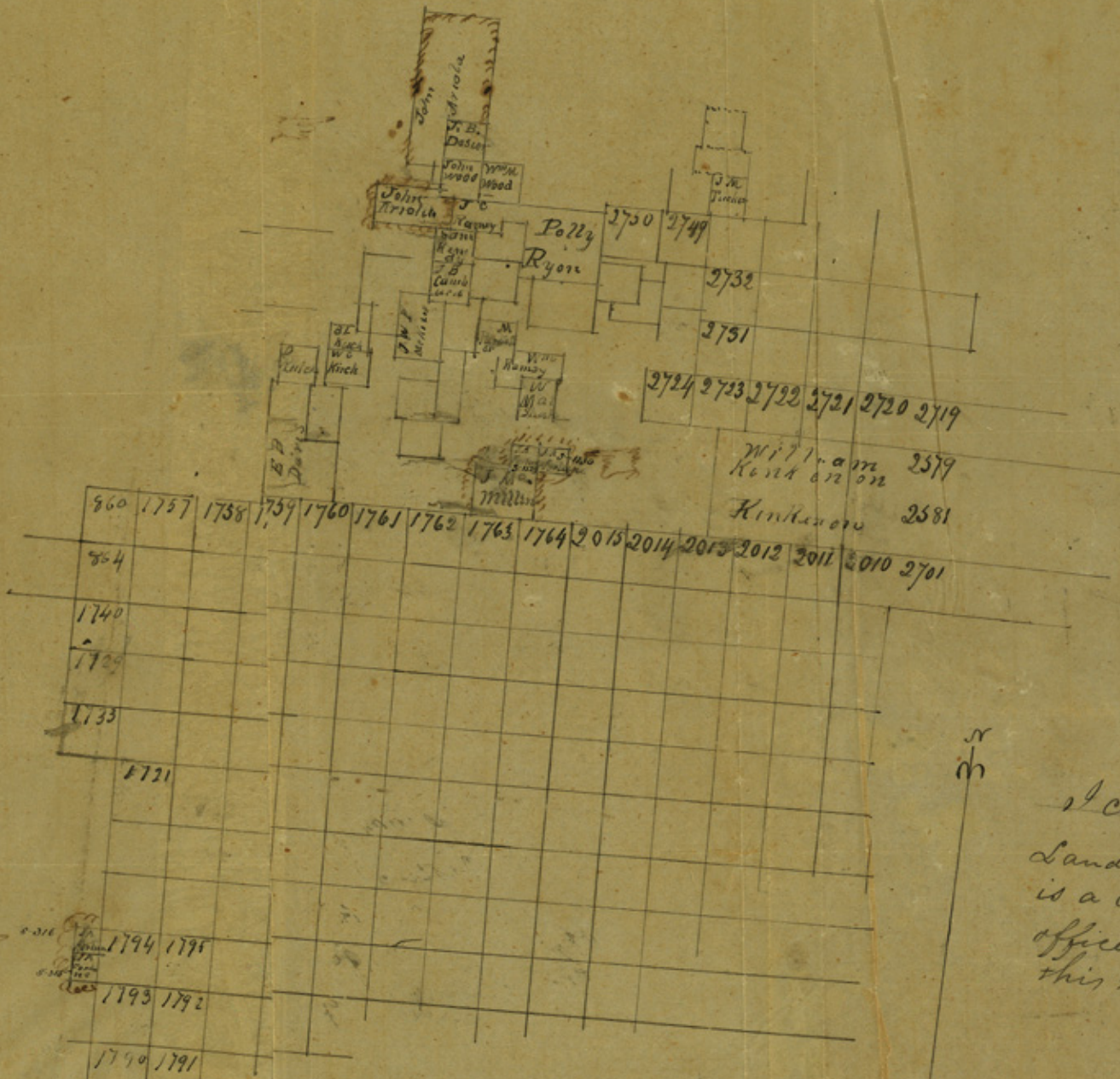

960 1757 1758 1759 1760 1761 1762 1763 1764 2015 2014 2013 2012 2011 2010 2701

William Kenton 2579
Kinchenore 2581

1794 1795
1793 1792
1790 1791

Scale 4000 yards to the inch

3
3

I Chas. Lacy District Surveyor of the Santa
Lana District do hereby certify that the foregoing
is a correct sketch of the original maps in this
office given under my hand at Denver
this the 15th day of octo 1867.

Chas. Lacy Dist. Sur.
of Santa Lana District.

County 27506

1000 00 11/14 # 4

Site # ~~11~~
4

Jack County

Recd. January 1858

about 12 miles South
of Jacksboro.

Chas C Lacy's SK about 125.
of Jacksboro.

Dated Oct. 15, 1857.

Filed January, 1858

number 27507

902581206

[Faint handwritten notes, possibly bleed-through from the reverse side]

Jack. Co. St. File #4