

East boundary of Young County

Scale of 4000, Vars, to the Inch.

I Charles Lacy District Surveyor of the
 Denton Land District do hereby certify that
 the foregoing is a true and correct sketch
 of the original maps in this office
 Given under my hand at
 Denton this 29th July 1857

Chas. Lacy Dis Sur
 of Den L District

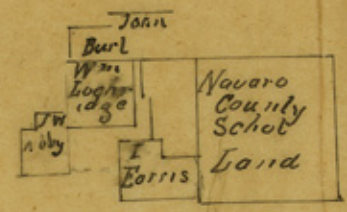

counter 27514

Lacy's map of Denton

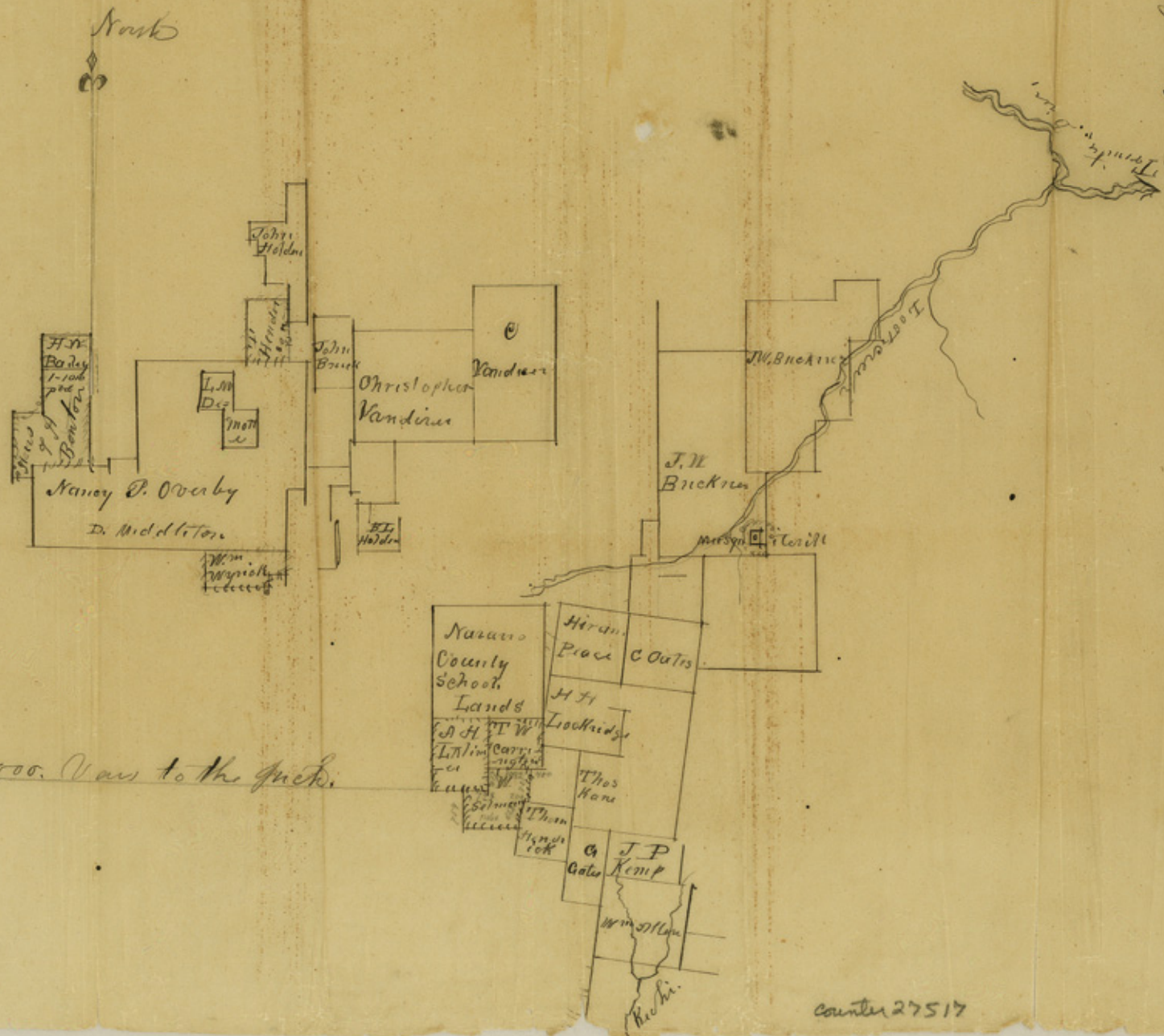

Scale of 4000. Yards to the inch.

I, Chas. C. Lacy, District Surveyor of Eastern Lincoln Dist.
 Do hereby certify that the foregoing is a true and correct
 sketch of the original maps of my office
 given under my hand at Denton this 29th day of 1857.
 Chas. C. Lacy District Sur of De
 Lane District

File # 7
R.

Sack Co.

Recd Aug. 17/57.

- 1) including Sacksboro
- 2) West of " "

2 sketches of Chas Clacy.

1st including Sacksboro.

2d West of do.

Dated July 29. 1857.