

I Cha^s Lacy District Surveyor for the Denton
 Land District Do hereby certify that the foregoing
 sketch is a true copy of the original map in my Office
 Given under my hand at Allen this the 19th day
 of September 1856

Cha^s Lacy District Surveyor
 for the Denton Land District

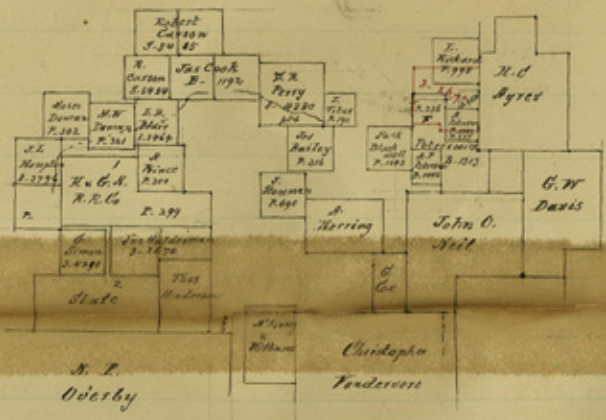

counter 27590



Handwritten scribbles and marks on the right edge of the paper, possibly including a signature or initials.

Handwritten text: "L. M. C. W. S. 1880-1882"

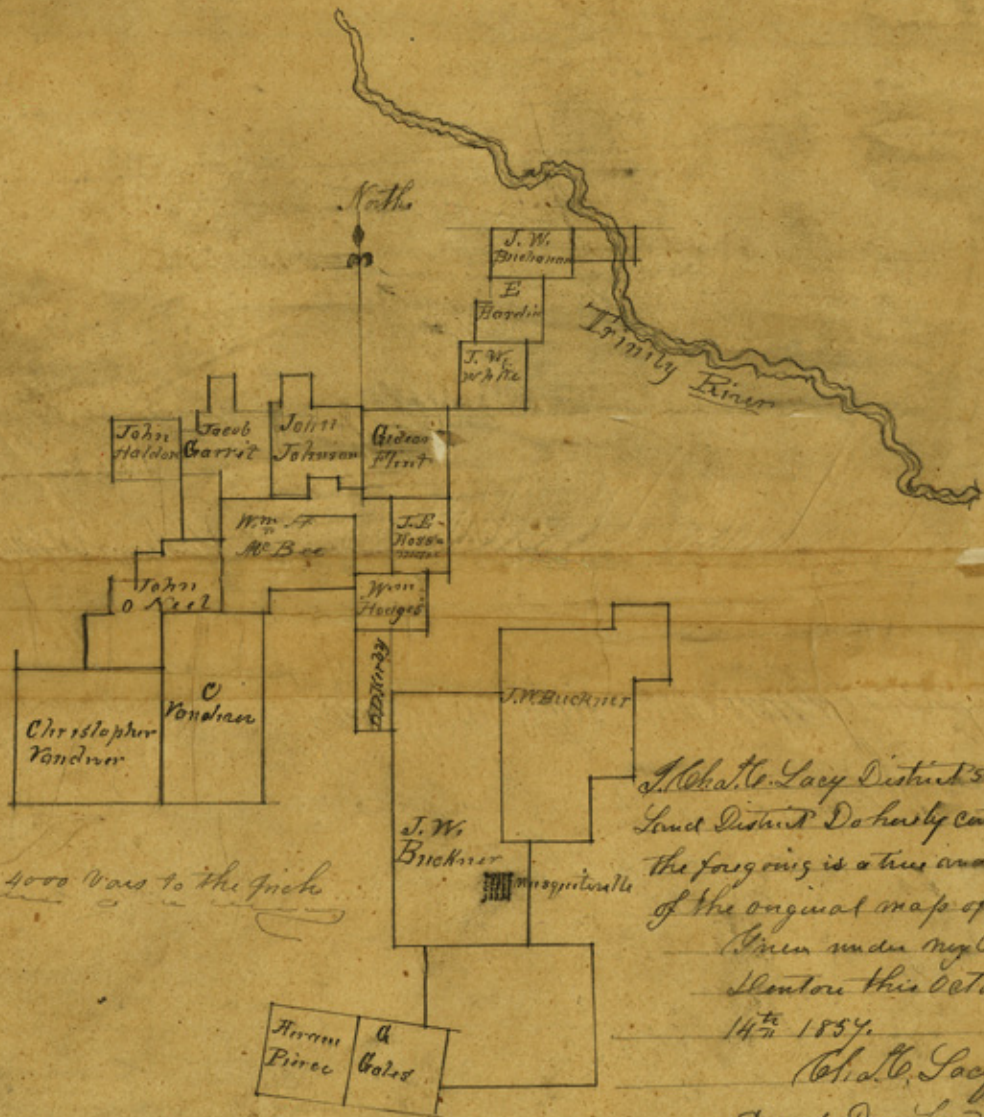

Scale of 4000 Yards to the Inch

Chas. C. Lacy District Sur of Deu
 Land District Do hereby certify that
 the foregoing is a true and correct copy
 of the original maps of this office
 given under my hand at
 Stanton this October the
 14th 1854.

Chas. C. Lacy Distric
 Sur of Deu Land District

counter 27542