

Montague Co.

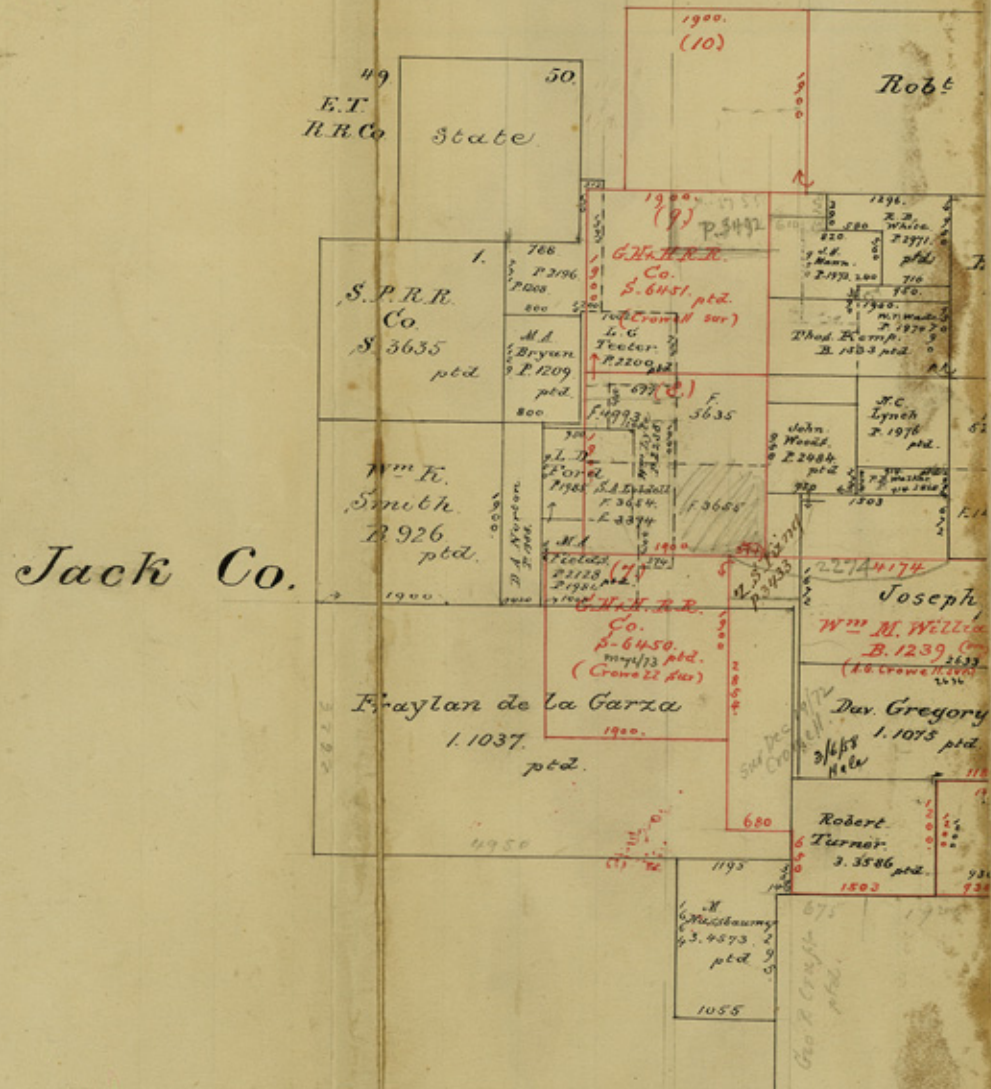

Jack Co.

T. Mellard
1. 983
ptd.

B.B.C.
R.R. Co.
S. 2401.
ptd.

F. 4118.
F. 1429.

Luce
1309
ptd.

Joseph Luce.
original survey of
H. 890. 590
1. 1309.
Jos. Luce.
ptd.
(Bl. ink show as ptd.)

Falls County
School Land.
1. 635
ptd.

Wise Co.

2633
1200
1433
70

Plotted Feb 11th 85.
H. J. J. J.

counter 27551

File 46.

25.16^a

Jack C^o

NE. of JACK & NW. of Wise.

N. E. corner.

New Sketch:

Jack & Wise

Co.s:

2/11/85.

See sketch p. 3433