

3.

Jackson Co

Atissue paper sketch and.
(see No. 7)

Sketches of Blocks 1, 2, 3.
& 4, I & G N R R Co.

Filed Nov. 2. 1875.

" May 13, 1876.

Block 3

Jackson County Tracts
Surveyed for
J. C. Dural & F. M. White

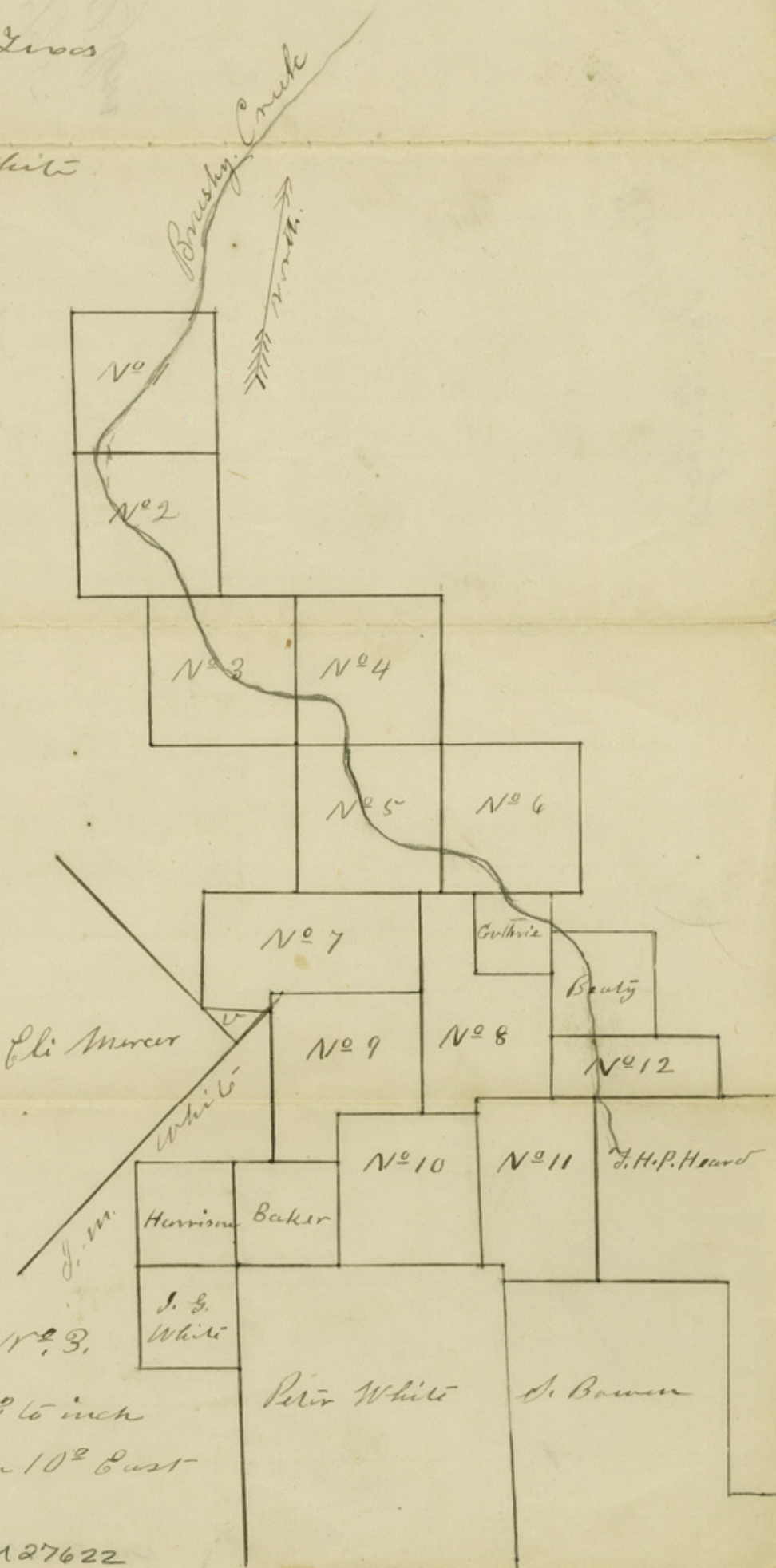

Block No 3,

Scale 2000th to inch
Variation 10th East

counter 27622

File

3

Jackson Twp

Block 3.

Sketch of Jackson Co Survey

Int'l G. & N. R.R. Co

Filed Nov 2 1895

J. Moore Esq.

Sketch of 13 Cross No 3.

120 Surveys of International R.R.
to Road Camps located in
Jacksons County

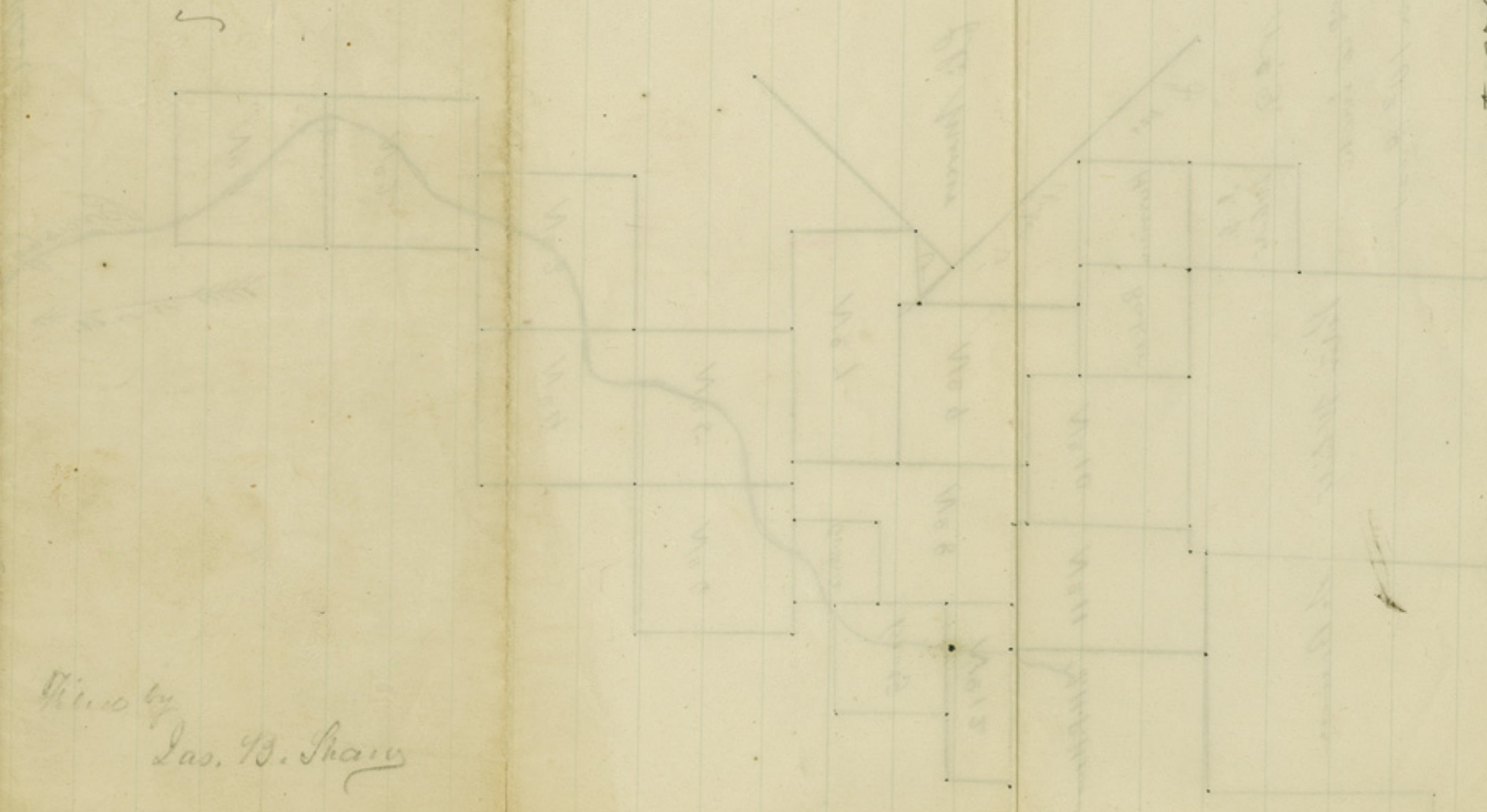

Drawn by
Geo. W. Shaw

counter 27623

Block 2



Jackson County Texas.
 Surveyed for J. C. Durnal

Block N^o 2. Scale 2000. var 10^o East.

File

3

Jackson Scrip

Block 2.

Sketch of Jackson Co Surveys

Walt & G. N. R. R. Co

Filed Nov 2/75-

J. P. Moore Comm

SKETCH FILES
JACKSON CO.

Sketch Block No. 2.

3 Surveys of Intersecting R.R.

B. Road Scrips located in

Jackson County

Filed by

Geo. W. Shaver

counter 27625



Block. No 4.

Jackson County Texas,
 J. C. Duval & F. M. White.

File 1

Jackson Geop.
Block 4

Sketch of Jackson Co survey

with G. N. RR line

Filed Nov 2^d 1875

J. P. Shaw

counter 27627

Sketch of Block 40-44.

5 Surveys of International R.R.
Roads Geop. located in
Jackson County

Filed by
Jas. W. Shaw

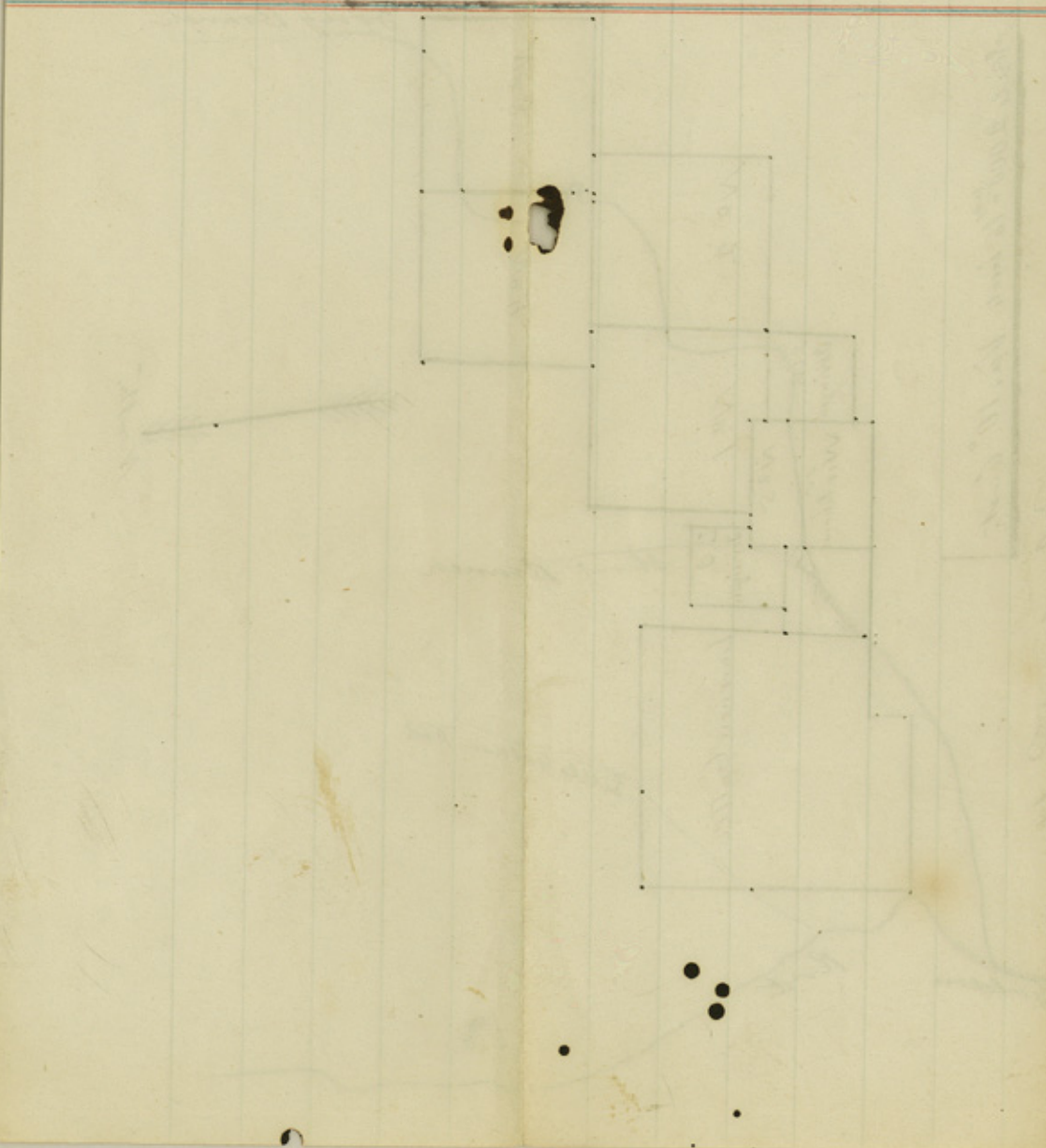

SKETCH OF SURVEY MADE FOR THE
I. & G. N. R. R. Co.
Jackson Co. Texas
Scale 2000 Vrs. = 1"



MAP
OF
Blocks 1. 2. 3 & 4
International & Great Northern Rail Road Company
in
Jackson County
TEXAS.
Scale 2000 Vrs. = one inch.



- Explanations.**
- Original Corners found.
 - ◊ Iron pipes 3" x 1/4" with Block & Survey numbers.
 - ◊ Bois d'arc stakes " " " "
 - Survey lines " " " "
 - Block lines " " " "
 - County Road.

N. P. Putnam, County Surveyor Jackson County, Co. Henry C. City, that the above map is a correct & true location of the R.R. Survey of I. & G. N. R. R. Blocks 1, 2, 3 & 4, in Jackson County and recorded in Book of Page 33, in my office, Aug. 15th 1894. Commencing from the file notes of which are herewith returned by me to the General Land Office. R. P. Putnam, County Surveyor Jackson County.

Sketch File No. 3
County Jackson
"OVERSIZE"