

J. C. Christy,

County Surveyor.

3611

Edna, Tex., March 30th 1898

Hon. Andrew J. Baker,
Austin Tex.,

Dear Sir:-

Attached you will please find
a tracing showing the situation in
connection with the following surveys
situated on the waters of the Chickadee
and Arinosa Creeks, in Jackson Co.,
Van Vleet - Isaac - Thomas - Schully -
and Burton -

There is an error in the 5th call
of the Schully Patent - in the field notes on
record in this office the call is N 55° E 290
varas and in the patent 950 - 4 - You will
see by referring to the acreage in these
5 surveys that they fall short - Mr Putnam
the former County Surveyor subdivided these
surveys as shown on plat some 4
years ago - and I wish to know how you
will correct this error will you allow
the correction if the parties will surrender
the patent & c

counter 27653

J. C. Christy,

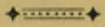

County Surveyor.

Edna, Tex., _____ 189

or will they have to purchase this strip
Please advise me how to correct
this and oblige

Yours very truly
J. C. Christy.

J'

counter 27659

In regard to the Jno Shultz (vic D-161) have to say that the field notes & the patent call for the 5th line to be 950 rs long. It appears however that said call was formerly something else (probably 290 rs) but if so it was erased, & 950 rs, written instead. As the said sur is now patented to 950 rs it will have to go that distance, & to stop at 290 rs, as shown on your sketch of re-survey & subdivisions, would include a strip of land 660 rs wide that does not appear to belong to said survey.

Also it does not seem that the Shultz, Lot Thomas (D-159) Elisha Bruton (D-158), Lot Van Vechten (D-160) & No Isaacs (D-157) are in conflict with any other surveys, and hence

Sketch File 10
Jackson Co

there is no authority for canceling the patents. The fact that said surveys are found to be short in area would not authorize cancellation of said patents.

4/6/98

Hill

(When reported, return this letter to Deftons Dept to attach to sketch No 10)
Jackson Co.

Reptd 4/7/98 John

J²

counter 27655

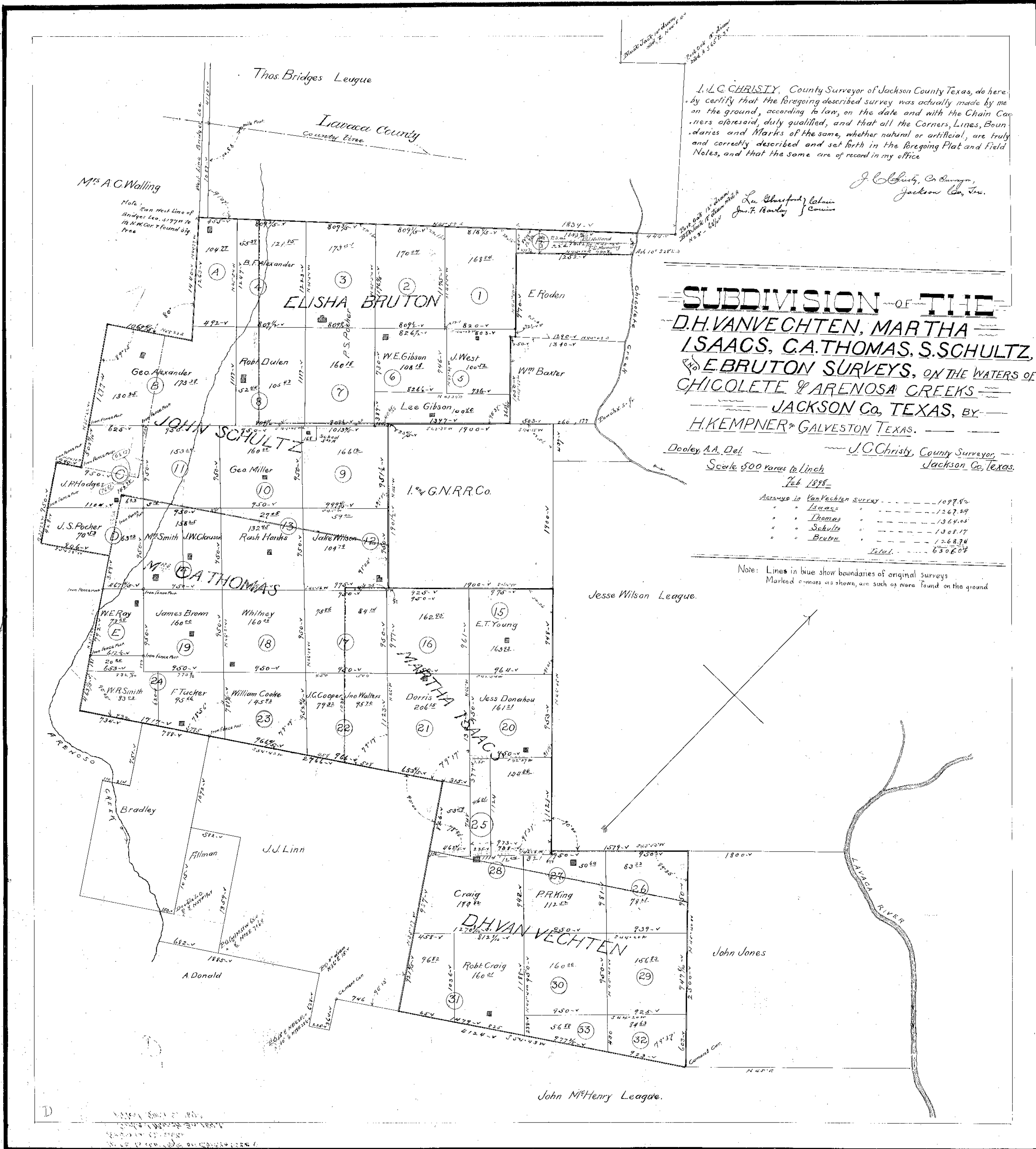

J. L. CHRISTY, County Surveyor of Jackson County Texas, do hereby certify that the foregoing described survey was actually made by me on the ground, according to law, on the date and with the Chain Carriers aforesaid, duly qualified, and that all the Corners, Lines, Boundaries and Marks of the same, whether natural or artificial, are truly and correctly described and set forth in the foregoing Plat and Field Notes, and that the same are of record in my office.

J. L. Christy, Co. Surveyor,
Jackson Co., Tex.

La. Christy & Co.
Surveyors
Jan. 7, 1898

SUBDIVISION OF THE
D. H. VANVECHTEN, MARTHA
ISAACS, C. A. THOMAS, S. SCHULTZ,
E. BRUTON SURVEYS, ON THE WATERS OF
CHICOLETE & ARENOSA CREEKS
JACKSON Co., TEXAS, BY
H. KEMPNER GALVESTON TEXAS.

Dooley, A. A., Del. J. L. Christy, County Surveyor,
 Jackson Co., Texas.

Scale 500 yards to Inch
 Feb 1898

Acreage to VanVechten Survey	1097.84
Isaacs	1267.29
Thomas	1364.45
Schultz	1308.17
Bruton	1248.74
Total	6596.59

Note: Lines in blue show boundaries of original surveys
 Marked corners as shown, are such as were found on the ground

500
 100
 50
 25
 10
 5
 2
 1