

Variation $11^{\circ}40' E.$

Block 1 G.H. & S.A. Ry. Co.

JEFF DAVIS Co.

Scale 2000^{Yrs} to 1 Inch.

9341
To
9346

10492

4917 205972

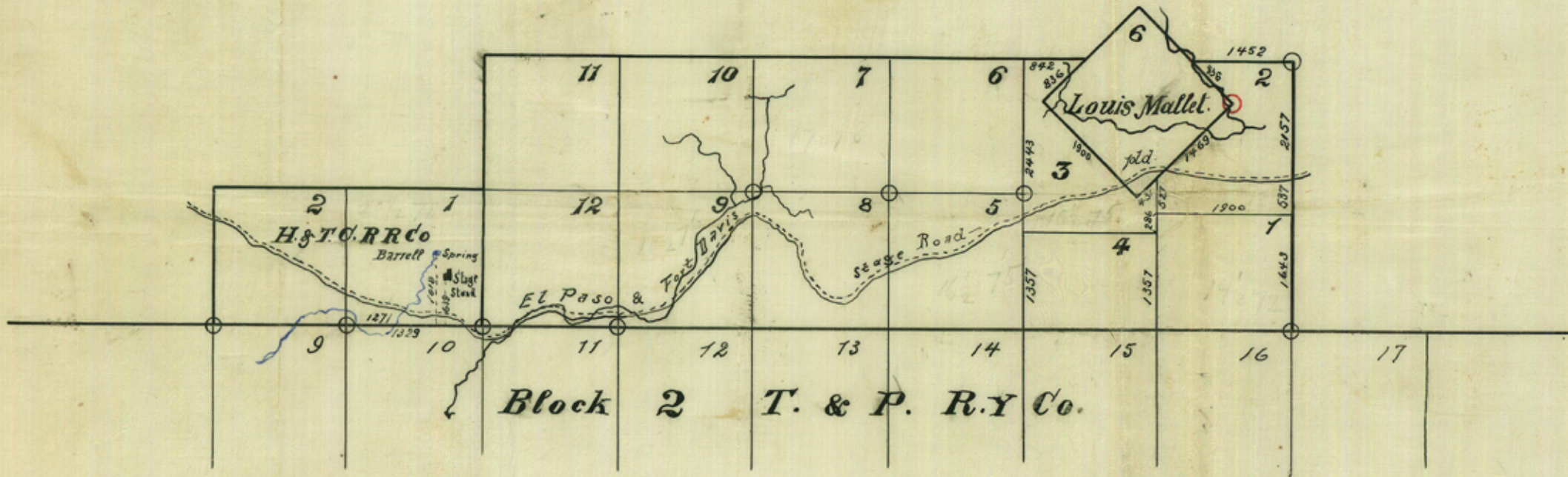

I *W.D. Mabry* State Surveyor do hereby certify that the foregoing
 is a correct Map of Block 1. G. H. & S. A. Ry Co. & also of Surveys
 No 1 & 2. H & T. C. Ry Co, as resurveyed by me in the months
 of January & February 1889

Given under my hand this 12th day of May 1889

W.D. Mabry
 State Surveyor.

See large sketch rolled, also
 Sketch in Besan. P-9347 & S-7080 $\frac{1}{2}$
 To See also S-10492 Barrell Spring survey *W.D. Mabry*

counter 27893

Connecting Line

1 Fort Davis To Barrel Spring -

2 Beginning at a white lime stone the south east
3 corner survey no 6 in the name of A. S. Lewis -
4 Thence with Variation $11^{\circ}30'$ East.
5

6 $467^{\circ}30'$ W - 6245 bars to pile stone and
7 cedar post in ground for north west corner section
8 1 Blk 7 St 4th P. C. Ry Co, whence a large
9 boulder on north slope of Hill brs S44 $\frac{1}{2}$ W -
10 and left hand boulder of large natural rock
11 mound on south west slope of Hill, brs North
12 $30\frac{1}{4}$ W -

13 Thence South at 480 bars El Paso road - at
14 1140 bars another road - 1900 bars 7 large
15 stone in ground for South west cor' 1 said
16 block 7, whence south point of Flat Moun-
17 -tain brs N47 $\frac{3}{4}$ E and lone tree on top
18 of low round Hill east of twin mountain
19 brs S37 $\frac{3}{4}$ E -

20 Thence South 1900 bars pile stone south
21 west corner 17 Blk 7 St 4th P CRR Co -
22 Thence South at 3400 road at 14000 Maja
23 road, at 19000, 4 staves set in ground for
24 South west corner 13 said block 7, whence
25 a lone tree on rim rock of low mountain
26 brs S78 W and east bluff of Hill brs N20 $\frac{3}{4}$ W

1 27 Thence West at 7000 Maja Road 19000 point.

2 28 Thence West 19000 point.

3 29 Thence West 19000 point.

4 30 Thence West 19000 point.

5 31 Thence West 19000 point.

6 32 Thence West at 100^{roads} at 19000 point.

- 1 Thence West at 1000^o a draw course southeast-
- 2 at 1619^o point in road. (Local attraction 1°15')
- 3 at 1900^o point.
- 4 Thence West at 1151^o point in road at 1900^o point.
- 5 Thence West at 1600^o point on rocky hill
- 6 at 1900^o a large pile stone and a live
- 7 oak post. the southwest corner section 10
- 8 Block 1 for Pth P. Ry. Co
- 9 Live live oak post being 8680 Varas South ⁹me
- 10 77587 Varas West from the South East corner
- 11 of the A. S. Lewis survey-
- 12 Thence West 1900^o to N. W. cor 18 Blk 2 P. Ry. Co
- 13 Thence West 1900^o Rock Mound.
- 14 Thence North 1900^o Rock Mound on west
- 15 edge of road for N E cor, Blk 1 G. & S. P. Ry. Co
- 16 Thence North at 280^o El Paso Road (west)
- 17 at 314^o fence at 1900^o small pile post
- 18 for N E corner 2, whence a fence post which
- 19 \bar{x} on N.W. side \bar{x} brs N 80 E 39^o and east point of
- 20 Anvil shaped boulder \bar{x} brs N 1 1/2 E about 3/4 of mile
- 21 Thence S 55° 37' W at 1045 to a large pinion stump
- 22 on east bank of creek, the east corner of the
- 23 Lewis Mallitt survey, whence a live oak stump
- 24 10" dia and mature with 3 large backs (remaining
- 25 marks gone) \bar{x} brs S 79° N 9 1/2^o and a small pinion
- 26 tree 8" dia \bar{x} brs N 10 1/2 W 34^o and a live oak
- 27 \bar{x} 70" dia \bar{x} brs S 80 1/2 W 30^o.

(M)



Fe²

1 Beginning at N.E. corner section 2 Blk 1 G.H. & S. Ryce
 2 the same being a small pile of pebbles - (A)
 3 thence south 1199 varas point.
 4 thence West 1900 varas point. whence a double live oak
 5 tree $\text{mkd } \bar{x}$ on E. side $\text{brs } N 85^{\circ} \frac{3}{4} E 19^{\circ}$ and a do
 6 $\text{mkd } \bar{x}$ on S. W. side $\text{brs } S 80^{\circ} E 39^{\circ}$ and
 7 thence south 701 varas a large rock monument
 8 near top of mountain for south West corner 2 Blk 1.
 9 thence West 1900 varas a large rock mound the S.W.
 10 cor 3. whence a stubby live oak tree 70° dia \bar{x} $\text{brs } N 87^{\circ} W 93^{\circ}$
 11 10° dia \bar{x} $\text{brs } S 7^{\circ} E 61$ varas -
 12 thence West 1900 varas a mound of red rock
 13 for N.E. cor 8 whence a large Cedar \bar{x} $\text{brs } S 26^{\circ} \frac{1}{2} W$
 14 $167^{\circ} \frac{1}{2}$ and a do 10° dia $\text{brs } S 23^{\circ} W 167^{\circ} \frac{1}{2}$ -
 15 thence West at 1590 varas branch course (S.W.)
 16 at 1900 varas a rock mid N.E. q whence a spreading
 17 live oak tree $\text{brs } N 48^{\circ} E 715$ varas
 18 thence S 45 W 7688 varas - pile stone S.W. q Blk 1
 19 whence a large rock monument on top of
 20 mountain $\text{brs } East$ about $\frac{3}{4}$ mile and a lone
 21 tree on top of mountain $\text{brs } N 30^{\circ} \frac{3}{4} E$ and a
 22 rock ledge on north side of mountain $\text{brs } S 84^{\circ} \frac{1}{4} W$
 23 thence West 1900 varas to a large rock mid on north
 24 bank of creek for south West corner 12 Blk 1 G.H. & S. Ryce.
 25 thence West 1900 varas and built a large pile rock
 26 for S.W. cor section 1 Barrell Spring survey, whence
 27 a rock monument on hill $\text{brs } S 1^{\circ} \frac{1}{2} E$ and from
 28 - next quartz ledge or boulder $\text{brs } S 38^{\circ} \frac{3}{4} E$ about
 29 700 varas and a lone tree on grassy mountain $\text{brs } N 69^{\circ} E$
 30 and Barrell Spring is 1018 varas North and 1271 East.
 31 and the old stage stance is 1329 varas East and 639 varas North
 32 This corner is 8680 varas south and 396870 varas West from the
 South east corner of the P. S. Lewis survey at
 Fort Davis -

1 Barrel Spring to El Muerto Spring -
 2 Beginning at Rock monument built for
 3 southwest corner section 1 Barrel Springs
 4 survey -
 5 thence West 1900 bars to large rock monument
 6 the southwest corner of 7th & 4th P. C. R. Co. and
 7 the northeast corner of Block 7 P. C. R. Co.
 8 thence West at 1308^o a large rock monument
 9 on top of hill for line monument at 1900 bars
 10 rock monument for southwest corner section
 11 1 Block 7 G. N. & S. P. Ry. Co -
 12 thence West 1900 r^s rock mound south west
 13 corner of Block G. N. & S. P. Ry. Co -
 14 thence West 1900 bars rock mound and live
 15 oak post the south east corner of 1 Block 3
 16 N. & P. C. R. Co. whence a sharp knoll on
 17 top of mountain b^rs N 63 1/4 E and a sharp
 18 top mountain b^rs N 37 3/4 W -
 19 thence West 1900 r^s pile rock south west corner
 20 1 said block 3
 21 thence West 1900 r^s pile rock south west cor-
 22 -ner of said block 3.
 23 thence West 1900 r^s md ^{3/4} small circular trench
 24 the southwest corner of said block 3 -
 25 thence West 1900 r^s md and small circular
 26 trench southwest corner 28 said block 3 -
 27 thence West 1900 r^s md ^{3/4} four pits and a
 28 live oak post 6" dia for south west cor-
 29 -ner of said block 3. whence Livermore's rock
 30 monument on boulder Peak b^rs N 60 E -
 31 and a sharp Peak b^rs N 0^o 15' W -
 32 thence North 1900 r^s md and circular trench
 see page 5

te 4

Page 5

1 for the northwest corner of said Block 5
 2 Thence North 1900 rods to mound and circular
 3 trench the south west corner 31 said Block 3 -
 4 Thence North at 460 rods branch (course sw)
 5 at 1900 rods and circular trench southwest
 6 corner 32 said Block 3 -
 7 Thence North at 70 rods Valentine ^{3/4} Port Davis
 8 road at 1900 rods earth and stone mound south
 9 west corner 33 said Block 3 - whence monu-
 10 ment on Boulder Peak bears $N 75^{\circ} 15' E$ and
 11 a sharp Peak bears $N 0^{\circ} 70' N$
 12 Thence North 1900 rods mound and circular
 13 trench the south west corner 34 said Block 3 -
 14 Thence North 1900 rods and circular trench the
 15 south west corner 35 said Block 3 -
 16 Thence North at 400 rods a draw, at 950 rods south
 17 edge of brush thicket, at 1600 rods north edge of
 18 said at 1900 rods mound and circular trench
 19 south west corner 36 said Block 3, whence
 20 a monument on Boulder Peak bears $N 87^{\circ} 45' E$
 21 and sharp top mountain bears $N 1^{\circ} N$
 22 Thence North at 1130 rods a branch (course sw)
 23 at 1900 rods and circular trench southwest
 24 corner 37 said Block 3 -
 25 Thence North at 77 rods road (course sw) at
 26 1900 rods mound and circular trench corner
 27 - 38 said Block 3
 28 Thence North at 1010 rods a pine stake 4" dia
 29 at 1030 a wire fence course E & W at
 30 1900 rods a live oak post 6" dia, whence
 31 a monument on Boulder Peak bears
 32 $S 79^{\circ} 35' E$ and a sharp top mountain bears

Fe⁵

1 N² 70' W

2 Thence East 1900 Varas Mound and Circular trench
3 the North east corner 38 said Block 3.

4 Thence East at 664^r the top of hill at 1668^r

5 El Paso road, at 1900^r earth & stone mound
6 for the North East corner of 19 said Block 3.

7 whence the south edge of prominent bluff

8 bns N 43 1/2 E and top of low round hill bns

9 N 15° 45' W and top of mountain bns N 39° 15' W

10 From this corner the old stage stance at El Muerto

11 Spring is 831 Varas north and 1489 Varas East -

12 And El Muerto Spring is 779 Varas north and

13 1711 Varas East -

14 said corner is also 10320^r north and

15 52987 Varas West of the South East corner of

16 the A. S. Lewis survey at Fort Davis -

17
18 Line to Van Horns Hill

19 Beg at Circular trench and live oak post for

20 North west corner 38 Blk 3 and South East

21 corner 6 Block 4 both blocks made for

22 Houston & Texas Central Ry Co -

23 Thence North at 1570^r El Paso road course west.

24 at 1900^r mound and four pits south east corner

25 5 said Block 4

26 Thence North at 560 Varas El Muerto Draw

27 course south west at 1900 Varas Rock mound

28 South east corner 4 - said Block 4 -

29 Thence North at 996^r line monument

30 at 1900^r rock mound south east 3 said

31 Block 4 -

32 Thence North 1900^r rock mound the south

- 1 east corner 7 saice block 4 -
- 2 Thence North 1900^{rs} rock monument - south
- 3 east corner 1 saice block 4
- 4 Thence North at 740^{rs} an arraya (course SW)
- 5 at 1900^{rs} Rock mound the North east corner
- 6 1 saice block 4
- 7 Thence West 1900^{rs} mound and circular trench
- 8 the North West corner 1 saice block 4 -
- 9 Thence North 1900^{rs} aras mound and circular
- 10 trench the North east corner 67 saice block 4
- 11 Thence North 1900^{rs} aras Rock mound for North
- 12 east corner 68 saice block 4 -
- 13 Thence West 1900^{rs} Rock mound for North
- 14 west corner 68 saice block 4 -
- 15 Thence West 1900^{rs} mound and four pits the
- 16 North West corner 69 saice block 4 -
- 17 Thence North 1900^{rs} mound and circular trench
- 18 the North east corner 139 saice block 4 -
- 19 Thence North at 540^{rs} dino wagon road (course NW)
- 20 at 1900^{rs} md and four pits North east corner 140
- 21 saice block
- 22 Thence West 1900^{rs} aras mound and four pits
- 23 the North east corner 141 saice block 4
- 24 Thence West 1900^{rs} mound and four pits
- 25 for North east corner 714 saice block 4
- 26 Thence West 1900^{rs} mound and four pits for
- 27 North east corner 715 saice block 4
- 28 Thence West 1900^{rs} pile stone at foot of hill
- 29 for North east corner 786 saice block 4 whence
- 30 a rock knob on hill brs N 7³/₄ W and a standing
- 31 boulder brs S 10° 30' W -
- 32 Thence West at 1370^{rs} draw (course north)

1 at 1418^{rs} a road course north at 1900^{rs} pile
 2 stone for north east corner 287 said block
 3 Thence West 1415^{rs} road course NW. at 1900^{rs} a
 4 pile stone for north east corner 350 this block
 5 whence another pile stone 38^{rs} East 38^{rs} East and North
 6 10^{rs} Varas.

7 Thence West at 675 line monument on rocky
 8 ridge at 1900^{rs} pile stone for north east corner
 9 351 said block. whence another pile stone 38^{rs}
 10 East 38^{rs} East. and north 13^{rs} Varas.

11 Thence West 1900^{rs} mound ^{1/4} four pits for north
 12 east corner 386 this block whence a rock mound
 13 39^{rs} East 39^{rs} East and north 10^{rs} Varas.

14 Thence West 1900^{rs} Varas pile stone for north
 15 east corner 387 whence a pile stone 40^{rs} East
 16 40^{rs} East and north 10^{rs} Varas.

17 Thence North 1900^{rs} small pile stone
 18 Thence N 45th at 2400^{rs} Varas draw in valley. at
 19 7688^{rs} point.

20 Thence N 45th W at 891 branch (course N.E.) at
 21 7688^{rs} point.

22 Thence N 45th W 675^{rs} Varas point in line road -
 23 Thence West 1900^{rs} point.

24 Thence West at 760^{rs} road in draw (course west)
 25 at 974 small pile stone whence a well & vine
 26 mill 38^{rs} S 47th N 450^{rs} Varas. at 1098 Draw
 27 (course S 78th W) at 1900^{rs} point.

28 Thence West 1473^{rs} point.

29 Thence West 1900^{rs} point.

30 Thence West 1900^{rs} point.

31 Thence West 1900^{rs} point.

32 Thence West 1900^{rs} point.

- 8
te

1 Thence North 1473 Varas - to point.

2 Thence N45N 7688 - point.

3 Thence N45W 7756 - point.

4 Thence S53° 56' N at 1040^{rs} G. N. & S. Ry track
5 at 2470 El Paso road at 7867 - point.

6 Thence S57° 50' W 187 Varas to the north east
7 corner of the old adobe house, the stage stone
8 at Vau Horns well - whence well brs N75W
9 193 Varas -

10 Thence N46E 1086 Varas to 7 stone suppose to
11 be the North east corner of survey 337. Known
12 as the Vau Horns well survey. From this stone
13 pile 7 more stones brs south 77 Varas - the
14 stone pile further north fits but for direction
15 from corner of old adobe house - but both
16 are excessive as to measurement.

17 Thence N84° 46' E 791 - to point.

18 Thence South 1900 Varas point.

19 Thence South at 1080 Varas El Paso road (N47S E)
20 at 1900 - point.

21 Thence South 1900 - point.

22 Thence South 1434 Varas point.

23 Thence N86° 35' E 787 Varas to rock monument
24 established by Paul McComb for the south line
25 of the P. & O. Ry 80 mile reserve -

26 Above line is transit line from Fort Davis
27 and by comparing it with McComb's line as
28 shown by his two monuments, find a
29 difference between this line and his of ~~his~~
30 of 28 minutes - Variation of needle on McComb's
31 line 11° 45' E - (Young's sans mountain transit) and
32 11° 53' E on "above" line - " "

1 Thence $S89^{\circ}34'E$ 581 Varas ^{with McComb's line} to Monument No 2

2 Built by McComb.

3 Thence $S89^{\circ}34'E$ at 480 rs Van Horns creek
4 (course north) at 1900 rs point.

5 Thence $S89^{\circ}34'E$ at 478 Varas rail road
6 course of road by angle from McComb's line
7 is $N70^{\circ}9'W$.

8 I hereby Certify that the above
9 and foregoing is a true and correct copy
10 of notes made by me of a line run from
11 Fort Davis to Van Horns creek during
12 the months of January, February ^{and} March
13 1889. Witness my hand this 24th day April
14 1889

N. S. Mabry -
State Surveyor.

No # 12⁴

Jeff Davis Co

Sketches

Filed May 20/89

R. H. Hull
Chief Clerk

W. S. Mabry's SK, connections
& explanation of BIK-1, H &
GNRY Co,

January, 1889.

Filed May 20, 1889-

Certificate of

Line from

Fort Davis to

Barrel Spring

El Muerto Spring

and

Van Horns well

W. S. Mabry
State Surveyor

Fe