

£ 3

Office SK. on South bank of  
Neches River, near its mouth.

Dated January 24, 1849,

counter 28097

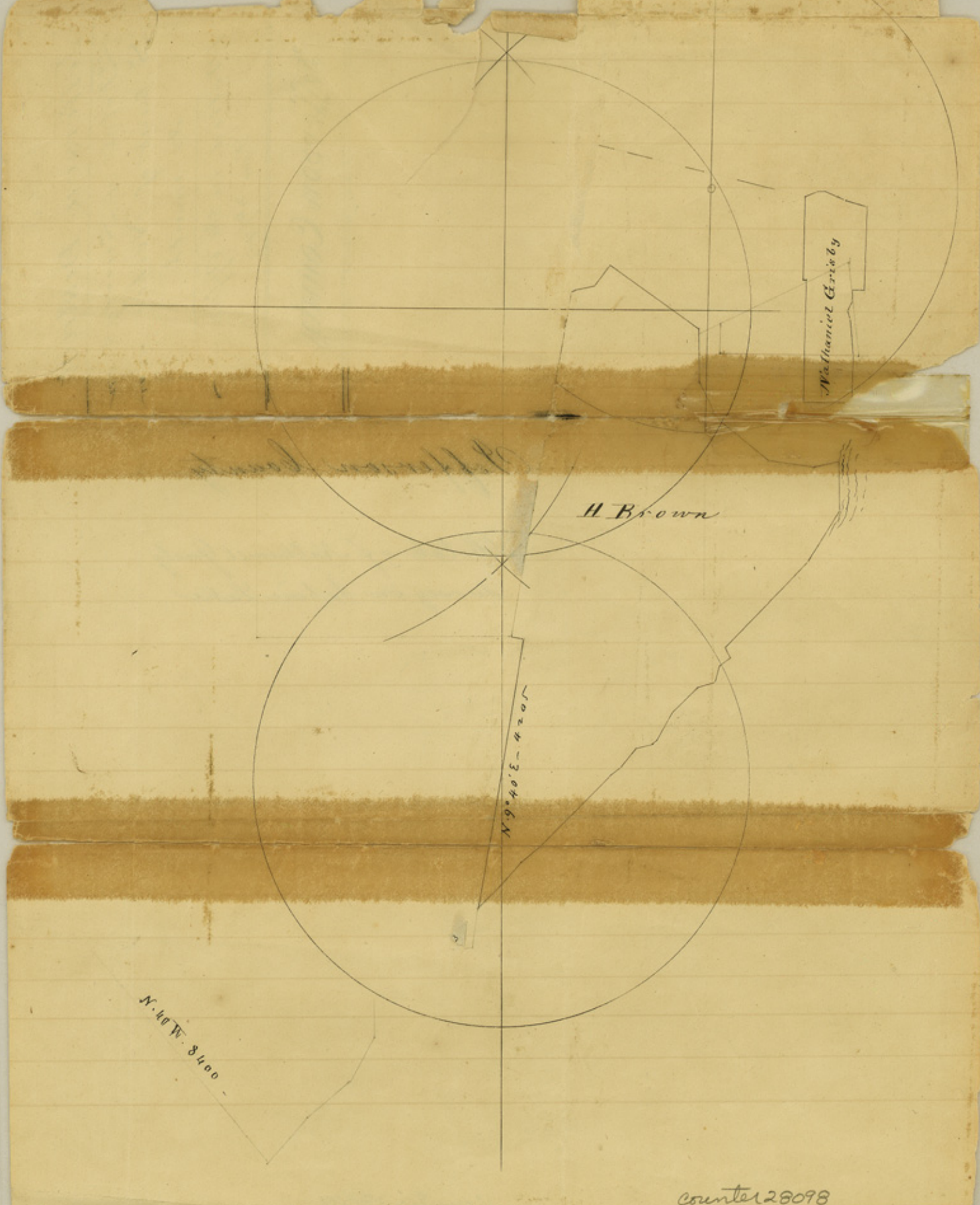

Walton's Crisby

H. Brown

N 9° 40' E - 4205

N. 40° W. 8400

counter 28098

+

File 3

Jefferson District

Sketch of Surveys on  
S. bank of Neches - near  
its mouth.

Plotted in the Office  
Jan 24/49

Jefferson County

Jefferson County

Sketch of Nathaniel Gruby  
Survey on Sabine Lake

County 2809

Grady's  
College

877 E 8550 vs

The F. M. Binny

Joseph G. Griston

0507.3

5879

4182

N. 45° 10'

N. 9°

55° 30'

Counter 28100