

Sk File No. 12

Jefferson County

School Lands

Field Notes

Filed _____ 19____

J. H. Walker, Com'r

File Clerk

Correct on Map for _____ Acres

Sk. File 12 A&B

Jefferson County

Position of the P. Humphreys, J. W. Bullock and John A. Veatch leagues S.E. of Beaumont.

Filed September 26, 1862

"Sketch and Statement" (File 12)
Found in Boundary Files
Jefferson County, and returned
to Sketch Files - 4/6/31
Clark

counter 28/35

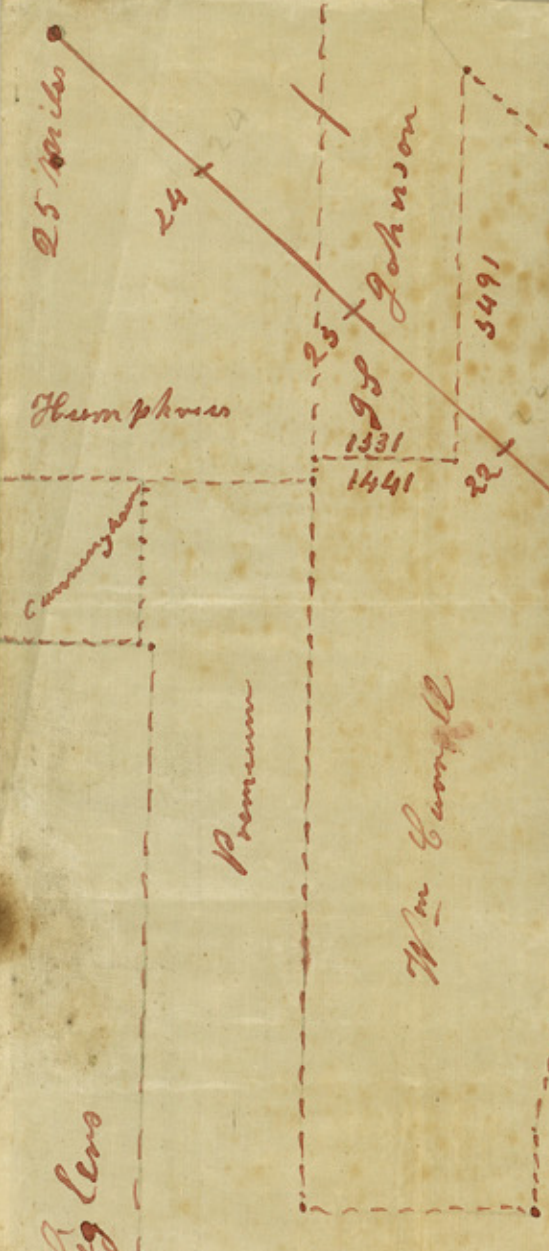

I herewith send you a sketch of some lines & their connections with the Gulf RR as run by me, in the sketch the Road is divided into miles the Stations are given in the field notes of each Survey sent up by me

James Ingalls Surveyor
Jeff Co

counter 28136



Jeff Co
Jefferson County

counter 28137

9 miles from Sabine Pass Depot



2.5 miles

Humphreys

Johnson
1331
1441

5491

Big lens

Premium

Wm Campbell

Montee

Wells

Stamps

Wm Long The

Mr Kinney

Swiggly

Stamp

Stamp

802 station

Stamps
640

Butler

Hanks

Stamps

Brown

750

Lake

Stamp

Jefferson county
L. J. ...
Wm P. ...

9 miles from Sabine Pass Depot

counter 28137

File 12. (b)

Jefferson County.

S.E. part.

Filed August 9. 1862

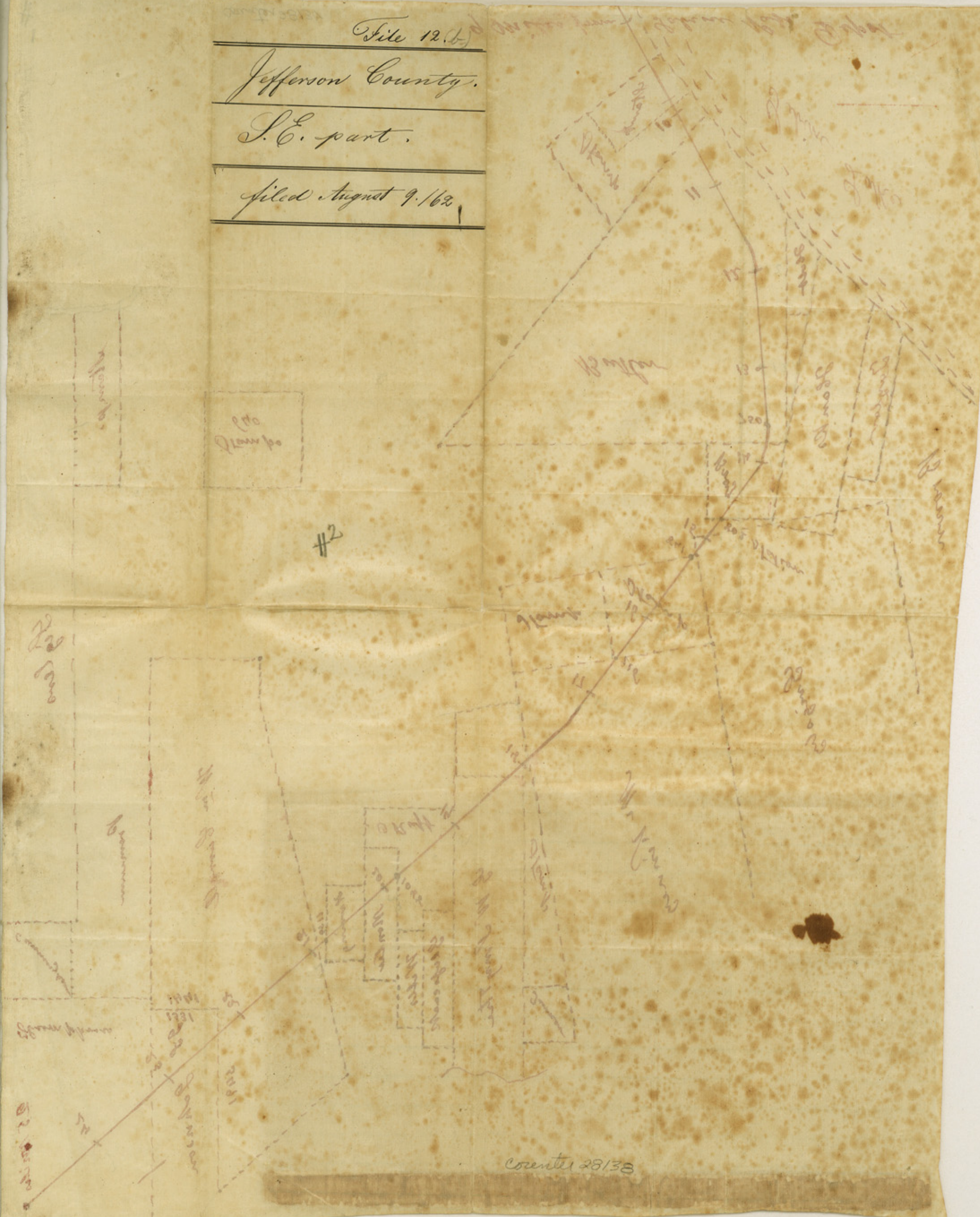

Coventry 28138

Genl Land Office.

Austin Oct. 7th 1862.

James Ingalls, Esqr.
Beaumont.

Dear Sir.

Yours of the 21st ult. accompanying sketch has been received.

The field notes of Wm. Carr's League are recorded in Book A. page 1, the field notes of 194 acres survey in its north end by virtue of B. B. B. & Co. R. R. Scrip, are not recorded. It seems, this is the survey alluded to as being cut from Carr's League. J. D. Shaw is not on our registers, the survey north - - - Blackburns is in the name of E. Shaw and is on file - - office.

The facts set forth by you as represented by the sketch sent up, will, I think, be sufficient to make a vacancy b/w. A. Veatch & R. H. Humphrey's surveys.

Yours Very Respectfully,
J. Crosby.

GENERAL LAND OFFICE, AUSTIN, TEXAS, May 24th 1890.

I, Charles Rogan, Commissioner of the General Land Office of the State of Texas, do hereby Certify that the above and foregoing is a true and correct copy of the imprint of a letter as appears on page 217 of letter book Vol. No. 82, which said volume is kept as an archive of this office,

IN TESTIMONY WHEREOF, I hereunto set my hand, and affix the impress of the seal of said office the date last above written,

Charles Rogan
Commissioner General Land Office.

Beaumont Sept 21st 82

Mr S. Crosby

Dear Sir

I herewith send you a sketch of some work that I have been doing in the Prairie below Beaumont, I commence at Siglers S.E. Corner & run a line North 12.50⁰⁰ to his N.E. Corner then West 19.8⁰⁰ to Cunningshams S.E. Corner then North 1500⁰⁰ to Cunningshams N.E. Corner continue same line North ~~500~~⁵⁰⁰ then West 95⁰⁰ to P Humphries 1st Corner on this line from Taylors Bayou Marsh to Humphries North line we set poles or long stakes each thousand rods, We then begin at Charles Williams S.E. Corner & run East 260⁰⁰ to Dr Stivers N.E. Corner then South 500⁰⁰ to a long post in the corner of J. Karnes Survey then East on Bullocks South line 10043 rods to the edge of the Naches marsh at the lower edge of the Spindle top timber then reversed the courses of Bullocks meanders N 77° W 200 rods West 190 rods - N 72° W 400 rods these courses followed the marsh and being satisfied that they would all do so, I returned to the Corner and Run S 74½° E 289 rods to P Humphries 1st Corner then North 198 rods to his second Corner on the marsh then East along the marsh & in the marsh 2300 rods to his N.E. Corner & I run out and divided his Survey) at Humphries first Corner a Tree called by some persons a Turkey Oak by others a Black Jack (of small leaf bears S 10° W 25 rods dist One foot in diam no marks perceptible & the only tree within 100 rods of this Corner this leaves a strip of land about 250 rods ^{wide} between Humphrey & Veatch, Will you be so kind as to inform me whether this strip

fieldnotes of Wm Carr's League are recorded in Book A page the fieldnotes of 194 are survey on its North end B.B.B & C.R. R 347 are not recorded, - it seems this is the survey alluded to as being cut off from Wm Carr's League in Vacant land & subject to location or will it go with Veaches as he calls for the line of the third Survey above Chambers' bluff Will you also be so kind as to inform me how much of Wm Carr's League was taken off of his old Survey on the North & South of P.D. Humphrey's

Blackman is a good survey or is it vacant

I James Ingalls Surveyor of Jefferson District do hereby certify that the lines described in the foregoing notes were made by me and are true as to Courses, Distances & Marks &c

Given under my hand at Beaumont this 21st day of Sept 1882

James Ingalls Surveyor
Jeff Dist

The facts as set forth above will be sufficient to make a vacancy between plots of Veatch & P. Humphrey's

P.S. Mr Marsh Chief Engineer of the Eastern Texas R.R (is now Boarding with and assisting me in regulating Connecting & Plotting the Surveys in this County) informs me that he made a map of his R.R and all of the Counties which it passes through as far as located and left it with the president of the Road to be sent to you but as soon as he can go to the press he will make another & send it to you, The County Court passed an order to pay you 17 Dollars for those field notes but the County Clerk has run away from the yellow fever & I cannot get the Draft I will send it as soon as he returns

J Ingalls
counted 28170 X

The name of E. Humphrey is not in my file of B. Blackman is in my file 2-8

92

12(a).
Sketch File No. 12 A.
Jefferson Co.

\$ 2.00

Letter to Ingalls
Vol 82 P. 17

12 (a)
See Sketch filed with
this - File 12

counter 28141

James W. Bullock.

The Rail Road Stations
are each 100ft in length
B.F. Marsh
Chief Engr
C. Tex R.R.

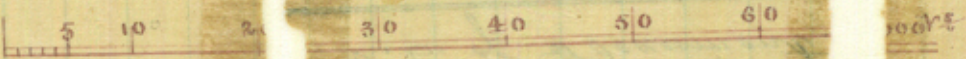
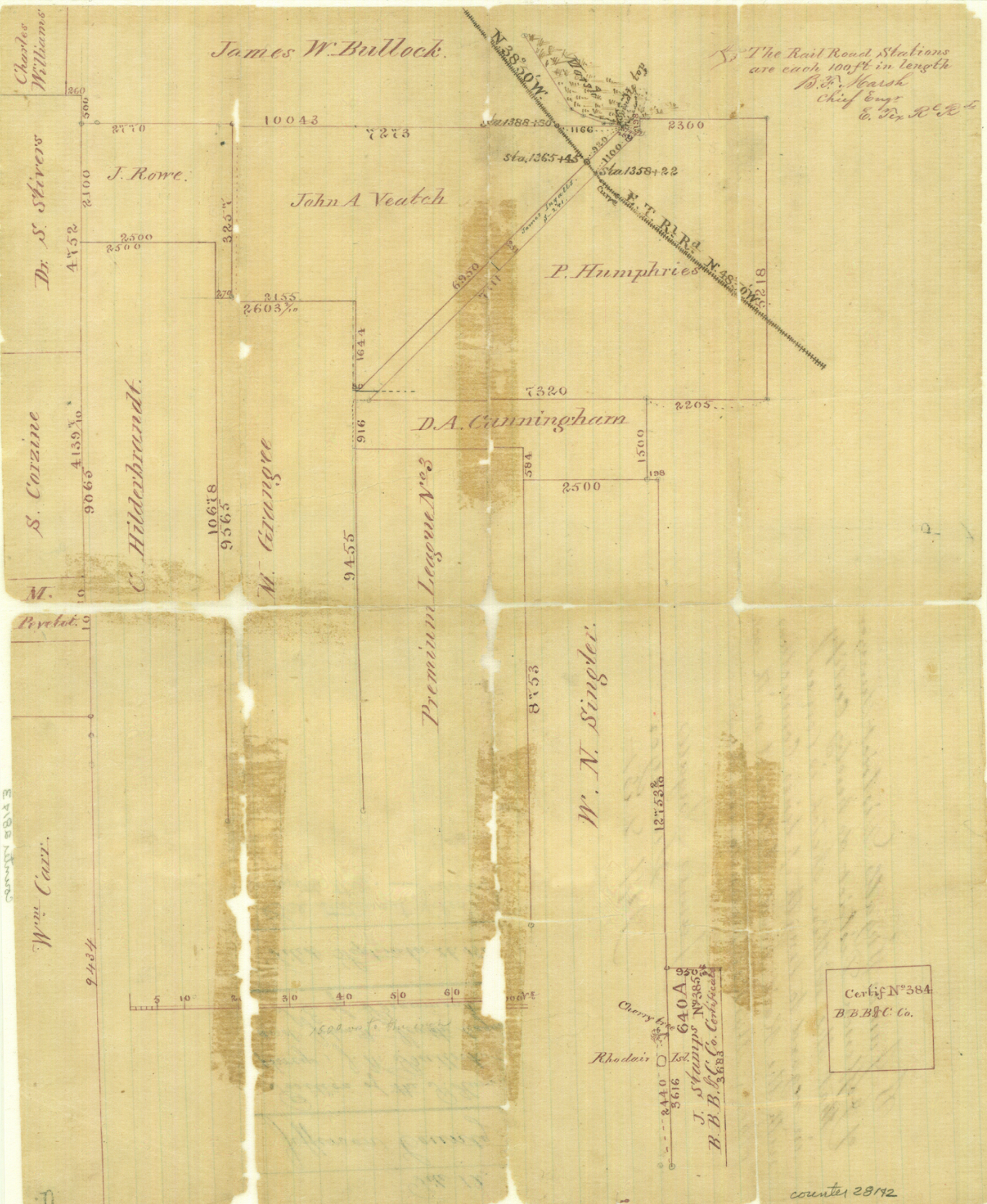

Cherry tree
Rhodair
640A
3616
J. Stamps No. 385
B.B.B.C. Co. Certificated

Certif N° 384
B.B.B.C. Co.

counter 28142

I James Ingalls District Surveyor
of Jefferson District do hereby Certify
that the within sketch is correct
in regard to length of lines connections
with the Rail Road Stations & with each
other. Marked, Beaumont &c.

James Ingalls
Surveyor
Jeff Dist

File 12.

Jefferson County

Location of the S. Hum-
phreys, J. W. Bullock
and John A. Peatoh Lines
S. E. of Beaumont.

Filed September 26. 1861

See statement filed
with this. — File 12 (a)

GULF PRODUCTION COMPANY

132

HOUSTON, TEXAS, Sept. 24, 1927.

F. L. BUFORD,
CHIEF ENGINEER

In Reply, Refer to File:

Hon. J. T. Robison, Commissioner,
General Land Office,
Austin, Texas.

Dear Sir:-

On the 12th and 13th instant Mr. Blakemore and I, assisted by Judge Clark, tried to find the correspondence and sketch we did not have pertaining to the Douthit and Ingalls Surveys in Jefferson County, Texas.

We have a copy of a letter from the commissioner to Jas. Ingalls, dated Oct. 7th, 1862, acknowledging receipt of his letter and sketch, etc. This we did not find-the sketch or the letter.

Yesterday, I saw a blue print of a sketch showing the position of the Humphreys, Bullock, Veatch, Douthit, Ingalls, and adjoining surveys. The following notation said on the back of the sketch:-

→ "File No.12 - Jefferson County
Position of the Pelham Humphreys,
J. W. Bullock, and J. A. Veatch
Leagues, SouthEast of Beaumont."
"Filed Sept. 26th, 1862."

This blue print is a certified copy out of the Land Office and was certified to by Chas. Ragan, Commissioner, May 24th, 1901.

Since this map was in the Commissioner's Office in 1901, I am inclined to believe it is still there and only perhaps misplaced, if not so then stolen. I will thank you very much to have another and thorough search made for this missing sketch. If you can not find same let me know, and if you do find sketch then please send me a certified copy of same.

RECEIVED

SEP 26 1927

REFERRED TO MAP

BP

counter 28144

Hon. J. T. Robison, Commissioner, Austin, Texas. (2)

Thanking you in advance, I remain

Yours very truly,

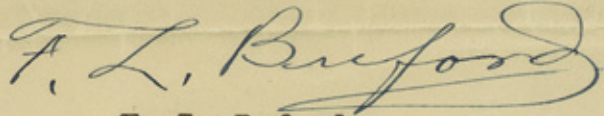

F. L. Buford.

FLB-WCB

P. S.

Address P. O. Drawer "C", Houston, Texas, but please have bill made to read Gulf Production Company, by F. L. Buford.

F. L. B.

counter 28146

GP

Sk. Files
Jefferson Co

1. 8.
Concominy
Copy Sk file 12

will make ready calli Production Company, by E. I. Buford.
Address P. O. Drawer "C", Houston, Texas; but please have

E. I. B.

E. I. Buford.

[Faint handwritten signature]

Yours very truly,

Thanking you in advance, I remain

Hon. J. T. Robinson, Commissioner, Austin, Texas. (2)