

RRR RRR

1825

1825

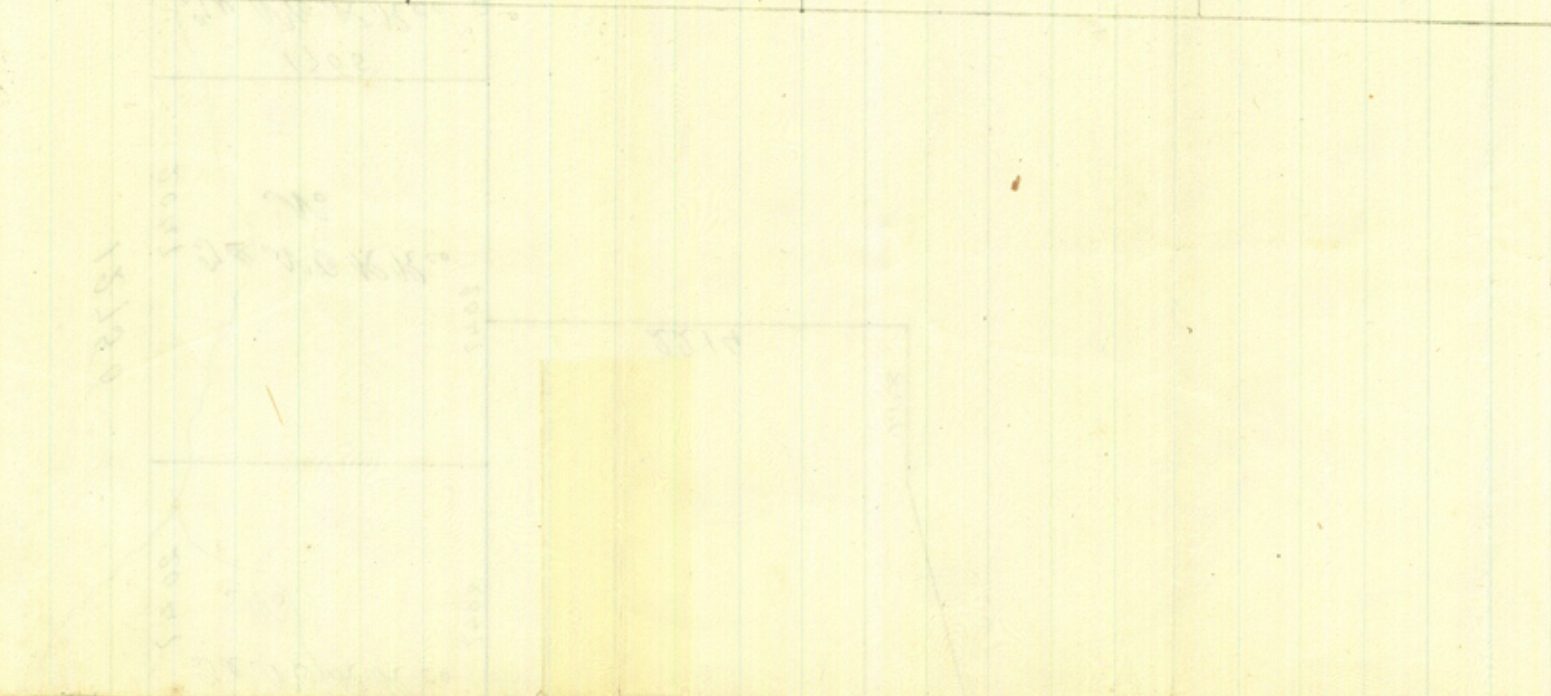
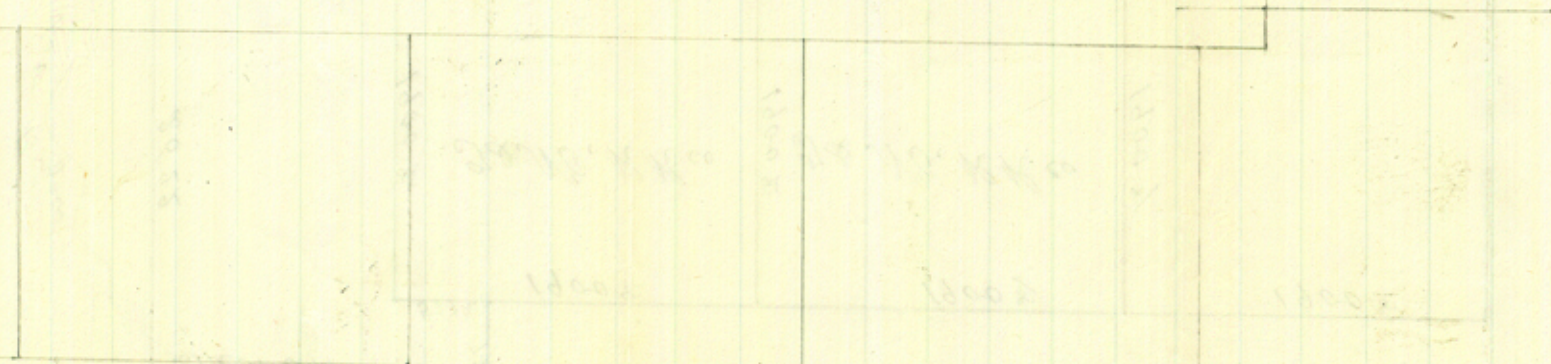

File 14.

Sketch of the East Part of
 Jefferson Co.
 about 12 miles S25E
 from Baumont.

File 274 ?
 Jefferson Co
 Sketch of 8 Sections
 Filed June 23rd 1874

L 110 - 468 572

counted 28/19

Filed June 15/70

Pelham Humphrey
League

5218 4980
J. J.
Johnson
4 League
1331

7320
5355
Cunningham

1965
J & N. C. RR Co
No

238
1877

2500

1765
J & N. C. RR Co
No

2047 7016

William Carroll
League

18 E. 2408

Biglers League

12756

1765
J & N. C. RR Co
No

2047 2047

Rodair Bayou

1765
J & N. C. RR Co
No

2047 2047

1765
J & N. C. RR Co

221

1900 1900 1900
J & N. C. RR Co
1900 J & N. C. RR Co
1900

1248
9504
B B B & C
R R
Co

1900 1900 1900
B B B & C R R Co

Cherry tree
cut down

Humphrey League

Gunningham

J. S. Johnson

William Carroll

S. W. Smythe or McDaniel

Digton League

Joseph Grigg's League

H. M. Harlan's

Joseph Butler League

Rodan Bayou

Cherry Island
Rodan Island

BBB & C RR Co or Stamps

BBB & C RR Co or Stamps 640

BBB & C RR Co or Stamps 640

BBB & C RR Co or Stamps 640

Joan's Broag 820 Stamps 1500

