

counter 28167

East part of Jefferson Co.

See contents of def 1-102

File 18

Jefferson Co. Va.

Blunk Survey &
Surveyors Explanations
with

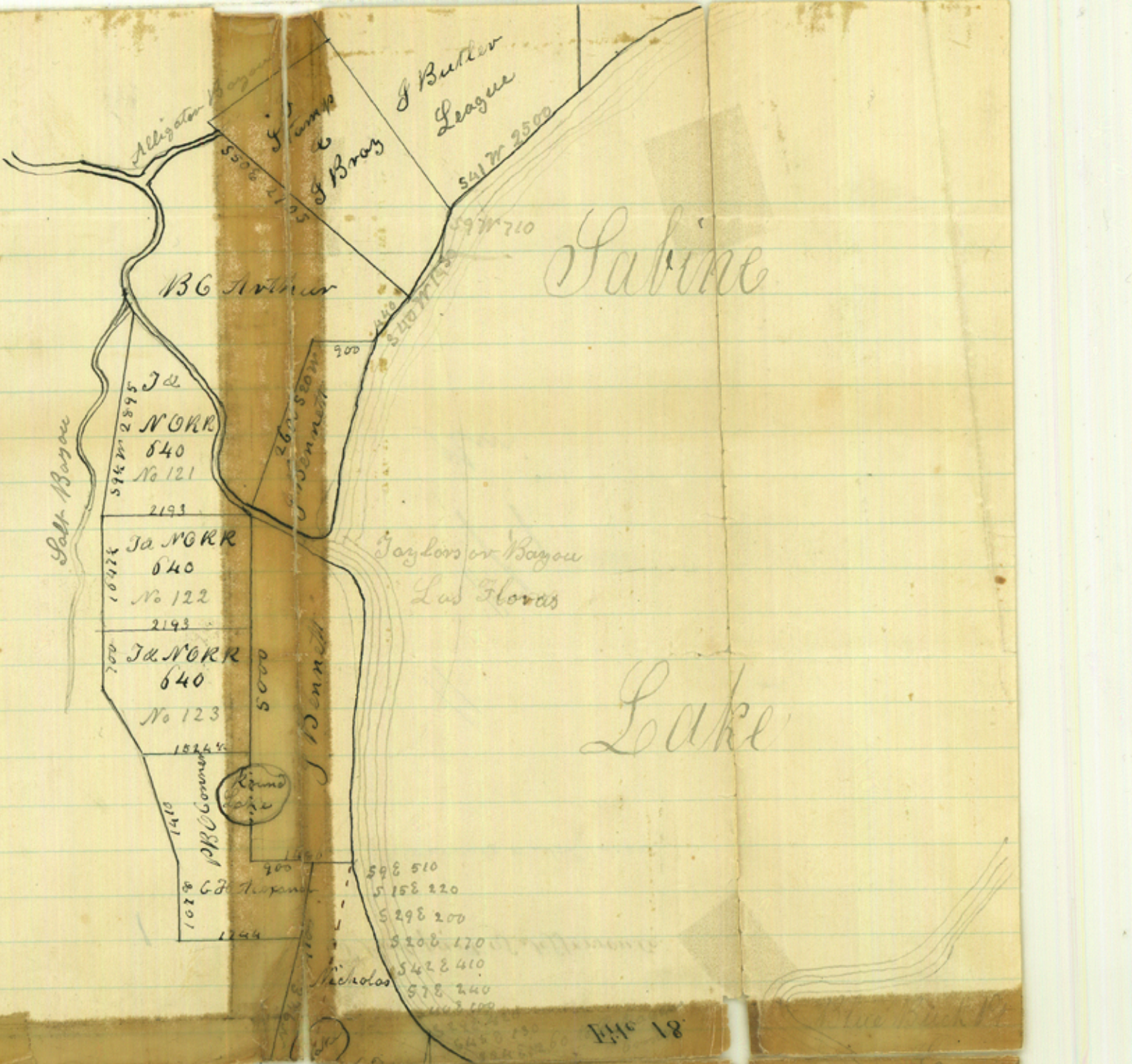

950	950	950	950	950
J&NO	J&NO	J&NO	J&NO	J&NO
RR	RR	RR	RR	RR
640	640	640	640	640
No	No	No	131	130
134	133	132		124

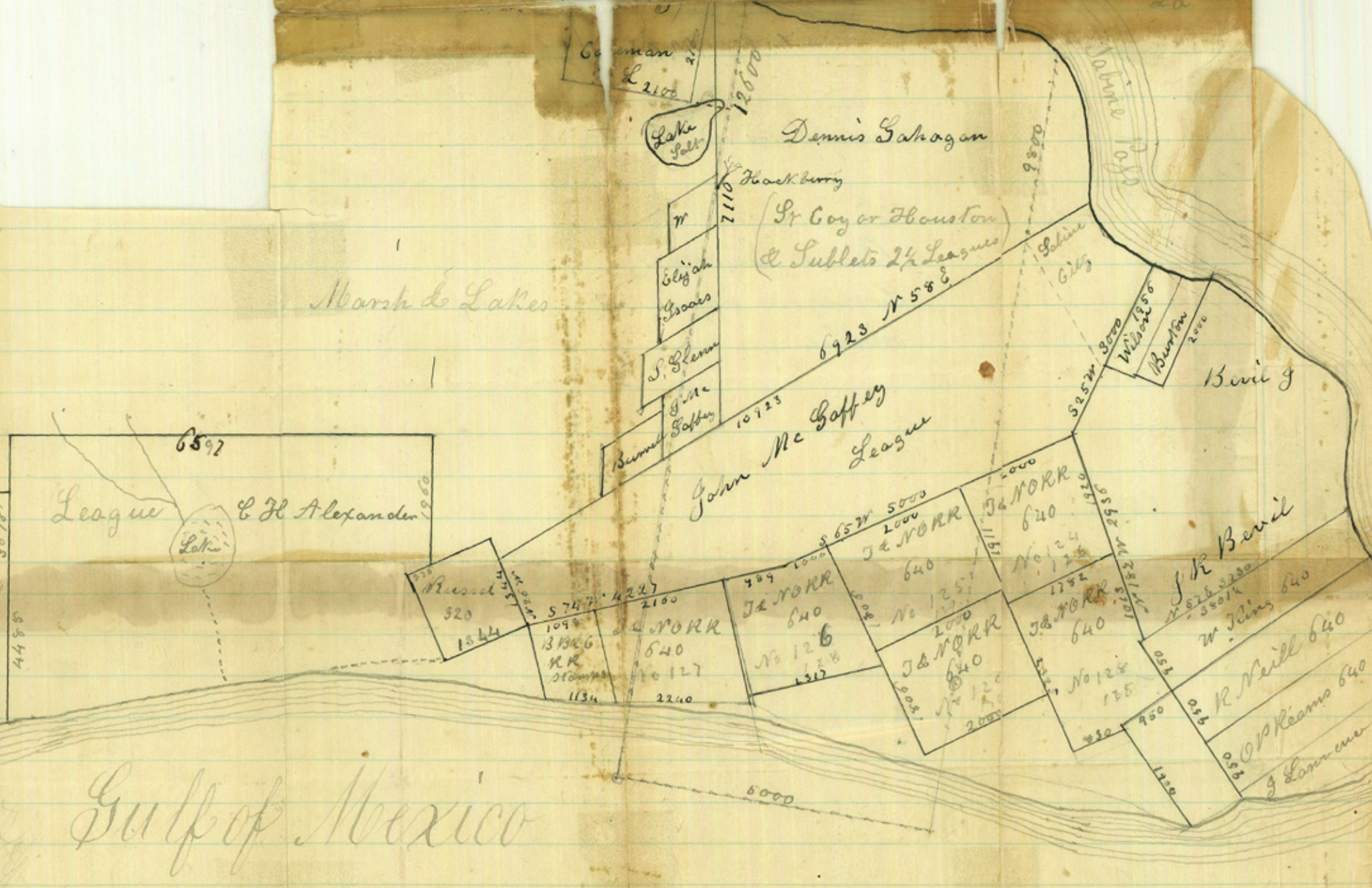

Am