

BEAUMONT, TEXAS,

Sept'. 20th. 1900.

Com'r. Gen'l Land Office,
Hon. Charles Rogan, Com'r.,
Austin, Texas.

Dear Sir:-

Enclosed please find sketch of a survey made for F.H. Votaw. I find after the most careful survey that there is a strip of land 246.9 varas wide between the Stephen Eaton, Wm. Smith and the M. Pevitot. I find in the field notes of the Stephen Eaton that the N.E. as well as the N.W. corner of said Stephen Eaton survey call for the M. Pevitot line and of the Wm. Smith the N.W. corner calls for the M. Pevitot line, but the N.E. corner, the starting point of the Wm. Smith survey, only calls for a post at the W. line of the Wm. Carr survey. Now, as the S.E. corner of the M. Pevitot and the N.E. corner of the Wm. Smith do not close in 246.9 varas, I find a vacant strip of land in the shape of a triangle 2979.7 varas, $\times 246.9 \times 2979.7$ containing 65.16 acres; Furthermore would like to ask your advice about the rest of this strip as shown in enclosed sketch.

Can the Stephen Eaton survey (calling for the Pevitot line) claim this strip of land North of this Stephen Eaton survey and South of the M. Pevitot being 246.9 varas wide and containing 88.2 acres, or is it to be considered vacant?

The same with the triangular strip North of the Wm. Smith as shown on enclosed sketch, containing 65.16 acres. Can the Wm. Smith survey hold this strip or not?

The South line of the M. Pevitot runs in the prairie, and there is absolutely no indication of any natural object, but the Stephen Eaton, Wm. Smith and Wm. Carr all have calls for natural objects to start from and the surveys close surprisingly well.

The N.E. corner of the M. Pevitot has never been disputed and the B.B.B. & C. Ry. Co., tract has been surveyed from this corner.

You will oblige me very much if you give me your decision in this matter as soon as possible.

Yours Very Truly,

E. Peperhorn

Dep't. Surveyor.

BAYOU
 DATED 25th 18th 1900
 E. Debar Bossis & 2K. and Taylor

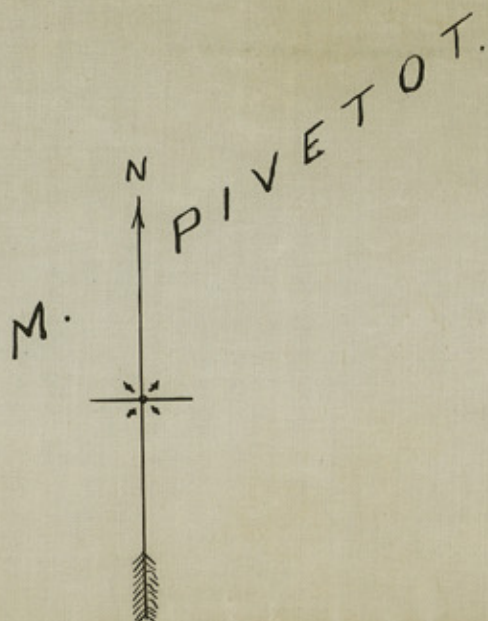

2548 vrs
 B. B. B. & C. Ry. Co.
 REC. CORNER

5000 vrs.
 2020.2 vrs
 38.2 ACRES
 2989.9 vrs
 65.16 ACRES
 2979.7 vrs

William Carr.

Stephen Eaton

William Smith.

wid Burrill

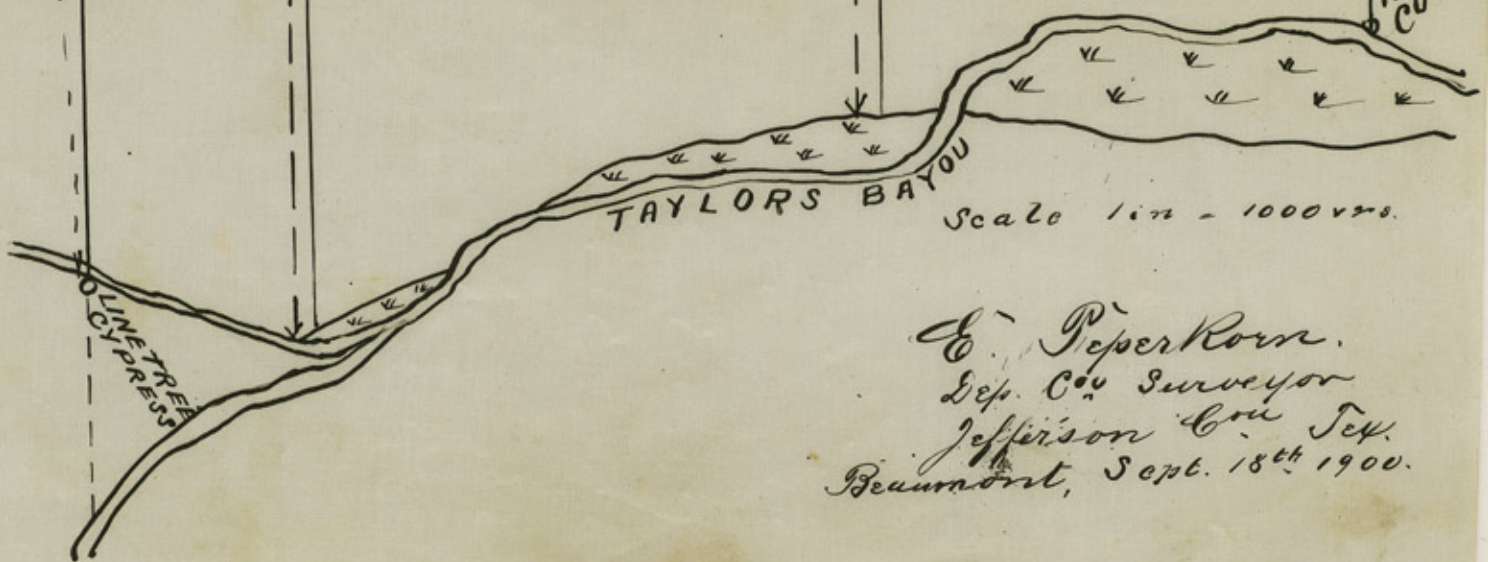

E. Piper Korn.
 Dep. Co. Surveyor
 Jefferson Co. Tex.
 Beaumont, Sept. 18th 1900.

corner 28200

corner 28200

PE

REC. CORNER

Jefferson County
Sketch Files

34

E Peper Roen's SK. on Taylors
Bayou.

Dated Sep. 18, 1900.

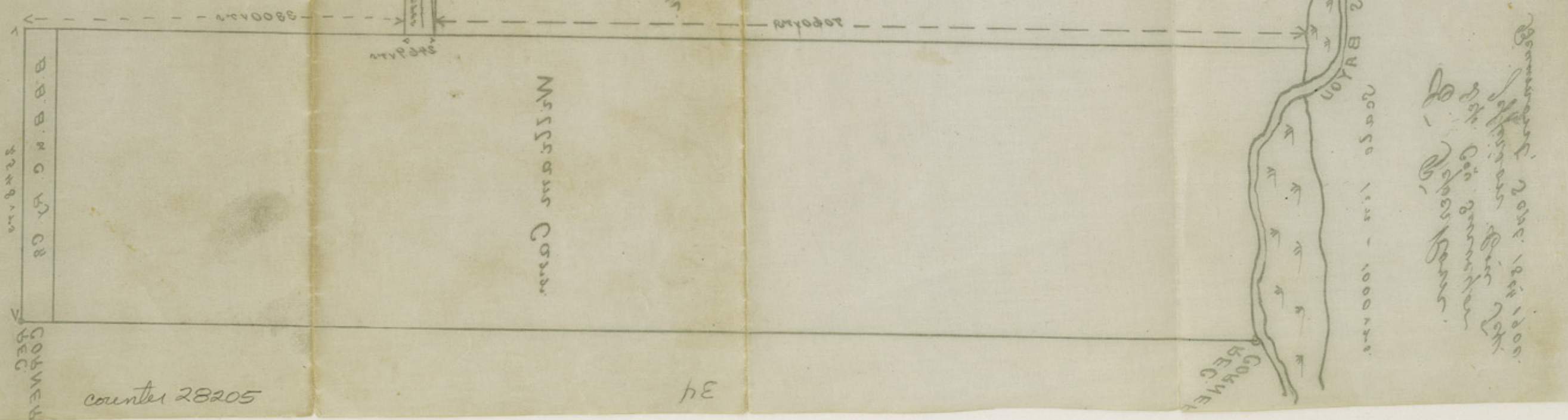
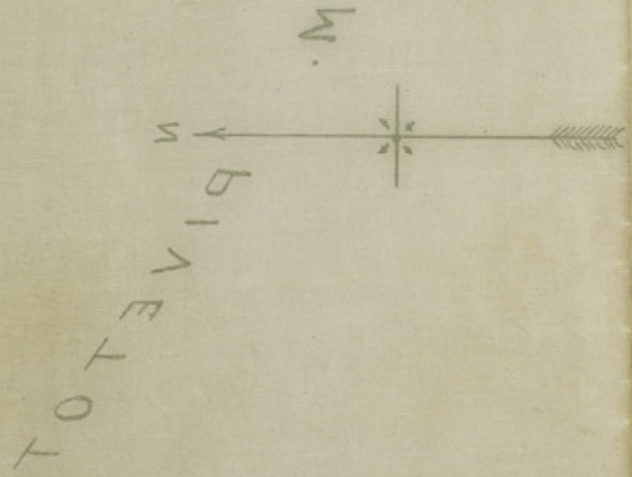

Remains of 1000 ft. 1000 ft.
 Jefferson's Pic. 1000 ft.
 to the corner
 of Peper Roen's

counter 28205

34