

File #. §. 4

Johnson. Co.

8-23-58

North of Buchanan.

Sketches, explanations,  
etc, lying North of Buchanan.  
Filed Aug, 23, 1858 -

counter 28435

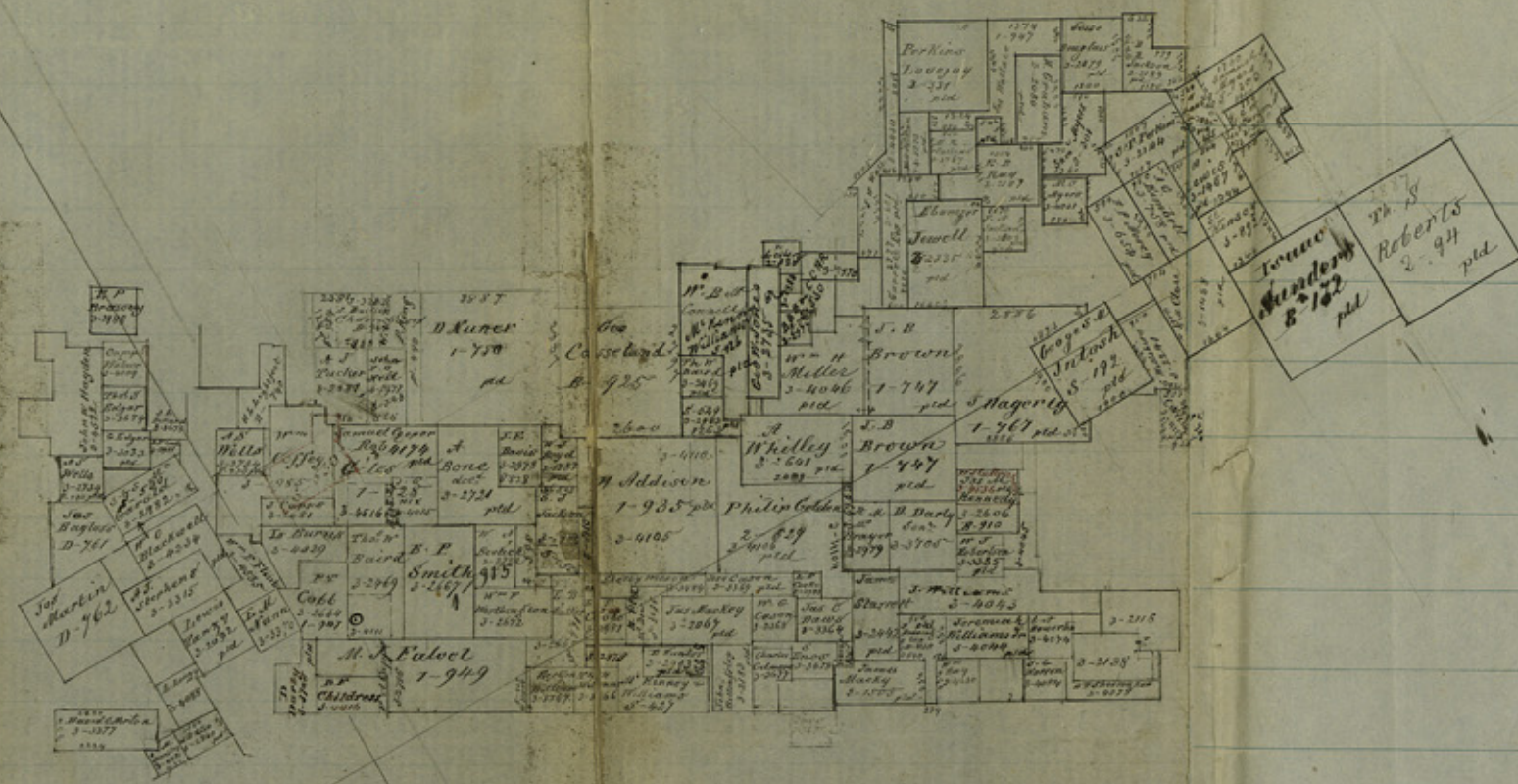

Counter 28436

1132 418  
788 1132  
1920 1550

File 4

Johnson County  
Filed Aug 11<sup>th</sup> 1858

1344  
594  
591

3-2978  
1787

county 28437

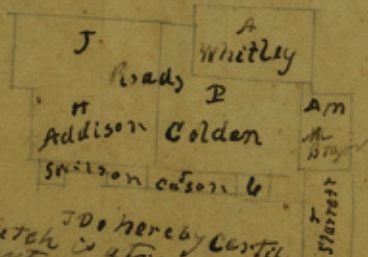

I do hereby certify that the above  
 sketch is a true copy of the maps of Whiston  
 County in my office and that the same  
 survey does not conflict with  
 any other. Aug 20 1854 G. H. P.

counter 28438

File 4  
Johnson Co

File of Johnson 529  
File.

Robertson. In. Clas.

Sketch.

Filed August 23<sup>rd</sup> 58

Count 28439