

Scale: 1000 vs. to the inch.
 Vari: 9°45'E.

November 1873.
 A. Rosenfeld
 Surveyor Montreal Co.

Counter 28673

The State of Texas }
County of Kendall }

I, the undersigned Surveyor of Kendall
County do hereby certify, that the accompanying sketch is a
true and correct representation of the actual position
of the surveys surrounding file S-1154 in the name of
the G. A. & M. G. R. Road survey for 520 acres of land in Kendall
County on Spring Creek, as found by careful examination
and measurement of original corners and lines on the ground.

Given under my hand this the
25th of November 1878.

A. Rozenshar
Surveyor Kendall County

Filed Dec 19 1873
W.E. & R. Lewis
etc

[Faint, mostly illegible handwritten text, possibly bleed-through from the reverse side of the page.]

[Faint handwritten notes or signatures.]

counter 28675

Comfort December 6th 1873

To the Comptroller of the Genl Land Office
Austin

Sir!

I respectfully transmit enclosed
to your office a sketch and Certificate showing the
actual position of certain surveys on Spring Creek in
Hendall County.

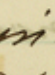
All the corners, marked on the plot thus  in red ink
are actually found by me on the ground and corresponding
with the original field notes, also are all the lines, where
the distances are marked in red ink, carefully measured.

Beginning at the East corner of J. Gumbert survey, Thence
East, to the intersection of West boundary of M. Wells survey
Thence South to the SW corner of the latter, Thence East,
and South to the SW corner of file S-1154 (S. & M. & R.) per
S. & R. Thence South to the intersection of the North
boundary of F. Gano survey and from its S. E. corner
to the well established S. E. corner of the same. Thence
following the plainly marked North boundary of the
Ortiz League to the SW corner of F. Gano. Thence
the distance marked on the Plot to the S. E. corner
of J. Butler survey on said line. Thence in the
course marked on the plot to the S. E. corner of Ph. Zoller
showing an interval between this and J. Butler survey.
Thence following the eastern boundary of Ph. Zoller away
westwards to a point, where the eastern boundary of M.
Olivera survey, extended to the South intersects the same,
further striking the West corner of J. Gumbert in an
East course and following the southern boundaries
of the latter to the beginning.

The distances in the J. Gumbert survey are the

result of actual measurement, as marked in red ink, viz: 7940s x 12500s. - The error in Latitude must be explained by the circumstance, that on the eastern side the ground is more level, than on the western.

The position of the J. Fiedler survey is given according to the actual position of the original corners on the ground. - It seems that in surveying the three surveys surrounding the P. Gauno survey, the original corners of the latter, as given by the field notes, never have been found, notwithstanding they are plainly established by well marked bearing trees. - From the same cause the A. L. Pfeiffer survey, as made and reported, is in conflict for about 80 varas with the P. Gauno survey. I understood that the former is patented and beg respectfully to be informed, in what manner this conflict can be repaired. Can the first patent be cancelled and a new one issued with corrected boundaries?

If there should be no objections against this statement, I will forthwith make out new field notes for file S-1154, J. Bittel and H. Steele.

I very respectfully remain
 Yours &c. &c.
 A. B. Bennett
 Surveyor Kendall Co.

Filed for Record 1873
 W. G. Adams
 Clerk

1160.
 Bryan Smith
 Surveyor
 Statement
 Strodon

Plotted according to surveyors
attached sketch and explanation.
Febr. 3/44. E. Schütze.

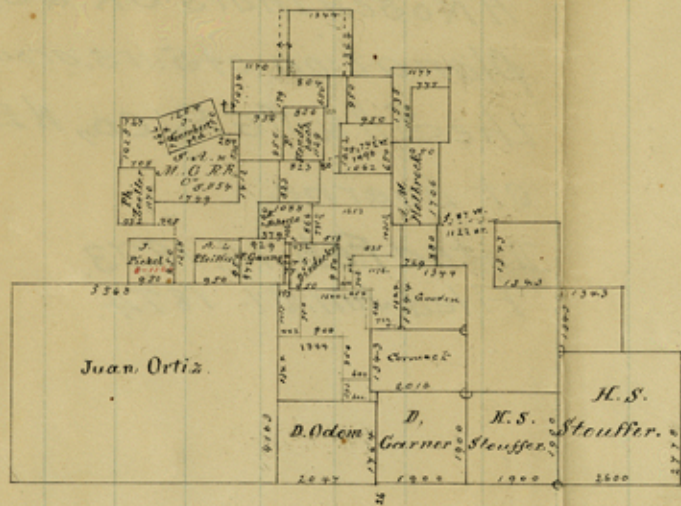

1383
1350
1340
1320
1300
1280
1260
1240
1220
1200
1180
1160
1140
1120
1100
1080
1060
1040
1020
1000
980
960
940
920
900
880
860
840
820
800
780
760
740
720
700
680
660
640
620
600
580
560
540
520
500
480
460
440
420
400
380
360
340
320
300
280
260
240
220
200
180
160
140
120
100
80
60
40
20
0

County 28678

Jan. 31/74.
Files on desk:

Fannin's 1476.
" S. 2260.
" S. 2262. }
Lamar's 219.

Jos. M. Ruiz.
S. P. N. R. Co.
H. L. Ward.

1/31/74

^{1^a}
File +
\$

Kendall Co.

A Rosen thal's SK & ex-
planation of Surs. around
the SA & MG Ry Co., NE,
of Boerne.

Dated Feb. 19. 1873.
Filed Jan. 31. 1874.

12/19/73

The examination of the larger survey file S-1154 in the name of the S.A. & M.G. R.R. Co shows the following discrepancies, to wit:

- 1) The connection of the J. Gombert North corner with the Fel. de Luna S.E. corner is $N. 5^{\circ} E$ 245 varas, the Northline of the J. Gombert survey is $S. 70^{\circ} W.$ 1204 varas and the distance between the Olivera East line and the Fel. de Luna S.E. corner is 1900 varas.

From these data the ^{calculated} distance between the J. Gombert West corner and the Olivera East line is 745 varas, while the fieldnotes of survey S-1154, call it 625 varas. Difference 120 varas.

2. According to fieldnotes S-1154 the distance between the J. Gombert East corner and the H. Wetz Westline (represented in conflict on the official map of Kendall Co) is 232 varas and the N.E. corner of this (S-1154) survey is 466 varas North of the S.W. corner of the H. Wetz survey. The H. Scheele survey is hereby drawn in conflict with the 120 acres survey file S-1154 in the name of the S.A. & M.G. R.R. Co.

- 3 The two surveys file S-1155 made for the S.A. & M.G. R.R. Co conflict with each other, probably owing to an error in the connecting line with the N.E. corner of the F. Stendebach survey. One of these surveys does not close.

4)

Kendall Co
Sketch file 7
examination of S-1154.

4.) The sketch represents the A. M. Holbrook survey according to its connections with the SW corner of the Juan Ortiz survey ^{via R Hodge and H.S. Strouffer} and indicates by the dotted connection line the position of the same survey, which results from the connections given in the fieldnotes of the larger survey file S-1154.

If the position of the Holbrook survey as represented in connection with the J. Ortiz S.W. corner is correct, then the J. Combert East corner is in conflict with the H. Wet's survey, and the S.A. & M.G. R.R. survey file 1155 (which does not close) is in conflict with the Thos Jackson and Fel. de Luna survey's

5) The southline of the Jul. Fabra survey is 904 varas. The same line, as H. Gotthardt's N. line is called 950 varas, and the O. Maraida S. line is 900 varas while the same line as F. Boehms N. line is called 939 varas long.

6) The conflict of the J. Scherz survey file 3-5795 with the Jas. J. Bettner section, appearing on the official map of Kendall Co, is removed by the explanatory statement of the surveyor on file with the fieldnotes of the J. Scherz survey.

Febr 19/72

Schenck