

Received of ...  
 the sum of ...  
 for ...  
 1882

Received of ...  
 the sum of ...  
 for ...  
 1882

Passer

No. 1  
 Kent & Scary  
 Dickens.

CP Benson, BIKS I & G.  
 RR Co., and AB, RM Thomson  
 Dated Dec. 15, 1882  
 Filed do 30, 1882.

Filed Dec 30/82  
 Robinson

Filed Decemb. 30/82.  
 J. H. Robinson  
 Chief Clerk

1882 & returns

counter 28823

Pease's return

1882 Dec 15

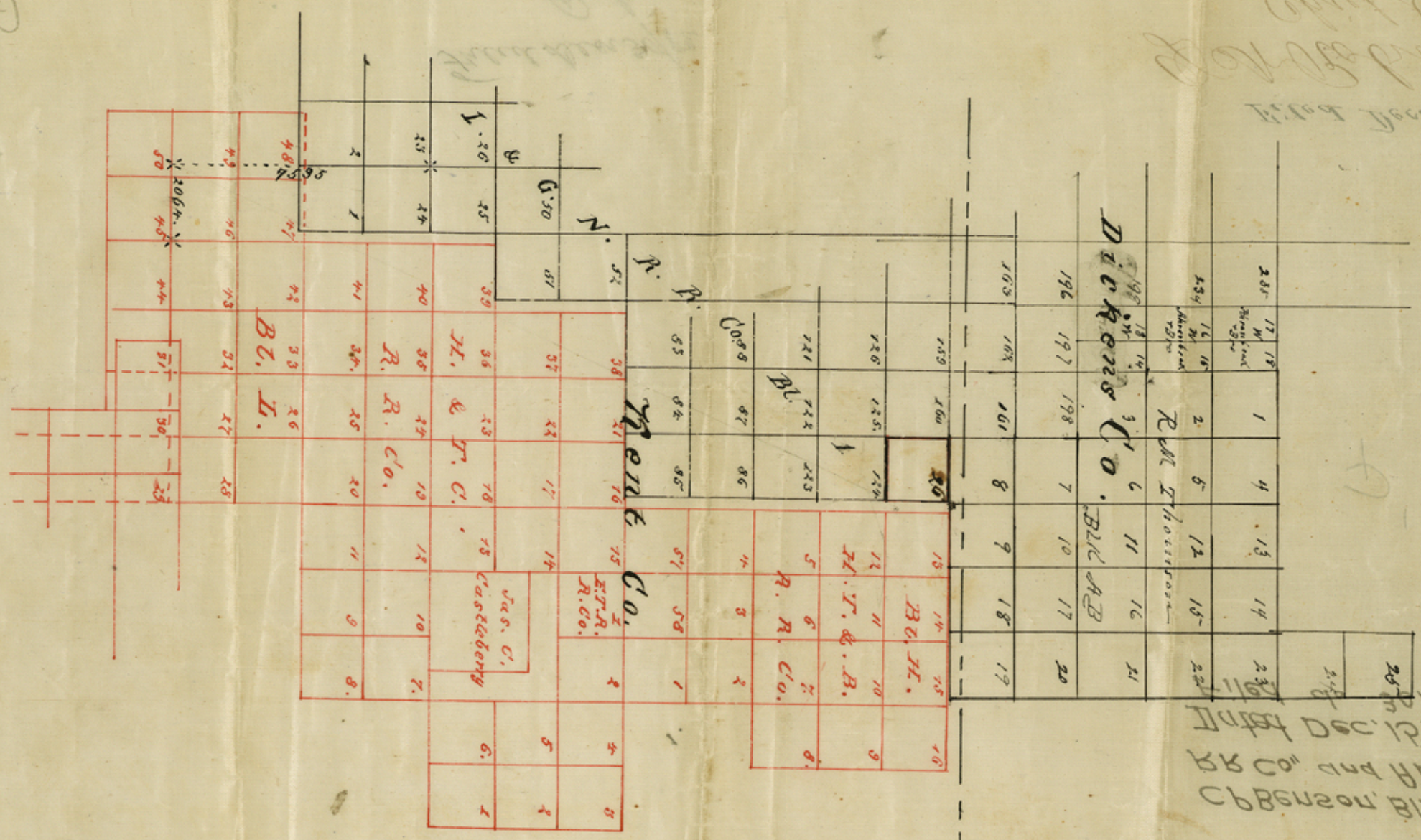

1885  
 Dec 12 1885  
 RR Co and RR Co  
 CPBenson, BIKS THE

Monte Co  
 Dickens

I G. P. Benson Surveyor of Young Land District do hereby  
 Certify the above to be a true & Correct Map of surveys in Dickens  
 Kent Counties & that by actual measurement on the ground I  
 found that the N.E. Cor of survey No 45 Blk I is 7595 vrs South  
 & 2064 vrs East of the N.E. Cor of Survey No 23, Block 1, H. & T.  
 RR Co.  
 This the 15<sup>th</sup> day of Decr 1882

G. P. Benson  
 Dist Surveyor Young Land Dist

counter 28324