

George W. ...
 Surveyor General
 San Antonio
 1851

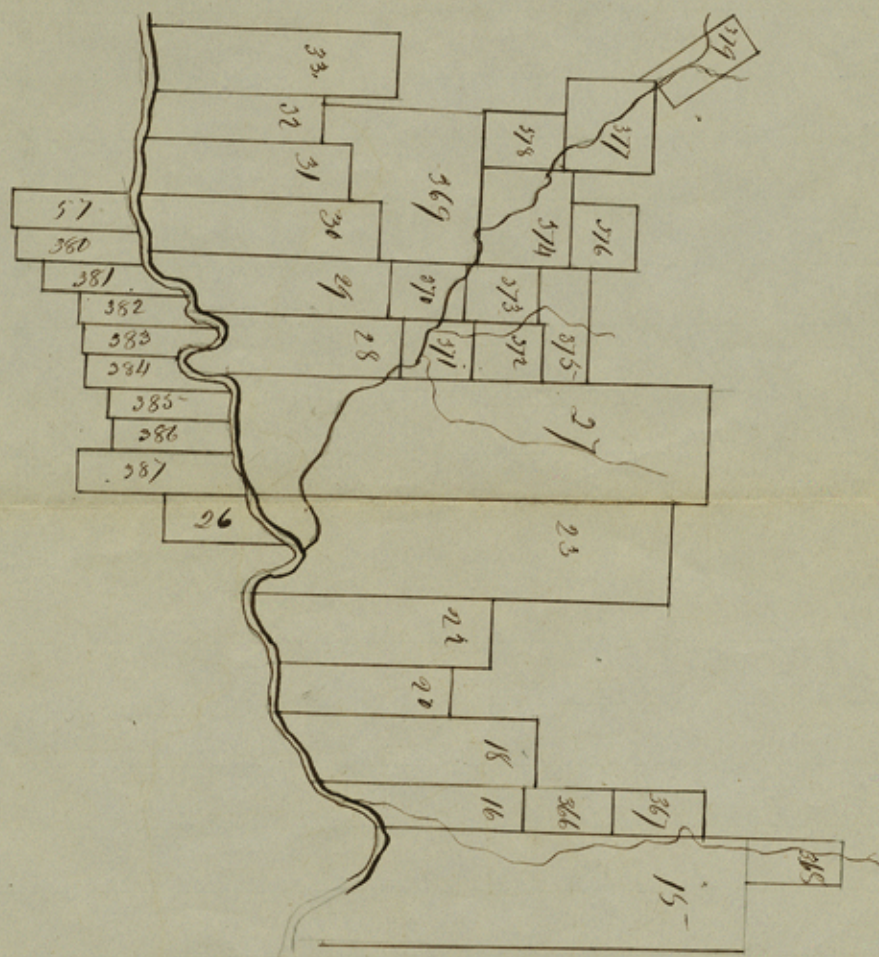

I J. S. McDonald District Surveyor Brown
 District do hereby certify that the above plat
 is a correct copy of a Representation of Survey
 returned to my office by J. S. McDonald Deputy
 Surveyor

San Antonio
 December 26th 1851

J. S. McDonald
 Dist. Sur. B. Dist

File 34 1^c

— Berar District —

— Berar County —

— Guadalupe River —

Plotted on Map

Kerr Co. - Sk. File # 1^c



J G McDonald -
12/26/51.

County 28852