

Kerr Co

1^d

W. Friederichs SK on N. side of Guadalupe, on EB line of Co,

counter 28853

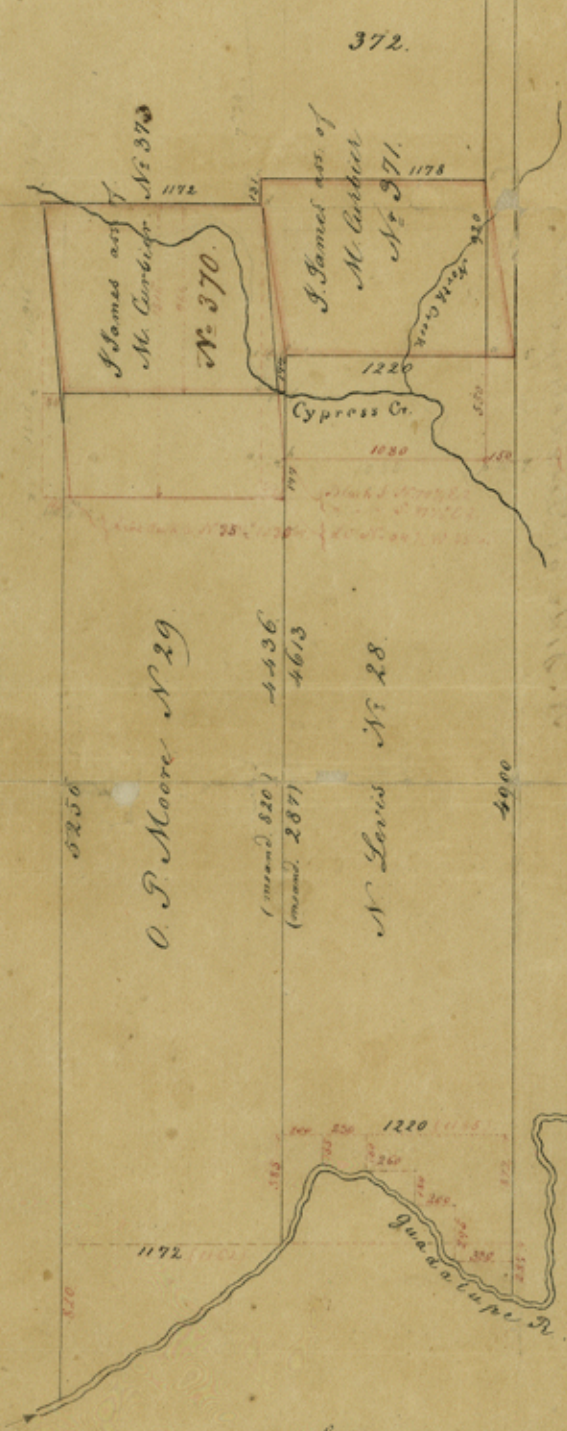

S. Regalado No. 27

I hereby certify that the above sketch is a correct representation of the survey represented on it as found by me on the ground by careful examination.

Comfert 15th April 1856.

Friedrich
Dep. Surv.
Ber. Dist.

Scale . 1000 varas pr. Inch
Variation . 9° 45' E.

Examined & found correct
J. Giraud Dist. S. B. D.
Comter 28854

File 103
Kerr County.
Deer Donation

Sketch N^o 31.

Bandera County

Near the E. Boundary
N. side of Guadalupe R.

County 28855