

1
2 The State of Texas

3 County of Lamar

4 I J J Terrell County Surveyor
5 of Lamar County do hereby certify
6 that the attached plat is a correct
7 delineation of the Lamar Co School
8 lands and of abutting and connecting
9 surveys ~~as~~ they are fixed on the
10 ground by calls and established
11 corners and boundary lines.

12 To certify all of which I hereunto
13 set my official signature on this
14 the 24 day of October 1895

15 J J Terrell
16 Surveyor of Lamar County
17 Texas



County line

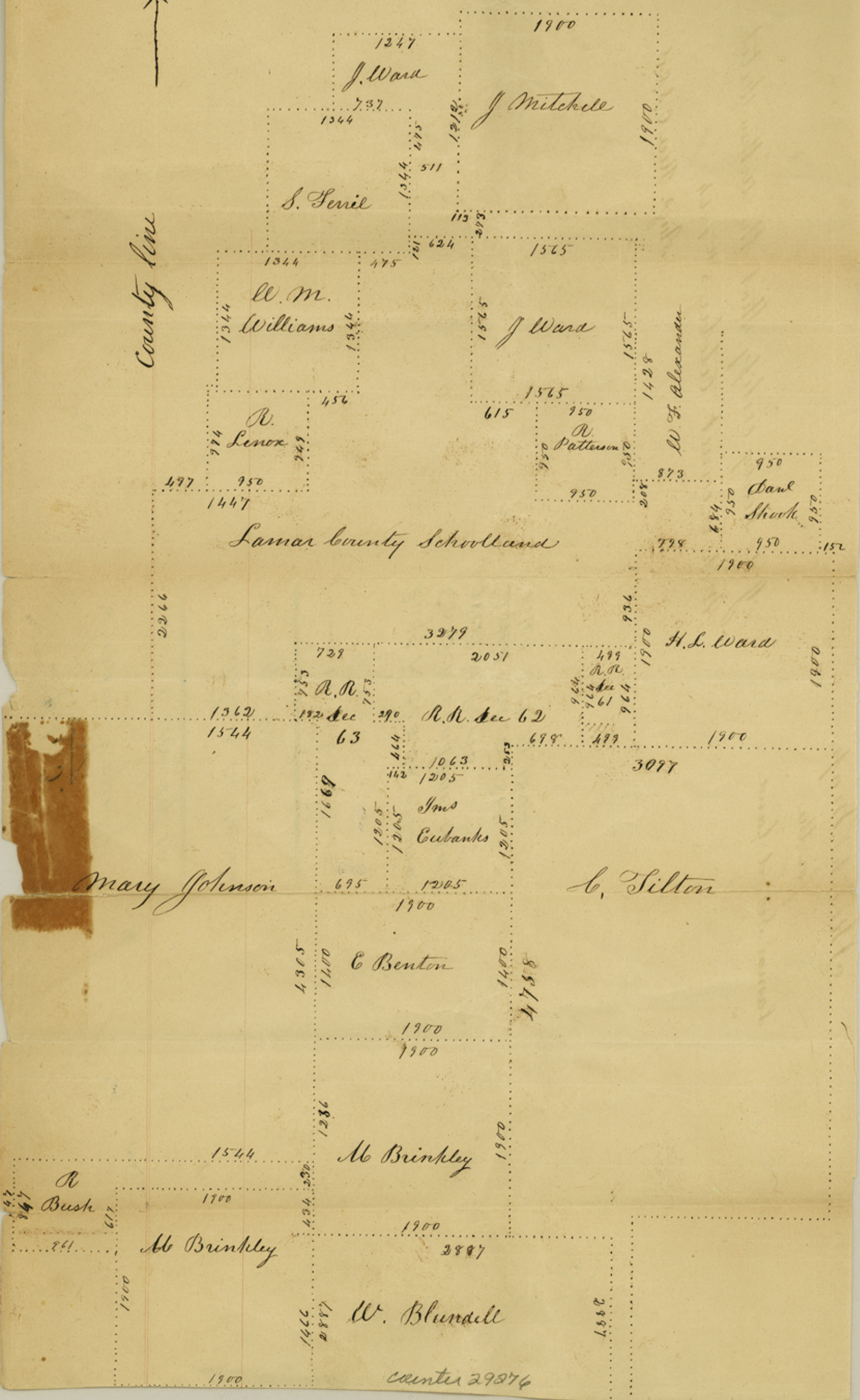

Lamar County School Land

Mary Johnson

C. Silton

C. Benton

M. Brinkley

R. Bush

M. Brinkley

W. Blundell

counter 29276

File 3.

Lamar County

Filed October 19th 1864.

School Land on Fannin
County line.

about 14 miles West
of Paris.

Aug^s Rice's sk. of Lamar
Co. Sch^l Land Sur. 14 mi
West of Paris.

Dated Oct. 5, 1864
Filed Oct. 19, 1864.

Sketch made
for the
Lamar School Land

I do hereby certify that the within sketch
map is correct October 5th 1864
Aug^s Rice C.S.S.D

counter 29877