

1-1<sup>a</sup>

Lamb Co

SK. & Con. Lines

Filed June 20, 1883,

counter 29337

The State of Texas  
County of Baylor

Field Notes of a connecting line made in Lamb <sup>and Hale</sup> Castro Counties:

Beginning at the N.E. corner of Capitol League No 633 and N.W. cor of League No 634 an earth mound and four pits easily identified; Thence North at 18,274 varas a point; Thence East at 1182 varas a point; Thence North at 547 varas an earth mound and 4 pits the original N.E. corner of state Capitol League No 617.

Thence North at 10,100 varas pass an earth mound and 4 pits the original <sup>S</sup>N.E. corner of state Capitol League No 574 at 15,150 varas we build an earth mound and three four pits 40 varas north from catfish creek from which a bush on rocky point of Bluff bears N 52 W about 3/4 of a mile; the N.E. cor 574

Thence S 56 1/2 E at 4500 varas creek running down channel of same we left it at 650 varas; at 2144 varas a point on high ridge; cor N. abt 600.0  
Thence East at 1140 varas creek at 1280 varas a point 80 var N of creek.

Thence S 64 1/4 E 1130 to a point 500 var N from creek  
Thence S 68 E 950 var to a point 400 var N of creek  
Thence S 79 E 804 var to a point abt 600 var N of creek

T

Thence N 78 1/2 E at 780 varas cross creek: at 1464  
varas touch bend of creek at 1464 or a point  
on a small hill 130 varas S. of creek

Thence S 63 3/4 E 1330 varas to a point 300 varas W from <sup>at</sup>

Thence S 67 1/2 E crossing creek at 600 - 800 - 940 and  
1200 varas. at 1532 a point in gap between two -  
hills about 500 varas N. from creek from which  
a monument on hill is 3. 25 varas. and a stone monument

+ the S. W. cor of sec N. 14 and N. W. cor of sec No  
15 Block T 3 made for R. M. F. D. A. Thomson  
bears N 52 1/2 E 127 varas. X

Thence S 86 1/2 E at 940 and 1200 varas creek at  
1600 varas touch bend of creek at North part at 2850  
varas a point on ridge 350 varas N. from creek.

Thence S 82 E at 540 varas cross creek at 1736 varas  
a point about 500 varas South of creek

Thence S. 65 3/4 E 2240 varas to a point about one mile  
S 7 1200 varas W from creek.

Thence S 36 1/2 E at 1650 & 1820 varas cross creek at  
2118 varas a point on North hillside 325 varas W S. of creek

Thence S 37 E 860 varas to a point about 600 varas  
S. of creek.

Thence S. 52 1/4 E 2292 varas to a point about 700 varas S.  
of creek.

Thence S. 63 E 1200 varas to a point 30 varas SW from  
Rose Spring on cutfish creek.

Thence East 588 varas (cross creek at 800 varas) to a point.

Thence N 61 E 870 varas a point.

+ Thence East at 240 varas cross McKenzie Trail  
at 6000 varas a point on high prairie

Thence S 78 E at 1220 varas McKenzie Trail at  
1368 varas on East end on North side of

McKenzie Trail.

Thence S 76 E 1460 varas to a point.

Thence S 86 E 1300 varas to a point.

Thence N 83 E 1820 varas to a rock mound

the N.W. corner of No 19 Block <sup>FB</sup> S.E. L. & R.R.P.P.

from which McKenzie's crossing on Coit Creek

is S. 15 W 220 varas. This corner is easily iden-

tified.

Surveyed May 23<sup>rd</sup> and 24<sup>th</sup> 1883

A. C. Packitt

John White

J. W. Armstrong

Chain carriers

I Sam L Chalk Surveyor Baylor Land District do hereby certify that the foregoing survey was made on the ground according to law and that the limits boundaries <sup>and corners</sup> with all marks natural <sup>and</sup> artificial are truly described in the foregoing field notes

Sam L Chalk

Sur Baylor Land Dist

"

I Sam L Chalk surveyor Baylor Land Dist do hereby certify that the foregoing field notes are recorded in my office in Book C.L. No Pages 73-74 <sup>and</sup> 75

Sam L Chalk

Sur Baylor Land Dist

T2

Lamb County

Connecting line filed

June 20<sup>th</sup> 1883.

D. A. Robinson

Chf. Clk.

2<sup>nd</sup> Run

1042	2144	1191	1763
E	1250		1280
1064	1130	492	1023
1115	907	316	511
1122	804	102	789
1135	1544	292	1435
1637 1/2	1300	588	1193
1671 1/2	1532	586	1416
1866 1/2	2657	174	2845
1872 1/2	1756	245	1738
1653 1/2	2240	920	2042
1366 1/2	2118	1702	1210
1372	820	687	517
1524 1/2	2292	1403	1813
1632	1200	545	1069
600 ft	586	5 <sup>th</sup>	586
1612	870	422	761
600 ft	6000		6000
1782	1368	284	1339
1762	1460	355	1416
1862	1300	91	1297
1683 1/2	1820	221	1807
		935	977434290
		935	
		8839	

T3

CASTRO

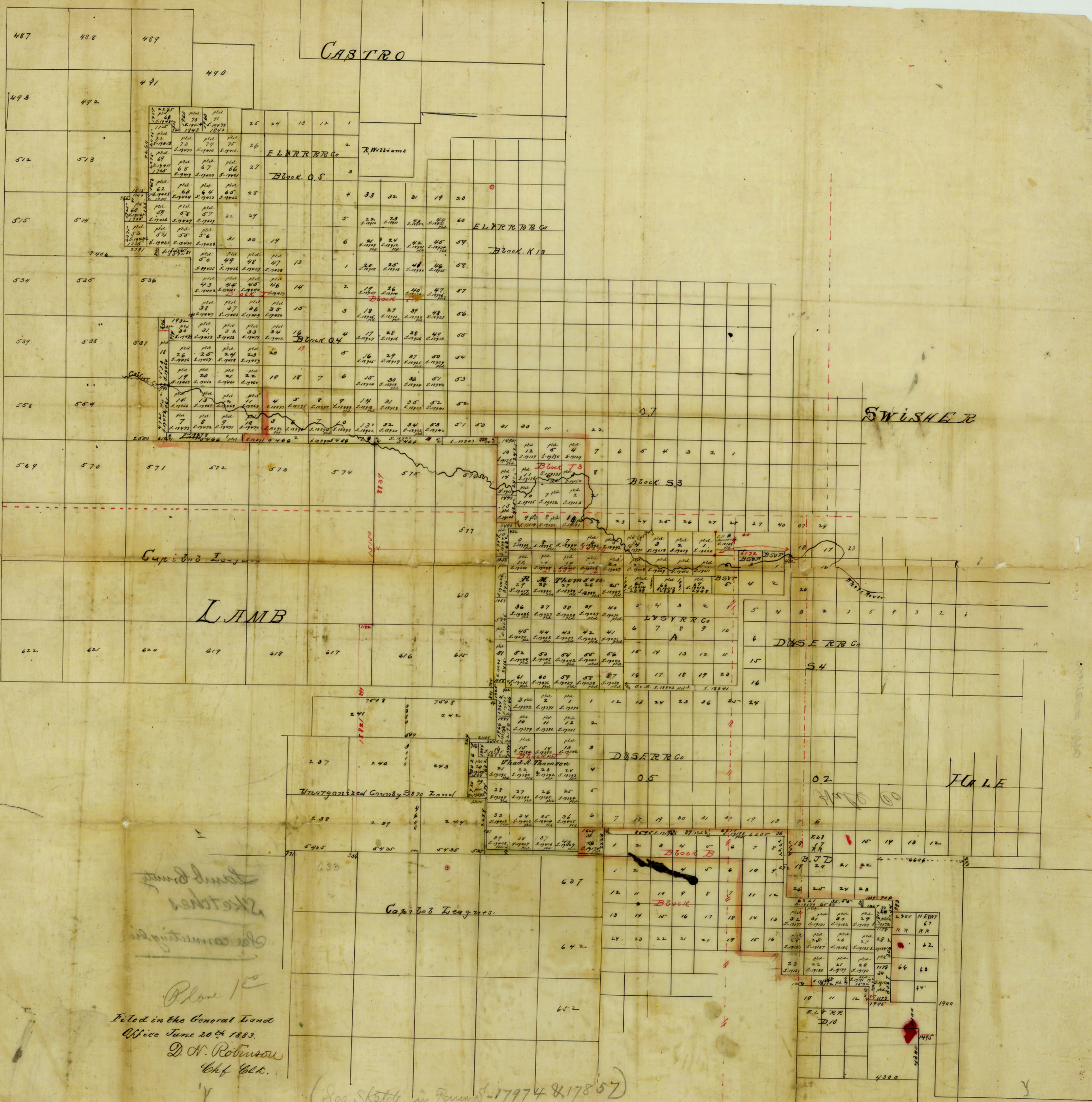

Filed in the General Land Office June 20th 1883.  
D. W. Robinson  
Chf. Clk.

(See sketch in Form S-17974 & 17857)  
By Sam L. Chalk  
Surveyor Baylor Land Dist. See connecting line accompanying this. E. von Rosenberg