

579
Capitol Land

608 609

Lake basin

617 616

J. H. Stephens

241 242
Unorganized

240 243
County

239 244
School Land

634 635 636 637
Capitol Land.

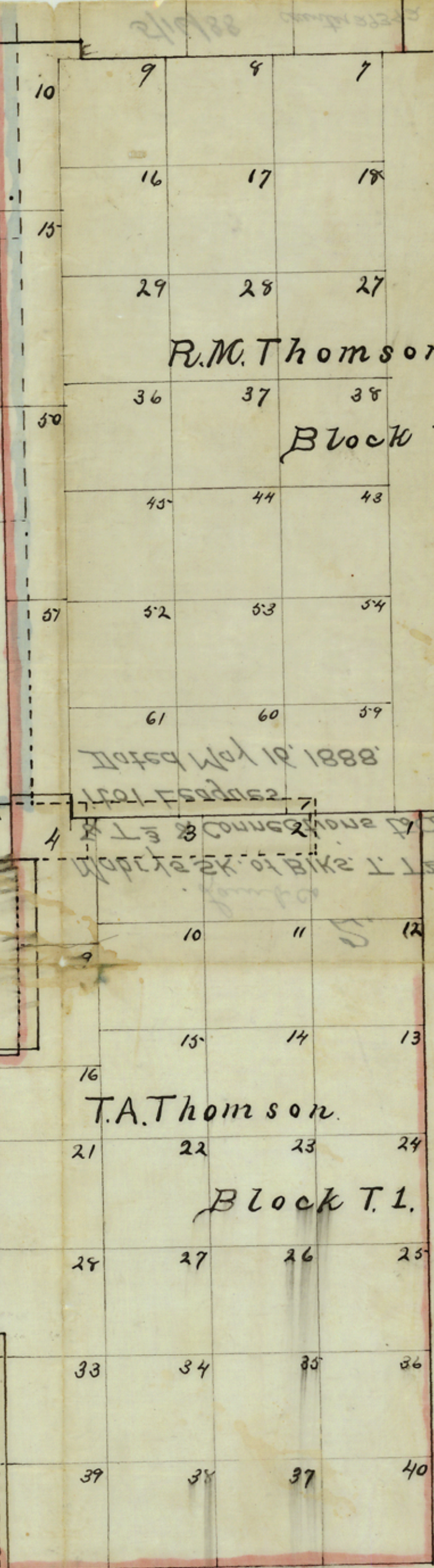

R.M. Thomson

Block T. 2

8881 1st lot basin

1st 3rd Congress

part of 2nd of 1888

10 11 12

13 14 15

T.A. Thomson

Block T. 1.

20 21 22 23 24

25 26 27 28 29

30 31 32 33 34

35 36 37 38 39 40

J. W. S. Mabry Surveyor Oldham Land
hereby certify that this sketch shows the
of blocks T. 1, T. 2 & T. 3 with reference
to unorganized County
May 16 1888
W. S. Mabry

Blair 956

505905

505905

131 132 133 134

505905 135

505905

505905



Lamb Co
 Mabry's SK. of BIKS. T. T2
 & T3 & Connections to Cap-
 itol Leagues
 Dated May 16, 1888.

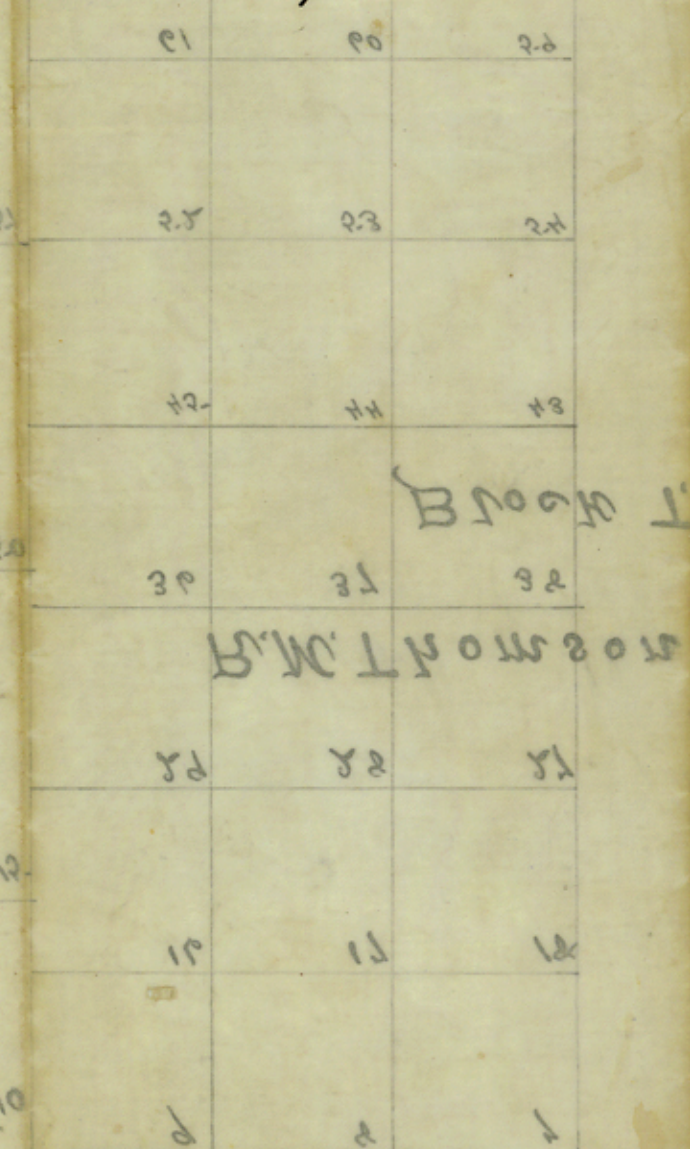

5/16/88 counter 29392

Handwritten notes in cursive script, including the name 'Mr. D. Mabry' and other illegible text.