

I, Isham McMullin District Surveyor for
 Milam San District do hereby certify that
 the foregoing sketch is a true copy of
 the original sketch returned by Reubin
 Harnsby Deputy Surveyor
 Given under my hand this 8th day of April
 1857
 Isham McMullin
 Surveyor for Milam
 San District

Lampasas Co.

On School Cr.
Rec^d April 1856

about 9 miles N10° W.
of Lampasas.

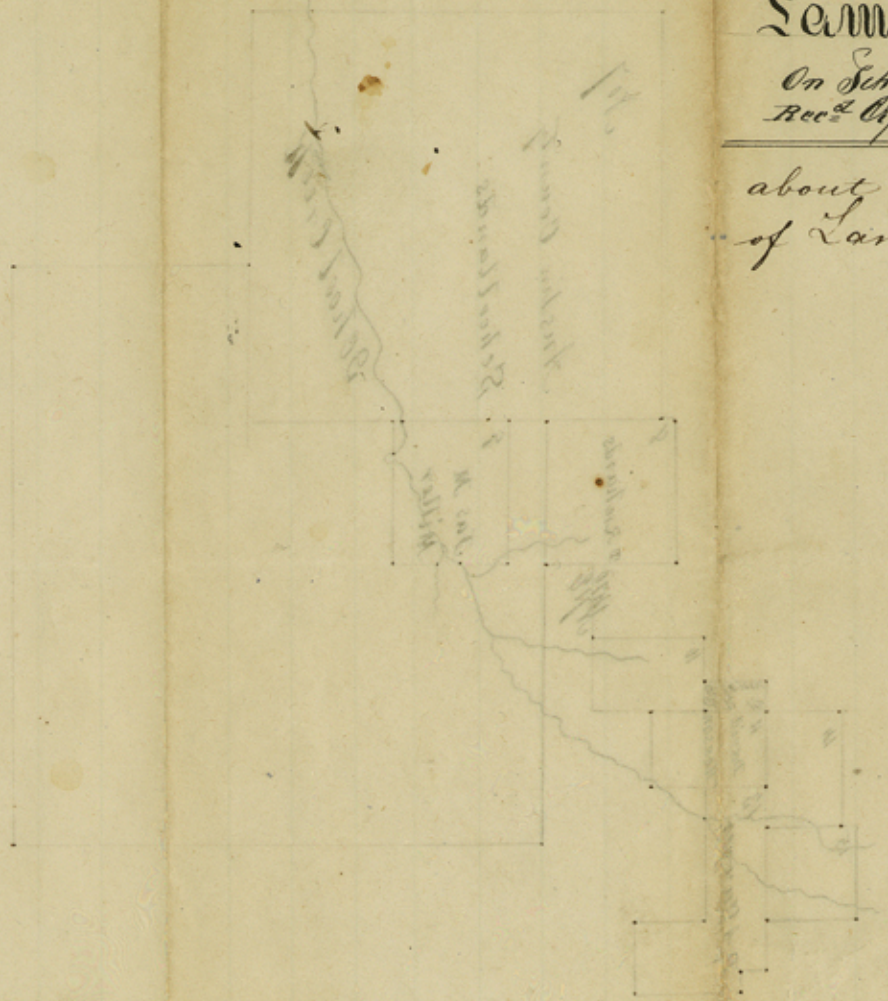

[Faint, mostly illegible handwritten text, likely bleed-through from the reverse side of the page.]