

A. B. Johnson
John Sumner
John Jones

The above sketch is correct as existing during
1812 & 1813 which conflict with



1330
630
1440

5342
5330
12

Mc Anally's Creek
23
Mr. W.
Sumners
1809

~~X~~

7a
File 9

Texas County

On McAnelly's & Lynch's Creeks
on the Eastside of Colorado near
and below the Mouth of San Saba
1-25-54.

Map of the Map of Southern part
of Texas District
file 410

Pampas Co

Over-Downing 26/5/54

W. D. Lynch

J. Lynch

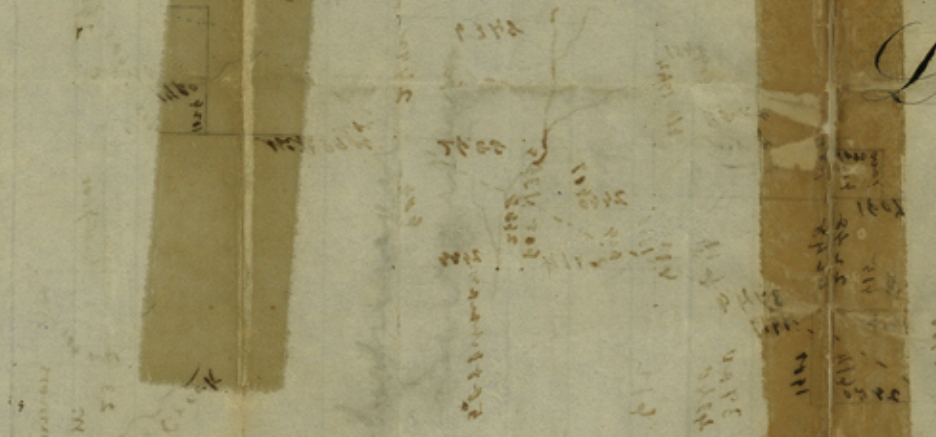

counter 29905