

Field Notes of a survey of the North line of the John Burleson  
1280 acre tract - survey No 45.

Beginning at the N. E. Corner of the G. H. W. Johnson  
this Craigie tract from which an Old oak bears  $S 45^{\circ} E 13^{\circ} \frac{2}{3} V. 20$  No  
other witness trees could be found at this corner

Thence N. 71 E at 80 V. passed a rock mound the  
S. E. Corner of the Stolek's tract from a Live oak bears  $S 70^{\circ} E 7^{\circ}$   
at  $1631\frac{1}{2}$  V. struck the S. E. Corner of the St & Hughes tract from which  
a Live Oak marked bears  $S 67^{\circ} W 9^{\circ}$  a do stump  $N 48^{\circ} W 25^{\circ}$  at  
 $2200$  V. struck a rock mound the S. W. Corner of the Powel tract  
at  $2698$  V. searched but found no sign of corner - at  $2851$  V. found  
a rock planted for the N. E. Corner <sup>of No 45</sup> but witness trees could not be found  
at  $3051$  V. struck the S. E. Cor of the Powel tract from which a  
Live oak bears  $N 63^{\circ} E 18^{\circ}$  and a do  $N 80^{\circ} W 14\frac{1}{2} V.$  both marked

Surveyed 25<sup>th</sup> April 1874.

A. Gibson

$\frac{3}{4}$  chains

No 10. 30 E

John Dutton

C. Surveyor & C.

I certify the above survey is correct as found on the  
ground by measurement made with greatest care as  
described in the above notes and that the same  
is recorded in Book A Page 201.

Apr 27<sup>th</sup> 1874

John Dutton

C. Surveyor

G. C.

N<sup>o</sup> 11.  
Lampasas County.

Sketch & Statement  
of Survey or to  
Survey Surrounding  
Lampasas.

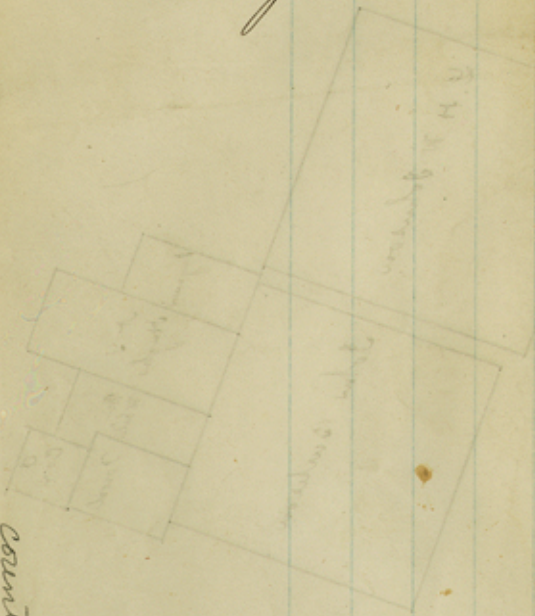

counter 2921

5- <sup>N<sup>o</sup> # 11</sup> File ~~2107~~ 11  
Milam 3<sup>d</sup> class  
Sketch ~~of fields~~  
Statement of Surveyor  
~~Conceal~~

Apr. 27-1874

Filed May 1/74.  
Rhoads Fisher,  
Chf. Ck.

Lampasas Co

*[Faint, mostly illegible handwriting on the right page, possibly bleed-through from the reverse side. Some legible words include "Statement of Surveyor", "Lampasas Co", and "Rhoads Fisher".]*

Apr 27 1874

Rhoads Fisher