

Leon co. File 10
Aug 12/71



Survey returned

Counter 29731

Leon & Fitz
Aug 12/11



Counter 29732

Counter 29732

Sketch File No. 10

Leon County

Dated August 12, 1871

Filed _____ 193 _____

J. H. Walker, Comm.

File Clerk

Descriptive: _____

Sundry Sketches.

counter 29733

112

Beginning at the SW corner of Dan. Duvall survey (file 1-94) - Thenoe

Station	Bearings	Distance	Latitude		Departure	
			N +	S -	E +	W -
1	N 23 W	5772 var	5373.28			2255.13 ✓
2	S 67 W	950		371.20		874.50 ✓
3	N 23 W	950	874.50			371.20 ✓
4	S 67 W	2850		1113.54		2623.03 ✓
5	S 23 E	1624		149.14	63.28	
6	S 67 W	6323		2470.99		5820.17 ✓
7	N 60 W	2900	1450.00			2511.00 ✓
8	S 30 W	1571		1360.49		785.50 ✓
9	N 60 W	2670				2312.62 ✓
10	N 30 E	225			162.50	
11	N 60 W	1895	947.50			1641.27 ✓
12	S 30 W	4361		3776.83		2150.50 ✓
13	N 60 W	1344	672.00			1164.11 ✓
14	S 30 W	1344		1164.11		672.00 ✓
15	N 60 W	620	310.00			526.90 ✓
16	N 30 E	218	188.83		109.00	
17	N 60 W	2391	1195.50			2070.81 ✓
18	N 30 E	316	273.70		158.00	
19	N 60 W	1998	999.00			1729.87 ✓
20	S 30 W	30		25.98		15.00 ✓
21	N 60 W	1313	656.50			1137.26 ✓
22	S 30 W	1002		867.73		501.00 ✓
23	West	1858				1858.00
24	S 30 E	2103		1821.60	1057.50	
25	S 30 E	90		77.94	45.00	
26	S 60 W	5099		2549.50		4415.74 ✓
27	S 30 E	10736		9297.38	5368.00	
28	N 67 E	28389	11091.02		26128.08	
			25588.26	25046.43	33085.36	35475.61
			25046.43			33085.36
Error in Sounding			541.83		Error in Easting	2390.25

Leon Co.

File 10

Field notes, showing
the error existing in
the surveys represented
in sketch file 10. Leon Co.

Aug 12. 1871

F. del Valle
11 L. grant
Leon Co.

1900
 7500
 8000



File 10

Surveyors Sketch.

Aug. 12/71



Counter 29739

Mary Sampson corner chosen for
 H Barns 640 are same

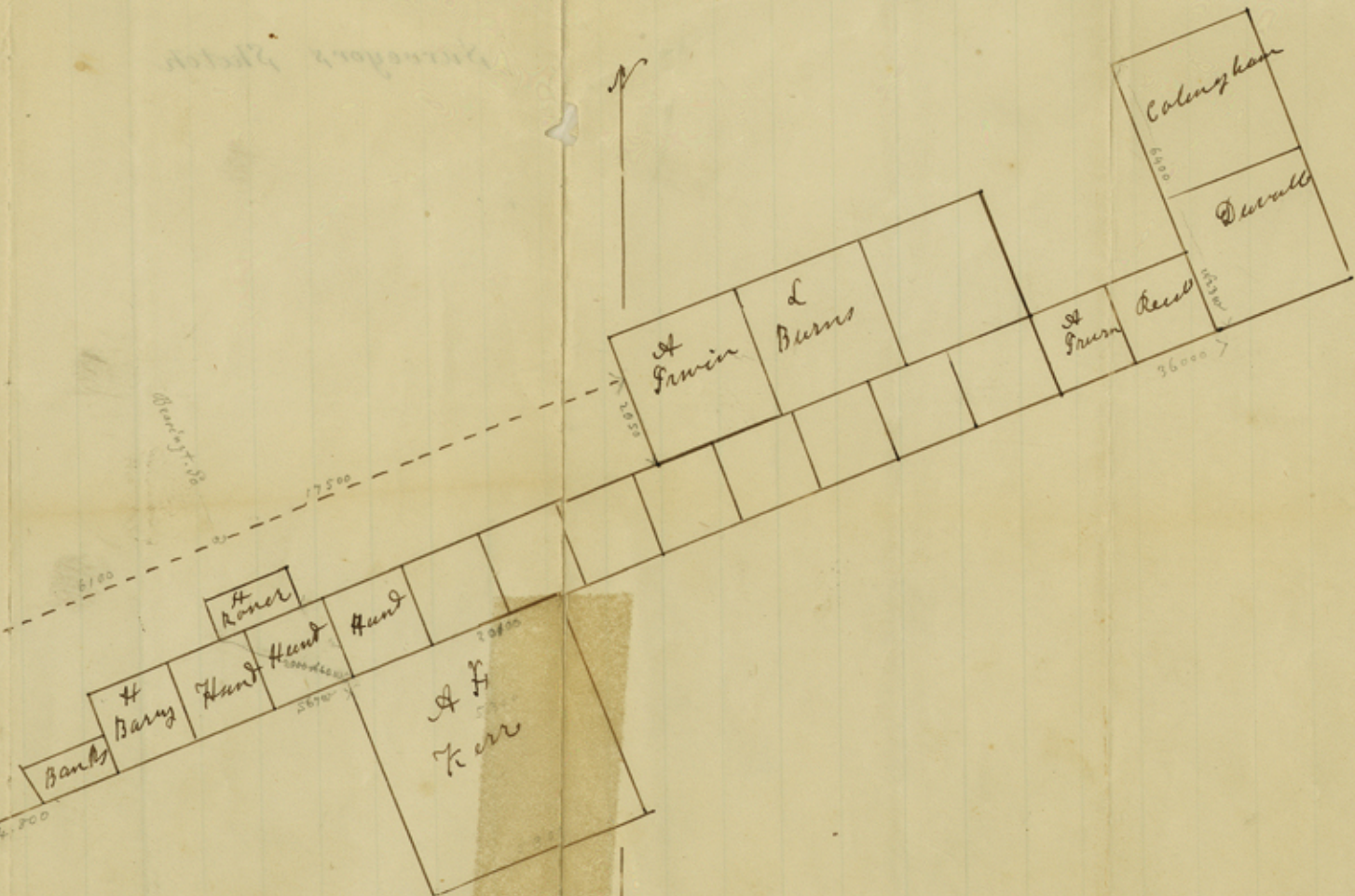

36000
20100
15900
14800
1100
36000
14800
21200
20100
14800
6300

counter 29740

④ File 10
 Leon Co.
 Surveyors Sketch

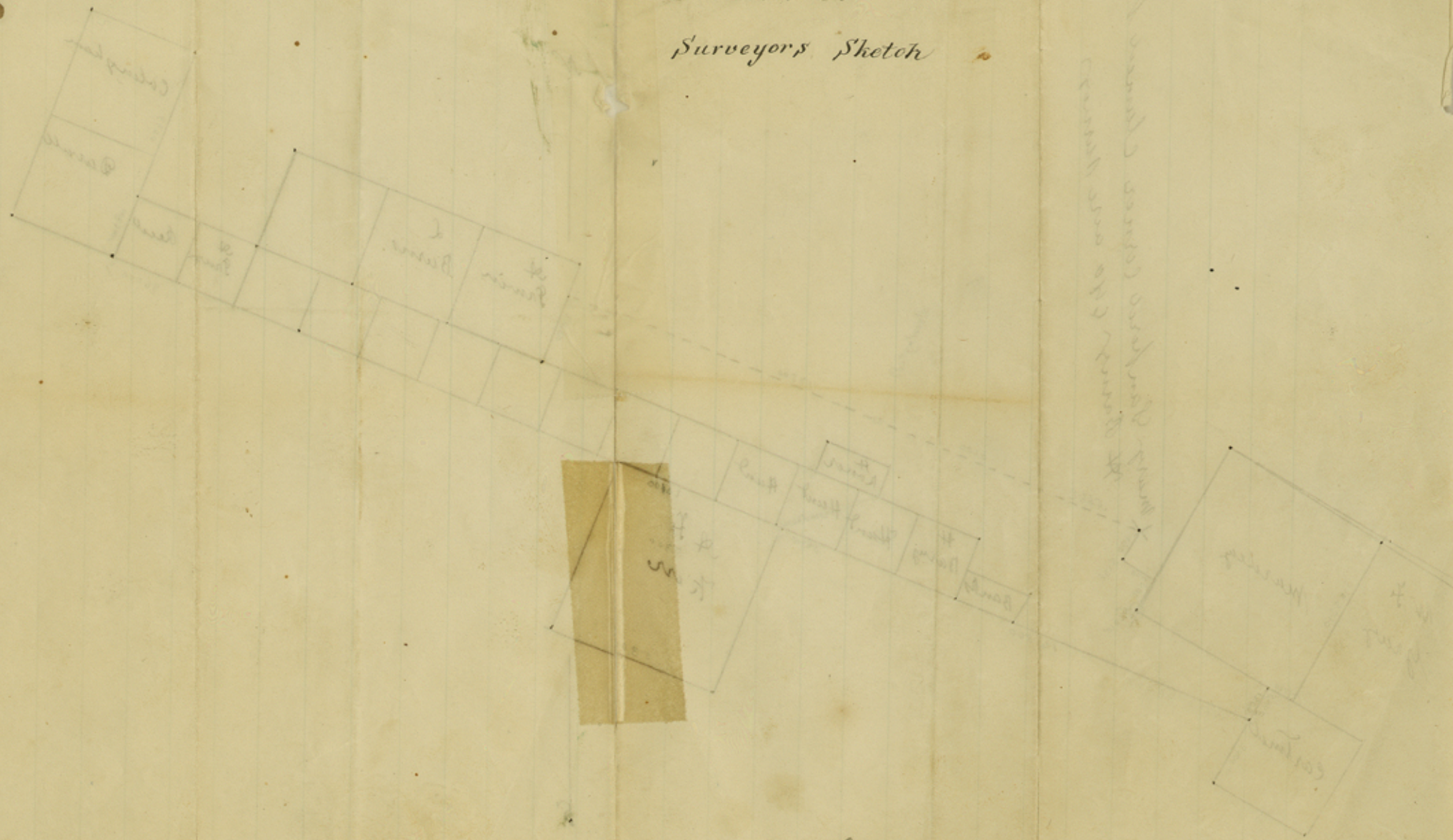

(Faint handwritten notes, possibly describing the survey or the names of the owners.)

f 2⁰⁰

county 29741

7/26/95
 1/26/95
 3/3/95

①

File 10.
Northern part of Leon Co.

Aug 12 1871.

f

N 60 W

N 77 W

SDW



J

Surgors Office Leon County,
March 1st 1872.

Care of Gen Land Office,
Austin Texas.

Dear Sir:-

In compliance
with request from your Office
I herewith inclose you sketch Map of the
Northern portion of Leon County, in
showing the row of 14 Sections of Land
located by Aaron Ketchel in A.D. 1840.
about the precise locality of which doubt
has arisen. This doubt any confusion
I am satisfied has arisen, from the
fact that subsequent Surveys, have
called for said Sections inis, and have
nearly all the Surveys with them that
are the grounds do not connect
with same.

In 1840 Aaron Ketchel who
surveyed said row of 14 Sections, surveyed
first a row of 7 Leagues and Subdivided
land to wit the Taylor, the Permitt, the
Arden, the Ken, the Corattee, the Whitmore
and the Gilman. All of which were open
lands and not patented except the A. H. Ken
The Taylor or Simon Jones Survey was
laid upon and connected with the A.
R. Courtwell Survey, running from
the North East corner of the Courtwell
North 60° East with the South boundary of
the Marlar League (shown in the sketch)

4412 Varas to the S E corner of Mordus League
 Thence S 30° E 537 Varas to Disjoint NB Line
 which says boundary line calls to run
 North of East which is the North boundary
 line of said entire ran of League, in-
 cluding Disjoint any all of said League's
 east & and said line is the South bound-
 ary line of said Ran of 14 Sections, from
 their Eastern commencement to their
 termination.

The Thos Reid Section the Eastern
 part are of said Ran, and the connecting
 Survey of said ran calls to commence at
 the S. W. corner of the Thos Durall 1/3 of a
 League. and is based upon said 1/3 of a
 League, which says S W corner of the
 Durall can be found and identified
 There is no vacancy between the Durall sur-
 vey and the Reid as now represented on the
 County Map. This is the connection, the
 Durall Survey for said ran of sections
 said Reid Survey calls for the Thos Irvine
 640. The Irvine calls for the Whitmore and
 Guilmore Leagues on the South and the
 William Pracks on the North. The Pann's
 Sides, and Jones 640' of said ran call for
 the Pracks. Durall and Irvine 1280' on the
 North, each of which 1280' I have identified
 and are on the granting property. So the Eastern
 portion of said ran of Sections are repre-
 sented on the present County Map as they are
 on the granting note the exception that there
 is no space between the Reid & Durall sur-

A

veys. I have identified by survey and finding
 the corners the A & K Ker League, ~~and being same~~
 on the ground as represented on the map -
 Such being the case, to run said Southern
 boundary line, ^{from the dorsal corner} according to the call South
 1/2 West, it will intersect the Northern boundary
 any line of the Ker League property, and
 the extension beyond the Ker League will
 show the Western extremity of said range of
 Section as to their position ~~with~~ as south
 of the Northern boundary of said Ker League
 as represented in the sketch map here
 with sent. I have demonstrated this by
 actually running the extension of said
 line West of the Ker League, and by a
 partial tracing of same line east of
 the Ker League.

I am satisfied from actual survey
 and measurement that the said range of sec-
 tions, ^{and other surveys shown on the map} will not fill the space between the
 dorsal S & K corner and the East boundary
 line of the K & R tract, by at least two miles.
 This arises from the fact that the lines of
 leagues upon which I am advised to be widely too
 large. I am of the opinion that said range
 of sections were never actually surveyed
 and measured but simply called for and
 based on said Row of leagues. Hence
 the leagues being too large it still or
 extends said range of sections from a
 mile and a half to two miles further West
 on the map than they are on the ground.
 I find the volume, Burns & Braab's 1280.

by actual measurement, 300 Varas too large each way. I further state that after passing the Irvine 1280 I have never found any trace of the North boundary line of said ran of Sections West of my transverse their whole extent.

I have never been able to find the corners of said ran of Sections except the Easternmost one the Thos. Reig. I further state that from actual measurement from the North boundary line of the River League North 23° West, to the John Maddigan, way to the Ran 320 and Survey the Space is 2000 Varas, so that there can be no conflict as is shown by the Sketch map between any of said surveys North of the ran of sections and the Sections. The only mode by which said ran of Sections can be identified one from the other, and their actual Western terminus is to commence at the several S.W. Corners, running S. 67° West for 14 miles, and establishing corners for same at the end of every mile. This I am satisfied will demonstrate that there is all the space on the ground that the Sketch map shows between their Western boundary and the least mid survey.

I would further state from actual survey and measurement that from an extension of the Northern Boundary of the River League S. 67° West to a point perpendicular to the James Byrns survey, that a line running at right angles to this extending line would pass over a space of 3800 Varas before

A3

reaching Burns South boundary line, or in other words that the James Burns South boundary line cannot touch or be nearer at any point to the North boundary line of the ran of Section than 8900 Varas.

W. A. McWhiter former Survey of this County Surveyed the James Burns Survey and calls for the North Boundary line of said Ran of Sections as the South boundary line of said Survey. He about the same time, ^{Surveyed} ~~called~~ for the McKinney and Williams Survey, and calls for the North boundary line of said Sections as the South boundary line of this Survey, an extension of the South boundary line of the Burns North $67^{\circ} E$ to a point opposite the McKinney and Williams Survey, will show that a line passing from this point $S 23^{\circ} E$ will have to pass over a space of 1900 Varas to reach the said Section line the S B of McKinney and Williams. This I have demonstrated by actual measurement. The fact is the Burns Survey is one mile from the Sections on the ground, the McKinney and Williams bears upon them on the ground.

The Survey of McKinney & Williams calls for in the Duckworth papers notes was for 240 acres, and was never sent to the General Land Office, and there is no such Survey now in existence.

In conclusion I repeat that in my opinion the only certain

L. 200. 00. 58. 10
File # 10

and practical method of determining
where the West line or boundary of
said ran of 14 Section is, is by actual
measurement from the SW corner of
the Deval Survey. According to the law
it is impossible to connect said ran of
Sections with the Deval Survey, any
with them any the other Surveys in
attempting to connect with the Court
There is an unoccupied space be-
tween the West line of said Sections and
the ground that cannot be occupied
by any of the Surveys now in existence
on the ground, and all of the confusion
that now exists has been caused by
Surveyors calling for said Sections
or some of them when in point of
fact they were ignorant of their proper
locality. The only conflict between any
of these Sections and another survey
is that of the St. Kibbey, and in my
opinion, a careful measurement of
the 14 miles from the SW corner
of the Deval will show that this con-
flict does not exist.

It will be perceived that the South
boundary line (after the C. C. Staty 1440
Survey) and the South boundary line of
the Jordan League are the same in
the Skelton map. This I have demon-
strated on the ground by actual Survey
and the SW corner of the Staty and the
North East corner of the Court are

the same. The accompanying sketch
map truly represents the position of
the Survey there delineated on the ground
with the exception, that when the said
run of sections is actually measured &
may change the relative position of their
extreme Western boundary. To all
of which I James J. Simms County
Surveyor of the said County of Lincoln
do hereby officially under my
oath of Office Done at Lawrence
ville, said County this the 1st
day of March A.D. 1872. At
test my hand
James J. Simms
S. J. Lee

counter 29751

[Faint, illegible handwriting on the left page]

② Leon County
Sketch file 10

[Faint, illegible handwriting on the right page, mostly obscured by bleed-through]

73⁵⁰

[Faint handwriting, possibly "Lance's"]

Memorandum

The examination of the northern part of the map of Leon County shows the following discrepancies and contradicting calls and statements of surveyors, to wit:

1. The boundaries of the surveys, surrounding the John Harrington survey file 1-799 include more land than the Harrington field notes call for.
2. The G. Kuykendall section, B-516, intending to ~~over~~locate ^{over} a section, formerly in the name of Thos. Reed, calls for a distance of 1500 varas between its East corner and the North corner of a survey in the name of E. Welch, file B-304. This call would bring the Kuykendall survey in conflict with the Thos. Irvin section, file 3-1123, while it calls for the S.E. corner of the Irvin for beginning.
3. The J. Hunt section S-17 calls for a distance of 464 varas S 67 W between his N.W. corner and the South corner of A. Irvin 1280 acres survey file 2-43.
The S. L. Jones section S-38 makes the same call.
4. The East boundary line of Chas. W. Kelly's survey file B. 540 calls to intersect the N. B. line of James Carson section (S-114) at 1252 varas from his N.W. corner, while on the County map it intersects the N. Boundary line of a Railroad survey file S-723 (formerly in the name of G. Robinson)
5. According to the statement of the County surveyor

Both of these calls indicate an error of a section

Memorandum

The examination of the northern part of the map of Leon County shows the following discrepancies and contradicting calls and statements of surveyors, to wit:

1. The boundaries of the surveys, surrounding the John Harrington survey file 1-799 include more land than the Harrington field notes call for.
2. The G. Kuykendall section, B-316, intending to ~~overlocate~~ ^{over} a section, formerly in the name of Thos. Read, calls for a distance of 1500 varas between its East corner and the North corner of a survey in the name of E. Welch, file B-304. This call would bring the Kuykendall survey in conflict with the Thos. Irvin section, file 3-1123, while it calls for the S.E. corner of the Irvin for beginning.
3. The J. Hunt section S-17 calls for a distance of 464 varas S 67 W between his N.W. corner and the South corner of A. Irvin 1280 acres survey file 2-43.
The S. L. Jones section S-38 makes the same call.
4. The East boundary line of Chas. W. Kelly's survey file B-540 calls to intersect the N. B. line of James Carson section (S-114) at 1252 varas from his N.W. corner, while on the County map it intersects the N. Boundary line of a Railroad survey file S-723 (formerly in the name of G. Robinson)
5. According to the statement of the County surveyor

Both of these calls indicate an error of a section

Williams survey for beginning corner, which call implies, the position of the McKinney survey to be in connection with the Hunt survey and not with the Duchworth and so it is represented in the latest sketch of the surveyor (dated July 3/77) filed with this memorandum, in which sketch the space occupied by the McKinney & Williams survey, as connected with the Duchworth is left blank.

The compilation of the surveys represented in sketch No 10 and the calculation of the courses indicated by the dotted lines, show, that the distance between Dan. Davalls (1-94) South corner and Margareth Puffells (1-444) East corner is longer than the connections along the southern boundary of that complex of surveys admit, and the above mentioned sketch of the surveyor represents the connection interrupted between the H Barney section (5-43) and the Mary Sandford survey 3-337, but fails to give distances and courses which would enable this office to effect a correction of the map.

The Alfred Rainer 320 acres survey file 3-318 calls for the North boundary of Jonathan Hunt S-21.

The J. Burleson (1-369) and A. Welch (B-304) call for South line of surveys file S-42, S-39, S-44, 3-1123.

The lines ^{calling and} called for in these surveys differ in their courses from N 65 E to N 67 E. This seems

to indicate, that an error exists in the course of the 14 sections as represented on the map of Leon County. A change of 2 degrees in the course of these sections, from the S. Duval S. corner as a centre, seems to remove the greater part of the conflicts along the NB line of these surveys.

7. The extent of the vacancy existing according to surveyors sketch, between the H. Barney section 5-43 and the Mary Sanford survey 3.337 can not be determined before information can be obtained giving course and distance between an established corner of one of the 14 sections and an established corner of either the Margaret Russell or one of the adjoining leagues or of any survey directly connected with one of these leagues.

Surveys D-1005 and D-1084 must remain suspended until the true position of the Mc-Kinney & Williams 160 acres, and the true course of the 14 sections can be ascertained. —

Genl. Land Office Aug 12/71

Schenck

Aug. 12. 1871.

Leon Co.
File 10
Draftsman's Memo
randum.

2.00

Centerville Leon County Texas
Mr Joseph Kuebler
Com of L. Land Office
Austin Texas

May 2nd 1892

enclosed I send you
the report of the surveys in the west part
of this County and hope to hear from
you soon if there is any thing more
you want explained please let me know
what it is and if necessary I will go
on the ground and measure any line you
may want measured

I have received the Entry of Mr
Eggleston and recorded them in the
entrys of my Office and will make the
survey as soon as the River Bottom gets
dri enough the coping lines are covered
in water at this time

as ever your friend
James J. Simms

Centerville Leon County Texas

April 30th 1878

Jacob Kuehler Esq
Commissioner of Land
Austin Texas

Sir in compliance with your request I make the following report of the surveys in the Northern part of this County at the N E corner of the W F Gray 2/3 of a League survey the bearing trees are gone but the lines are marked plain and the corner can be located beyond a doubt from the N E corner of Gray's survey the line runs S 30 E 5310 m a stake in the North line of H R Cartmell 1/3 League survey where a Post Oak is West 5 m and a Post Oak is N 80 E 8 m from the S E corner of Gray's survey to the N E corner of Cartmell is N 40 E 720 m in running a line from the N W corner of A F Kerr League survey at S 67 W at 14,800 m intersect the East line of Cartmell 200 E 12 m from the S E corner of the same the East line of Cartmell is 3000 m long Beginning at a stake in Cartmell E line S 30 E 1300 m from the N E corner thence N 67 E 36,000 m passing Kerr's N W corner 14,800 m a 20,100 pass the N E corner at 36,000 the S W corner of Daniel Derrall 1/3 League from the S W corner of Derrall to the N W corner of Calingham 1/3 League is N 23 W 6,400 m

The Mary Sanford — are
survey and calling for the Barney
N or corner of Barney 640 acre survey
begins at a stake and runs S 83 E 950
is or there a bow as there are 3 corners
and 3 lines claimed as the South line
of Mary Sanford I cant tell the right
one none agreeing to the calls in
the field notes then at 1100 is in ter
sect the E line of A Mardey League
N 30 W 900 is from the S E corner
of said League and there I found
five (5) plainly marked corners in a
space of 200 is and none agreeing with
the calls in the field notes of Mary
Sanford but all claimed for the Sanford
corner. at the beginning corner I found
baring trees to correspond to the calls
in the Sanford field notes but would
not agree with the calls in A Barney 640
acre survey I found a marked line
as represented in the annexed sketch
running from said corner N 66 E at 6100
found a Post Oak marked as a baring
tree the line continued marked the
same way at 17,500 is intersected the
West line of A Prewin 1280 acre survey
S 55 E 2050 is from the S W corner of the
same the line here described appears
to be of the same date and marked
with the same Axx that the Mary Sanford
survey was the connection at the East
end of the Kitchel surveys must be given

up on the connection at the west
end you cant hold the survey made
by Kitchel where they are marked on
the ground and keep them connected
with the James Burns & Mary Sanford
Survey. The N E & N W corners of
The Kerr League can be established
by the bearing trees standing on the
ground. The S E & S W corners I dont
think was ever made. The beginning
corner of A Runer is N 60 W 2000 is from
the N W corner of the Kerr League

I James J. Simms County Surveyor
of Leon County do certify that the
foregoing is a correct statement
as found on the ground by actual measure
ment

James J. Simms
S. J. L. Co

[Faint handwritten text, possibly bleed-through from the reverse side of the page.]

Part of sketch file
no 10
Leon Co

Leon County

©