

1891-12-21-1891

J. R. Faulk

1881. A. 1011 D. 1111
D. 1011 D. 1111
H. 1011 D. 1111
Connections to the T.C.
W.D. 1011 D. 1111

Office of the Surveyor
Liberty Co. Va.
No. 1011 D. 1111

Magnetic Variation 2° 50' E

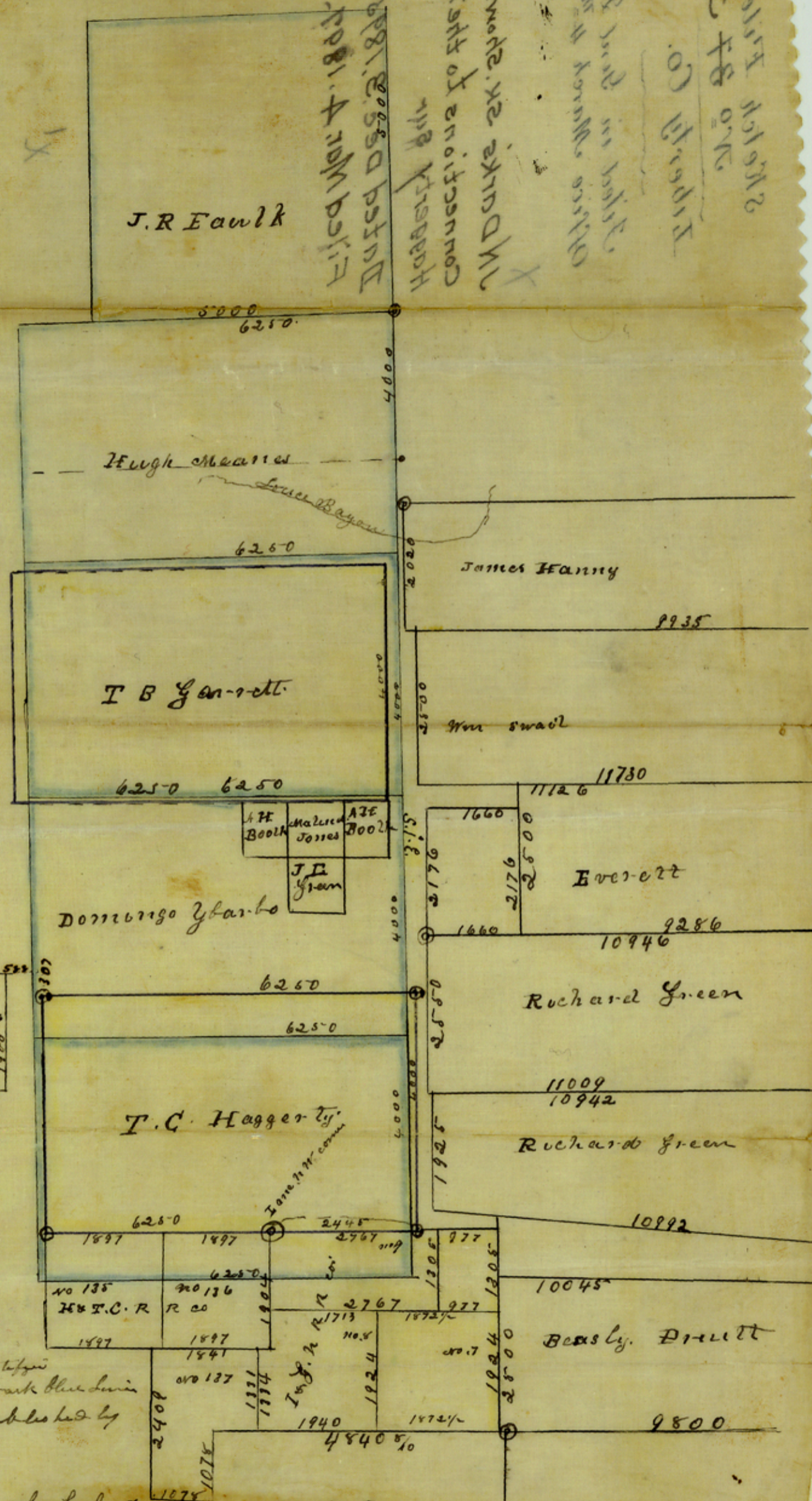

corners, mark. ©, found by
Haggerty established by J. W. Dark blue line
J.R. Garrett blue line established by
Fran sent surveyor.

J. W. Dark Co Surveyor of Liberty
Co. Va. do hereby certify under
my official oath that the above plot
show the true position of the survey.
J. W. Dark
Dec 3rd 1895.

counter 29981

Sketch File 37^a
No 37 55

Liberty Co.

Filed in Genl Land
Office March 4th 1897

JN Darks SK. showing
connections to the T. G.
Haggerty Sur

Dated Dec. 3, 1895
Filed Mar. 4, 1897.



W. C. Haggerty

J. B. Darks

X'

County 29982

Prepared & Mounted
July 1951 - Jander

This sketch shows the connections
 between the land of J. B. Darks
 and the land of T. G. Haggerty
 as shown in the sketch of
 Dec. 3, 1895. The sketch
 shows the land of J. B. Darks
 as being adjacent to the land
 of T. G. Haggerty. The sketch
 also shows the land of W. C. Haggerty
 as being adjacent to the land
 of T. G. Haggerty. The sketch
 is a copy of the original sketch
 of Dec. 3, 1895.