



File 5.

Limestone Co  
west of Springfield  
plotted in office

---

counter 30161

(Corrected plat of the Western  
 of Jameson County  
 received - March 10 1848  
 Platted on map  
 Robertson  
 1848

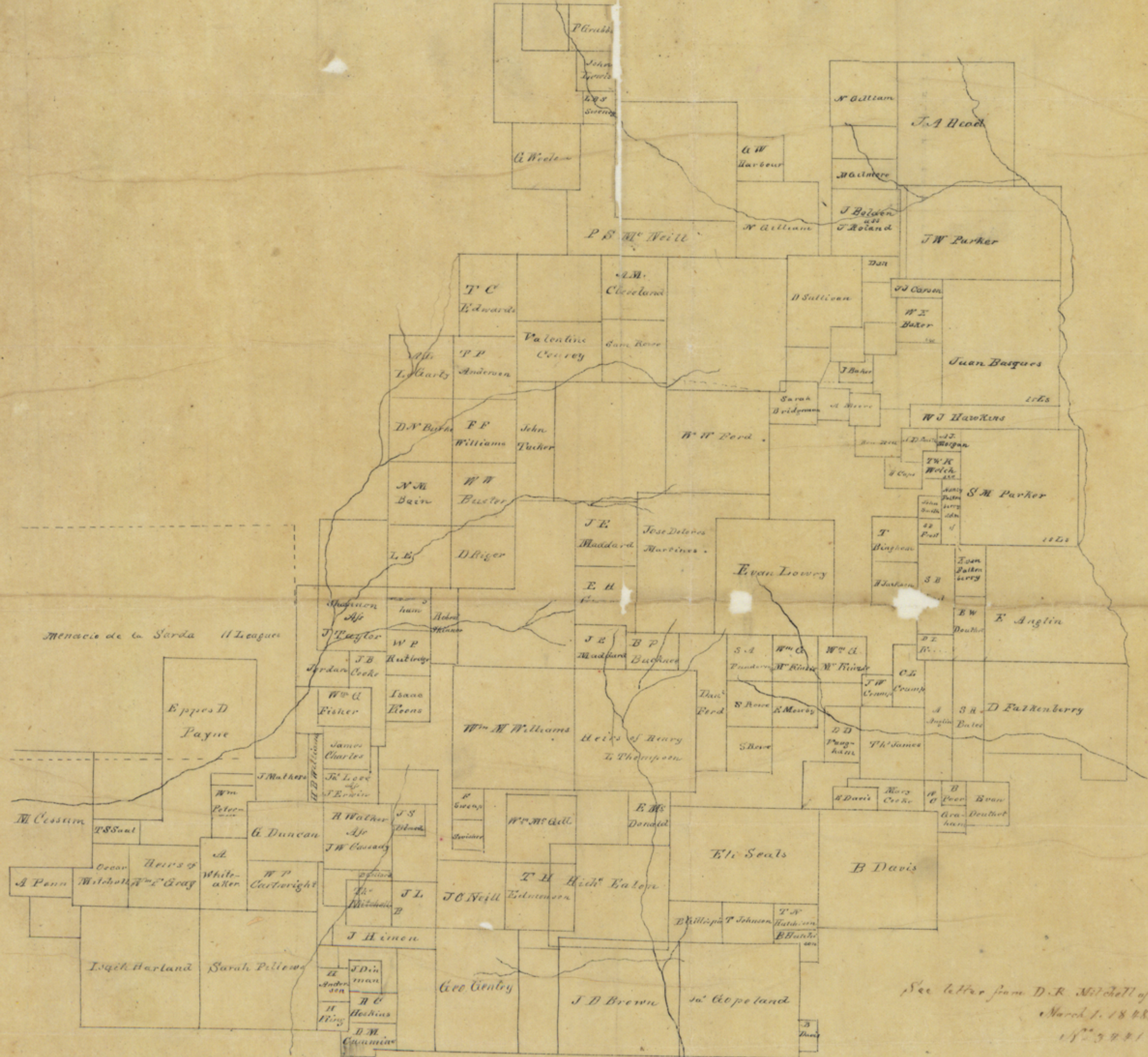

Menacio de la Sarda 11 Leagues

See letter from D.R. Mitchell of date  
 March 1. 1848.  
 1848

Corrected plot of the Western part  
of Timestone County.  
received - - March 10 1848  
Plotted on map

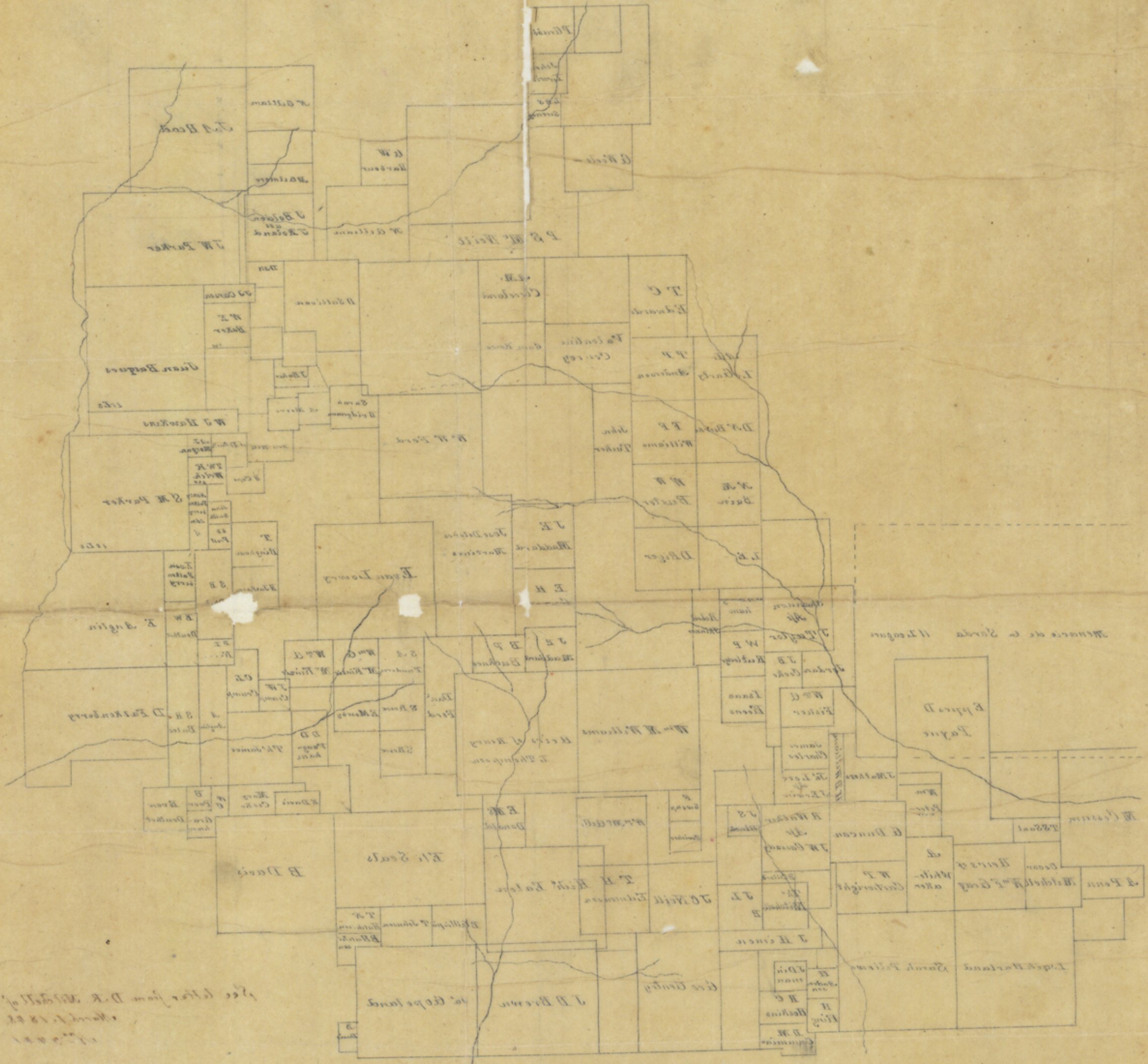

See letter from D. R. Mitchell of date  
March 1. 1848