



N.B. The lines marked thus, run at  $10^{\circ}30'$  E. variation, the  
 others at  $9^{\circ}45'$  E. Johnson.  
 J. M. Johnson Deputy Surveyor for Texas District certifies  
 the above diagram to represent the situation of surveys made  
 by me with their connections with other surveys, as per field  
 notes returned to the District Surveyors Office, San Antonio, Tex.  
 Nov. 1849.  
 J. M. Johnson  
 D. B. Co.

Sketches 2 File 23 <sup>File 2, Llanos  
1858</sup>

— Bexar Dis. —

— Gillespie County —  
Honey cr. a tributary of the  
— Llanos River. —

— Matted & delivered by Col. Johnson  
— Nov. 6: 1849 —

Llano Cr.

— Junction of Honey Cr.  
and Llano River near  
the East Boundary  
of the County.

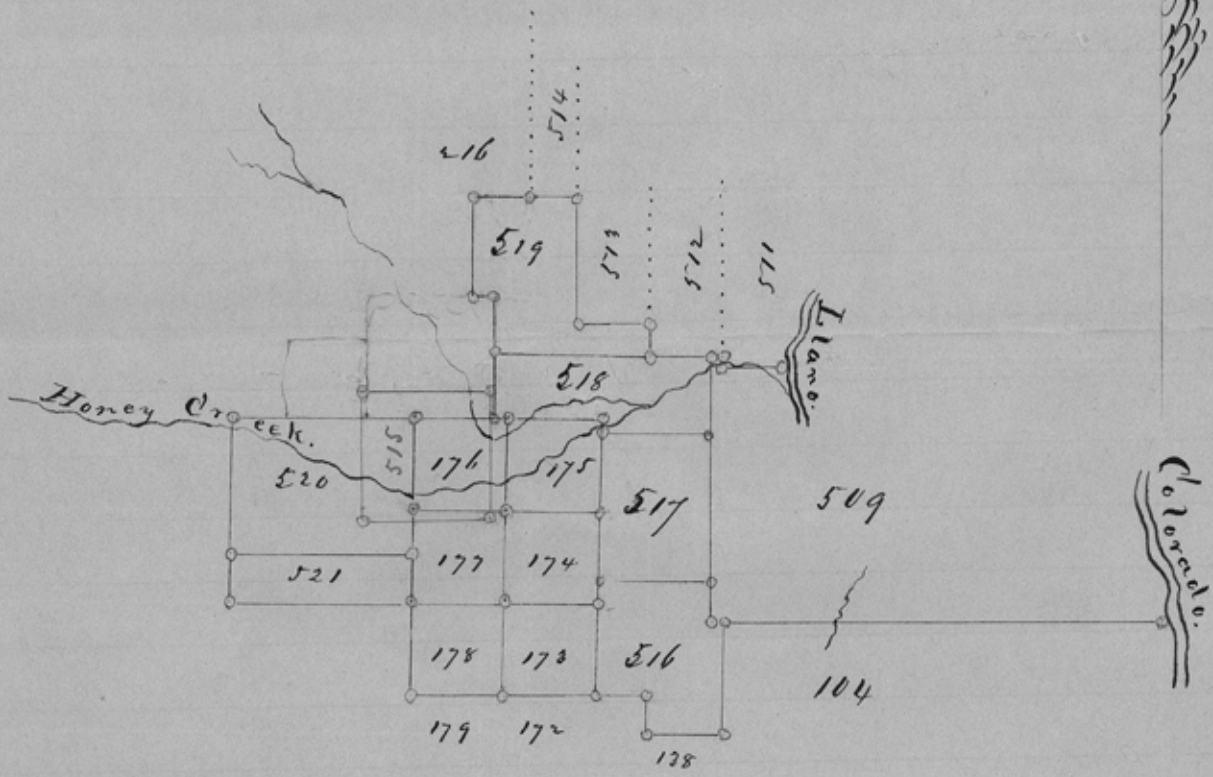

1000 yards to an inch.

counter 30349

10030

7000