

State of Texas

Llano County } Field notes of the connecting  
lines between the John Ingram survey N<sup>o</sup> 225-  
and the Pedro Lopez sur. N<sup>o</sup> 515 situated S.E.  
of Llano town in Llano County.

Beginning at the N.W. corner of the  
John Ingram survey N<sup>o</sup> 225, a stone mound  
(No bearing trees found)

Thence S 10° W at 4430 varas the S.W.  
corner of said survey, a P.O. 30 inches in dia  
marked X brs N 59° W 36 vrs. I believe this to be  
one of the old bearing trees.

Thence S 80° E at 3230 varas found the  
corner of the J. C. Oatman survey a stone  
mound with both bearing tree standing as  
called for. (20 vrs south of this cor I found old stone  
mound and fallen tree the proper course and distance  
for one of the bearing trees of the Jack Shackelford  
survey)

Thence S 10° W at 645 varas the N. W. corner  
of the Wm M<sup>c</sup> V. Clements survey both bearings  
standing as called for.

Thence East at 1475 varas came to  
another corner of said Clements survey, bearing  
tree standing as called for.

Thence South at 320 varas stone mound  
corner of said survey

Thence East at 310 varas the N.W. cor.  
of the L. C. Ferguson survey bearings as called  
for. at 195 varas more the S.W. corner of the  
S. St. Goodman survey, bearings standing as  
called for. at 755 varas more the S.E. corner  
of said Goodman sur bearings as called  
for.

Thence South at 355 varas the S.W.

Corner of the Littleton Brown survey of 1060 acres, the bearing trees standing as called for.

Thence East at 2940 varas the S.E. corner of said Brown survey (bearing trees as called for) at 272 varas more the N.E. corner of State sur. N<sup>o</sup> 2, a stone mound.

Thence South 150 varas to stone mound the most southern S.W. corner of the M.J. Perry survey—

Thence East at 1480 varas the N.W. corner of the Pedro Lopez Survey N<sup>o</sup> 515, found both bearing trees standing as called for.

Surveyed Jan. 2<sup>nd</sup>, 3<sup>rd</sup>, 4<sup>th</sup> & 6<sup>th</sup> 1890

J. W. Alexander } Chain  
E. A. Alexander } Carriers

I, E. H. Alexander County Surveyor of Llano County do hereby Certify that I made the above and foregoing survey of the connecting lines as set forth in the foregoing field notes and that ~~the~~ lines, distances, and corners are truly described to the best of my knowledge and belief.

E. H. Alexander  
Co. Surveyor Llano County.

Llano Jan. 7<sup>th</sup> 1890.

1 State of Texas 3

2 Llano County 3 Field Notes of the connecting  
3 lines of the W<sup>m</sup> Wood, Jesse Evans, P. Lopez,  
4 W. J. Hill, &c Surveys

5 Beginning at a stone mound the N.E.  
6 corner of the John Lewis Sur. N<sup>o</sup> 179 - bearing  
7 trees cut down - stumps standing about  
8 as called for.

9 Thence North over one mile, I found  
10 no marks or evidence of any line having  
11 been run, or any bearing trees for corner  
12 at the end of mile, nor for some distance  
13 beyond that distance. There is no dispute  
14 about the N.E. corner of N<sup>o</sup> 179.

15 I then went to the S.E. corner of the  
16 W. J. Hill sur. N<sup>o</sup> 176 (by common reputation  
17 the corner of Hill) a stone mound, bearing  
18 trees gone, but found Live oak stumps course  
19 and distance called for.

20 Thence South 1950 varas stone mound  
21 the N.W. corner of A. B. & M. N<sup>o</sup> 1 bearings  
22 standing as called for for said survey  
23 N<sup>o</sup> 1, and on the line running East about  
24 40 varas from this corner I found two P.O.  
25 trees lying on the ground, the course and  
26 distance from their roots would exactly  
27 place the corner in this line.

28 Thence beginning at last mentioned  
29 stone mound at 1912 varas found the S.W.  
30 corner of said N<sup>o</sup> 1, stone mound and bearing  
31 trees as called for. No evidence of any  
32 other bearings, I found a plainly marked

old line all the way from the beginning of  
of these lines running south.

Thence West 1040 varas. Thence South  
484 varas to said N.E. corner of N<sup>o</sup> 179.

I found the P. Lopez S.E. corner 42  
varas N 27 $\frac{1}{2}$  W from the W. J. Hill S.E. corner,  
both bearing trees standing as called for.

Thence beginning at said Lopez corner  
and running North, at 170 varas came  
to bank of Honey Creek, at 1880 varas a  
mound made for S.W. corner of W<sup>m</sup> Wood  
survey, found this line plainly marked  
all the way, also old line running from  
the said Hill S.E. corner near this  
all the way.

Thence East with marked line 1890 varas  
stopped on north bank of Honey Creek,  
bearings of this corner gone.

Thence South crossing Honey creek  
and with marked line, at 175 varas came  
to N.W. corner of Evans Sur. N<sup>o</sup> 517, bearing  
trees standing as called for.

Surveyed June 18<sup>th</sup>, 19<sup>th</sup> & 20<sup>th</sup> 1889.

Robt. Fisher & J. W. Alexander Chain Carriers

I, E. H. Alexander County Surveyor of Llano  
County do hereby Certify that I made the  
foregoing survey of connecting lines of the  
surveys therein mentioned according to law;  
and that the limits, boundaries, and corners,  
with their marks natural and artificial are  
correctly described in the foregoing field  
notes and accompanying Plat, and that

1 the survey was actually made on the  
2 ground.

3 Plano Texas Nov. 2<sup>nd</sup> 1889.

4 E. H. Alexander  
5 Co. Surveyor Plano County.

6  
7  
8  
9  
10  
11  
12  
13  
14  
15  
16  
17  
18  
19  
20  
21  
22  
23  
24  
25  
26  
27  
28  
29  
30  
31  
32

N<sup>o</sup> 12.

Llano County

32 31 30 29 28 27 26 25 24 23 22 21 20 19 18 17 16 15 14 13 12 11 10 9 8 7 6 5 4 3 2 1

Connections

filed in the General Land  
Office June 10<sup>th</sup> 1890.

Dated Nov. 2, 1889

R. Shelley  
Chief Clerk.

Surveys on Honey Cr.

counter 30385

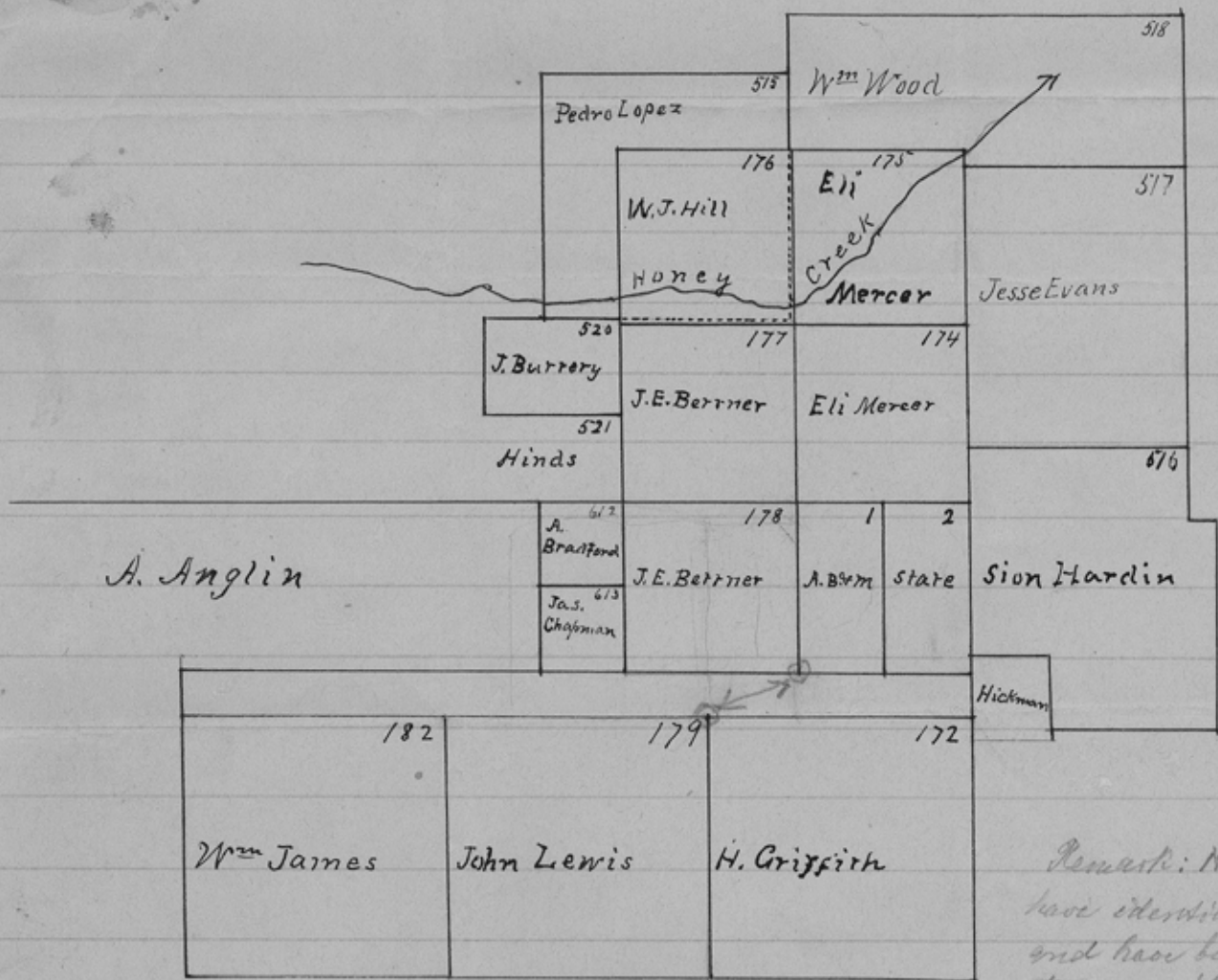

Remark: Nos. 179 & 178  
 have identical bearings  
 and have been made by  
 the same Surveyor and  
 therefore cannot be separated  
 B.W. Profiles

State of Texas }  
 Llano County } I, E. H. Alexander County Surveyor of Llano  
 County hereby certify that the above sketch is a true  
 representation of the surveys, lines and corners, of surveys  
 Nos 179, 178, 174, 177, 175, 176, 515, 518, 517, and Nos 1 & 2  
 according to lines run by me June 18<sup>th</sup>, 19<sup>th</sup> & 20<sup>th</sup> 1889.  
 This Nov. 2<sup>nd</sup> 1889  
 counter 30386  
 E. H. Alexander  
 Co. Surveyor Llano County