

COPY

30

JACOB KUECHLER

FIELD NOTES

N - 2 - 30

1879

Jacob Kuechler's Field Notes (Field Book)
Texas & Pacific Ry. Co. 80 Mile Reserve

Legend.

In the summer of 1883 the State Land Board of Texas, appointed Paul McCombs to resurvey the 80 mile T & P Reservation west of the Pecos River, to see what error if any Jacob Kuechler had made in the width of same, in his survey of 1879. W.H. Abrams secured Jacob Kuechler to go along with the surveying party and identify his original corners, and Kuechler had a copy made of his original field notes and took this book along on the trip. The Survey was made in the fall of 1883, and Jacob Kuechler used this book, which he told McCombs was a correct copy of his original field notes of that survey of 1879. He used this book continuously on that trip to identify his corners, and at the close of the trip, at the request of McCombs, Kuechler gave this book to McCombs for use in any future survey of those lands. And it was so used for several years. Sometime in 1886 or 87 this book became mislaid and could not be found, although it was diligently sought for many years. A few days ago in going over some old papers, My wife found this book and brought it to me, and I at once recognized it as the lost book.

6 Oct 1883.
Austin, Texas. Paul McCombs-

General Land Office.

Austin, Texas,

Received this book from Paul McCombs as a gift to the State of Texas, this 23rd day of October 1933.

J. H. Walker

Commissioner. G. L. O.

State of Texas,
Travis County.

Before me, the undersigned author-

ity, on this day personally appeared Paul McCombs, known by me to be the person whose name is signed to the foregoing Legend, and he being by me duly sworn, says under oath, that the statements in said foregoing Legend are true and correct to the best of his knowledge and belief, and are made without any consideration therefor.

Subscribed and sworn to before me this 16th day of
October 1933.

Paul McCombs
H. Hedick
Notary Public, Travis County,
Texas.

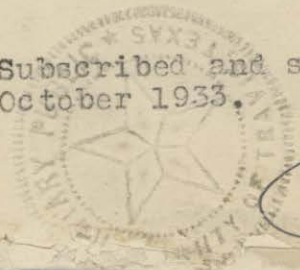

Line New Mexico

October 3rd West at

576 vs across Pecos River

PA 590 W auk at 800 vs monument

at 1900 vs stone mound NW 5-57

Thence West with south line of New Mexico

at 1105 vs Monument North

6 1/2 vs

82 1/8

Monument of vs Guadalupe P. S 70 W mag ^{02 S. 80 1/2 W}

Head of S S 69 1/4 W mag.

1900 vs stone ant fm ... 15 NW 6

Guad P. S 70 3/8 W mag (2) s ... w.

rock in the ground mtz T.P. S 17 1/2 E 92

1) Thence West 1900 vs rock on the mtz
T.P. S 70 W. NW 1-58

2) Thence West 1900 vs stone m^d of 00 NW 2
a rock in the gr mtz T.P

S 57 1/2 W. 15 vs (S.P. S 69 3/4 W 77

3) Thence West 1900 vs (..... NW 3

) stone m^d of W
a stone in the ground mt T.P S x 16 vs ^{S 17 1/2 W.}

4) Thence West 1900 vs stone m^d of W in NW 4

stone in the ground m^d T.P. N. 7 1/2 W. 19 vs

" " " N 35 W 16 vs

//

October 4th

- 5) Continuing West 1900^{ft} NW 5
to a stake and mt on the north bank
of Delaware Creek Thence East 100^{ft}
- 6) Thence South 1900^{ft} on the north side of
a hill. Thence West 100^{ft} to a large
rocks m^{ts} T.P. with a mt of rocks
on its top NW 8
- 7) Thence West 1900^{ft} stone m^{ts} m^{ts} T.P. NW 7
- 8) Thence West at 245^{ft} cross Delaware
Creek at 1600^{ft} top of a hill 1900^{ft}
stone m^{ts} m^{ts} T.P. NW 12-59
- 9) Thence West 1900^{ft} stone m^{ts} T.P.
large prairie NW 11-
- 10) Thence West 1900^{ft} stone mt.
m^{ts} T.P. NW 10
- 11) Thence West 1900^{ft} (Valley of Delaware
Creek) stone m^{ts}. NW 9-
Thence West 1560^{ft} hill

Continuing October 5th

- 12) 1900^{ft} stone m^{ts} fr. w NW 8
a Rock br S 87 E 147^{ft}
round hill N. 3/4 about 230^{ft} on other
S. 15 E about 700 ft
- 13) Thence South 1900^{ft} rocks m^{ts}
m^{ts} T.P. NW 17

- 14) Thence south 1900 ^{NW 20} ~~20~~ ²¹ route m^d m^d - T.P.
Thence south at 530 ²¹ a road
- 15) 1900 ²² stone m^d m^d - T.P. NW 29
- 16) Thence south at 1630 ²¹ cross Delaware
Creeks 1900 ^{NW 32} ²² stone m^d m^d - T.P. f.w.
1. Boyer Mountain br. N 44 1/4 W.
2. R. Mt brs. N 61. W.
- 17) Thence West at 830 ²² cross Delaware
Creeks at 1600 ²⁵ stone mound - stop
Continuing West October 6th S. day
1900 ²¹ stone m^d m^d - T.P. f.w. first
round hill N 31 W. NW 31
G.P. brs. S. 86 3/4 W. Round Mt
south of Delaware Creeks S. 42 1/2 W.
- 18) Thence West 1900 ²¹ stone m^d m^d
T.P. f.w. Round Mt south of Dela
ware Creeks brs S 27 1/2 W. NW 36-60
2nd Round hill N 34 W.
Delaware Creeks S. about 1050 ²¹
- 19) Thence West 1900 ^{NW 35} ²¹ stone m^d m^d.
T.P. f.w. 1. Red Mt brs N 15 W
2. " " " N 5 W
Red Mt south of Delaware Creeks
brs. S. 7. W. G.P. brs. S. 86 1/2 W
- 20) Thence West 1900 ^{NW 34} ²¹ stone m^d m^d.
T.P. f.w. north of a hill 3rd round
hill N 48 W. 4th N. 65 W. G.P. S. 86 1/2 W.

Thence South abt 970²¹ to Dela
ware Creek (no crossing went back
to corner)

21) Thence West at 320²¹ cross road
NW 33 1900²¹ stone mt fr w. 4th round
hill br. at 57 1/2 W. Round mt
south of Del Creek br S 35 E.
G.P. S. 86 1/4 W. (3 3/4)

22) Thence West 1900²¹ to a stone mt
mted T.P. fr w. Round mt south of
Del Creek br S 47 1/2 W. Needle mt
S. 19 3/4 W. - (Round mt S 15 E
about two miles) NW 32
October 7th continued

23) West 1900²¹ NW 31 stone mt mtd T.P.

24) Thence West NW 36-61 1900²¹ stone mt

25) Thence West 1900²¹ NW 35 stone mt fr w
on top of a ridge a cedar mtd.
x N. 58 W 95²¹ a cedar S 22 E 30²¹
needle hill S 6 1/4 W G.P. S. 85 1/2 W (4 1/2)

26) Thence South 1900²¹ stone mt fr w.
cedar 8 brs East 120²¹ cedar 12
brs S 23 W 101²¹ NW 38

27) Thence South at 1500²¹ cross road
1900²¹ stone mt mtd T.P. NW 47

Thence South 700^{ft} north bank of
Itavaue Creek fr w. S.P. N 89 1/2 W.
Thence West at 810^{ft} cross road
1900^{ft}

28) Thence South 715^{ft} to the North
Bank of Del Creek at 740^{ft} cross
creek.

error

Continued October 8.

NW 3-61^{ft} at 890^{ft} pass a little round top
at 1200^{ft} ston in prairie mid T.P.

29) Thence South 1900^{ft} stake fr w. a
ceder 6 brs S. 65 W. 80^{ft} a ceder
6. brs S 10 1/2 E. 98^{ft} round top
north of creek N 21 E. - Little
Ball head S 86 W. NW 10

30) Thence South 1900^{ft} to mound
of gypsum of North Side of round
hill fr w. a ceder x 6 N. 69 E 35^{ft}
a ceder x S. 21 E. 75^{ft} NW 15

31) Thence West at 1400^{ft} found a
large deposit of gypsum 1900^{ft} stake
fr w. ceder x 8 S 53 E 31^{ft} NW 16
ceder 8 N 62 1/2 W. 59^{ft}

32) Thence West at 1500^{ft} pass North
side of a round hill 1900^{ft} mound
of gypsum fr w. a ceder 12. S 21 1/2 W.
275^{ft} Posts on top of md. S 10 W. NW 17

G. P. N 83 1/2 W. Needle near S. Creek
N 35 4 W.

33) Thru West 1900 ^W state of cedar
frw. a 5 cedar brs S 63 W. 130 ^W
5 v " N 79 W. 220 ^W
Needle mt N 28 E. NW 18-

34) Thru West at 1430 ^W cross
large creek (no water) 1900 ^W
stone mt mtd T.P. frw. G.P.
N 83 1/4 W. NW 12-62-2

October 9th

Continuing West

35) Thru West at 1330 a divide
NW 13 1900 ^W a stone mt frw. a large
rocks mtd T.P. brs N 67 1/2 E. 490 ^W
another on southern end of top
of hill mtd T.P. brs N 73 1/2 E
475 ^W round hill S 73 1/2 W
Little House mountain

36) Thru West at 120 ^W two small
sulphur springs on south bank
of a large creek
Gray sand stone bank of creek
course of creek about S 20 W.

NW 14 1900 ^W a stone mtd T.P. at a large prairie

37) Thence West at 121st Little House mountain S 65 1/2 E at 298th cross NW 15 road 1900th stone mt mtd T.P. fr w. Little House Mt S 47 1/2 W.

1. round top S 8 W. (32)
little S 10 W.

38) Thence West Passing a high mtn, 1900th to stone mt T.P. fr w. Little house Mt S. 1 E. NW 16

39) Thence West at 1570th north side of a hill 1900th stone mt T.P. fr w. large rock mtd X N 39 E 35th
" " " " N 24 E 40th

40) Thence North 1900th stone mt in a large prairie fr w. (East crossing creek about 1 mile

Round top N 75 E } north side of
2nd vr top N 76 1/2 E }

Little House Mt # S 28 E.

Thence North 2. Corcets ^{middle fork of} about 1000th

October 10.

Commencing in camp at a stake

Thence South 1344 1/2th

Thence East 400th to corner N 27 a stone mtd T.P. for corner. (36)

NW 21 - 62 - 2

- 41) Thence South 1900^{ft} Stone mt mtd TP
C..... about 350^{ft}
- 42) Thence South at 400^{ft} cross South
NW 21
forts 1900^{ft} stone mt f.w. Little Rock
brs N 60 W. dtd Little Rock brs N 41 W.
- 43) Thence South 1900^{ft} state of cedar f.w
beds 6. S. 75 1/2 E 215^{ft} NW 33
G.P. brs N 75 W
(Thence S 45 W. 2688^{ft}) (?)
- 44) Thence South 1900^{ft} state and
..... sand NW 44
- 45) Thence West 1900^{ft} to a rock mtd
TP (brs West 120^{ft}) NW 43
- 46) Thence South at 300^{ft} cross creek
SW 43 1300^{ft} 1900^{ft} stone mt
in bed of creek f.w. a round top
hill S 15 1/2 E. G.P. N 69 1/2 W. a rock
in the ground mtd X brs N 7 1/2 W.
3^{ft} an other mtd X N 18 E 6^{ft}
genl course of creek South
mouth of creek Little Rock N 59 W
October 11th
Commencing state in Camp
Thence East 400^{ft}
- 47) Thence North at 350^{ft} cross creek
480^{ft} cross road 556^{ft} stone mt

fw arm fw old mant station brs
S. 82. E. NW 9-62-2

48) Thence North at 1100^{ft}
NW 2 of a round hill 1900^{ft} stone mt
mkd T.P. fr w. a rock mkd X on
a little round hill S. 32 W. 70^{ft}
Round hill brs S 11 E. west of (middle)

49) Thence North 1900^{ft} stone mt mkd
T.P. fr w. rocks in ground mkd
X brs S 73 1/2 E 18^{ft} NW 46-62-1

50) Thence West at 202^{ft} needle
S 29 1/2 E at 1680^{ft} needle hill
S 33 1/2 E - Goose round top West
of needle Hill brs S 15 E at 1700^{ft}

NW 45 On the men 1900^{ft} to a stone
mt on the foot of men mkd T.P.
fr w Little House Mt. brs S 14 1/2 W.
(passing E side of Hill)

51) Thence West 1900^{ft} stone mt mkd
NW 44 T.P. in large prairie fr w. sole hill
west of needle brs S 20 1/2 E round
hill in prairie S 45 E

52) Thence West 1900^{ft} to a stake
NW 43 set in a pile of little stone in a large
prairie

53) Thence South 45 W. at 660^{ft} cross
road at 980^{ft} crossroad hill at 1924^{ft}

top of mountain fr. Sica House Mt
west of Studee brs S 30 $\frac{1}{2}$ E. at
2270^m high bluff of middle fortz
NW 6-63⁷ crossing cretz 2688^m to a stone
mt mkt. T.P. on north side of hill
fr. a rock mkt. X brs S 38 W. 14^m
54) Thence North at 250^m middle
of cretz course of cretz down
S 66 $\frac{1}{2}$ E up West at 1310^m road
continued October 12

NW 48-63⁷ 1400^m at mt on the mesa

55) Thence West 1400^m to a stone mt
NW 47 made on the west side of mesa.
(South at 400^m road 590^m west side
of hill) fr. w. rock mkt X above
a cave S 60 E 35^m

56) Thence West 1900^m stont mt mkt
T.P. (Thence S. 45 W 900 The West
NW 46 at 1500^m cretz 1900^m The north 636^m)

57) Thence West with monk
1900^m stone mt near and north of
the road (South 250^m cretz)

58) Thence West at 590^m run
at 1400^m another road comes N W
1900^m stone mt mkt T.P. fr. two
round top run brs N 26 $\frac{1}{2}$ E
brs N 1 $\frac{1}{2}$ W

- 59) Thence West across a mountain 1900²⁴
to a stone mt. made on its
W side (Crest S 26 E about one mile
- 60) Thence West Mountains
at 1600²⁷ crest 1900²⁷ stone mt mtd
T.P. in C N 70 W
- 61) Thence West at 1580²⁷ a large crest
near its mouth cross North 1900²⁷
stone mt mtd T.P.
- 62) Thence West 1900²⁷ stone mt fr. round
Mt West of Mars brs S 54 E.
needle brs S 60 E

October 13th continued West
Sunday

- 63) 1900²⁷ stone mt mtd T.P.
- 64) Thence West at 9400²⁷ cross
crest 1900²⁷ stone mt
. thing and recross it at 1800²⁷
- 65) Thence West 1900²⁷ stone mt
fr w. a rock on bank of crest x
brs N 79 E 65²⁷ a Satz brs 50 W.
36²⁷
- 66) Thence West 1900²⁷ stone mt G.P.
brs S 88 1/2 W. NW 48-65-1

October 14
commencing 65 fr w. G.P. S 89 W.

- 67) Thence North at 120th break at
 1730th another creek 1900th a stone
 mt f.w. a bush of oaks brs North
 140th
- 68) Thence North, crossing a branch
 at 1690th cross road at 1850th cross
 creek across up west
 1900th stone mt f.w. thin oak
 10 brs S 12 E 162th
 ditto 10. brs S 14 W 175th
- 69) Thence North at 730th a road
 at 900th an other road
 1150th a running creek at 1550th
 Quad P. S 66³/₄ W. 1900th stone mt
 f.w. s thin oak 7 brs N 18¹/₂ W 56th
 " " brs N 61 E 74¹/₂th
- 70) Thence North a 450th
 spring branch at 870th
 G.P. S 62¹/₄ W. Two P on the Mts
 1. brs N 55 W.
 2 brs N 43 W.
 at 1090th a b.....
 1900th stone mt f.w. a fort
 cedar 16 brs N 81 W. 81th
 " 20. brs N 72 W 118th
 two P. 1 brs N 60 W
 2 brs N 57 W.

71) Thence West crossing branch at
 1490th with branch 1900th stone mt
 near its S bank fr. Shin oak 7
 brs Shin oak br S 3 1/2 E 9 1/2th
 fortz Shin oak 8 brs S 80 W 12 7/8th
 Two P. 1 brs N 41 W. 2. brs N 24 W.

72) Thence West at 1500th deep ravine
 at 1630th foot of high mountain
 1900th stake mkd on a bluff
October 15th

commencing at cor N 65.

73) Thence South at 1260th cross road
 above Independence Spring about
 500th 1900th stone mt made
 near and north of a deep ravine

④ continuing on cor. 66 fr w a cedar
 14 S 81 1/2 W 158th Shin oak 10
 S 86 1/2 W 160th

74) Thence West 1900th stone mt fr
 Shin oak 7 brs S 83 E 758th
 do. 4. brs S 40 E 119th

75) Thence West at 1140th a S brush
 1900th the msk. on West Side
 of br fr w. a Shin oak 7 brs S 27 E
 34th a Shin oak 10 br N 72 W
 115th

NW 45

- 76) Thence West 1900th stone mt fr
a cedar 20 brs S' 67th W 56th
Shin Oaks 8 brs S' 2th W 110th

October 16

- 77) Thence West at 172th road to
Jim Spring at 530th old mail
shak at 535th road at 1305th
an other road—1900th Stone mt
large stone in the ground brs S' 73th 7th
thence to a boat 1900th brs S' 66th 2th E.
By at cor of 76.

- 78) Thence South at 180th road
650 boats at 1580th G.P. brs
N. 77. 7. 1900th to a stone mt fr
G.P. N. 74. 7. be on mt S' 77th 2th W
stone large roots mt'd X
brs N 2 E 90th
N 44 4 W 81th

- 79) Thence South at 770th cross brs
course east 1900th a stone mt fr
Lead P. N 57th 2th W
be on Hill brs N 58th W.
Thence South at 270th road 80th
stone mt.

October 17

- 80) Commencing at N. 71 stone mt
fr. a Sh Oak 7 brs S' 3th 2th E 9th 2th

d fortz 8 S 80 W 12th
 course of creek about S 65 E about
 3/4 mile below a good spring at the
 junction of an other branch

#80 Thence North at 1080th deep rav.
 at 1220th another at 1400th do. at
 1400th at 1100th south end of an
 oblongical hill 1900th stone mt
 made on the South bank of a deep
 ravine fw. a cedar 20 S 4 1/2 E 123th
 Oatz 8 brs S 11 E 23th needle mt
 brs S 55 E Mt west of needle brs
 S 50 E. Thence North 1500th

October 18th

Thence East 422 1/2th to a mt
 on S. Bank of Black River

October 19th in camp

October 21th

Beginning at Cor N 70 near
 India town

- 81) Thence North 1900th to an oatz
 5 in dia mt 17 fw. an Oatz 5
 brs S 48 E 19th do 7 S 28 E 39th
 (East crossing Blue River)
- 82) Thence North at 350th Blue River
 1900th stone mt made of a lava Stone
 fw. high point west of corner

on the bluff or foot of mountain
brs S¹ 57^W.

- 83) Thence North at 290^W a bush
1900^W stone mt made on foot of
mountain
- 84) Thence East 1900^W stone mt fr.
a Oatz 5 brs S¹ 85^E 90^W
Lynn Sawitts 10. N 76¹/₂ E 215^W
October 22 continuing
- 85) Thence East 1900^W stone mt
- 86) Thence East at 620 West left
of creek at 690^W E bank
of creek (Middle fork)
1900^W stone mt (S¹ West about)
300^W a spring
- 87) Thence East 1900^W stone mt
fr. a rock near an Indian trail
brs N 38¹/₂ E 318^W
- 88) Thence East 1900^W a stone mt
fr. w. a rock brs S¹ 45¹/₂ E.
- 89) Thence East ~~1900~~^W crossing
a branch 1900^W to a stone mt.
made on S. side of ridge
- 90) Thence East 1900^W to a stone
mt.
- 91) Thence East at 130^W a road
1900^W stone mt

92) Thence East 1400th stone mt

93) Thence East at 900th North
Banks of River
October 23rd

cor to east at 1900th stake mt
in the bed of the Blue river

94) Thence East at 1300th Banks
at 1400th stone mt f w. Needle
brs S 29¹/₄ E Mt West of needle
brs S 18³/₄ E

October 24th

October 25th

Beginning at cor at 76 S. E of
Pine Spring f w. round mt
north of Pine Spring brs S 42¹/₂ W

95) Thence South 45 E. at 1300th
Crest from Cam and will
brs 26 88th stone mt made
near South bank of creek
f w. a oak & brs N 45 W 35¹/₂th
do brs N 26¹/₂ E 24th

96) Thence S 45 E, 26 88th a stone mt
made on the south bank of a
deep ravine f w. Inquirer 20
brs N 45 W 10⁴/₂th Oak 10 brs
S. S. E. 35th do 8 brs S 31 E 46th

- 97) Thru S 45 E rough rapin
at 775th cross. Capt Creek above
pouch with same cretz at 1990th
an other branch runs east
2688th stone mt
- 98) Thru S 45 E at 1400th cross +
Capt cretz at a junction of a
branch from West at 2660th
cross a cretz above its junction
with Capt cretz course S 56 W.
2688th stone mt made near J. Bantz
of cretz fw. 08 1/2 hrs N 67 1/2 W
27 1/2th do 10 hrs N 31 E. 15th
- 99) Thru S 45 E at 2400th cross
cretz 2688th stone mt
- October 26 continuing
- 100) Thru S 45 E at 1710th
Round mountain north of Pine Spring
hrs N 31 1/4 W at 1400th a dividing
ridge 2688th stone mt vally
fw. Oatz 7 hrs S 78 1/2 E 219th
do 10 hrs S 81 E 214th
- 101) Thru S. 45 E 2688th to a
stone mt
- 102) Thru S 45 E at 1575th cross
Spring cretz 2688th stone mt

- 103) Thru S 45 E at 225th a large creek
was east at 1770th another at 2100th
another creek, about 700th from junction
brs N E 2688th stone mt

October 27 Sunday

Weather unfavorable for work

October 28th continued

- 104) Thru S 45 E at 2615th a bench
2688th a stone mt for a beder 3
brs South 8th

- 105) Thru S 45 E at 1320th
2688th stone mt on a ridge

- 106) Thru S 45 E at 1805th a round
mountain brs N 80 1/2 E.
(Course of creek down the same)
2688th stone mt on North
bank of creek.

October 29th continued

- 107) Thru S 45 E at 24th cross
creek (i.e. N 80 W) at 2688th
stone mt for a beder 3 brs S 72 E
118th

- 108) Thru South at 45th cross bench
1900th stone mt in prairie

- 109) Thru South 1900th stone mt
in the prairie

- 110) Thence South 1900^{ft} stone mt in prairie near the new road.
- 111) Thence South at 1200^{ft} cross a large creek runs N & E 1900^{ft} stone mt mt'd T.P. in large prairie fr w a rock mt'd x brs N 66 W 15^{ft}
- 112) Thence South 1900^{ft} stone mt west side of a hill
- 113) Thence South at 250^{ft} a divide at 426^{ft} a branch 1900^{ft} stone mt on top of a hill
- 114) Thence S 45 E at 1000^{ft} large creek (course E & E) 2688^{ft} stone mt made on the mesa

October 30th continued

- 115) Thence S 45 E at 2150^{ft} cross a creek branch course East 2688^{ft} stone mt fr an Sats 12 brs S 74 W 213^{ft}
- 116) Thence South crossing two small branches 1900^{ft} stone mt on south side of mesa
- 117) Thence S 45 E a 200^{ft} enters valley at which, 1300^{ft} (course of) 2680^{ft} stone mt in valley

- 118) Thence S 45 E 2688^m stone mt
- 119) Thence S 45 E 2688^m stone mt
- 120) Thence S 45 E 2688^m stone mt
- 121) Thence S 45 E 2688^m stone mt
- 122) Thence S 45 E 2688^m Stone mt
in a large plain fw. a bed
3 brs S 3 1/2 W 59^m
- 123) Thence S 45 E 1700^m stone mt
fw. dome con Hill 1. brs S 61 1/4 E
2. brs S 61 1/2 E a fat Hill S 45 E
October 31 Fine Davis road camp
November 1st
Camp on road Quad P N 54 1/4 W
Gorney P on Davis Mt S 22 1/2 E
November 2nd cont. S 45 E.
Peats north end of a Mountain
range brs S 16 E. Corned Hill
East of double Hill brs S 76 E.
- ~~124~~ Thence S 45 E at 880^m cross a
branch 988^m (wall 2688^m) Stone
T.P. fw. bed 12 brs S 63 1/2 E 81^m
bed 14 brs S 47 1/2 E 115^m bed 24
brs S 6 1/2 E 106^m

124) Thence East at 665⁰⁰ Peak
north of Pass S 85 1/2 W - South of
pass S 83 W low Peak brs S. 80. W.
1900⁰⁰ stazs fw. leader 10 brs S 29 W
70⁰⁰ leader 14 brs N 87 E 1310⁰⁰

125) Thence East 1900⁰⁰ stazs fw
leader 16 brs S 59 1/2 E 10⁰⁰ leader
20 brs N 72 W 910⁰⁰

126) Thence East 1900⁰⁰ slope mt of
gypsiferous fw.

2 on hill brs S 57 W 195⁰⁰

leader 16 " S 13 W 370⁰⁰

" 8 " S 4 1/2 E 41⁰⁰

Peak north of pass S 86 1/2 W

" in south of pass S 85 W

low Peak S 82 3/4 W

Quad P N 43 3/4 W

127) Thence East 1900⁰⁰ stazs
w leader 14 brs S 68 1/2 E 54 1/2⁰⁰
leader 12 brs N 62 E 25 1/4⁰⁰

128) Thence East 1900⁰⁰ stazs S W
leader 10 brs S 41 E 60 1/2

first^d leader 20 brs S 52 E 60⁰⁰

Double Hill 1. brs S. 8 W.

2. " S 6 1/2 W

low Hill East " S 48 E

- 129) Thence N 45 E 2688^{ft} stake fw
beds 10 hrs S 41½ E 9^{ft}
beds 10 hrs at 15½ E 27^{ft}
- 130) Thence N 45 E 2688^{ft} st fw
beds 16 hrs S 58½ N. 24^{ft} beds
10 hrs North 29^{ft}
November 8th Sunday
- 131) Thence N 45 E 1960^{ft} to a bed
near creek 2110^{ft} cross a large
creek above a spring 2688^{ft}
stake in a mt of gypsum fw
ford. beds 8 hrs S 44½ E 15^{ft}
beds 6 hrs N 76½ E 23^{ft}
- 132) Thence S 45 E at 1275^{ft} cross
creek - 2688^{ft} stake fw. beds
10 hrs S 1½ E 28½^{ft} do. 10 hrs East 27^{ft}
creek North 475^{ft}
- 133) Thence East at 570^{ft} cross road
to Davis at 1280^{ft} top of a hill
1900^{ft} 4 in² fw in bed of creek a
cottonwood 8 hrs N 64 E 205^{ft}
- 134) Thence East at 300^{ft} beds 1560^{ft}
St. Bantz 1900^{ft} stout mt fw a
round hill hrs S 9 E 95^{ft}
- 135) Thence East at 1780^{ft} top of ridge
1900^{ft} stone mt made on E side
of ridge - beds with about 650^{ft}

East about 1 mile thence turn at 45 E

Nov 4th

Beginning at cor at 132 state fw. Cedar
10 brs S 1 1/2 E 28th do 10 brs East 27th

136) Thence S 45 E 2688th state fw.
Cedar 10 brs S 3/4 W 185th

Nov 5th

137) Coming on Saladito Creek

Quad P brs at S 1 1/2 W (640th from ...)

Containing S 45 E from cor No. 136

Gomez Peats Dicks ditto brs S 17 1/4 E

Quad P brs N 50 3/4 W at 1210th a branch
runs East 2688th rocks mt f w. P North
of Pass brs S 88 1/4 W - South of it S 87 1/4 W
on hill South of it S 86 1/4 W. -

138) Thence S 45 E at 2175th cross hill
2688th stone mt near road fw. a Cedar
8. brs S 22 E 259th

139) Thence S 45 E at 170th cross road
at 570th cross m. ridge at 1045th
road on at 1415th 2688th stone
mt f w. Gomez P. brs S 13 E.

140) Thence South 45 E. 2688th rocks mt f w. rocks
brs S 79 W 9th do brs S 48 W 8 1/2th
Gomez Peats brs S 11 E. -

- 1441) Thurc South at 1850th cross road
1900th stone mt frw. Gomez Plat
brs S 12 E. Plat N E of Abs S 12 1/2 E
- 1442) Thurc South 1900th stone mt
in a large prairie
- 1443) Thurc South 1900th stone mt in
a prairie frw. P. Gomez brs S 13 E
P. north of it S 13 1/2 E
- 1444) Thurc S 45 E 2688th stone mt frw
Plat Gomez brs S 11 E.
Plat north of it brs S 11 1/2 E
November 6.
- 1445) Thurc South 1900th stone mt in prairie
- 1446) Thurc South 1900th stone mt
in prairie
- 1447) Thurc South 1900th stone mt
in prairie
- 1448) Thurc South 1900th stone mt
in prairie
- 1449) Thurc South at 670th cross a large
creek above a spring 1900th
stone mt in prairie
- 150) Thurc South 1900th stone mt
frw. Gomez Plat brs S 15 1/4 E
North of it brs S 16 1/4 E.

- 151) Thence S 45 E. 2688th stone mt in prairie
- 152) Thence S 45 E 2688th stone mt in prairie
- 153) Thence S 45 E. 2688th stone fr. a mesquit 4 hrs S 86 W. 35th
- 154) Thence S 45 E at 2345th cross road 2688th stone of mt. (North con hill S 45 E - S of another S 45 E)
- 155) Thence South 1900th stone fr. & top hrs S 20 E con hill hrs N 50 E a west south eye at 21 1/2

Nov. 7th continued

- 156) Thence South 1900th stone mt in prairie
- 157) Thence South at 700th foot of mountain on it 1900th stone mt fr. w. route x hrs S 62 E 4th. do hrs S 89 W 3 1/2th
- 158) Thence South at 1000th dividing ridge 1900th stone mt
- 159) Thence South (with hills) 1900th stone mt fr. fork of hill Long Plats hrs S 1/2 E
- 160) Thence West at 1200th foot of a red mountain and with its north top 1900th stone mt.
- 161) Thence West at 1100th camp.

November 8th San Martin Spring

- 161) 1900^{ft} Stone on E bank of creek
- 162) Thence South 1900^{ft} Stone mt in prairie
- 163) Thence South at 120^{ft} foot of hill paving hill at 1400^{ft} valley at 1600^{ft} another hill 1900^{ft} Stone mt on top of a ridge few rocks x brs N. 77 E. 20^{ft} rocks x brs N 59 1/2 E 17 1/2^{ft}
- 164) Thence South at 1140^{ft} cross creek a gl at 1630^{ft} 1900^{ft} Stone mt on E side of mountain few rocks mt x brs N. 16 1/2 W. 4^{ft} rocks do. brs S 45 E 1 1/2^{ft}
- 165) Thence South 1900^{ft} Stone mt made on west top of ridge
- 166) Thence South 1900^{ft} Stone mt made in the bed of a large creek few course of creek N.W. fortz Wild Cherry 10 brs S 58 E 41^{ft} do 8 brs S 64 E 8^{ft}
Gonyz Peats brs S 71 E
Quad P brs N. 36 W

167) Thence East with the west slope of Davis Mountain. 1900^{ft} stone mt. fr. Gomez P. brs S' 54 $\frac{1}{2}$ E. (2178^{ft})

168) Thence East at 300^{ft} pass spring branch (course west) 1900^{ft} Gunipa 20 brs at 83 $\frac{1}{2}$ W 111^{ft} Oats 8 brs at 35 $\frac{1}{2}$ W 41^{ft} Cave in Mountain S' 35 $\frac{1}{2}$ E.

November 9th continuing

169) Thence East at 700^{ft} ravine at 1300^{ft} branch below a Gomez Spring at 1780^{ft} ravine at 1900^{ft} large stone mtd. T.P. in a deep ravine fr.

Oats 20 brs at 228 37^{ft}

White oats 7 brs West 4^{ft}

170) Thence East at 2444^{ft} near Davis Mountain brs S' 86 $\frac{3}{4}$ W. 1882^{ft} - November 10th

at 700^{ft} a branch 1900^{ft} stone mt

171) Thence East at 650^{ft} cross bridge crossing at 950^{ft} at 1100^{ft} at 1750^{ft} cross a large terrace above the junction (course north) 1900^{ft} route mt fr. N. end of Davis mountain brs S' 82 $\frac{1}{2}$ W.

- 172) Thence East crossing ... cretz
 1900th stone mt on S bank of it fr.
 a black Walnut 10 brs N $3\frac{1}{2}$ E 3rd
- 173) Thence East November 11th
 passing a hill at 1500th p. m.
 1900th stone mt in prairie near
 S bank of cretz fr. Peatz north
 of Pass brs S $20\frac{1}{2}$ W
 Peatz south of P. brs S $16\frac{1}{2}$ W
 Lion Hill brs S $23\frac{1}{2}$ E A high
 table hill brs S $33\frac{1}{2}$ E
 2 " " S $46\frac{1}{2}$ E
 3 " " S 48 E
- 174) Thence S 45 E. 2688th ... mt made
 in prairie
- 175) Thence S 45 E at 950th cross a
 cretz course East at 1200th top
 of hill at 1500th enters valley 2500th
 cross a large cretz course N 27 E
 2688th roots mt near a high bluff
- 176) Thence S 45 E 2688th stone mt fr.
 Peatz north of Pass brs S 22 W.
 " south of " brs S 12 W.
 Lion Hill brs S $17\frac{3}{4}$ E
 High table Hill brs S 31 E
 brs S $49\frac{1}{2}$ E

182) Thence S 45 E. at 590th enters valley
 at 795th cross road 1200th middle of
 a large creek runs up to canyon
 brs S 59 $\frac{1}{2}$ W. 2688th rocks mt in
 prairie f.w. sw. round hill
 brs resp. S 37 W other S 36 W
 saddle brs S 52 W 14 835th
 con hill brs S 5 W (16510th)

183) Thence S 45 E at 800th crossing large
 creek at 1300th foot of hill crossing
 at 2688th rocks mt in a large
 prairie.

184) Thence S 45 E at 1200th cross a large
 creek 2688th Stone mt f.w. 13950th
 1 high table mountains brs S 8 $\frac{1}{2}$ E
 2 ————— brs S 56 E
 Cottonwood in creek brs S W 98 00th
Thence East at 130th road

November 15th
 continuing line - Beginning
 at 20th Victoria thence S. 6 W 75 80th
 thence S 82 $\frac{1}{2}$ W. 1497th

185) Thence South at 1600th cross Davis
 road recrossing the same at 1880th
 - 1900th Stone mt.
November 16th B

- 186 Thence South at 1040th cross a large
creek at 1520th stone mt on Indian
trail runs East to spring 1900th
stone mt in a large prairie
- 187 Thence South at 1270th cross a branch
1900th stone mt made in a moun-
tain pass fr. a large rock mtd
x brs S 50 E 3rd do brs S 13 1/2 W 5th
- 188 Thence S 45th W at 1900th cross a
branch 2688th stone mt in a
bed of a large creek (course S 13 W)
fr w. a black Walnut 7 brs N 8 E 21st
do brs S 66 W 3 1/2th
Oats 12 brs N 6 1/2 W. about 500th
- 189 Thence South 1900th stone mt
creek west about 300th
- 190 Thence South 1900th to a rock mtd
x fr. Oats 8 brs S 76 W 68th
a rock mtd x brs N 75 1/2 W 80th
creek west over a mile
- November 19
- 191 Beginning at corner β near Indian
trail opp. side sol. camp Thence East
at 800th a branch at 900th cross a
large creek at 1040th cross road
at 1900th Stone mt (.....)

192) Thence South at 460th runs a branch
at 1040th cross road at 1250th
at 6... above its junction with
main crest at 1400th cross a
large running crest 1900th stone
mt

193) Thence East at 600th cross junction
of two forks (course of main
forks brs S 15 E.) crossing road
1900th stone mt

November 18th to Fort Davis

November 14th to 21st at Fort Davis

November 22nd at San Springs

on line from Tom Murphy Stone
mt near road S E about 500th

from edge camp brs N 13 1/2 E
11260th fr S corner of tax No 256
on Toyah Spring

fr sand stone mt brs 1st high....

S 7 E - 2nd S 78 E Gomez P brs

N 53 1/4 W Thence S 83 E 1000th
to corner S.

November 24th Beginning at
corner near San Martin Spring

194) Thence West 1900th v. mt frw.
Gomez P brs S 27 3/4 E

- 195) Thence West 1900^{ft} v mt.
- 196) Thence West 1900^{ft} v mt f w
Gomez P brs S 41 E.
- 197) Thence West 1900^{ft} v mt f w.
a rock mtd x brs S 2 1/2 E 13^{ft}
do brs S 61 W 6^{ft}
- 198) Thence West 1900^{ft} Stone mt in valley
- 199) Thence West 1900^{ft} stone mt in bed
of creek runs North f w. a rock
on... side of a hill brs at 78 1/2 W
77^{ft} another brs S 77 W 54^{ft}
November 25th Snow storm in Camp
Nov 27th Beginning at stone
mt 1 3/4 miles East of San Martin
Spring cor at 159
- 200) Thence East crossing gavin 800^{ft}
to top of hill and with hills 1900^{ft}
stone mt made in bed of a large creek
branch
- 201) Thence East at 1800^{ft} cross a large creek
Course at 35 E 1900^{ft} stone mt f w.
a rock mtd x brs S 6 W 10^{ft} Northern
Davis mountain 65 S 18 1/2 W
other high point brs S. g. W.
- 202) Thence East at 970^{ft} pass ridge
north and near a round top hill
1900^{ft} stone mt on South side of a

mountain fw. a large rock mtnd
x brs S 8. W

do brs S 41 W 9th

203 Thence East at 280th crossing
branch crossing round top hill
1900th Stone mt in valley

204 Thence East 1900th rock mt in
valley fw. high point S E of
Gomez Peak brs S 31 W
November 28th in camp
November 29th

205 Thence East at 65th cross branch
at 1100th top of hill 1900th Stone
mt in valley fw. high pt
brs S 37 W.

206 Thence East at 240th cross Davis
road 1900th Stone mt on south side
of hill

207 Thence East crossing Amphip Hill
1900th slate in a large prairie

208 Thence East 1900th Stone mt...
of a ^{small} rock in prairie fw.
Cataw 4 brs S 7 W 14th
do 3 brs S 3 1/2 W 14 1/2th

209 Thence East 1900th slate, & mt in
a large prairie

215. Thence N 45 W 2300^{ft} stone mt in
 a large prairie for a branch
 runs WNW 2688^{ft} stone mt
 for 1 West end little P brs S 46 W
 1 pass brs S 36 W 2nd brs South
 1 Peats brs S 11 1/2 E.
- 216 Thence N 45 W 2688^{ft} stone mt
 in a large prairie.
- 217 Thence N 45 W 2688^{ft} stone mt for
 con hill brs at 82 1/2 E West end little
 P brs S 34 W
- 218 Thence N 45 W 2688^{ft} stone mt
 on W. side of mountain
- 219 Thence N 45 W 1400^{ft} rocks mt
 near cross at 2688^{ft} stone mt in
 a large prairie
- 220 Thence West 1900^{ft} stone mt in fore
 of w. mes con hill brs S 67 1/2 E
- 221 Thence West 1900^{ft} stone mt on the
 east side of Mountain
- 222 Thence West 1900^{ft} stone mt on
 the north side of mountain
- 223 Thence West 1900^{ft} stone mt
 for Peats N 45 W brs at 29 1/2 W
Thence West 1000^{ft}
December 4th

223) Thence N 45 W at 700^{ft} cross branch
5200^{ft} top 5378^{ft}

224) Thence West 900^{ft} roots in large
prairie for

225) Thence N 45 W 2688^{ft} mt. fr.
granite 3 brs S 5 W 10 1/2^{ft}
at 700^{ft} cross crests

226) Thence N 45 W 2688^{ft} stone mt
in Valley

227) Thence N 45 W at 900^{ft} foot of Mountain
- - - course West East 1590^{ft}
to the round top West about 600^{ft}
White round top brs at 20 W
2688^{ft} stone mt -

228) Thence N 45 W 2688^{ft} slate fr.
a Cedar 8 brs at 37 1/2 W 63 1/2^{ft}
forts Cedar 12 brs N 59 W 167 3/4^{ft}
White round top brs at 70 1/2 E

229) Thence West crossing ridge 1900^{ft}
stone mt in bed of branch runs
SE. frw. Cedar 8 brs at 62 1/2 E 127^{ft}
forts Cedar 12 brs at 88 E 97^{ft}

230) Thence West stone mt on N side
of a hill frw. a forts Cedar 14
S 31 W 25^{ft}

231) Thence West at 400^{ft} pass betw. two round
hills 1900^{ft} stone mt in a large prairie -

232. Thence West 1900^{ft} stone mt fr
a prairie Peats brs at $2\frac{3}{4}E$
- 233 Thence at 45 W 2688^{ft} stone mt
prairie Plate brs at $7\frac{1}{4}N$ at $17\frac{1}{4}E$.
- 234 Thence West 1900^{ft} stone mt in
prairie
- 235 Thence at 45 W 2000^{ft} stone mt
Decr 4th 2688^{ft} stone mt in
a valley fr. fort'd Cedar 16 br
 $S 56 E 71\frac{1}{2}$ ^{ft} Cedar 3 brs $S 8 W$
2855. East top of a high hill about
400^{ft} Thence at 45 W 340^{ft}
Thence West 1660^{ft}
- 236 Thence South 2400^{ft} stone mt
on E side of hill fr. stone mt
on a little round top brs at $35\frac{1}{2}E$
 78 ^{ft}
- 237 Thence West at 80^{ft} top of hill
fr Peats north end of l. - - -
mountain brs at $61\frac{1}{2}W$ - 1900^{ft}
- - - on W side of mountain salt
bricks valley fr. Peats (Star end
Del.) brs at $60\frac{1}{4}W$. 39500^{ft}
December 5th continued
- 238 Thence West 1900^{ft} Stone mt
mt'd T.P.

- 239) Thence West 1900^{ft} stone mt in p
f.w. Peats brs at 57 1/2 W
- 240) Thence West 1900^{ft} stone mt
f.w. Peats brs at 55 1/2 W at
300^{ft} h old.
- 241) Thence at 45 W. 2688^{ft} stone mt
f.w. Peats brs at 57 W
Peats East of S brs S 41 1/2 W.
- 242) Thence at 45 W 2688^{ft} stone mt
f.w. Obv. Wilson S m brs S 82 W.
br Peats (N end) at 57 3/4 W.
- 243) Thence at 45 W 2688^{ft} stone mt
f.w. Peats bears of S m S 28 W
Southern S m brs S 46 W
- 244) Thence at 45 W at 800^{ft} cross
ridges South end mar rounded top
hills at 1900^{ft} very old road 2688^{ft}
stone mt f.w. S. end brs S 41 1/2 W
- 245) Thence at 45 W 2688^{ft} stone mt
f.w. Peats m br at 62 W.
- 246) Thence at 45 W 300^{ft} camp brs
N 43 E. 1. Peats East mt S 60 E
2, S 87 E - 3 N 39 1/2 E - 4th N. end high
table brs at 28 3/4 E - S. end S m
brs S 36 3/4 W Peats East range. See 6
continuing 2688^{ft} stone mt in prairie
f.w. Magnets 3 brs S 72 E 14 1/2^{ft}

Mesquite 3 brs S 35 E 21^v

Peats in cañon brs S 65½ W 17^v

247) Thence at 45 W 2688^v south mt
 fr. 1. Peats brs S 58 E

2 brs S 70 E

3 " at 69½ E

4 " at 50 E

round high mt brs at 48½ E

Peats in cañon brs S 58¾ W

Quad P. brs at 11¼ W

248) Thence at 45 W 2688^v static
 earth mt.

249) Thence at 45 W 2688^v to a
 mesquite static - (Gypsum)

250) Thence at 45 W 2688^v mt
 of gypsum fr.

1. Peats brs S 53 E

3' " brs at 84½ E

3.00 brs at 75 E

Peats M. J. M. brs at 8 W

min round top on D. W. brs at 28 E

over round top brs at 6½ E

Quad P. brs at 8¼ W

251) Thence at 45 W at 2640^v cross
Indian trail course S. W. 2688^v
 earth mt. - brs S 27 W

840 + 1075 contour.

252. Thence at 45 W 2688¹⁷

Earth mt

253. Thence at 45 W 2688² slate

fw. along 5 brs at 52 1/2 W 29 1/2²

do brs at 47 W 71⁰²

as Peats brs at 34 E

Peats north end D.M. brs S 57 W

December 7th continued

254. Thence at 45 W 2688¹⁷ slate

fw. a Mesquite 2 brs at 26 E

17¹⁷

255. Thence at 45 W 2688¹⁷ earth

mt

256. Thence at 45 W. 2688¹⁷ Earth

mt in salt lake valley fw. round
top on table mountain N. end of D.M.

brs at 87 1/2 W 2 marion hill brs

at 64 1/2 W - Quad P. at 9 E #

258. Thence at 45 W 2688⁸ mound of

Gypsum

259. Thence at 45 W 2688¹⁷ earth mt fw

uncon little brs at 75 1/2 W other on

table in writing a long table in brs

S 84 W Kullern brs S 89 W

260. Thence at 45 W 2688¹⁷ earth mt fw

round top on high table in brs S 76 W

medle S 84 1/2 W. Quad P. at $\frac{20}{18 3/4}$ E

261. Thence at 45^W at 600^{ft} in by lagon
1000^{ft} W base of it Quad Peate
br at 21^E

December 8th continuing

~~261~~ 2688^{ft} m² of gypsum fr round
top br S 62^W at 1240^{ft} another
Salt lake

262 Thence at 45^W at 1240^{ft} another
salt lake 2688^{ft} m² of l fr hills
br at 52^{1/2} W another br at 32^{3/4} W
round top on W line) Quad P br at 26² E

263 Thence at 45^W 2688^{ft} to it i.e. ^(28^{3/4} W)
fr. Peate br at 37^E, at 48^W

~~262~~ Thence at 45^W at 324^{ft} old round
at 990^{ft} cross trail 1000^{ft}

264 Thence north 946^{ft} + 247
Thence east 707^{ft} slats & mt fr
a mesquit 2 br at 73^{1/2} E 31^{ft}

265 Thence north 1900^{ft} earth mt (35²⁵ /
N 35^E)
a table mountain br at 40^{1/2} W.

266 Thence West 1900^{ft} to a stone mt
on W end of hill fr. round top
br at 54^{1/8} W Quad P at 40^E

(2) Round top at 20^{3/4} W -
December 11th

267) Thence north 1900th stake of mine for
 a forte^d mesquit 4 brs S' 86 $\frac{1}{2}$ E 21th
 mesquit 5 brs S' 60 E 63th
 Peats β on E range brs S' 85 $\frac{1}{4}$ E.
 Peats 5 brs N 60 E
 Peats brs S' 71 E

268) Thence north at 330th cross salt
 road 1900th stake fw. a mesquit
 5 brs S' 73 W 208th forte^d Mesq 7 brs
 S' 43 $\frac{1}{2}$ W 211th
 roots mound on round top brs
 N 88 W little round top in high table
 mt brs S' 32 $\frac{1}{2}$ W crude brs S' 43 $\frac{3}{4}$ W

269) Thence North 1900th stake fw.
 a forte^d mesq 6 brs N 14 W 144th
 range 5 brs N 15 W 143 $\frac{1}{2}$ th
 Roots into on top of round top brs
 S' 37 W Cred P. brs N 44 $\frac{3}{4}$ E
 South end of GM brs S' 47 $\frac{3}{4}$ E
 Peats brs N 66 $\frac{3}{4}$ E
 P. brs S' 65 E
 double P S' 78 $\frac{1}{2}$ E

270) Thence East Peats brs N 88 E
 1900th stake not in pl.

271) Thence East at 800th cross road

Second Book

Dec 12th

on west bank of salt lake

- Quad Peate brs at 27 1/2 E
- round top brs at 49 W
- run over hill brs S 39 W
- cor of lake down brs S 17 W

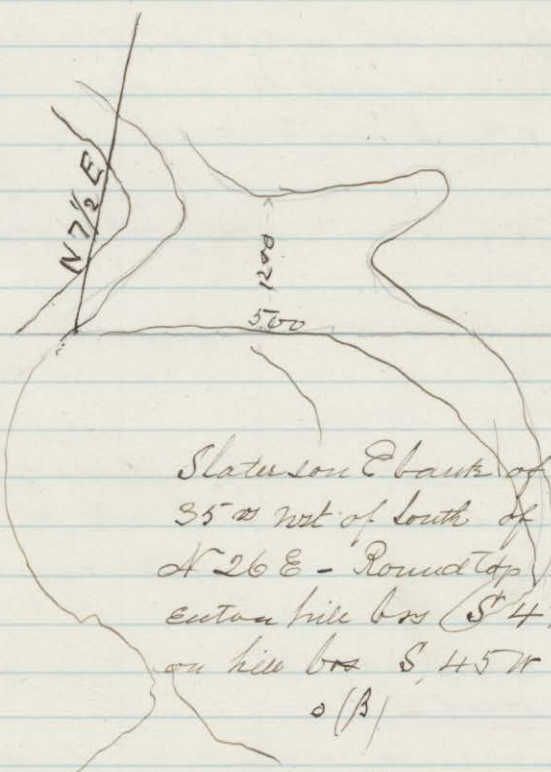

Station on E bank of lake and about
 350' west of south of slough S Peate
 at 26 E - Round top brs at 41 1/2 W
 onto a hill brs S 47 W - Lake round
 on hill brs S 45 W

o (B)

Run east across lake

46

Quad Plate is 232nd East and 317th South
from corner 2 miles West of cor No 77
or at 269 Quad Plate brs N 48 $\frac{1}{2}$ E

December 13th

in Camp

December 14th

Commencing at cor No 271

2⁵ Thence North with latre at 900th
..... slough at 966th all old..... earth
m $\frac{1}{2}$ brs West 8th at 1900th earth m $\frac{1}{2}$

276 Thence North 1900th earth m $\frac{1}{2}$ for 4 Peat

- 1) brs at 59th W
- 2) concut brs at 61th W
- 3) brs at 63 $\frac{1}{2}$ W
- 4) brs at 69 $\frac{1}{2}$ W

277 Thence N 45 E 2688th crossing
several lagoons earth m $\frac{1}{2}$

278 Thence 45 E at 400th enters lagoon
at 2200 earth bank
2688th earth m $\frac{1}{2}$

279 Thence at 45 E
2680th crossing right..... land
corner made earth North of Latre

December 15

North of a spring in can G. P brs
N 45 $\frac{1}{2}$ E m $\frac{1}{2}$ S. point of G. P brs

N 53 E

280) Thence N 45 E at 832^m west
 2655^m stone mt^d on N side (foot of ...)
 mount temporary gen^d wws S 10 E fr.
 4 Peats brs 1. at 68 1/2 W (2) brs at 71° W
 (3) brs at 73 W. (4) at 80 1/2 W.

281) Thence North with foot of mountain
 1900^m m^d

282) Thence North 1900^m rock m^d prairie
 about 500^m west of mountains fr
 G.P. brs at 9.1. brs at 65 1/4 E

St 2 " at 49 1/2 E

at 3 " at 40 1/4 E

at 4 " at 35 3/4 E

283) Thence north 1900^m rock in bed of large
 creek (brs SW)

284) Thence north 1900^m rock m^d on N
 end of hill fr. G.P. brs S 89 1/2 E

P at 1 at 74 E, at 2 at 62 E N. at 53 E

S Peats of Gm brs S 78 E

Thence North 200^m to line north of
 G.P. Thence last 200^m stone m^d in
 bed of creek G.P. brs S 87 1/2 E

December 16th

285) Thence N 45 W at 850^m a branch
 at 1640^m cross El Paso road at 2000^m a
 deep creek 2688^m rock m^d f. w. a high

Platz on G range brs at $56\frac{3}{4}E$

286 Trunce at 45 W 2688^m stak & m^d in
a large prairie

December 17

287 Trunce at 45 W 2688^m in m^d for
a high Platz on G range brs at $84\frac{1}{2}W$
round top on branch range in timber
South brs at $26\frac{1}{2}E$

288 Trunce at 45 W 2688^m m^d of water
for a high Platz brs $S 87\frac{1}{2}E$

289 Trunce at 45 W 2688^m m^d of Gypsum

290 Trunce at 45 W m^d of gypsum

291 Trunce at 45 W 2688^m earth

1140^m in trail at 300 Salt Lake 2500^m
m^d on S line of New Mexico from
Quad P brs $S 56E$

high Platz on G range brs $S 72E$

^(1.) Trunce West 820^m 1050^m across crests

1240^m

Trunce South $73\frac{1}{2}$ ^m to the monument

292 Trunce^(1.) West at 160^m cross crests &
El Paso road at 467^m another mt
at 660^m earth m^d for cor

293 Trunce^(2.) West 1900^m earth m^d

South line cross Salt Lake about $1\frac{1}{2}$ mile

394 Trunce^(3.) West 1900^m earth m^d from
Train Platz brs $S 38\frac{3}{4}W$, Medd P of a

3 hill hrs S 21 1/2 W

295) Thence ⁽⁴⁾ West 1900th earth m^d fr. Prairie
hrs S 17 W Middle P. hrs S 11 1/2 W

296) Thence ⁽⁵⁾ West at 1657th monument
1900th large r m^d m^d TP

297) Thence ⁽⁶⁾ West 1900th r m^d and a Prairie
Plate hrs S 13 E 2) Plate of 4 ... hrs S 8 1/2 E
Quad P. hrs S 67 1/2 E

Three Plates on mountain South of
1) hrs S 55 W - 2) hrs S 62 1/2 W 3) hrs S 73 W
North P runs N 72 W

December 19

298) Thence ⁽⁷⁾ West 1900th stake in m^d of
mad water

299) Thence West (at 1000th road 10 1/2)
1900th r m^d

300) Thence West 1900th r m^d

301) Thence West 1840 Thence South
40th to monument

Thence West 60th road m^d for
over on top of hill

302) Thence West 1900th earth m^d in
a large prairie

303) Thence West 1900th r m^d on the
side of a hill

304) Thence West 1900th earth m^d in
prairie (c)

- 305) Thence West 1900th rocks m^d fr
 Grad 9 brs S 74³/₄ E
December 20.
- 306) Thence West 1900th stone m^d
- 307) Thence West 1900th earth m^d in
 prairie
- 308) Thence West 1900th to stone & earth m^d
- 309) Thence West 1900th to earth m^d
 B with rocks on its top
- 310) Thence West 1900th earth do w
 S 5³/₄ W Needs S 50³/₄ W
- 311) Thence West 1900th stone m^d fr
 Peats brs S 2¹/₄ E
- 312) Thence West 1900th earth m^d
- 313) Thence West with hill 1900th
 stone m^d on W side of hill
 fr. Needle brs S 96¹/₂ W
 3 Peat brs S 8 E
Thence West 200th (60 ...)
December 21st
- 314) 1900th vs stone m^d on N rib of mountain
 range
- 315) Thence West 1900th stone m^d on
 W side of Phosphor hill Block
- 316) Thence West 300th (camp)
December 22
 corvantes brs N 16¹/₄ W

- 317 Thence N 45 W 1550 ²⁷ 5 miles
- 318 Thence West 2000 ²⁷ +
4620 ²⁷ + 600
- 319 Thence South 1096
- 320 Thence West 884 ²⁷ stone m^d in
a prairie
- 321 Thence West 1900 ²⁷ stone m^d in
purn blots
- 322 Thence West 1900 ²⁷ r m^d in prairie
fr Cottonwood spring about
1 mile N 45 W
- 323 Thence West 1900 ²⁷ r m^d
to camp on cottonwood spring
December 23^d
Continued west
- 324 Thence West with S line New
Mexico 1900 ²⁷ r m^d m^d T P
- 325 Thence West 1900 ²⁷ to a r m^d.
made on W side of hill
- 326 Thence West 1900 ²⁷ to a r m^d.
made on S W side of a hill
- 327 Thence West 1900 ²⁷ to a m^d of
(Blots) small rocks fr
A udle N^W brs S 67 E another Peats
brs S 56 ¹/₄ E
- 328 ⁵ Thence West 1900 ²⁷ to r m^d fr mud mt
brs S 68 ³/₄ E another P. brs S 69 ¹/₄ E.

- 329) 6. Thence West 1900 ^{ft} to a large stone
m^d m^d TP made in a valley
- 330) 7. Thence West 1900 ^{ft} a n m^d
8. Thence West at 1270 ^{ft} El Paso road
1560 ^{ft}
- 331) Thence South 102 ^{ft} to monument.
Thence West 340 (at 75 ^{ft} cross El P
road) r m^d fw at 28 ^{ft} monument
- 332) Thence West 1900 ^{ft} r m^d
- 333) Thence West 1900 ^{ft} r m^d Block
fw cor Peak (South of Mt br S43W
- 334) Thence West 1900 ^{ft} r m^d in valley
- 335) Thence West 1900 ^{ft} r m^d fw on hill
br S33W
- 336) Thence S45W 2688 ^{ft} r m^d in
valley
- 337) Thence S45W at 775 cross road
2688 ^{ft} r m^d
- 338) Thence West 1900 ^{ft} r m^d in frag
Thence West 1350 ^{ft} to the El Paso
road to camp Dec 25th
December 26th continuing West
- 339) 1900 ^{ft} r m^d on E side of a hill
range course of it S80W
Block
- 340) Thence S45W at 1000 cross El Paso
road 2688 ^{ft} r m^d

- 341) Thence S 45 W 2688^{ft} r m^d
- 342) Thence S 45 W 1850^{ft} to camp
 Dec. 27 continuing about $\frac{1}{4}$ mile
 SE of the mountain
Thence South at 1000^{ft} cross a deep
creek course West 1900^{ft}
- 343) Thence S 45 W 838^{ft} (at 410^{ft} cross
a) r m^d for corner
on S side of Mountain
- 343) Thence S 45 W at 1350^{ft} side of alt
range (cross S side about south
with overhang limestone)
2688^{ft} stone m^d on foot of alt
- 344) Thence West crossing several
branches gl. course SW-1900^{ft} r m^d
- 345) Thence West at 1380^{ft} cross creek
1900^{ft} r m^d made in prairie f.w. n
point of Mono bond hills brs S 42 W
S point of same brs S 62 $\frac{1}{4}$ W
- Blocks
- 346) Thence West at 600 cross a large
Crab course S. W. at 1525^{ft} at point
of N bank brs S 18 $\frac{1}{2}$ W.
The pass brs S 23 W
S pond brs S 47 W
1900^{ft} r m^d made in a large prairie
f.w. S point of Mono bond hills brs S 40 W
or hill brs S 5 W

December 27 in camp

December 28 continuing west

347 Thence West 1900' \approx m^d in prairie
for extra S^r point brs at 20E

348 Thence West 1900' earth m^d with
rocks on top for. S^r brs at 57E
Pass in hill (road mount) brs at 45E

349 Thence West at 1120' cross El
Paso road 1900' \approx m^d near E side
of hill range course S^rW

350 Thence S^r 45W 2688' \approx m^d in a
large prairie

351 Thence S^r 45W at 1665' cross El
Paso road 2688' \approx m^d in valley
for a con hill brs at 82½W about 650'
plots

352 Thence S^r 45W 2688' mound of
small rocks in sand

353 Thence S^r 45W 2688' earth m^d

354 Thence S^r 45W 2688' \approx m^d on a
little sandhile

Dec 29th cont.

355 Thence West 1900' into and
 \approx m^d for. 1. Plate for gyps
2. Plate on range brs at 81½W
3 brs at 73½W. 4. brs at 69W

356 Thence West 1900' earth & r. m^d

- 357) Thence West 1900^{ft} earth + r. m^d
block
- 358) Thence West 1900^{ft} earth + r. m^d
- 359) Thence West 1900^{ft} at 1830^{ft} cross
road course S^W stake in a earth m^d
- 360) Thence West 1900^{ft} to a stake in
a earth m^d
- 361) Thence West 1900^{ft} earth m^d for.
Plate No 2 brs at 76¹/₂ W. Plate 3 brs at 64³/₄ W
Plate 4 brs at 51 W.
- 362) Thence West at 185^{ft} cross^d road
course S^W at 730^{ft} cross El Paso
road 1900^{ft} earth m^d
- 363) Thence West 1900^{ft} earth m^d for.
block
Plate No 2 brs at 73¹/₂ W
No 3 brs at 59³/₄ W det. brs at 45 W
- 364) Thence S⁴⁵W at 1700^{ft} El Paso road for
Ob. on the mea... brs at 85 W
Plate No 2 brs at 68 W Plate 3 brs at 54¹/₂ W
Plate No 4 brs at 41 W

January 2nd 1879.

Connecting line

Beginning at monument (meridian lately established in the town of Franklin)

Thence at 45^E 1000^{ft} + 1000 + 1000 + 1000 + 1000 + (at 610^{ft} a r. m^d made of granit

rocks) 1000⁰⁰ + (800⁰⁰ rocks md) + 1000⁰⁰
 + (at 740⁰⁰ r md md in a high bank
 of Rio Grande wally at 760 cross a road)
 Continuing at earth md on El Paso road
 S 45 W at 988⁰⁰ l at 968⁰⁰ cross road
 earth md in the fortz of the road

365) Thence West at S cross road at
 1700⁰⁰ cross El Paso road 1900⁰⁰ earth
 md North and near El Paso road

366) Thence West at 685 cross road at
 1665⁰⁰ cross an other road 1900⁰⁰
 earth md with small rocks on its top

367) Thence West at 330⁰⁰ cross road
 1900⁰⁰ earth md

368) Thence West at 165⁰⁰ cross a large
 road at 1900⁰⁰ an other road at 1500⁰⁰
 a large road 1900⁰⁰ to an earth
 md with small rocks on its top. fw.
 Obect on the ridge brs N 75 W
 West Gate brs N 47 W.

Thence S 45 W 1608⁰⁰ Being a
 monument in Franklin Thence
 N 45 E 7740⁰⁰

Thence N 45 W crossing road 68⁰⁰
 to r md fr connecting line 480⁰⁰
 N 48⁰⁰ W 6610 north + 6610 East

Jan 3rd

Beginning at monument Franklin
Thence N 45 W 68th

Thence West 440th

Thence N 45 W 1140th (886 north
886 W)

Thence North 2000 + 322th rock m^d
on N bank of a ravine

Thence N 45 W at 2000th top of a
hill 2250 another creek 2688th stone
m^d made on a ridge

Thence N 45 W at 2400th a creek
2688th stone m^d on N bank of a ravine

Thence N 45 W 1400th (camp
continuing Jan 4th 2688th (at 1470
r m^d on an old corner, at 1700th
a at 2400th r m^d on top of
ridge 1228th Thence North 3 miles Jan
West 2 miles)

Thence North 1900th r m^d in bed of
Creek f w. mesquit 8 on N. b. of Creek
brs N 1/2 W 736 for Mesquit 10 brs
N 10 W 119th do 7. brs East 70th

Thence West crossing creek 1228th
r m^d (cor West about 1/2 mile then
crossing river in a bend)

Thence $N 45^{\circ} W$ at 450° a large Creek runs West at 800° cross another Creek at 1970 another creek 2688° stake & m^d in a ravine

Thence $N 45^{\circ} W$ 1470°

Continuing Jan 4th

at 2080° slough of river 2688° stake & m^d about $\frac{1}{2}$ mile East of ...

Thence North at 760° cross slough again at 1425° again at 1760° 1900° a & m^d in both

Thence North 310°

Thence East 300°

Thence North at 440 cross Creek at 1200° & other branch come out 1590° & m^d (East crossing Plate)

Thence North at 100° cross Creek 1900° at & m^d in round hill

Thence North at 770° a large Creek 1900° stake for. Plate crossed by line brs $S 20^{\circ} E$

Thence West 300° & m^d for cor for Aug 12 brs $N 5^{\circ} E$ 97° Aug 3 brs $N 21^{\circ} W$ 36° Aug. Plate north line brs $N 73^{\circ} 1/2^{\circ} E$... Plate brs $N 56^{\circ} 3/4^{\circ} E$

Thence North 1900° roots m^d for. Aug 5 brs $N 11^{\circ} 1/2^{\circ} E$ 158° Aug 4 brs $N 10^{\circ} E$ 158°

P hrs at 83 1/2 E

Double P hrs at 66 E to camp

Continuing Jan 5

Thence North at 775 c crests 1900^m

r m^d for four Peatz hrs S 86 E

double Peatz hrs at 76 3/4 E

Thence North 1900^m r m^d for a

Bottomwood hrs. S 64 3/4 W mesq 3 hrs

S 6 E 18 1/2^m

Thence North 1900^m at r m^d

Thence North at 1520 cross a road 1900^m

pile of hills at cor I made on

Thence West at 1690 cross road

3980^m bank of Rio Grande

$\frac{368}{365}$ Jan 6th camp Jan 7th in camp

Jan 8th in camp Jan 9th in camp

Jan 10th 1900
368

Continuing in road 368^m south of
m^d of Gull (w L) made on the 5th

1) Thence East 1532^m at r m^d

2) Thence East 1900 m

3) Thence East 160^m road

580^m road 1900^m stone m^d cor B.

Thence South 1120^m

Thence West 253^m to monument

Jan 11th

Big at corner β made on the 10th

- 1) Thence East at 1200^{ft} road 1900^{ft}
- 2) Thence East 470^{ft} road 1900^{ft} stake
& m^d on N side of a high hill
- 3) Thence East at 160^{ft} top of hill
1900^{ft}
- 4) Thence East 1900^{ft} in prairie
- 5) Thence East 1900^{ft} in prairie
Thence South 1120^{ft}
- 6) Thence East 1900^{ft} (varied N° E)
- 7) Thence S 45° E 2050^{ft}

Jan 12th (Sunday)

at monument East of the road

Thence West at 25^{ft} cross road

990^{ft} to Cañuellos N E cor

Continuing S 45° E at 2620 cross road

2688^{ft} at m^d f.w. monument

on the mountain br S 75° W

- 8) Thence South 1900^{ft} r m^d of small
rocks
- 9) Thence South 1900^{ft} r m^d small
rocks f.w. 1. Seat^s north of cañon
br S 48¹/₂° W, 2. P. south of cañon
br S 32° W
- 10) Thence South 1900^{ft} r m^d f.w. P. 1
br S 59° W P. 2 br S 37¹/₂° W
- 11) Thence South at 1720^{ft} cross road
over mt 1900^{ft} r m^d f.w. P. 1. br S 72° W

P. 2 hrs $S 44\frac{1}{2} W$

Can other connecting line
Peg at N W corner of Survey # 2
in the name of Jonathan W Cummings.

Thence $S 36\frac{1}{4} W 2820^{\text{m}}$

Thence $S 53\frac{3}{4} E 58^{\text{m}}$

Thence $S 36\frac{1}{4} W 14^{\text{m}}$

to monument

N W corner of sur # 2 is 542^{m}

South and 583^{m} East of from
Section concerning it

Variation $12^{\circ} 30'$ as calculated

by $\frac{12.78}{0.1200} = 0^{\circ} 45'$

$11\frac{3}{4}$
 $12\frac{1}{2}\frac{3}{4}$

monument from S W of section
on sur # 2 in the name of

A. Styles 1270^{m} north and 59^{m}

East

Page 15th

Peg at the supposed N W cor of
sur # 2 in the name of Lou W
Cummings.

Thence South 542^{m}

Thence East 1317^{m} for m flagstaff
bracket 76 E C. . . .

D Thence East 1900^{m} for flagstaff 33rd 11

- 2) Thence East 1900^{ft} (3)
- 3) Thence East 330^{ft} cross road
Continuing Jan 16
- 4) at 1190^{ft} cross road for church steeple
brs S 62³/₈ N flaggs N 85¹/₈ W
- 5) Thence East at road 60^{ft} another
road 290^{ft} 1180^{ft} another road for
Church steeple brs S 67¹/₄ W 1900^{ft}
to an earth m^d
- 6) Thence East at 1890^{ft} road at 1900^{ft}
to earth m^d (6)
- 7) Thence S 45 E 2688^{ft} to large
earth m^d
Thence S 45 E 585 cross road
at 1820 another road 1830. for
Church steeple brs S 88¹/₄ W
Continuing Jan 17[#]
2688^{ft} large earth m^d
- 8) Thence East at 270^{ft} road an
other at 505^{ft} do at 1220^{ft} at
1400^{ft} ravine
- 9) Thence East 1900^{ft} earth m^d
- 10) Thence S 45 E at 750^{ft} road do
at 1700^{ft} do at 2660^{ft} 2688^{ft} large
earth m^d
- 11) Thence South 1900^{ft} to earth m^d

- 12) Thence S45E at 2255^m road at 2300^m
 a creek 2688^m earth m^d fw. Ysleta
 church to S78 $\frac{1}{2}$ W Sooria church br
 S37 $\frac{1}{2}$ W
- 13) Thence East at 410^m road at 560^m
 1900^m to earth m^d fw. Ysleta church
 br S81W.
- 14) Thence East at 440^m road 1900^m to
 a large earth m^d
- 15) Thence S45E 2688^m to a large earth
 m^d with stones m^d on its top
- 16) Thence S45E at 1000^m road 2688^m
 to a large earth m^d on S side of road
 fw. S of m. . . . br at 88 $\frac{1}{2}$ E
- 17) Thence S45E 2688^m to an earth m^d
 Continued Saw 20^f
- 18) Thence S45E at 1900^m 2688^m
 earth m^d fw S point of mountain
 br at 80 $\frac{1}{2}$ E
- 19) Thence S45E at 1080
 br at 61W
 at 2335^m a large road at 80E
 at 2420^m another large road course
 S70E 2688^m earth m^d fw. S. P. . .
 of m. . . . br at 7: E
- 20) Thence South 1900^m earth m^d

21. Thence South 1900² earth md. fw.
Point of Corrauas l. brs S 71 E
- 22 Thence South at 1265 cross road
1270 Salt Lake road a N 72 1/2 E
at 1270⁵ earth md. stop
January 21^a
Camp to be moved
Jan 22th
Continuing South (hills)
1900⁵ earth md (22)
- 23) Thence South 1900⁵ to an earth md.
made in a ravine
- 24) Thence South 1900⁵ to an earth
md. fw. prominent Plate brs S 8 W
another S 24 3/4 E
- 25) Thence South at 1280⁴ cross a road
1900⁵ to an earth md. fw. rip on
Plate brs S 8 1/2 W another S 25 3/4 W
- 26) Thence South 1900⁴ earth md. fw
2nd Plate brs S 27 1/4 E
- 27) Thence South 1900⁴ to earth md.
fw. 1st P. brs S 9 1/2 W 2nd brs S 28 1/2 E
- 28) Thence South cross road at 1310⁴
at 1850 cross main road 1900⁵
to earth md. fw. a Turnio S brs
S 9 3/4 E do S brs S 52 1/2 W
Thence South at 845th road 1225th

to river bank

Jan 25th

Beginning at River Bank 15th
South of road course of river down
S¹⁹ E for over a mile up the river
at 55 W.

Thence East at 1560th Telegraph road
1900th r d md in land

29) Thence South at 425th cross road
1040th state for a Cottonwood 14
m^{ts} x brs at 7 $\frac{1}{2}$ W 72th do 16 brs at 268
63th

30) Thence S⁴⁵ E 2688th near Telegraph
for Cottonwood m^{ts} x brs S⁴⁹ $\frac{1}{2}$ W
90th do 14 m^{ts} x brs S⁶⁹ $\frac{1}{4}$ W 87th

Thence S⁴⁵ E at 400th road end. . . .
at 1700th road stop

31) Continuing Jan 26th (near
state in Tel. line at 2688th r m^{ts} for
Church of Lau Syn about brs south
Plate No 1 brs S⁷⁸ $\frac{1}{2}$ E Plate 2 brs S⁷¹ $\frac{1}{2}$ E

32) Thence S⁴⁵ E at . . . 770th church brs
S¹⁵ W at 26th is the hill S³³ W
2688th state near and south of Tel. ~~plate~~
for a m^{ts} x brs at 46 W 62th
Cottonwood m^{ts} x 14 brs S⁶⁸ E 81th

33 Thence S 45° E at 1000⁰⁰ main road
at 1665⁰⁰ road to Guadalupe. Sun
bars about S 55° W - 2688⁰⁰ for
a cotton & brs S 59° W 760
(Guadalupe S 59° W) cotton wood X
12 brs at 69½° E 104⁰⁰

Thence S 45° E at 1745⁰⁰ enters bend
of river at 2150⁰⁰ Guadalupe brs
S 72½° W & S 79½° W

Thence East 430⁰⁰

Thence S 45° E at 1200⁰⁰ a slough at
1800⁰⁰ the same river South about
at 1900⁰⁰ at 2320⁰⁰ river course
river up west

Thence with river at 61¼° E 200⁰⁰

Thence with at 48° E 840⁰⁰

Thence at 81½° E at 1000⁰⁰ road 1080⁰⁰

Thence S 52½° E at 150⁰⁰ road
210⁰⁰ river bank

Thence with river S 63¾° E 260⁰⁰
rd road

Thence with river S 35½° E 870⁰⁰
course of river down S 35° W about
2 mile turn

Thence S 78¼° E little Prairie line
at 770⁰⁰ a road on east at 1200⁰⁰

main road near Telegraph post

Jan 27

San Ignace brs S 58 W

Thence East 290^o

Thence South 401^o at 145^o

main road at 165 see other road
near junction a 246^o river bank

Thence East at 190^o San Ign
brs S 58 W 450^o

Thence South 155^o near road
in river bank San Ignace brs S 64 1/2 W

course of river up S 71 W down
S 21 W con. unmed. Jan 27 Camp

34 Thence East at 1450^o earth m?

35 Thence East at 950^o San Ign brs
S 74 1/2 W at 1900^o earth m?

36 Thence East at 1700^o San Ign
brs S 80 3/4 W

37 Thence South 1900^o earth m?
near that 1930^o South 1900^o

Thence South 220^o road

Jan 28^o

Thence North 220^o #

Meanders of Rio Grande
 Commencing on river South of cor-
 ner of 28-55th from water course
Thence N 45 W at 240th river South
 60th at 717th river south 72th at 850th
 river -
Thence North 200th
Thence N 45 W at 390th river South
 112th at 720th river -
Thence with river North 278th
Thence N 57 W 750th with river
Thence North 30th
Thence N 57½ W 340th with river
Thence North 30th
Thence N 57½ W 340th with river
Thence N 16½ W 221th with river
Thence N 30 W 263th with river
Thence N 14¾ W 273th with river
Thence N 45 W at 390th
 South 238th 610th
Thence South 1900th
Thence N 45 W 270th
Thence West 210th to river
Thence N 45 W 210th 320th to river
 Samuels brook
 Thence back last 320th and taking
 back at 435th

- Thence $\text{N} 4 \text{ W}$ with said bank 250^{ft}
 Thence $\text{N} 45 \text{ W}$ with bank 110^{ft}
 Thence $\text{N} 64 \text{ W}$ at 560^{ft} bank
 45^{ft} at 910^{ft} bank 60^{ft}
 Thence West at 320^{ft} bank 28^{ft} at 495^{ft}
 bank 60^{ft}
 Thence West at 320^{ft} bank 28^{ft} at 495^{ft}
 bank 85^{ft}
 720^{ft} stopped bank is 330^{ft} from line
 Thence $\text{S} 86\frac{1}{2} \text{ W}$ 1840^{ft} to river bank
 Course up river North West
 along ge worn of river $\text{N} 33 \text{ W}$
 for 3550 : down river
 South - $\text{N} 20^{\circ}$ at
 39) Thence $\text{S} 45 \text{ E}$ 2688^{ft} rock m^a
 40) Thence $\text{S} 45 \text{ E}$ at 2529^{ft} a large
 creek at 2688^{ft} earth m^a
 41) Thence $\text{S} 45 \text{ E}$ at 2645^{ft} road
 at 2688^{ft} earth m^a fr.

Jan - 29th

Pay at cor $\text{N} 36$

Thence North at 960 table land at 1900^{ft}
 earth m^a fr. N part of Mesa brs
 $\text{N} 31\frac{1}{2} \text{ E}$ $\text{S} 6$ brs East $\text{S} 89 \text{ E}$
 Double Peats on Sierra de los Lamentos
 brs $\text{S} 71\frac{1}{4} \text{ E}$ $\text{S} 11$ cor 37

- (6) Thence North 1900th earth ^{mid}
 sp of mesa brs at $87^{\circ} E$
 sp brs at $34\frac{1}{4}^{\circ} E$
- (c) Thence North 1900th earth ^{m^a} ^{fw.}
 Emp point of mesa brs at $22\frac{1}{2}^{\circ} E$
 pp brs at $37\frac{1}{4}^{\circ} E$
 Sp brs $S^{\circ} 83\frac{1}{2}^{\circ} E$
 Double p brs $S^{\circ} 67\frac{1}{2}^{\circ} E$
- (d) Thence North 1900th earth ^{m^a}
- (e) Thence North 1900th earth ^{m^a}
 fw. Dob Pk brs $S^{\circ} 64\frac{1}{4}^{\circ} E$
 Sp of mesa brs $S^{\circ} 77\frac{1}{4}^{\circ} E$
Thence North 305th fw.
 n p of mesa brs at $45\frac{1}{2}^{\circ} E$
 Ep brs at $36\frac{3}{4}^{\circ} E$
Thence East (Jan 30) 1900th
- (f) Thence South 305th earth ^{m^a}
 for air
Thence East 1900th earth ^{m^a}
 fw. Sp of mesa brs $S^{\circ} 75\frac{1}{2}^{\circ} E$
- (g) at P. brs at $34\frac{1}{2}^{\circ} E$
 at East P. brs at $24\frac{1}{2}^{\circ} E$
Thence East 1900th large earth
^{m^a} ^{fw.} Sp of mesa $S^{\circ} 94\frac{1}{2}^{\circ} E$
 h sp of mesa brs at $28^{\circ} E$
Thence East 1900th earth ^{m^a}
 small rock on its top fw

Doblo brs S 60 3/4 E | next peak in line
Sp of 4 brs S 73 1/2 E | on... A 78 1/4
A sp of M. brs A 20 1/2 E | ~~at~~ S 66 1/2 E

Jan 31st

Febr 1st

Febr 2nd

Febr 3rd morning Camp
Continued by at cor A 141

Thence S 45 E at 1300^{ft}. S end
monte brs A 81 1/2 E

Saddle brs A 79 3/4 E

A end brs A 70 3/4 E at 2688^{ft}
earth m^d frw S end brs A 81 E

Saddle brs A 77 1/4 E

North E A 68 1/2 E

Thence S 45 E at 2688^{ft} earth m^d
frw a Gordon mtz 1/2 30 in dia brs

S 69 3/4 E 38^{ft} another 5 brs A 23 3/4 W
3700. S 45 E at 1367^{ft} (Rio Grande)

Then East at 6.....

(24) 1900^{ft} earth m^d

Thence S 45 E 2688^{ft} to

(45) earth m^d

Thence South at 1515^{ft}.....

(46) 1900^{ft} to earth m^d

Febr 4 rain Febr 5 cum on
river banks frw.

S end of mesa brs at 47 E 53 3/4
N end of mountain brs at 53 1/4 E (53 1/2)
Saddle brs at 64 1/2 E
S end of mountain brs at 63 3/4 E
Little Trade brs at 70 1/2 E

- 1. Platz on laminated mt brs at 82 1/2 E
- 2. Hills of at 89 E

Thence at 70 3/4 E 1120' to cor at 146

47) Thence S 45 E at 640' a creek
2688' earth m^d

48) Thence East at 1900' a large earth
m^d fr. S end of mt brs S 60 1/4 E
Saddle brs at 55 3/4 E
N end at 43 1/2 E

49) Thence S 45 E at 1475' a creek
at 1805' road 2688' earth m^d
fr. E. brs at 75 E
Pt 2 brs at 81 1/2 E

50) Thence S 45 E 2688' to earth m^d
with rocks on its top

Thence S 45 E at 90' creek
at 480' another creek at 900'
a large brook at 1630' an old
road at 2688' a stone m^d

Feb 6

Continuing

Thence South at 650' creek

at 660th an old road at 1110th another
 Creek at 1900th on earth m^d fir
 a Cottonwood 12 in dia brs S 5 1/2 W
 320th another 12 in dia brs S 5 1/2 W 326th
 mtz at x

Thence S 45 E at 425th a stone m^d
 53 p S 45 W 13th
 at 2173th a stake

at 2189th stake in a rock m^d
 S 45 W 28th at 2688th earth m^d
 fir a Cottonwood 15 in brs S 15 1/2 E
 235th another 12 in dia brs S 17 1/2 W
 209th

Thence S 45 E at 600 road 2688th
 Earth m^d fir. S end of mountain
 brs S 76 1/2 E high plate on brs
 S 83 1/4 E at end brs A 66 E

Thence S 45 E 1800th
 to

Febr 7th

Begin at cor of 53

Thence at 45 E at 980th an old
 at 1428th Mountain range at
 pass I plate (new) brs S 70 E
 II plate S 73 1/4 E III high 9 brs S 75 1/4 E
 Little p (at end) brs S 83 E

2 mountain range
I high Peak brs S 84 E
II h P brs S 86 1/2 E
Little Pean near of end brs S 89 E

III range
I Peak brs S 89 1/2 E
Little P brs S 87 E
high P S 85 1/2 E
brs S 77 E
Doble P South brs S 67 1/2 E
another brs S 67 1/4 E

Peak brs S 29 1/2 E
S 23 E

Peak β brs S 23 3/4 E
at 2080 a branch at 2360 ^{or}
break course S E. at 2688 ^{or}
an earth m^d small rocks on
its top for a mesquite 4 in
brs S 33 1/2 W 23 1/2 ^{or}

(β) Thence S 45 E 2688 ^{or} earth m^d
Thence S 45 E 2688 ^{or} earth
a n m^d in valley of Creek
(course S 35 E) for

I Mountain Range
I Peak S end brs S 50 1/2 E
II P brs S 53 1/2 E

III Phipps bars $S 57\frac{1}{2} E$

at end bars

2nd m r

1 high P bars $S 60\frac{1}{4} E$

2 " " $S 69\frac{1}{4} E$

Little P near n bars $S 73\frac{1}{2} E$

III range

1 P bars $S 74\frac{1}{2} E$

high P bars $S 79\frac{3}{4} E$

Dolbe-Beak

1 Southern bars at $74\frac{1}{4} E$

1 northern " at $73\frac{3}{8} E$

Nucle P bars at $33 E$

P (β) bars at $24\frac{3}{4} E$

P at $22\frac{3}{4} E$

P (α) bars at $22\frac{1}{4} E$

a ... m r x 15 bars $S 74\frac{1}{4} E 271^{\circ}$

a do 8 $S 73\frac{1}{2} E 259^{\circ}$

Thence at $45 E$ at 120° a large

road at 1853° a break at

2688° m d of by sulph of

mag. salt + rocks for

Beats in line at $45 W$) n end of

range bars at $28\frac{1}{4} E$

at end bars at $24\frac{3}{4} E$

P. β bars at $17\frac{1}{2} E$

N end of range bars at $4\frac{1}{2} E$

Febr 8.

Continuing at cor of 54

- 55) Thence East 1900^{ft} to an earth m^d with rocks on its top made out N side of a creek branch
- 56) Thence East at 650^{ft} cross main road at 1900^{ft} earth m^d with rocks on its top
- 57) Thence East at 740^{ft} a large creek 1900^{ft} earth m^d
- 58) Thence South at 1050^{ft} creek 1900^{ft} r m^d
- 59) Thence South at 1516^{ft} main road at 1900^{ft} earth m^d f.w. Cottonwood m^d x 12 m^d br S 19 1/2 W 205^{ft}
do 10 br S 23 1/2 W 205^{ft}
- Thence South at 340^{ft} old river at 907^{ft} to stay br of 45E 44^{ft}
- Thence South 45E at 1700^{ft} river Banks to corner of 59
- 60) Thence East 1900^{ft} to stone m^d.
- 61) Thence S 45 E 2688^{ft} r m^d
- Thence S 45 W 1500^{ft} to river

Continuing Feb 9 as follows
to w Beginning at cor of 61

- 1) Thence S 45 E
- 2) Thence South

a) Thence S 45 E
Thence South
Thence South (5 miles East to corner
of Block

② Thence S 45 E 2688^m to r mt^l for
S end brs at 76 1/2 E
 1 Peak at 57 3/4 E
 Main P br at 55 m E
 S S brs at 51 1/2 E

2nd range
 1 Peak brs at 45 3/4 E
 2 brs at 43 3/4 E
 next brs at 40 3/4 E
 North End hill P brs at 31 E

3 range
 Main P brs at 34 1/2 E
 at end P brs at 26 E

range South of pass
 1 Little table top brs S 86 3/4 E
 2 high 1/2 top S 79 E
 3 S 70 3/4 E
 4 S end table brs S 64 3/4 E

Thence South at 970^m a large
Creek at 1218^m Pass road at 1640^m
an other branch 1900^m earlier mt^l

64) Thence South at 1660^m run West
 about 150^o at 1900^m r m d
Thence S 45 E at 1370^m El Paso
 road at 1700^m break at 2685^m
 at m d low

1 range

S end P. br at 45 E

m P at 30 E

2 P at 23 3/4 E

2nd range

S end W P br at 12 1/2 E

South of Pass

1) at 66 3/4 E, 2) at 79 E 3) S 86 E

4) br S 77 1/2 E

66) Thence South 1900^m r m d
Thence S 45 W at 4600^m old road
 at 1850^m river
 cont. Febr 10th

Beginning at cor 65 f.w.

P br 1 br S 69 E

P β to S 59 1/4 E

67) Thence East at 1900^m r m d

68) Thence East at 1260^m cross creek

(course South) 1900^m r m d on top of
 hill

69) Thence East 1900^m earth m d with
 rocks on its top

70 Thence East at 1850^{ft} cross a large
creek 1900^{ft} to a rock mt. Febr 11

71 Thence East 1900^{ft} r mt

72 Thence North 1900^{ft} r mt

73 Thence North 1900^{ft} r mt

74 Thence North 1900^{ft} r mt

75 Thence North at 1813^{ft} I was
1900^{ft} r mt

Febr 11

Begin at cor of 61

61-a Thence N 45 E at 1850^{ft} an old road
at 2688^{ft} r mt

61-b Thence N 45 E 2688^{ft} r mt

61-c Thence East at 1480^{ft} old road
1900^{ft} r mt

61-d Thence East 1900^{ft} r mt on
foot of mountain

Febr 12

Beginning at cor of 75 in
cañon le Puerto de los Lamentos

Thence N 45 E 1100^{ft} r mt

Thence East at 330^{ft} cross creek
and El Paso road 720^{ft} r mt

Thence N 45 E at 700^{ft} cross road
& creek 710^{ft}

Thence East 1450^{ft}

Thence N 45 E at 200^{ft}

- 75^a - Traverse of canon road + Creek
 at 878^{ft} r m d fw. a fork $\frac{1}{2}$ bed
 10 brs S⁶³ W 125^{ft} do 8 brs S⁸⁸ W
 132^{ft}
- 76) Traverse East at 660^{ft} a creek
 at 920^{ft} an other creek at
 1035^{ft} a r m d fw high Peak 3rd
 range brs at 32^{ft} W
- 77) Traverse East 1900^{ft} to a r m d
 fw. Saddle of Dolle Peak by at 104
- 79) Traverse S⁴⁵ E 2688^{ft} to an earth
 m d fw. on Eagle mountain
 1st range
 at high P brs S⁶⁶ $\frac{1}{2}$ E
 and Tallu P brs S⁶⁰ $\frac{1}{2}$ E
 2nd range
 at high P brs S⁵⁹ $\frac{1}{2}$ E
 SW end P brs S⁵³ E
- 80) Traverse S⁴⁵ E at 1730^{ft}
 top cont. Feb 13th
 2688^{ft} r m d near Tulline
- 81) Traverse S⁴⁵ E at 1300^{ft} cross
 El Paso road 2688^{ft} stake fw
 Green thorn brs at 45^{ft} 89^{ft}
 do 3 brs at 7^{ft} 23^{ft}
- 82) Traverse S⁴⁵ E 2688^{ft}
 earth m d fw.

Green thorn 4 brs at $42\frac{1}{2}$ W 79^W
 mesq. 2 brs S⁸⁸ W 21^W

Eagle mountain

High P. brs S⁷⁴ E

n Double P br S⁷⁰ $\frac{1}{2}$ E

low hill " S⁶⁵ E

2nd range

high P brs S⁶³ $\frac{1}{2}$ E

S^W end P. brs S⁵⁶ E

83 Thence East crossing
 rim South East 1900^{ft} rmd
 for a rim Peak on Carmentos
 brs S¹⁰ $\frac{1}{2}$ W

84 Thence East 1900^{ft} rmd
 r Pond brs S¹⁷ $\frac{3}{4}$ W

85 Thence East at 950^{ft} cross
 Es Pass road 1900^{ft} rmd
 for rim con hill L brs S²⁴ $\frac{1}{2}$ W
 range Eagle m

high P brs S⁵⁷ $\frac{1}{2}$ E

n w end brs S⁴⁷ $\frac{3}{4}$ E

86 Thence East at 350^{ft} cross
 a ridge 1900^{ft} rmd mt^a TP

87 Thence East with South slope
 of mountain 1900^{ft} to a limestone
 rmd mt^a x for phosphur rock
 mt^a x brs S⁵ W 210^W

another mt^d x brs S⁴⁴W 31⁵
88. Thence East at 1500⁵ at Dunes
Continuing Feb 14th

at 1800⁵ El Paso road 1900⁵ Earth
& stone mt^d for S⁹ of D. m.

At 59³/₄E flat con hill brs at 12³/₄E

89 Thence East at 1280⁵ top of ridge
con from high at 1900⁵ Earth mt^d
for con on hill brs S³²W 4E
At P. high mt b S⁵⁶E

2nd range

SW end P brs S³⁴W 4E

90 Thence East at 1376⁵ El Paso
road 1900⁵ to a r mt^d
mt^d TP for con hill on Drab
m brs at 43¹/₄E

con hill on Eagle m br S¹⁸E

91 Thence East at 1220⁵ ridge
cross S⁵⁵E

at 1900⁵ Earth mt^d in valley
for at P Eagle m brs S⁴⁴W 1/2 E
Solbe P br. at 44¹/₄E

low hill of E m brs S⁷⁰W 1/2 E

92 Thence East at 500⁵ cross
small ridge at 1900⁵ Earth mt^d
a fortified cedar br ; S³W 1/4 E 275
for a Flat round top br at 3¹/₂W

Peak of fw Em br S 16 3/4 E

93 Thence East at 1600' = a ridge
at 1900' r md fw. S P Diob br
A 54 3/4 E

Bull head on hill bears at 35 1/2 E

94. Thence East 1900' = r md
fw. S Eud P Sil m br at 5 1/4 E
~~Bull head P br at 30 1/8 E~~
~~low hill near at end opp dial~~
~~br at 61 E~~

~~Thence S 45 E~~

S P on Egle m br S 26 E

95 Thence East 1900' = r md
fw. S Eud P Sil m br at 5 1/2 E
Bull head P br at 30 1/8 E

on hill near at Eud opp dial
at 61 E

96 Thence S 45 E 2688' r md fw.
high P 3 range br S 6 1/2 E

end eagle inter br S 35 3/4 W

97 Thence South at 420' cross El
Pass road 1900' r md on
slope of high mountain

Thence East cont Feb 16th
at 300' mail station - South 300'
Feb 16th Big at cor
A 96

98. Trunce S 45 E at 1095^o El Paso road
at 1885^o re- from station at 2688^o
a stone md on E side of a large
hill
99. Trunce S 45 E at 900^o cross Creek
at 1055^o road corner SW at 1610^o
another road at 2688^o a stone md
100. Trunce S 45 W with a creek 2688^o
to a stone md fr. 3 for a Cedar 14 brs
at 85^o E 181^o do 8 india brs
S 16 3/4 E 139^o
101. Trunce West 980^o cross creek
at 1400^o a branch at 1900^o
a r md
102. Trunce North 1900^o to a r md
Febr 17th
Begin at cor at 100 fr. S end
Diab high p brs at 34 1/4 E
lower point brs at 37 E
round Pine head br at 18 1/8 E
Range South of Diab at S end
brs (round hill) at 44 7/8 E
S end brs at 56 1/4 E
103. Trunce S 45 W 2688^o to a rock
md made on a slope of a high
mountain near a bank of a
deep ravine fr a fork^d oak

mt^d x brs 6 in
 Dub brs at $56\frac{3}{4}E$ 37° a fort^d biden
 brs at $12E$ 25°

Thence at $45E$ 736°

Thence $S 45E$ at 1890 ^{of} middle
 of creek 10° - of spring
 course of Creek up $S 15W$
Febr 18

By at cor at 96

104 Thence East at 1100 ^{to} road at
 1900° r mt^d fw. E end Eagle mt
 brs $S 27\frac{1}{2}E$ at 2 brs $S 9\frac{3}{4}E$
 Capt. Platz brs $S 3W$
 Pass east end on Dial brs
 at $7\frac{1}{4}W$

105. Thence East 1900° r earth
 mt^d

106 Thence East 1900° to earth mt^d
 fw East end E. m brs $S 19E$

107 Thence East at 1890 ^{of} old road
 course SE 1900° earth mt^d fw
 Eagle P at 01 brs $S 6W$
 at 02 brs $S 20W$

Platz at 4 brs $S 48\frac{3}{8}W$
 Pass e end on brs at $19\frac{3}{4}W$

108 Thence East 1900° to earth mt^d
 fw Platz x brs $S 33\frac{3}{4}E$

- P brs S 45 $\frac{1}{2}$ E
 109 Thence East at 520 ^v cross
 mineral creek at 1900 ^v earth m^d fw
 P x brs S 30 $\frac{1}{4}$ E
 P y brs S 42 E
 110 Thence S 46 E 2688 ^v earth m^d
 fw. East End Eagle mt brs S 14 $\frac{1}{4}$ W
 - P x brs S 34 $\frac{1}{4}$ W
 at 2 " S 44 $\frac{1}{4}$ W
 at 3 " S 57 $\frac{1}{4}$ W
 at 4 " S 62 $\frac{1}{4}$ W
Thence South 1100 ^v to road
 - Febr 21
 P y at cor at 96 fw. mail
 station brs S 12 $\frac{1}{2}$ E a P
 brs S 40 $\frac{1}{2}$ E
 111 Thence at 45 E at 2400 ^v
 old road course about dock
 at 2688 ^v earth m^d fw.
 E end of mesa br at 29 W
 Bulls head brs at 23 $\frac{1}{4}$ E
 a P (?) brs S 24 E }
 Double Peak East of mt brs S 43 $\frac{1}{2}$ E
 112 Thence at 45 E at 1135 ^v
 at 2688 ^v an earth m^d
 fw. a Peak brs S 13 E
Thence at 45 E at 1600 ^v to 2000 ^v

a large . . . runs North at 2600^m
 another large . . .

2688^m an earth mt^d fw. a Green
 thorn 3 brs S 55^oE 48^m

do 4 brs S 53¹/₂^oE 48¹/₂^m

S^P Eagle brs S 4¹/₂^oW

114 Thence at 45^oE 2688^m earth mt^d
 fw & end of Mesa brs at 64¹/₂^oW
 (course of mesa about the same)
 Dobb Peak brs S 29³/₄^oE

115 Thence East 1900^m = Earth mt^d
 fw. Bull head at 9³/₄^oE
 Speat Eagle m brs S 12³/₄^oW

116 Thence East 1900^m to an earth
 mt^d fw. S^E Eagle c brs S 17^oW
 a Peak. brs S 13¹/₂^oW

9. of the foreg ✓ S 10¹/₂^oW

117 Thence East 1900^m to an earth
 mt^d on S side of a limestone
 Hill.

Thence East at 600^m mt^d
 on ridge continuing at 22^m
 . . . at 1900^m mt^d made on
 NW side of a high ph mountain
 fw. South P. Diab. brs at 21¹/₂^oE
 Round mountain S of Diab brs
 at 15^oE

- 119 Thence at 45° E crossing trail
at 2500^{ft} enters sandstone canyon
2688^{ft} a large r mtd frw a mtd x
brs North 9½[°] a white r mtd x
brs at 15 W 2[°]
- 120 Thence East at 75° Gorney Peak
brs S 84½ E at 1688^{ft} cross Hackberry
Creek 1900^{ft} to a r mtd made
out top of a hill
- 121 Thence East at 800^{ft} cross
Hackberry Creek at 960^{ft}
cross North fork of it at
1800^{ft}
- 122 Thence North 1900^{ft}
Thence East 100^{ft} r mtd north
and near Indian trail
Continuing Febr 23
- 123 Thence North 1900^{ft} to a stone
mtd made on a small ridge
- 124 Thence North at 1240^{ft} cross
Creek runs S E. at 1900^{ft} r mtd
on S side of cañon frw. a cedar
9 brs S 13¼ W 70[°] a Hackberry
near Springs brs S 7½ W 4500
- 125 Thence North at 960^{ft} cross
E. fork of Hackberry Creek
runs S W at 1840^{ft} cross a

128_K Thence East 700 ^{ft} cross
break road 1900 ^{ft} N mt
fw. ctp of m bro S 59 $\frac{1}{2}$ E

- branch of it near Hut at 1900[±]
 r m^d fw. a Cedar 6 brs S 61 2/4 E
 850[±] another Cedar 12 brs S 48 1/2 E
 90[±] another 10 brs S 42 1/2 W 115[±]
- 126 Thence North 1900[±] r m^d
 fw. S end Sm. b at 2 1/4 E
- 127 Thence East at 240[±] again
 cross a branch at 470[±] 1900[±]
 r m^d fw. top of mountain brs
 S 76 1/4 E
- 128 Continued Febr 24
 Beg 100[±] west of cor at 121
Thence East 100[±] to a r m^d
 made on high bluff
- 129 Thence East at 75[±] cross
 branch at 1320[±] cross Willow
 branch 1900[±] r m^d
Thence East at 930[±] cross Cotton
 Creek at 1600[±] foot of high
 mountain range
Thence South 1900[±]
- 130 Thence East 400[±] to a r m^d
- 131 Thence East 650[±] cross Cotton
 wood Creek at 1875[±] cross
 canon Creek 1900[±] to a r m^d
- 132 Thence East 1900[±] to r m^d
 fw. Gony. P brs S 85 1/2 E

Continued Feb 25th

Double P East of Eagle m brs S 8 W
a high Double P (Em) brs S 47 W
S point of range West of Cay brs
S 55 1/2 W

N E Plate of range East of Camp
brs at 24 3/4 E course of valley
S 15 E another S 40 W

133 Thence S 45 E at 120th a
road course West at 1955th
an old road course S 75 E
at 2688th an earth m d fw.
E end of Double P range brs
S 4 1/2 E

134 Thence S 45 E 2688th earth
m d fw. Double P East of
Em. brs S 16 1/4 W
E end of range brs S 12 W
Dalls on Eagle n brs S 55 1/4 W
S end range W of C brs at 7 1/2 W
N E P brs at 9 1/4 E

135 Thence East 1900th to an earth
m d

136 Thence East 1900th earth m d
fw S end eagle m brs S 45 1/2 W
Thence East at 1540th cross
break runs N E 1900th earth
and r m d

138. Thence East 1900[°] r + earth m^d
 fw. Peats near dry Camp
 brs N 34¹/₄ E
139. Thence East 1900[°] r + earth
 m^d fw camp brs S 27¹/₂ W
 Continued Feb 26th
140. Thence East 1900[°] to an earth
 m^d fw. Pass in mountain
 brs N 17¹/₂ E
 Peak near brs N 28¹/₄ E
 at 1240 is road course S E
141. Thence East 1900[°] r + earth m^d
142. Thence East 1900[°] earth m^d
 fw. high P Eagle m brs S 7¹/₂ W
 Pass brs N 13¹/₂ E
 Peats dry S N 21¹/₂ E
 (G P brs N 10 1/4?)
 No Peats brs S 87¹/₂ E
143. (4) Thence East 1900[°] v d
 earth m^d fw. Pass brs N 11³/₄ E
 Peats brs N 18 E
144. (5) Thence East 1900[°] earth m^d ^r
145. (6) Thence East 1900[°] earth m^d
 in valley
146. (7) Thence East 1900[°] earth m^d fw
 of end of mesa brs N 82 E
147. (8) Thence East 1900[°] earth m^d

variation $11^{\circ} 35'$

- 148 (9) Thence East 1900° earth m^d
- 144 (10) Thence East 1900° (with sand prairie)
- 150 (11) Thence East at 1250° at side of hill at 1900° earth m^d fr. a con low hill brs at $9\frac{1}{2}^{\circ}$ E another brs at 23° W.
- 151 (12) Thence East 1900° earth m^d fr. at end of mesa brs at $73\frac{1}{2}^{\circ}$ E con hill brs at $66\frac{1}{2}^{\circ}$ W
- 152 (13) Thence East 1900° earth on an old E S E
- 153 (14) Thence S 45° E 2688° earth or m^d.
154. (15) Thence S 45° E 2688° earth m^d.
- 155 (1) Thence S 45° E continuing = Feb 27th 2688° earth m^d fr. high Ptatz brs S 35° 58' E another Ptatz brs S $33\frac{1}{4}^{\circ}$ E
- 156 (2) Thence East 1900° earth m^d
- 157 (3) Thence East 1900° earth on d fr. high P brs S $11\frac{1}{16}^{\circ}$ E
158. (4) Thence East 1900° earth m^d fr. a Ptatz c brs S 31° W
- 159 Thence East 1900° earth m^d fr. P c brs S $36\frac{1}{2}^{\circ}$ W white con hill brs at $28\frac{1}{2}^{\circ}$ W Bantz brs at 33° W

160. Thence East 1900° earth m^d fw.
white con hill brs at 45 W
baults brs at 45 1/3 W
161. Thence S 45 E at 2688° a large
stone m^d made in the mouth
of the cañon
County = Feb 28°
162. Thence at 45 E 2688° r m^d
fw. con hill at 1 brs at 14 1/8 E
" " at 2 " at 12 1/2 E
White " " " at 5 3/4 W
163. Thence East 1900° r m^d fw.
con hill No 1 brs at 7 1/8 W
" " No 1. " at 1 1/2 W
another con hill brs at 23 1/4 E
" " No 2 brs at 22 1/8 E
No 3 at 21 1/8 E
- 164 (B) Thence S 45 E 2688° to earth
m^d fw. another con hill
No 4 brs at 7 1/2 E
No 1 brs at 8 1/2 E
No 2 brs 6 1/4 E
165. Thence South at 900° cross
large Britz runs North at
1740° a branch above its mouth
comes p^d at 1900° earth and
r m^d

166. = Thence S 45 W at 370° cross large
Creek runs E + West above it
junction with main creek at 800°
large creek (Walnut creek)
and with creek at 2000° enters
hill East course East of a spring
in the inside of mountain at
2688° a r m^d made on the E slope
of high mountain
167. = Thence South at 870° cross a
branch at 1220° an other branch
at 1400° earth m^d fr. an
Salt 18 in dia brs S 44 1/4 W 280°
March 1st
= Big. at corner of 161 made in
cañon fr. A end of diabolos m
brs N 45 1/4 W
168. (1) = Thence West 1900° r m^d
- 169 (2) = Thence S 45 W 2688° r m^d
fr. Peats brs S 60 1/4 W
- 170 (3) = Thence S 45 W 2688° r m^d
- 171 (4) = Thence S 45 W 2688° r m^d
made on N side of a foot hill
fr = Peats brs S 6 W another Peats
(2) brs S 46 W
- 172 (5) = Thence S 45 W 2688° earth
m^d all rain 4 1/2 E

173. (6) Thence S45W 220° Thence S
1745° Thence East 155° earth
m^d fw. Peats (d) brs S 68 1/4 W
high P Eagle m. brs at 88 3/4 W
on hill near cor brs S 76 W
174. (7) Thence S45E at 2510° cross
Willow Creek runs S W at 268°
earth + r m^d fw. Hackberry
7 brs at 64 2/3 W 145° a
black Walnut in bed of Creek
8 brs at 43 W 178°
- 175 (8) Thence East 1900° + m^d on
top of mesa fw. Peats on mesa
brs at 5 W

Mardi 3rd

Beginning at cor β at 164
ac side on the 28 ult

176. Thence East at 690° cross Walnut
Creek 1900° earth + r m^d
177. Thence East 1900° to r m^d fw
Gomez P brs at 77 1/3 E
178. Thence East at 1480° cross
Creek 1900° to ar m^d on st side
of a foot hill fw. a P top brs at 37 1/2 E
Gomez P brs at 75 1/4 E
179. Thence East 1900° to an earth +
r m^d

180. Thence S45E at 1680[±] break 684[±]
to an earth & r m d fw. a top brs
at 5 7/8 E - another R top brs
at 11 3/8 E. Gomez P brs at 64 1/2 E
181. Thence East with rally at
1900[±] earth & r m d fw. two con
hill. brs at 4 W
2 at 4 1/2 W
182. Thence East at 900[±] foot of hill
crossing it at 1900[±] large r m d
made on E side of hill fw.
apacha spring brs S 55 E
Gomez Pate at 55 1/2 E
Cottonwood 36 brs at 42 3/4 E
183. Thence East at 680[±] cross Grite
rives North below mouth of
spring at 100[±] enter foot hills
Dau mountains at 1900[±] r m d
made on west slope of main range
184. Thence S45 W at 85[±] two con
hills 1) brs at 22 1/2 W
2) " at 23 1/2 W
at 1080[±] cross spring branch
2688[±] r m d
Gomez P brs at 49 1/2 E

March 4th

Begin at cor of 182

185. Thence N 45 E at 760["] cross
Creek 2688["] stone and mason
top of foot hill

186 Thence N 45 E at 1740["] a creek
at 2620["] cross Oak Creek 2688["]
a mt. fw. Oak 10 brs S 3 1/2 E 227["]
f^d Oak 16 brs S 16 3/4 E 239 1/2["]
Gomez P brs N 65 3/4 E

187. Thence S 45 E at 640["] Oak
age at 740 + 920["] 2688["] a mt
fw. a rock outcrop x brs S 7 1/2 E
do do brs S 17 W 7["]
Gomez P brs N 41 3/4 E

Thence East 270["] to rock and x
a fork^d Oak 8 brs at 22 E - 189["]
10 brs at 59 E 203["]

March 5th

Begin at cor of 184 (S W of Spring)

188. Thence S 45 W at 2380["] small
creek another at 2620["] at
2688["] a stone mt fw. Oak 10 brs
N 21 1/2 W 23["] another Oak 5 brs
N 18 3/4 W - 205["]

189. Thence West 1900["] to + mt

190. Thence South 1900["] to r mt

- 191 Thence S 45 W 2688⁵ to r mt
- 192 Thence S 45 W 1900 Thence S 45 E
100⁵ thence continuing S 45 W
(at 34° N) to 2688⁵ Thence S 45 E
to 200⁵ continuing March 6
Thence S 45 W 500⁵ Thence West
500⁵ Thence S 23 3/4 W 800⁵
Thence S 45 E 600⁵ Thence South
171⁵ Thence East 540⁵
at 60⁵ branch 270⁵ to a large
r mt for an Oak 10 brs at 81 1/4 E
30⁵ Oak 14 brs S 39 W 31⁵
- 194 Thence South at 260⁵ high
Plate ^{mucosa} on mountain to S 11 1/2 E
at 1900⁵ earth m^d in prairie
dog town
195. Thence South at 800⁵ local attraction
lion 1 3/4⁵ West at 1900⁵ earth
r mt high S 12 3/4 E
March 7th
Beg at cor at 193
- 196 Thence S 45 E 2688 to r mt
made on E side of hill
197. Thence East at 970⁵ cross
Creek course North 1900⁵ to a
r mt made on E side of hill
for a Oak 12 brs at 71 1/4 E 125⁵

- do 7 hrs at $84\frac{3}{4}E$ 130⁰
198. Thence East 1900⁰ to r mt
local at $4\frac{3}{4}E$ fw. an Oak 8 hrs
 $S\ 58\frac{3}{4}E$ 5⁰ another 10 hrs
 $S\ 23\frac{1}{2}E$ 22⁰
199. Thence East 1800⁰ to a high
bluff 1900⁰ stake & mt in valley
about 2 miles wide
March 8th
- Big at cor of 193
200. Thence $S\ 45E$ 2688⁰ earth mt
201. Thence $S\ 45E$ 2688⁰ earth & mt
fw. Peak at 1 hrs $S\ 71\frac{1}{3}E$
at 2 hrs $S\ 49\frac{7}{8}E$
 S end of Ap in right br at $68\frac{3}{4}E$
202. Thence $S\ 45E$ 2688⁰ earth m
fw. P at 1 hrs $S\ 79\frac{1}{2}E$
at 2 hrs $S\ 52E$
- Big at cor of 202
203. Thence $S\ 45E$ 2688⁰ to
& mt fw. P on memento
mt brs $S\ 1\frac{1}{4}E$
204. Thence $S\ 45E$ at 1200⁰ break
2688⁰ & mt fw. an Oak 6 hrs
 $S\ 35\frac{1}{4}W\ 43$ another Oak 6 hrs
 $S\ 38\frac{3}{4}W\ 42$ March 9th big at cor
of 195 (3 hours $S\ 0E$)

205. Thence South 1900' earth mt.
- 206 2) Thence South 1900' r mt on
S end of a round hill for high
Peak brs S 14' 4" E (valley west
of line drawing north)
- 207 (3) Thence South at 370' another
round hill 1900' to an earth mt
in valley
- 208 (4) Thence South 1900' earth m
stone on top mt - TP for a r
rocky road hill brs about
375' another about ... brs
S 82 W
- 209 Thence South with valley 1900'
earth mt for con hill brs at 42 E
for cor another near at brs at 47 E
con hill for cor brs at 81 1/2 W
high P eagle m brs at 78 1/2 W
East to the mountains about 2 miles
Porphyry mounds range about 2
miles South course E x W
March 10th Camp on El Paso
road . . . March 11th Fort Davis
March 12th Fort Davis March 13th
Camp on Lempia March 14th Camp
near seven Springs March 15th

March 15th - By at a rock mt
 S E of Soldiers Camp on Seven
 Springs fw. a rock in the ground
 with no rock on its top brs S⁵⁹ E W
 20 another do brs East 15th

210 Thence East at 1350th cross branch
 1900th to a r mt made on South side
 of a high hill fw. a rock in the ground
 with small rock on its top brs
 at 23¹/₄ W 4¹/₂th another rock
 in the ground with small rock
 on its top + mk^o x brs S⁸⁸ W 3th
 fw. high P brs S⁵⁴ 1/2 W

211 Thence East at 430th cross creek
 at 1900th r mt fw. an Oak mt^o
 x brs S⁷⁰ E 124th another do 8 do
 brs S⁵⁹ 1/2 E 119th a large
 rock mt^o x with small rock
 on its top brs S⁵⁴ E 118th
 high P brs S⁵⁷ W
 Little P South end of mesa brs
 S⁸² 1/4 W (East crossing branch
 at 350th)

Thence S⁴⁵ E 1400th 989th S x 989th E

212 Thence West 989th to r mt
 north about 200th

213 Thence South at 1010th deep

ravin at 1200^{ft} Little P on me
 br S 89 W high P br S 62 W
 1900^{ft} to r md on W side of
 mountain range fr. a rock
 mt. 5' x with small rock on its
 top br S 12 E - 9^{ft} another
 do br South 6^{ft}

214 Thence West at 360^{ft} cross a
 large creek branch of E fork
 of Togah Creek at 850^{ft} cross
 road to Victoria 1900^{ft} it r md
 March 16th

Big at cor of 190 on
 Perdita Creek

215 Thence S 45 W - 2688^{ft} r md
 on E side of hill and S bound
 ary line of reservation (West
 at 750^{ft} cross Perdita

March 19th Big at cor of 188
 216 on Perdita Creek Thence West
 at r cross m Creek 1900^{ft}
 to a r md in prairie

217 Thence West 1900^{ft} to a r md
 made on S bank of Middlefork
 of Togah Creek fr. an oak
 8 in dia br S 8 W 195^{ft} Black
 Walnut 5 in dia br S 80 E W 45^{ft}

- 218 Thence S 45 W at 400' enters
Creek at 800' cross Main Creek
below junction of a spring branch
2688' to a rock mt made in
bed of Creek fw. an oak 6 brs
At 30 E 52' 4 brs S 22' 4 E 17'
- 219 Thence West 1900' to a r mt
March 18th
Buy at cor No 217 on S bank
of middle brook
- 220 Thence North crossing
creek 1900' to a earth mt
fw. white bank brs at 4' 4 E
Thence S 45 W at 1000' pass a
high - 2688' r mt fw. high
221 mountain brs S 75' 2 W
White bank brs S 79 E
- 222 Thence East 1900' to r mt
made on large prairie
March 19 Buy at cor
No 213 E fork of Toghah
- 223 Thence S 45 E at 1400' at bank
of Creek crossing it at 1600'
pass a high bluff 2688' r mt
in Lempsio valley fw a rocky
in the ground mt 5' x brs S 45 W
2' 6' of another do mt 5' x brs

S 41 1/2 W 3⁵ high table mountains
brs S 53 W

224. Thence S 45 E at 1600⁵ cross
a branch 2688⁵ r md
made in a large prairie about
1 mile north of Lumpio Brick
fw high table mountains brs
S 74 W

225. Thence East 1900⁵ to a r md
made in a dog team fw a rock
mkt x with small rocks on
its top brs N 88 1/2 W 100⁵

226. Thence East at 1160⁵ cross a
cut runs South 1900⁵ to a r md
made in a large prairie
March 20th

Continuing

227. Thence East at 800⁵ foot of
mountain at 1900⁵ r md made
on N side of high mountain
fw an Oak 14 brs S 18 1/4 W
94⁵ do 8 brs S 77 E - 87⁵

228. Thence East at 1310⁵ cross
spring branch runs South
1900⁵ to a Cedar mkt x 20 in
fw a Cedar 8 ft 52 W 9 1/2⁵
a fork⁵ Cedar 30 ft brs S 60 E 15⁵

229 Thruce East at 640° top of
 a high mountain 1900 \pm
 to a large rock m^t. x with
 small rock on its top on
 S side of mountain f. cornd
 fr. a Cedar 5 in dia brs $S 42^{\circ} E$
 41°

230 Thruce East at 450° at mid
 on W bank of branch fr.
 an Oak 10 brs $N 70^{\circ} E$ 6°
 dr 8 brs South 7° crossing
 branch 1900 \pm to a stake sm^d
 on the mesa out about north
 of Borrilla spring
 March 21 to Camp on road
 fr. high Table mountain
 brs $S 85^{\circ} W$ Gomez Peak
 brs $N 71^{\circ} \frac{3}{4} W$

March 22 to Camp on
 Leon Spring.

March 23 on road east of Stockton

" 24 to Camp Estovado

" 25 to camp on Ditch

" 26 to camp on road 7 mi
 east at Bee Station

" 27 Camp on Spring

" 28 Camp on road

" 29 to camp of middle
 Boncho

March 30 camp au Concho
" 31 camp on rocky Creek
Apr 1st camp on rocky

