

OFFICE OF
William H. Leekie
Land Surveyor

*Respectfully referred to
you for Robison's Bonus
for attention & to be
filed with Maria Co.
Sketches
July 3/1912
E. von Rosenberg*

91

Runge, Texas, Feb. 1st, 1912.

RECEIVED

FEB 3 1912

Referred to Map

Mr Ernst von Rosenberg

Gen. Land Office

Austin, Texas.

Dear Sir:-

Pardon delay in carrying out my promise to send you a sketch, showing actual conditions of surveys around Pine Bayou, in Marion County; but pressure of business has kept me on the move since I saw you. Herewith I enclose a hastily constructed plat, but which outlines correctly a part of my work in that county in 1870. All the distances given are as actually measured; and Pine Bayou is sketched in from close readers, except from the N. Williams N.E. cor. up to the N.E. cor. of the largest W. Meyer tract.

I trust this will come to hand in time to meet your purposes. If you can take a copy of this plat, and return me the original, or send me the copy, or a blue print, it will be appreciated as I have retained no copy.

Very truly yours

W. H. Leekie

*W. H. Leekie
Gen. Land Office
Austin, Texas
Filed 2/3/12*

Wg

Office of
William F. ...
Land ...

Handwritten notes and signatures in the top right corner, including a signature that appears to be 'W. F. ...' and some illegible text.

Runge, Texas. Feb. 1st, 1913.

RECEIVED
Feb 8 1913
Returned to Map

Mr. ...

Gen. Land Office

Austin, Texas.

Faint, mostly illegible typed text, likely the body of a letter or report.

Marion Co.
Sketch file ¹³
N. E. portion of
County.
Filed 2/3/12.

WY'

counter 30584

SKETCH OF CERTAIN SURVEYS
 IN
MARION COUNTY,
TEXAS.

According to a survey made by
 W. H. LECKIE, From April to August, 1910.

Scale - 1 Inch to 1000 Varas.

Note - Given distances are actual measurements from identified corners, with 40-Vara steel tape.
 At Original Corners one or more original bearing trees were found.
 "Old Corners" are old 70-marked Corners.
 Small numerals at Mile Mounds on State Line indicate distance from last identified Mile Mound running north.

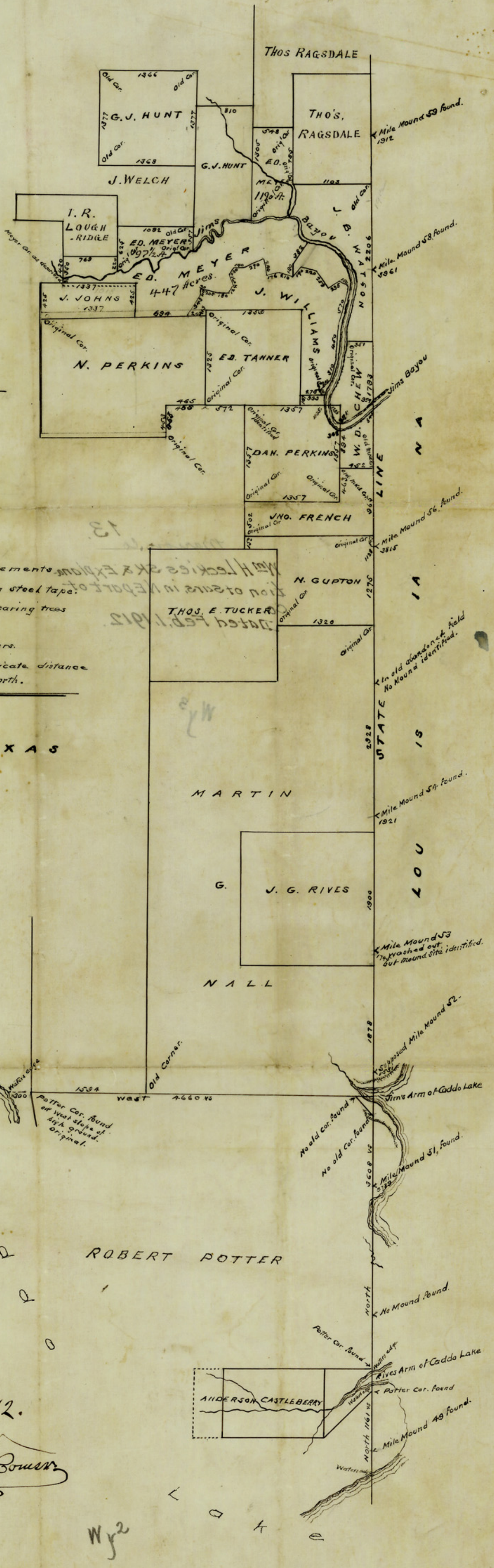

Filed, February 3rd 1912.
 J. H. Wacker
 Chief Clerk Acting County