

Martin sk. file 3

W. D. TWICHELL,  
SURVEYOR,

Texas Land Boundaries a Specialty.

431.

Litwalton  
Amarillo, Texas,

July 1<sup>st</sup> 1906

Hon John J. Terrell,  
Austin, Tx.

Dear Sir;

Carrying out your instructions that I submit a preliminary survey, setting out the facts on the ground, upon which to base final instructions to survey School Trayers 245<sup>to</sup> 281 in Dawson County I have gone to the SW corner of Trayer <sup>as corrected</sup> 285<sup>1</sup> and extended a line N 75° 49' E 20,000 varas thence S 14° 11' E at 5000 varas fall in SE edge of lake basin at 25000 varas at ~~21600~~ <sup>21570</sup> varas natural tank in basin is 100 varas to E of line at 25000 varas find monument bearing N 89 1/4° E 7500 in hard flat, and in fair state of preservation at 30,000 point on N side of flat draw and 83 varas N of center of draw at 35,000 a point - thence S 75° 49' W 10,000 ms to point on slope to Concho draw, thence S 14° 11' E at 1200 to 2500 line follows Concho draw (if placed 500 varas west will leave draw at 2200 and be in center of draw at 1200) at 10,000 varas find monument in fair preservation bearing S 75° 49' E <sup>280</sup> 1500 ms & S 14° 11' E 12 ms - thence East N 75° 49' E 15-123 ms th N 14° 11' W 10 ms to East Mt in fair state of preservation. Every one in party and myself were convinced that none of the 3 monuments above referred to could have been made by redstarts, the trace of trench is complete and there is no

counter 30632

Martin sk. file 3  
W. D. TWICHELL,  
SURVEYOR,

Texas Land Boundaries a Specialty.

Amarillo, Texas,

subsoil in the mounds and no trace of a hole in the mound. Putting  
the natural objects as they do it seems certain that these three are  
original courses.

I then went to the T & P center line and began at the SW corner 46  
Blk 37 T 1 N, an old pile of stones ~~was~~ at East of Mustang draw, with very  
old cedar stakes in and marked with scrub but not legible. Thence  
N  $74^{\circ} 33'$  E making all miles 1920 varas. at 3 miles pt. Th  $N 15^{\circ} 27' W$   
16 miles - (1920 each) thence  $N 43^{\circ} 21' 20'' = N 58^{\circ} 48' W$  299 to monument  
found at SE corner 245. I could not identify the rock mounds called  
for on the east side of Block 37. Nor the one called for at Soda Spring  
at SW 29 Blk 35 T 3 N. The P. of stone at Soda Spring seems to have been  
placed too far west and the pile of stone on E line of Blk 37 seem to be  
too far east. From the above you will see that a conflict will  
result between Block 36 and the layers and a slight vacancy will  
occur South of the layers - the 20 varas I added coming North will  
about distribute excess from the center line to Tobacco Ck course  
connected to where I located Block 8 for the State.  
While surveying for Mr. J. B. Slaughter I found the course of T & P

counter 30633

Martin sk. file 3

W. D. TWICHELL,  
SURVEYOR,

Texas Land Boundaries a Specialty.

Amarillo, Texas, <sup>mslk39</sup>

original corners as  $N 15^{\circ} 37' W$  - While surveying for  
the state I found a right-angle from center line at  
SW Block 42 is  $N 15^{\circ} 7' W$ . If meridians were parallel  
these lines would converge and when meridian convergence  
is added for 40 miles a considerable shortage will result -  
cutting down the apparent vacancy west of the county  
lines and causing a conflict on the east of the line  
if natural objects control the position of the line.  
If natural objects do not control the position of the line  
then course and distance from T & P corners will cause  
the line to conflict with line now connected to  
fit the well identified corner at NW 254. Mr. Godwin will  
be glad to know how the shortage in these lines is made  
good and show the land is selected. Please send full  
instructions for this work as early as convenient. I hope to  
finish it while I am here.

counter 30639

Yours respectfully,  
W. D. Twichell State sur.

I, W.D. Twichell, State Surveyor, do hereby certify  
that this map is true and correct.

*W.D. Twichell*  
State Surveyor

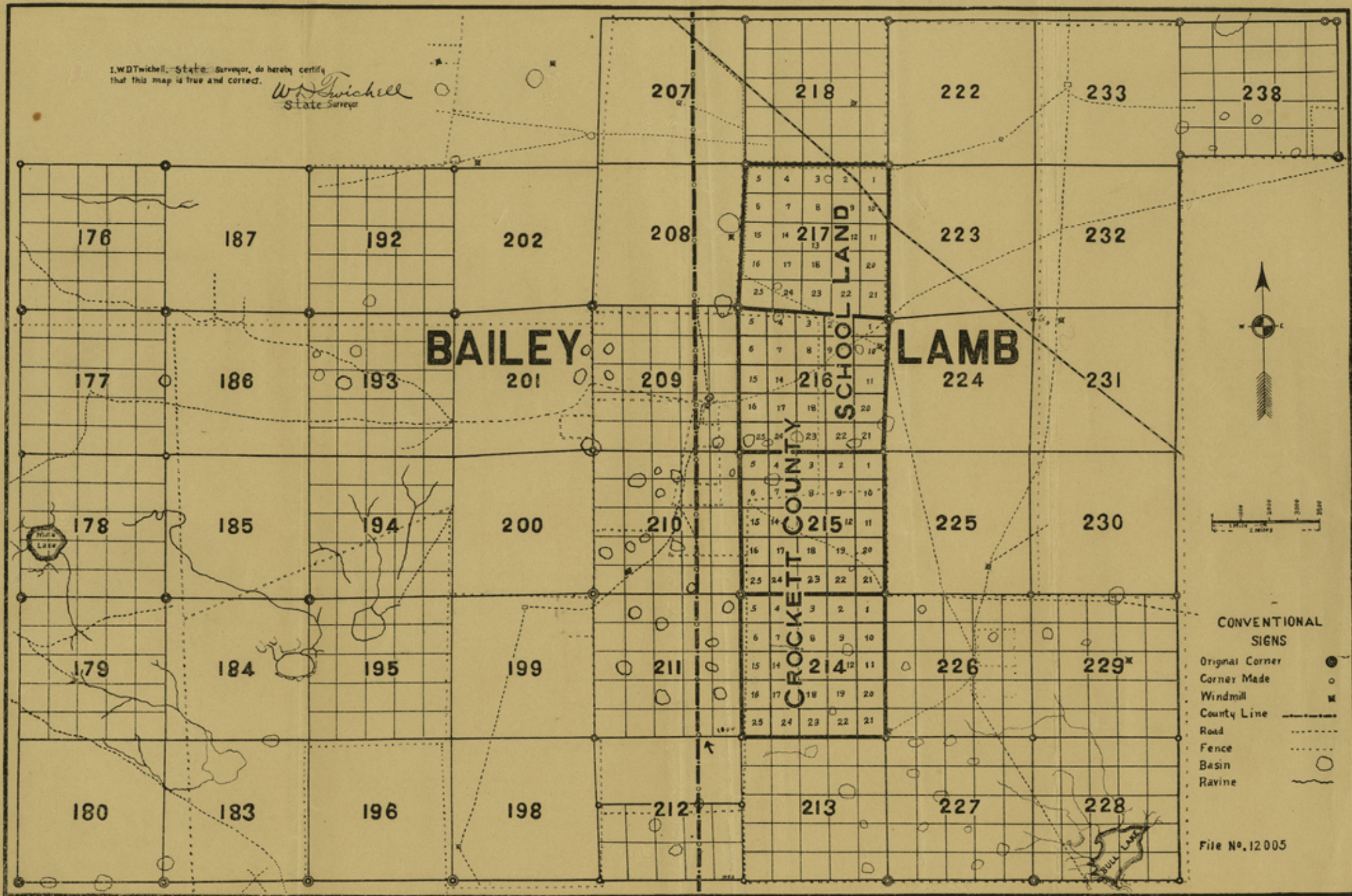

CONVENTIONAL  
SIGNS

- Original Corner ●
- Corner Made ○
- Windmill ⌘
- County Line ———
- Road - - - - -
- Fence ·····
- Basin ○
- Ravine ~~~~~

File No. 12 005

counter 306 35

# SCHOOL LEAGUES

and  
ADJACENT LANDS

Situated in  
MARTIN AND DAWSON COUNTIES  
TEXAS

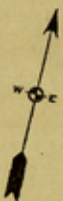

ANDERSON WELLS CORNER 284

284

285

281

286

280

279

278

277

287

273

274

276

288

272

271

270

269

289

265

266

267

268

290

264

263

262

261

291

257

258

259

260

292

256

255

254

253

293

249

250

251

252

294

248

247

246

245

295

318

319

320

321

296

319

320

321

322

BLOCK A 19

0  
1  
2  
3  
4  
5  
6  
7  
8  
9  
10  
11  
12  
13  
14  
15  
16  
17  
18  
19  
20

PARMER COUNTY

GARZA COUNTY

LA SALLE COUNTY

SCHOOL LAND

G & M & MB & A BLOCK 38

KENT COUNTY

SCHOOL LAND

BRISCOE COUNTY

SCHOOL LAND

HARTLEY COUNTY

SCHOOL LAND

WHEELER COUNTY

SCHOOL LAND

LA SALLE COUNTY

SCHOOL LAND

JESSE F. CROSS

TEXAS

TEXAS

LOVING COUNTY

SCHOOL LAND

BORDEN COUNTY

SCHOOL LAND

WARD COUNTY

SCHOOL LAND

WHEELER COUNTY

SCHOOL LAND

MARTIN COUNTY

SCHOOL LAND

WHEELER COUNTY

SCHOOL LAND

WHEELER COUNTY

GLASSCOCK COUNTY

SCHOOL LAND

BORDEN COUNTY

SCHOOL LAND

WARD COUNTY

SCHOOL LAND

WHEELER COUNTY

SCHOOL LAND

MARTIN COUNTY

SCHOOL LAND

WHEELER COUNTY

SCHOOL LAND

WHEELER COUNTY

GLASSCOCK COUNTY

SCHOOL LAND

BORDEN COUNTY

SCHOOL LAND

WARD COUNTY

SCHOOL LAND

WHEELER COUNTY

SCHOOL LAND

MARTIN COUNTY

SCHOOL LAND

WHEELER COUNTY

SCHOOL LAND

WHEELER COUNTY

TOWNSHIP 5 NORTH

0  
1  
2  
3  
4  
5  
6  
7  
8  
9  
10  
11  
12  
13  
14  
15  
16  
17  
18  
19  
20

TOWNSHIP 4 NORTH

0  
1  
2  
3  
4  
5  
6  
7  
8  
9  
10  
11  
12  
13  
14  
15  
16  
17  
18  
19  
20

TOWNSHIP 2 NORTH

0  
1  
2  
3  
4  
5  
6  
7  
8  
9  
10  
11  
12  
13  
14  
15  
16  
17  
18  
19  
20

TOWNSHIP 2 NORTH

0  
1  
2  
3  
4  
5  
6  
7  
8  
9  
10  
11  
12  
13  
14  
15  
16  
17  
18  
19  
20

TOWNSHIP 2 NORTH

0  
1  
2  
3  
4  
5  
6  
7  
8  
9  
10  
11  
12  
13  
14  
15  
16  
17  
18  
19  
20

TOWNSHIP 2 NORTH

0  
1  
2  
3  
4  
5  
6  
7  
8  
9  
10  
11  
12  
13  
14  
15  
16  
17  
18  
19  
20

TOWNSHIP 2 NORTH

- CONVENTIONAL SIGNS
- Original Corner
  - State Surveyor Corner
  - Corner Mark
  - Fence
  - Road
  - Stream
  - County Line

W.D. Churchill, Surveyor

# SCHOOL LEAGUES

and  
ADJACENT LANDS

Situated in  
MARTIN AND DAWSON COUNTIES  
TEXAS

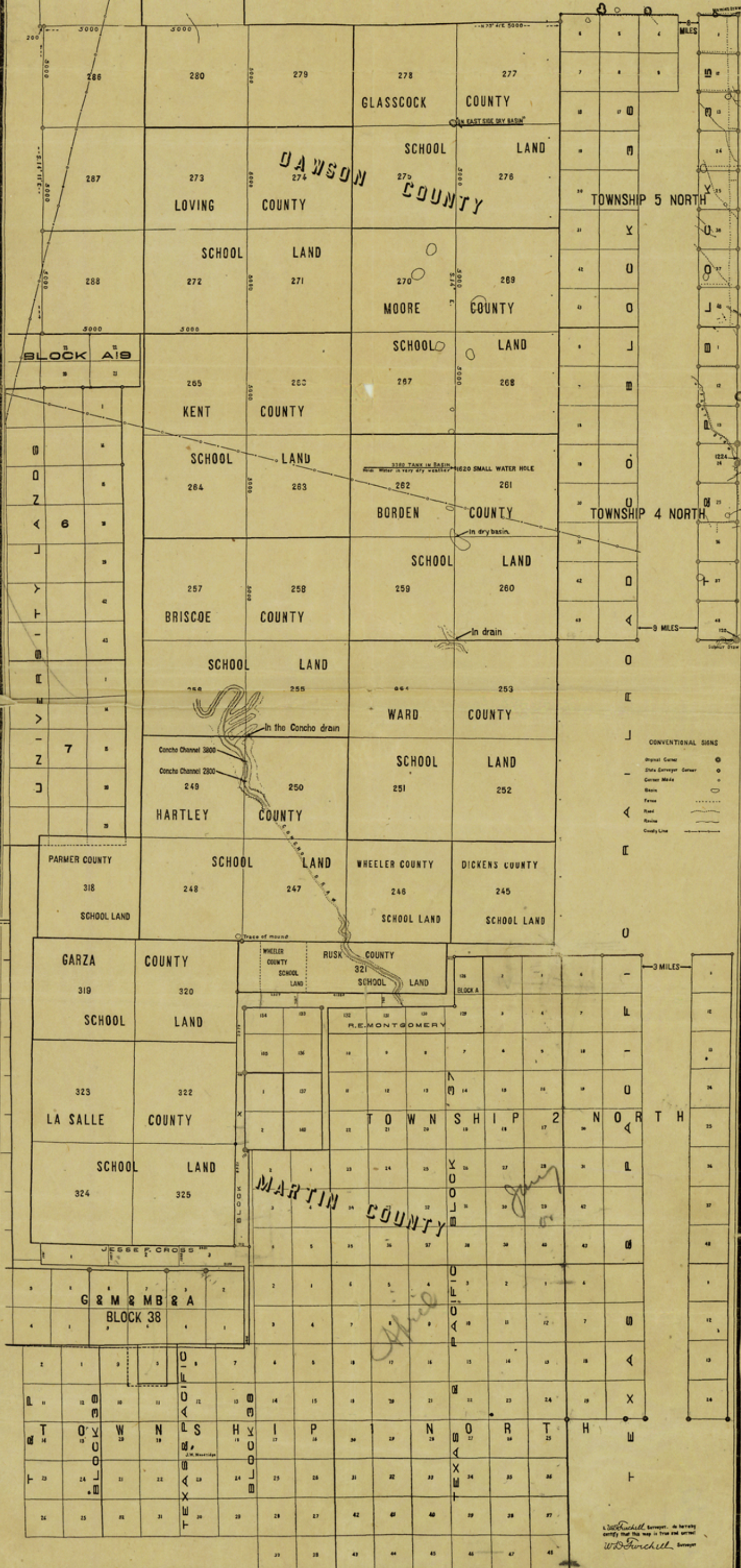
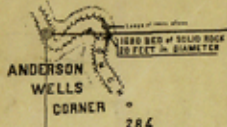

- CONVENTIONAL SIGNS
- Original Corner
  - State Surveyor's Corner
  - Corner Mark
  - Stream
  - Fence
  - Road
  - Railroad
  - County Line

L. W. Russell, Surveyor, in hereby certify that this map is true and correct.  
W.D. Funchell, Surveyor

Counter 30637

# SCHOOL LEAGUES

and  
ADJACENT LANDS

Situated in  
MARTIN AND DAWSON COUNTIES  
TEXAS

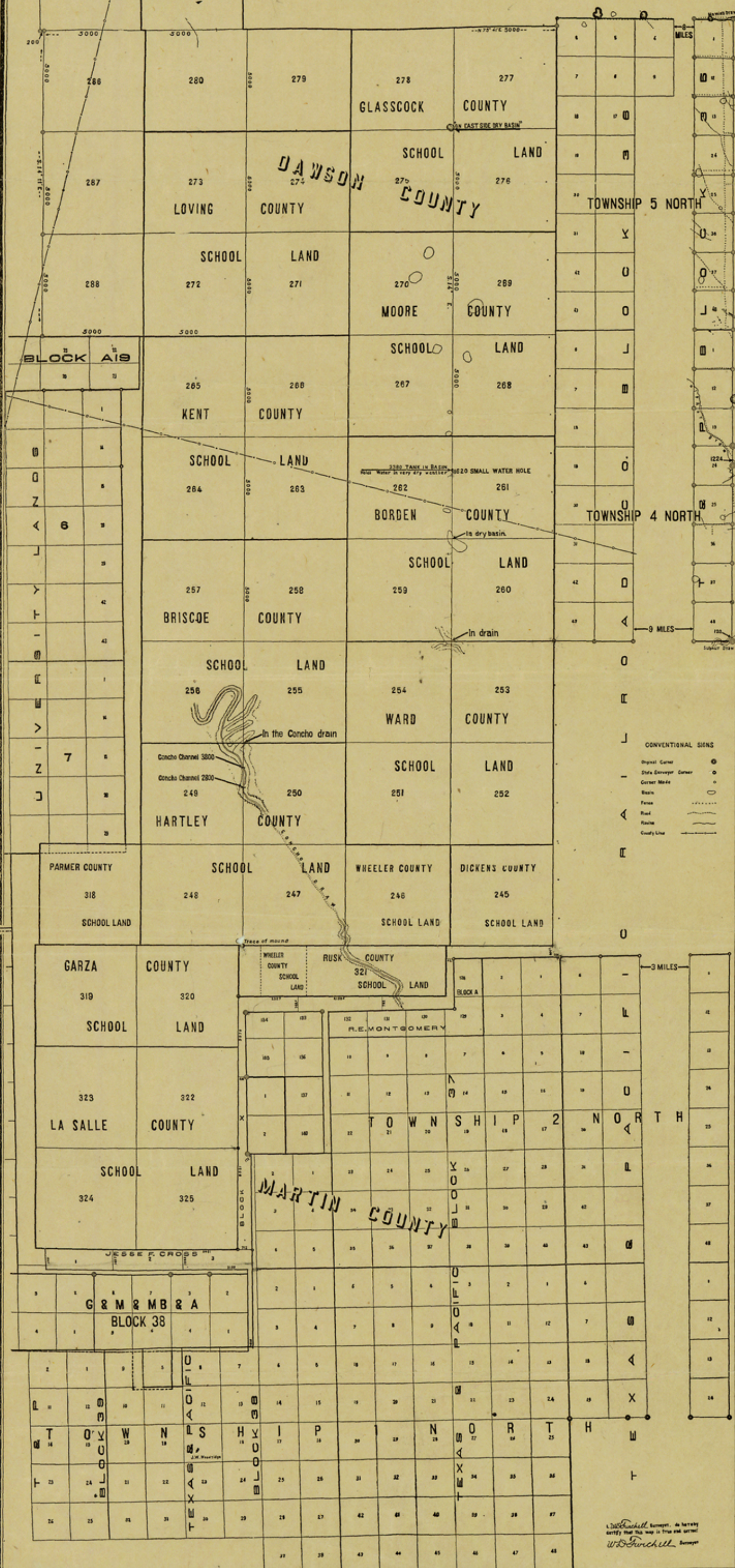
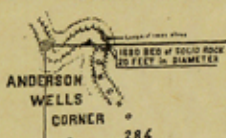

- CONVENTIONAL SIGNS
- Original Corner
  - State Surveyor's Corner
  - Corner Made
  - Basin
  - Fence
  - Road
  - Stream
  - County Line

L. W. Fitchell, Surveyor, do hereby certify that this map is true and correct.  
W. D. Fitchell, Surveyor

3.

*Twichell's Litho Sketches.*

*Martin Co*

counter 30639