

File 2.

Maverick Co.

Oct. 28/75.

Sketch of Block 7, between
Elm & Sans Creeks.
Dated Oct. 26, 1875.
Filed Oct. 28, 1875.

[Handwritten signatures and notes]
John C. ...
...



County 30131

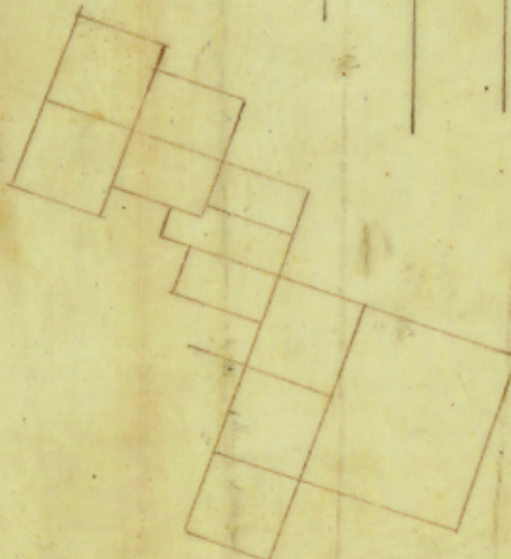

County 30131

File 2
 March 1876
 Oct 28/76

Sketch of Block No. 7
 No. 1000 of
 Elms & Gans Creeks
 Dated Oct. 28, 1876
 Filed Oct. 28, 1876

Filed October 26 1876

J. W. [Signature]

W. H. [Signature]

