

Connections given to explain accompanying sketch as run by myself.

(1) Beg. at a post 4m<sup>d</sup> in  $\odot$  for wh a mesgt 12" br S 75 W 90 $\frac{1}{2}$ ° do p<sup>d</sup> 11" N 62 E 67 $\frac{1}{2}$ ° being the S.W. cor no 39. Blk 11.

Thence East at 780<sup>vs</sup> xed branch 1600 v. pass 4<sup>vs</sup> M. of Penika creek 2000  
varas to a st 4m<sup>d</sup> in  $\odot$  for wh a mesgt 11" br S 30 $\frac{1}{2}$  E 88 $\frac{1}{2}$ ° do 13" S 72 W 87 $\frac{1}{2}$ °

Thence N. at 1930 v. br. 2800<sup>v</sup>. pt. E. 125 $\frac{1}{2}$ ° & N-127 $\frac{1}{2}$ ° to a st 4m<sup>d</sup> in  $\odot$   
for wh a mesgt 6" S 3 W 20 $\frac{1}{2}$ ° do 9" S 64 E 28 $\frac{1}{2}$ ° Thence East 1030 $\frac{1}{2}$  v. and  
North 300 $\frac{1}{2}$  v. to a st 4m<sup>d</sup> in  $\odot$  for wh a mes 10 ins br S 98 E 27 $\frac{1}{2}$ ° do 10" N 20 E  
17 $\frac{1}{2}$ ° set for NW cor no 613. John Sharp.

again. Beg at a post 4m<sup>d</sup> in circle set by A. Mychetski.

Thence South 1940 $\frac{1}{2}$  v. & West 138 $\frac{1}{2}$  v. to st 4m<sup>d</sup> in circle for wh a  
mesgt 12" br N 65 E 152 $\frac{1}{2}$ ° do 6 ins S 32 $\frac{1}{2}$  W 91 $\frac{1}{2}$ ° Thence S. 1900 $\frac{1}{2}$  v.  
set st for wh a mesgt 12 ins br N 9 $\frac{3}{4}$  E 54 $\frac{1}{2}$ ° do 12" N 6 $\frac{1}{2}$  E 52 $\frac{1}{2}$ °

Thence East 873 $\frac{1}{2}$  v. to N E cor No 1. W. W. I. Co. set st for wh a mesgt 7"  
br N 17 E 35 $\frac{1}{2}$ ° Thence S 895 $\frac{1}{2}$  v. to N. line No 613. J. Sharp. a st  
for wh a mesgt 8" br S 16 $\frac{1}{2}$  W 87 $\frac{1}{4}$ °. Thence N 70 E with N line J. Sharp  
No 613. 1151 varas to its N.E. corner. a large post 4m<sup>d</sup> in  $\odot$  for wh a  
mesgt 10 $\frac{1}{2}$ " S 39 E 31 $\frac{1}{2}$ ° do 13 $\frac{1}{2}$ " br S 52 $\frac{1}{2}$  W 22 $\frac{1}{2}$ °

From said N.E. cor. No 613. S 70 W 32 $\frac{1}{2}$ ° set st for wh a mesgt 4"  
br N 25 E 14 $\frac{1}{2}$ ° set for S.E. cor no 99. (made for J. W. Piddle & H. Herz)

Thence again N 70 E from N.E. corner No 613. 2000 $\frac{1}{2}$  v. set for S.W. cor  
no 577. & N E cor no 579. & NW cor no 578. for wh a mesgt 10" br S 44 E 34 $\frac{1}{2}$ °  
a cat's claw 6" N 76 $\frac{1}{2}$  W 28 $\frac{1}{2}$ ° Thence S. 20 E 200 $\frac{1}{2}$  v. & 1 varas 070 W to st  
set for S.W. cor no 21. & 8 E cor no 22. made for Sam white for wh a mesgt  
14" br N 79 $\frac{1}{2}$  W 21 $\frac{1}{2}$ ° do 8" N 79 $\frac{1}{2}$  E 23 $\frac{1}{2}$ ° Thence again N 20 W from  
N.E. cor. 579. as above. (at 1369 v. passed 1 v. east of st for wh a mesgt  
10" br N 35 $\frac{1}{4}$  W 34 $\frac{1}{2}$ ° do 5 ins N 14 E 14 $\frac{2}{3}$ ° N.W. cor No 21. on S. line  
B counter 31102

from said mesqt 194 varas to above point on fence, or 5920°  
E from S.W. cor no 69. B. 6.) Thence East from SW cor no 69  
as above at 5920° N. line no 99. 7660° fence 7800° to 1450  
1580. 1680. 1798, 1844 varas xed Fresno creek. 1900 varas set stake  
fr wh a flk mesqt 12" S 60° E 280°. & an Iron wood cluster of 12. at butt  
16" S 11 E 60°. Thence North at 80° crossed Fresno cr. at 5300° fence  
550 varas cross a north line of no 99. 9700° top of dam of Pauls.  
1900° sh fr wh a mesqt 2 pms 8, 7 & 6 ins in dia br S 28 E 280° set for  
N E cor no 69. B. 6. S E no 67 & W no 68.

Thence N 45 E 2688° to NE cor no 68. 3 pms mesqt 10 in dia MKD #.  
again N 45 E 2688° to S E cor no 39, a stump in branch fr wh  
a stump of mesqt 4 pms 4 ins dia S 40 W 50°  
again N 45 E 2688° to S W cor no 1. B. 6. -

Thence East at 620° xed road 800° x br br N. E. 1900° point. Thence  
S 40 E 160° to N. W. cor no 645. G. W. S. P. R. B. Co fr wh a mesqt of 11  
ins dia br N 5 W 8½° do 5" (coll 7") N 52½ E 90°.

Thence again west from above point N 40 W 160° from NW cor no 645  
as above 440 varas to a stake fr wh a mesqt 14" br N 47 E 2½°  
do 7" S 81 W 17¼°. This being the S E cor no 1. B. 6. (being short  
of 1900 varas. 440 varas. or 8 line is 1460° in length.)

Thence North 1900° to stake <sup>N. E. cor no 1. B. 6.</sup> fr wh a flk mesqt 5 ins br S 45½ W  
80° do 3 pms 7" S 42½ W 14¾°. Thence S 63½ W 175 varas to a stake  
set for SW cor no 595. G. F. Ferry. & S E cor no 596. State. fr wh a mesqt  
12" br S 23 W 200° do down 14" S 18 E 29°.

Thence again Beg at N E cor 569 & S of St. Lane & W B cor no 649.  
G. W. S. P. R. Co. st fr wh a mesq 20" flk S 42½ W 15° do 16" flk S 87 W  
26°. Thence N 20 W at 570° pass NW cor no 555. 2065° to  
a st fr wh a mesqt 9" S 31 W 20° do 6" S 83 W 37°. Thence again

N 20 W <sup>2070 Varas</sup> with W line No 645. to N W cor no 645. a st fr wh a  
mesgt fhd 11 ins W 5 W 8 1/2 E do 5" (call 4) N 5 2 1/2 E 9 1/2. Thence again  
N 20 W 2070 Varas to st fr wh a mesgt 12" S 23 W 20 P. do down  
14" S 18 E 29 P. Thence N 63 1/2 E 175 Varas to N.E. cor no 1. B. 6.  
as above.

I, O. W. Hector, County Surveyor of Maverick County Texas,  
do hereby certify to the above connections, they being true  
copies of notes of work done by myself on the ground.  
Further: I also certify that the accompanying sketch  
marked A. represents the true relative position of  
the surveys designated thereon, and the extent of  
conflict found to exist between surveys. The original  
corners marked o with the corresponding bearings, <sup>being</sup> actually  
found by me on the ground.

Signed this 16<sup>th</sup> day of April 1888.

O. W. Hector.

Co. Sur. Mod. Co.

15-13  
Sketch file 13  
in  
Maverick Co.  
Connection and  
exploration Post  
and J. D. of Hayes & Co.  
by O. W. Hector  
O. W. M. Co.  
Filed April 22<sup>nd</sup> 1888  
Don Robinson  
Chief Clerk

15. 13

Sketch file 13

Maverick Co.

Sketch and explanation  
East and South East of  
Bayle Pass by O. H. Hector  
C. S. M. Co.

See Sketch 15

Filed April 22, 1884

A.

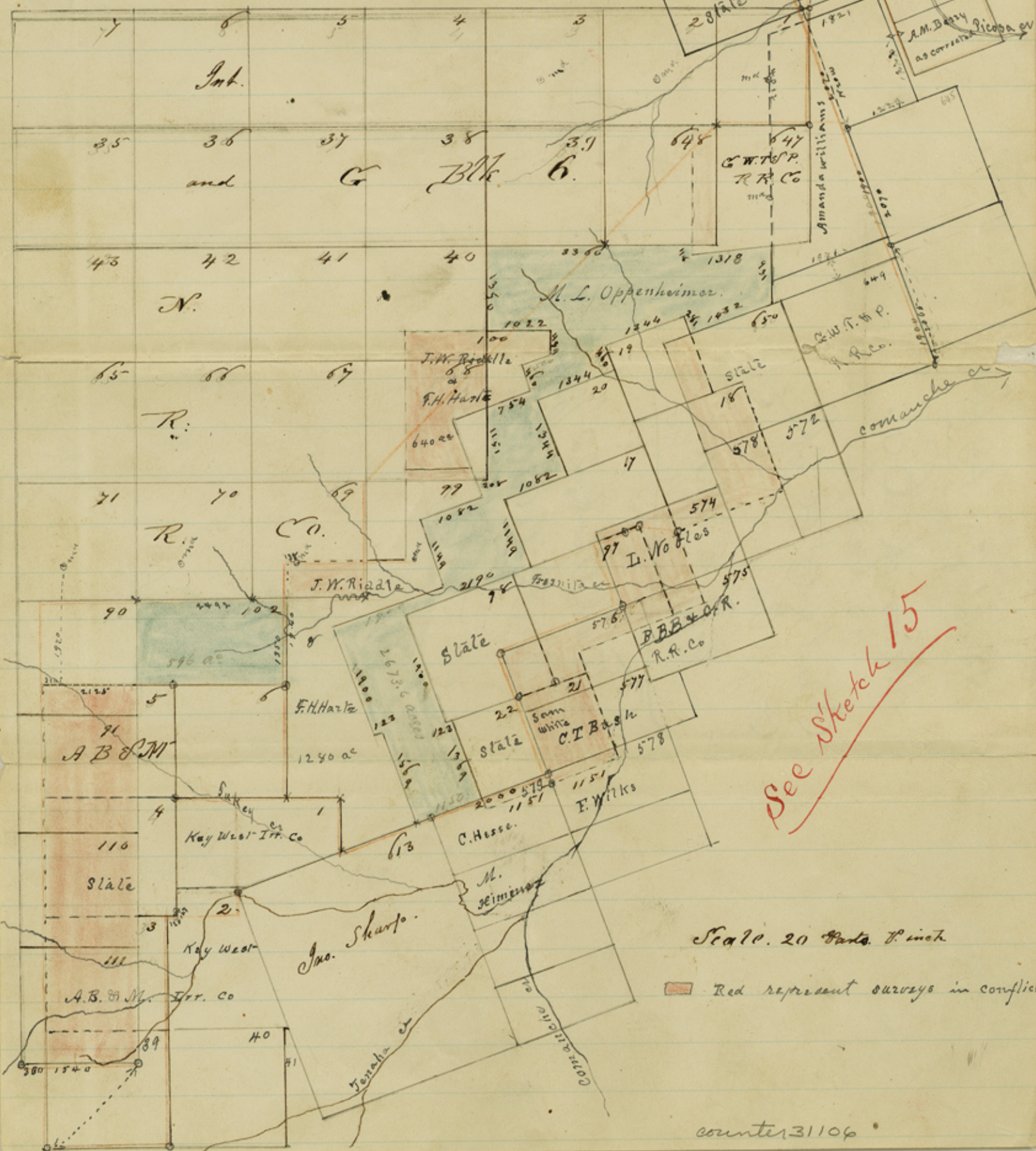

13  
Sketch file 13<sup>15</sup>.  
Maverick Co.  
Sketch  
East & S. E. of  
Eagle Pass.

by O. H. Hector  
C. P. M. Co.

---

Filed April 22<sup>nd</sup> / 84.  
J. K. Robinson  
Chief Clerk

No 98. and distant 870 w 625-3/10 P from its S E cor & S W corner  
No 97. Arnold & Barrett at said corner found a cat claw 5 1/2 ins 87 1/2  
E 34 4/10 P) 2100 Varas to St for N. W cor No 576. A tree fr wh a

mesq 8" br S 64 1/2 E 88 1/2 P. do S 64 E 88 P. bunched down 6 ins above ground.  
Thence N 70 E 2100 P to N E cor No 576 fr wh a mesq 1 1/2 " N 26 W  
20 P. do 9" S 36 1/2 E 13 P. Thence N 20 W 1174 P to N line No 97. and  
N 70 E <sup>at</sup> 426 P to St fr wh a mesq 12" N 42 1/2 W 6 x 10 P. do 12" N 80 1/2 E  
38 1/2 P. 715 P N. E. cor No 97. St fr wh a mesq 8 ins S 83 1/4 W 15 P do  
10" N 16 E. 25 P. Thence N 70 E 526 Varas & S 20 E 289 P to S. W.  
cor No 18. State, a st fr wh a mesq 10" N 83 E 20 1/10 P. do 6" N 80 W 47 1/2 P  
again. Set at S E cor No 111. B. No 6. reset state. fr wh an Iron wood  
& mesq together br N 42 E 21 1/2 P. a cat claw 5" S 35 W 25 P.

Thence West at 240 P x 61 440 P. x 61 440 P. to S. E. & N. E. 1540 Varas  
to west line No 39. B. 11. 1900 P to S. W. cor. No 111. B. 6. fr wh a mesq  
12" 4 pronged N 54 E 21 P. a cat claw 8" S 68 1/2 E 43 1/2 P.

Thence again from above point on W. line No 39. and N line  
No 111. B. 6. North with W. lines of Nos 39. 3. 4 & 5. at 800 P x 61 1900 P  
open prairie 2180 P x cr. 3800 P open prairie 5300 P. xed <sup>to</sup> Turkey creek  
6420 P x Turkey cr. (at 6250 P. intersect with line running west  
from N E cor No 5. A. B. & M. for N W corner of same.) 7600 P to point  
set stake on S. line No 71. B. 6. Thence East 1540 Varas to stake  
set for S E cor No 71 & S W cor No 70. again at 900 P pass North 43 P of  
a mesq in prairie 10 ins dia 1900 P to a st set from which a mesq 10"  
br S 88 1/2 W 64 P. Thence again East 5 Varas cross Presnita creek 7660  
to fence of Hartz <sup>High</sup> ~~High~~ Co. Thence (from a st set for N. E. cor No 6. on  
W. line No 99. fr wh a mesq 12" br N 65 E 152 P. do 6" (now cut down) S 32 1/2 W 91 P)  
North at 794 P. 867 P & 941 P. crossed Presnita cr. 13500 Varas  
to a mesq 4" dia on S line No 69. do 4" br S 15 W 1 P. (Thence East  
B' counter 43000 B)