

N 02 27 1/2

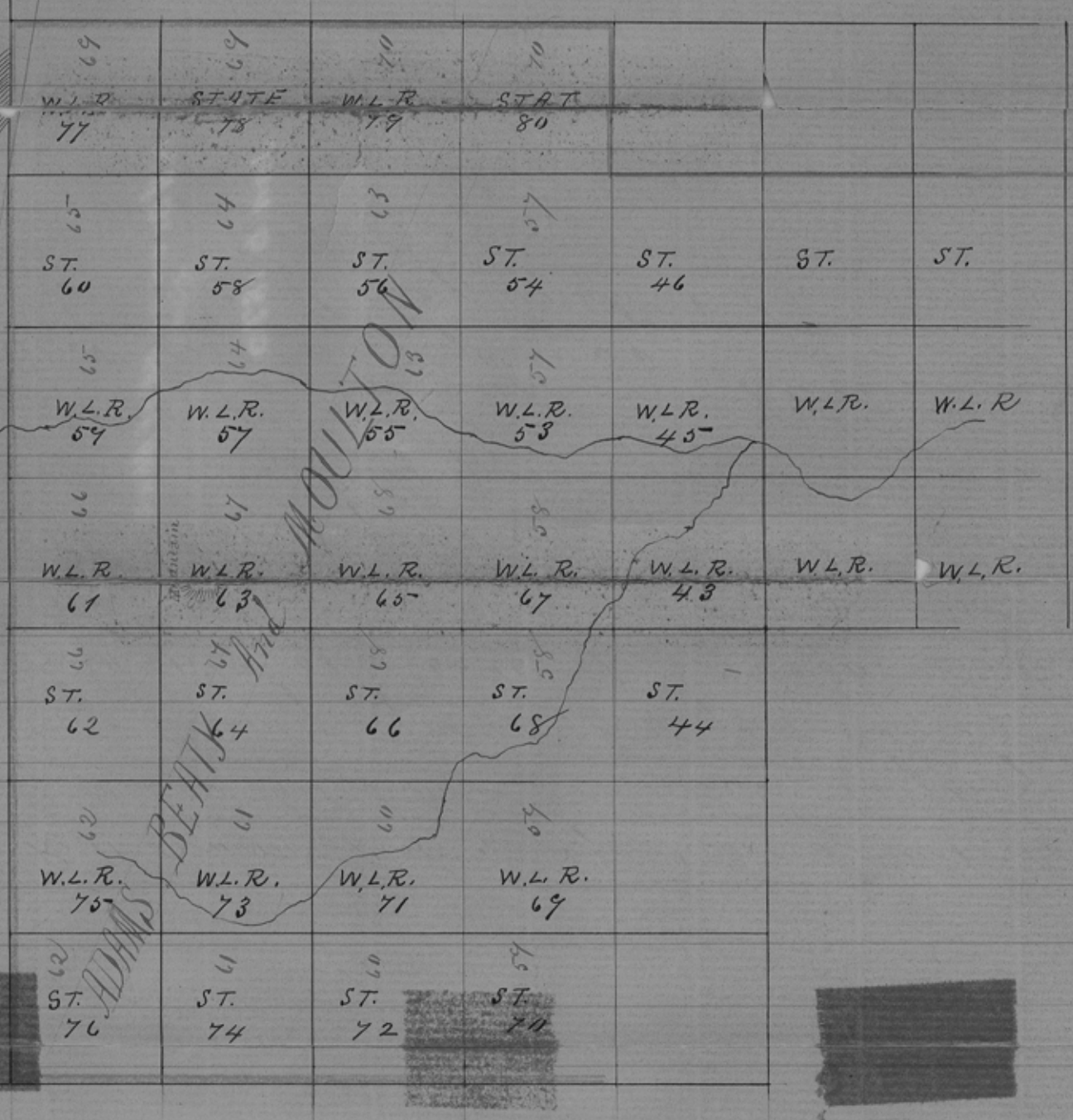

Plat of Surveys for W^m L. Rogers situated
in Mc Mullen County on the head waters of
Ligarto Creek.

Scale 2000 Tr^s per Inch
Variation N 9° East



South Boundary of Mc Mullen County

I R. H. Brown Dist. Surveyor Live Oak Dist. do
hereby certify that I have examined the foregoing
Plat of Surveys for W^m L. Rogers Nos^s 55. 56. 57
58. 59. 60. 61. 62. 63. 64. 65. 66. 77. 78. 79 & 80 made by
Vilas of Adams, Bealy & Moulton S^s Nos^s 63 to 77
inclusive and find same correct in accord
ance with the Field Notes of same, and that
this Plat is recorded in my office in Book
L. S. No^o one on page 335

Given under my hand at Oakville the 6th day
of January A. D. 1876

R. H. Brown

File 9, 9
McMullen Co.

RH Bronns Sk of AB & M.
Surv.

Jan. 6. 1876.

Filed January 25/76
J. W. Cook

County 31352