

Commenced by J. S. B. 1/2/54

Plot of surveys on Black Co.
 Scale 4000 ft = 1/2 inch.
 J. S. B.
 J. S. B.
 J. S. B.

I do hereby certify that the Plot of Surveys
 represented by this Sketch is correct and that
 they were made by me in the month of
 April A. D. 1854.

8412 returned

Received Oct. 3/54

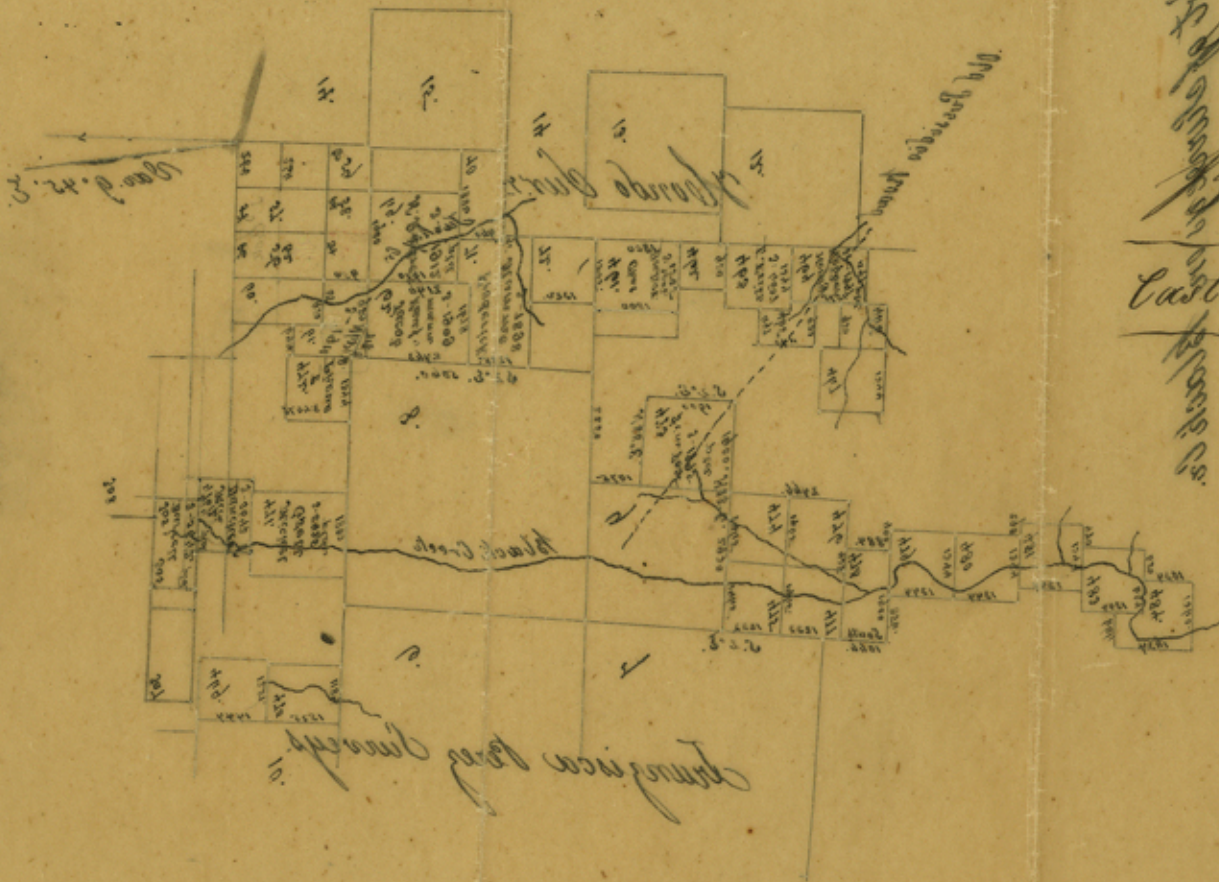

Plot
of
Black Creek.
Castro's Colony.

Planned by
J. M. Castro

Planned by J. M. Castro
This map was made for me on the 10th of Oct
1854 and is correct and true
I have signed and sealed the same
J. M. Castro

Counter 3144A

J. M. Castro

counter 31448

File # ~~3~~ 4

Medina County
In Black & Hand Cr.

Recd Octob. 3rd 1854.

S 35° W of Castrovilla

Counter 31449