

195	Petty D. 780	R.R. Co. S. 17528	39	42	55	58	1	Beauty Seale & Forwood	3.3106	H. F. Fisher	3.3106	3-30
21	107	Indiana R.R. Co. S. 9273	S. 2368	E. A. Mc Carthy F. 6515	S. 2376	E. A. Mc Carthy F. 6524	G. C. & S. F. R.R. Co. S. 31788	1436	2083 Valentine Hohmann 3.3106	& B. Miller 3.1951	C. C. 2078	F. 45048
6	106	6. C. & S. F. R.R. Co. S. 30015	38	43	54	59	70	Alexander Crain, Harris & Brooks	2870	John Gibbons S. 17816	John W. Dancy 2-310	2057 Harney Lien 3.3094
3	108	C. H. Hearre F. 4847	F. 9983	S. 2370	F. 6527	S. 2378	F. 13221	131	2871	2871	2089	2090
20	21	28	29	36	45	52	61	68	73	74	75	76
19	22	27	30	35	46	51	62	67	74	75	76	77
18	23	26	31	34	47	50	63	66	75	76	77	78
17	24	25	32	33	48	49	64	65	76	77	78	79
16	17	18	19	20	21	22	23	24	25	26	27	28
15	16	17	18	19	20	21	22	23	24	25	26	27
14	15	16	17	18	19	20	21	22	23	24	25	26
13	14	15	16	17	18	19	20	21	22	23	24	25
12	13	14	15	16	17	18	19	20	21	22	23	24
11	12	13	14	15	16	17	18	19	20	21	22	23
10	11	12	13	14	15	16	17	18	19	20	21	22
9	10	11	12	13	14	15	16	17	18	19	20	21
8	9	10	11	12	13	14	15	16	17	18	19	20
7	8	9	10	11	12	13	14	15	16	17	18	19
6	7	8	9	10	11	12	13	14	15	16	17	18
5	6	7	8	9	10	11	12	13	14	15	16	17
4	5	6	7	8	9	10	11	12	13	14	15	16
3	4	5	6	7	8	9	10	11	12	13	14	15
2	3	4	5	6	7	8	9	10	11	12	13	14
1	2	3	4	5	6	7	8	9	10	11	12	13

**CONCHO Co.**

**Central Railway Co.**

**Menard Co.**

Scale 2000 varas to the Inch.

"Note"  
 Surveys no. 59, 60, 61, 62, 111, 112, 112, 143, 144, 145 & 146 and other surveys south and east of the above as indicated in block broken lines with solid red border are represented hereon according to a certified plat by Arthur Striegler Co. Surveyor Menard County filed in this office Sept. 29/1892, thereby creating a conflict on its north with surveys in Combs County from the records of said Mr. Striegler's construction to be correct.  
 July 22<sup>nd</sup> 1914  
 O. von Rosenberg  
 Chief Draftsman

Genl. Land Office  
 Austin Texas.  
 Dec. 10<sup>th</sup> 1913.

Fee \$1.00  
 copy of this mailed to  
 West Texas Land Co.  
 1-23-1914 Rosenberg

counter 31551

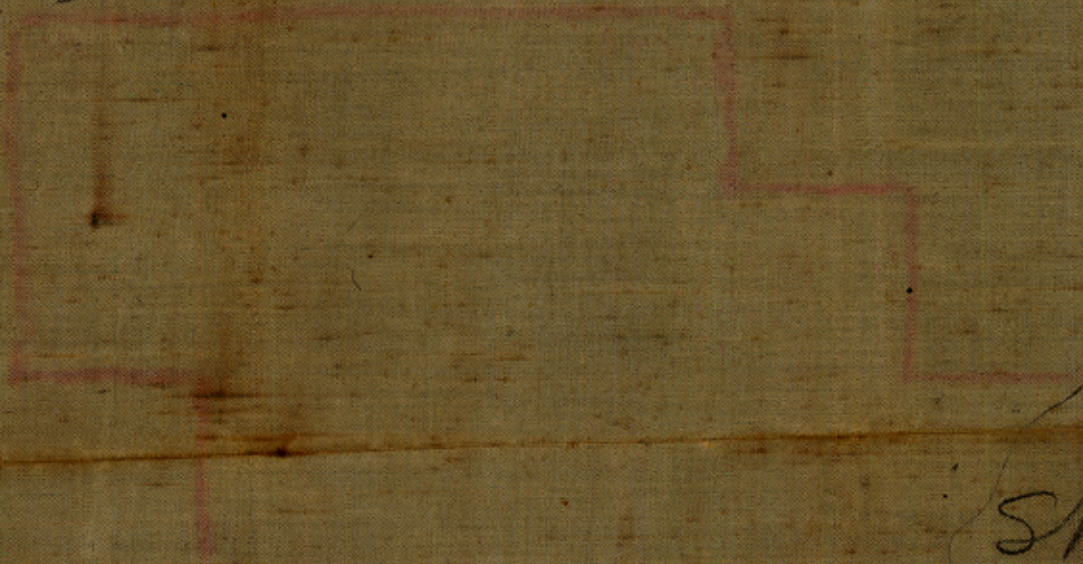

SK "A"

Part of SK A

Sketch File No. 21

Part of SKA

Menard County

Evon R. office SK on line of  
Menard and Canche Cos.

Dated Dec. 10, 1913.

Filed ..... 1913

J. H. Walker, Commr

File Clerk

Descriptive: .....

.....

.....

1414

County 31552