

Sketch File B2

Sketch File "BR"

Country Line

Black J. B.

G. B. & C. N. G.

R. R. Co.

and

Black H.

D. H. Jones

L. H. Seay
Surveyor

counter 31970

MATADOR, TEXAS

1893

The State of Texas }
County of Motley }

Field notes of connecting line run in Block J. B.
1. & C. N. G. R. R. Co. & D. H. Jones Block 1,
in line at the N. E. corner of and vs 1 A. B. & M.
2. Block J. Cert. No. 267 this point is the Beginning corner
3. of Survey No. 1 Block J. B. according to records in surveyors
4. office of Motley County and is identified as per records
5. of above named survey No. 1 A. B. & M. (see report and plat
6. returned of connecting lines in F. & P. Blocks. 3. & 4 B. S. & F. Blk.
7. F. bearing dates May 7th to May 19th 1900 in Chain and
8. recorded in Surveyors office in Homestead record Vol. 1.
9. "Pages 320. to 328")

10. Thence East 1900 vs. a point at 3800 vs. a point 5700 vs. a
11. point at 7600 vs. a point at 9500 vs. a point at 11400 vs. a
12. point at 13300 vs. a point and at 15200 vs. a stone mound
13. on the west line of survey ^{No.} 3 D. H. Jones Block H.
14. see corrected field notes of survey No. 3 Block H. D. H. Jones By A. D. Kerr
15. dated June 23rd 1884 this point we identify as follows
16. Beginning at a stake the N. W. cor. of sur. No. 1 Block H. from which
17. the breaks of Red Bluff vs. N. 37 W. top of Tree vs.
18. Thence N. 11.40 vs. a point 300 vs. East of ravine Thence N. 12.50 vs.
19. Thence N. 90 ^W Rock mound on edge of Red hills identified as the N. W.
20. corner of sur. No. 3 D. H. Jones

Thence South at 1250 varas a point where a measure
on top of Hill vs. E. 112 vs. at 1426 vs. found old
stone mound end of line brought down from ~~west~~ the
N. E. corner of Survey No. 1 A. B. & M.

I T. H. Seay County Surveyor of Motley County do hereby
certify that the foregoing lines was run by me on the
ground and that all the line corner marks natural and
artificial are truly described and set forth in
the foregoing plat and field notes

This survey was made May 20th to 22nd 1900

with Cliff Rogers and Frank O'Carroll as Chain carriers

T. H. Seay County Surveyor
Motley County Texas

The foregoing field notes is recorded in my office in
Book 1 Page 329 Homestead field note record
of Motley County Texas

Given under my hand at Matador this 4th day
of June 1900

T. H. Seay County Surveyor
Motley County Texas

"2B"

"2B"

Filed in Grant D.O. 6/7/1900
Block 2B
G.C. Brog. + Geo. N. G. R.

23

24

Large Coak tree near
mouth of creek S. 62 E.
S 10 W.

A. R. ...
N. 88 W. ...
N. 82 E. ...

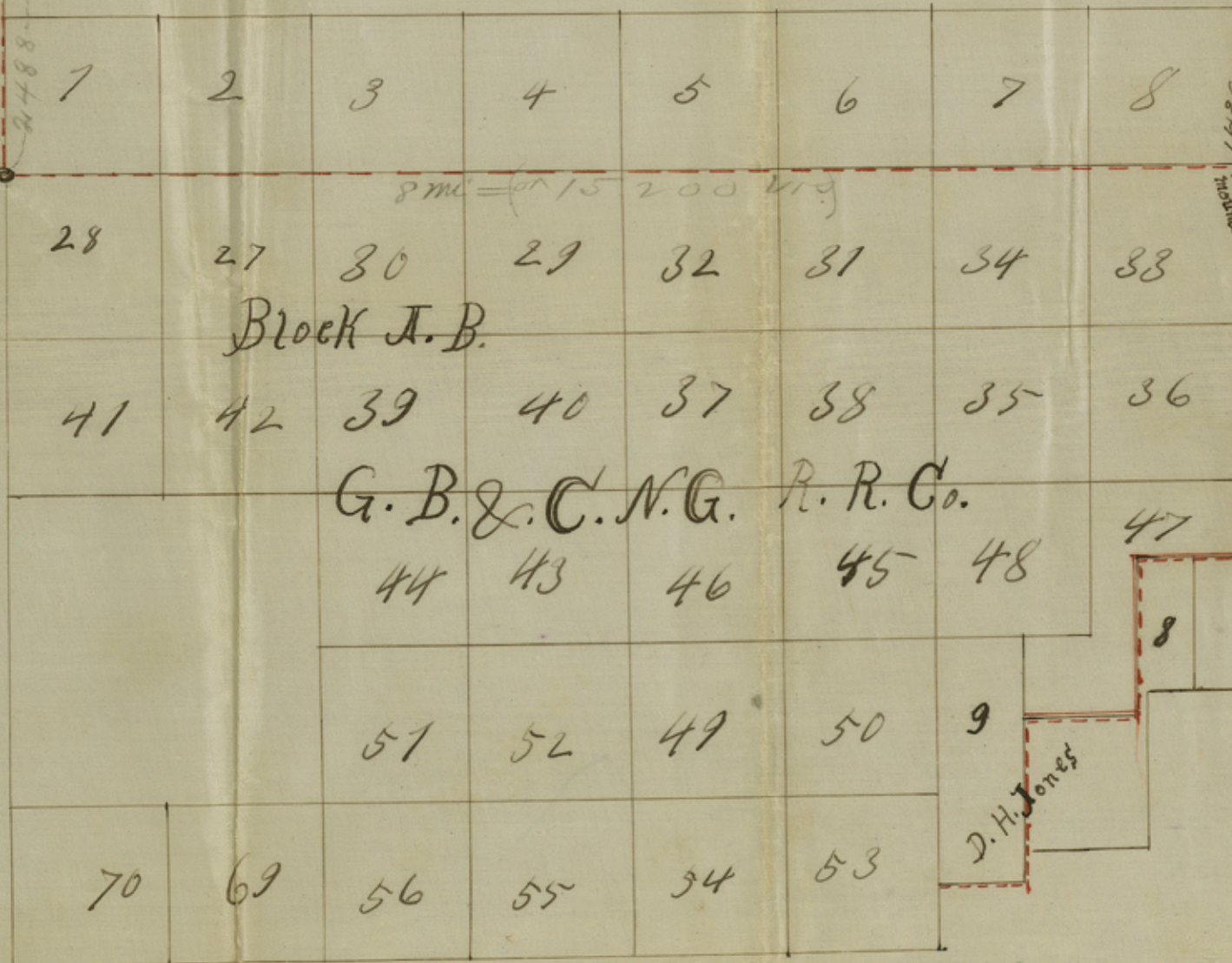

Rock mound on edge of Red hills
top of hill E. 112 W.

Pile of Cobblestone
S. 2.52 W.

D. H. Jones

D. H. Jones

Motley Co.

B. 2

"5" FD

Filed in Genl. L.O.
6/7/1900

Wiso

Block "JB"

Gal. Braz. + Colo. N.G. Ry

Block "A"
Large Coal Free West
Moose Lake Creek, etc.

M. B. J. Co.
N. 1/2 Sec. 10
N. 1/2 Sec. 11
N. 1/2 Sec. 12
N. 1/2 Sec. 13

Block "B"
Large Coal Free West
Moose Lake Creek, etc.

1	2	3	4	5	6	7	8
9	10	11	12	13	14	15	16
17	18	19	20	21	22	23	24
25	26	27	28	29	30	31	32
33	34	35	36	37	38	39	40
41	42	43	44	45	46	47	48
49	50	51	52	53	54	55	56
57	58	59	60	61	62	63	64

Block "A. B."

G. B. & C. N. G.
R. R. Co.

D. H. Jones

counter 31973

counter 31973