

Motley County

"7A"

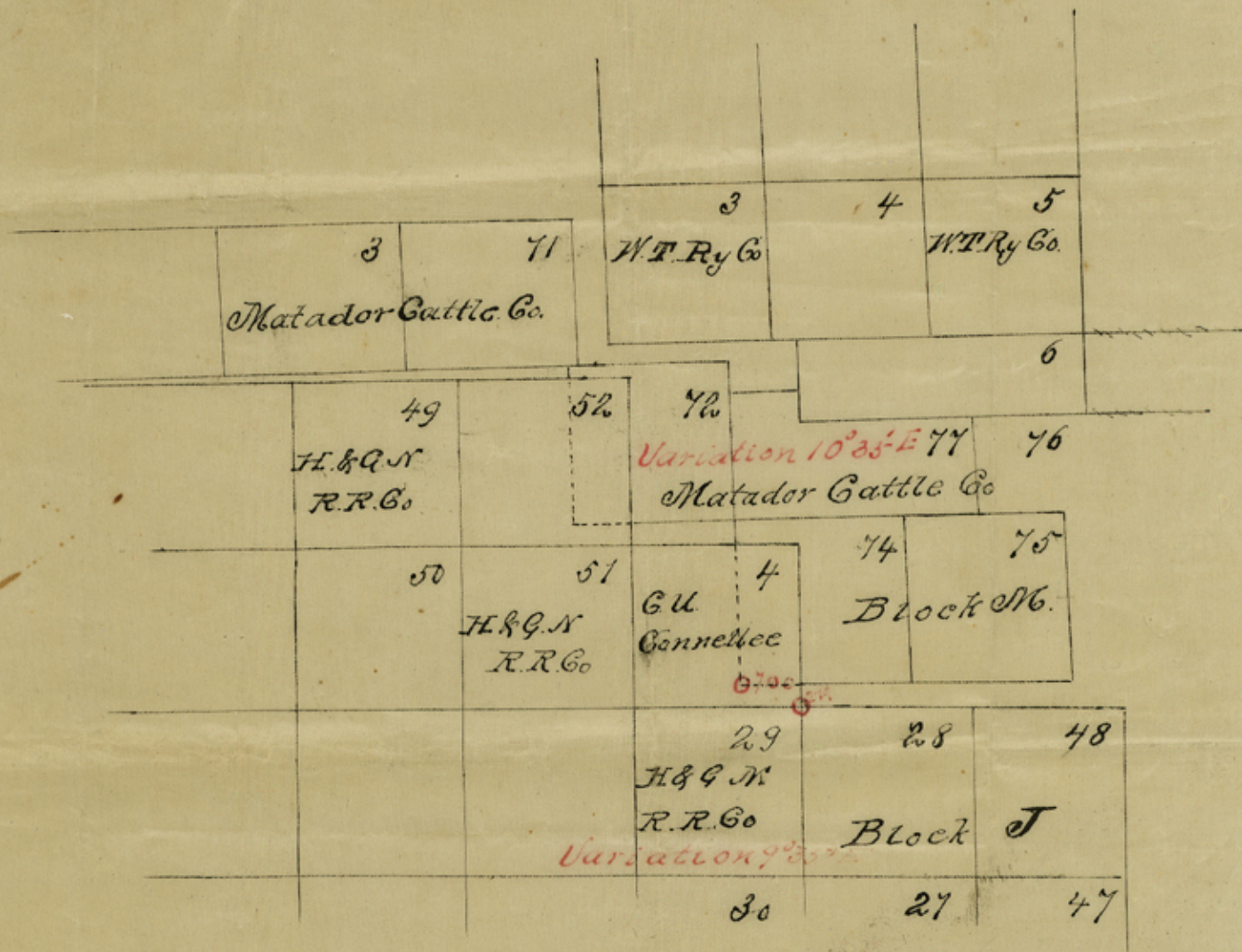

I Sam L. Chalk Surveyor of Motley County do hereby
 Certify that this sketch represents the true positions
 of Surveys Nos 72 & 74 Matador Cattle Co as corrected
 by me. Corners marked in red and distances marked
 same are as found on ground.

July 16 1895.

Sam L. Chalk
 Surveyor Motley Co Texas

Molloy County 39

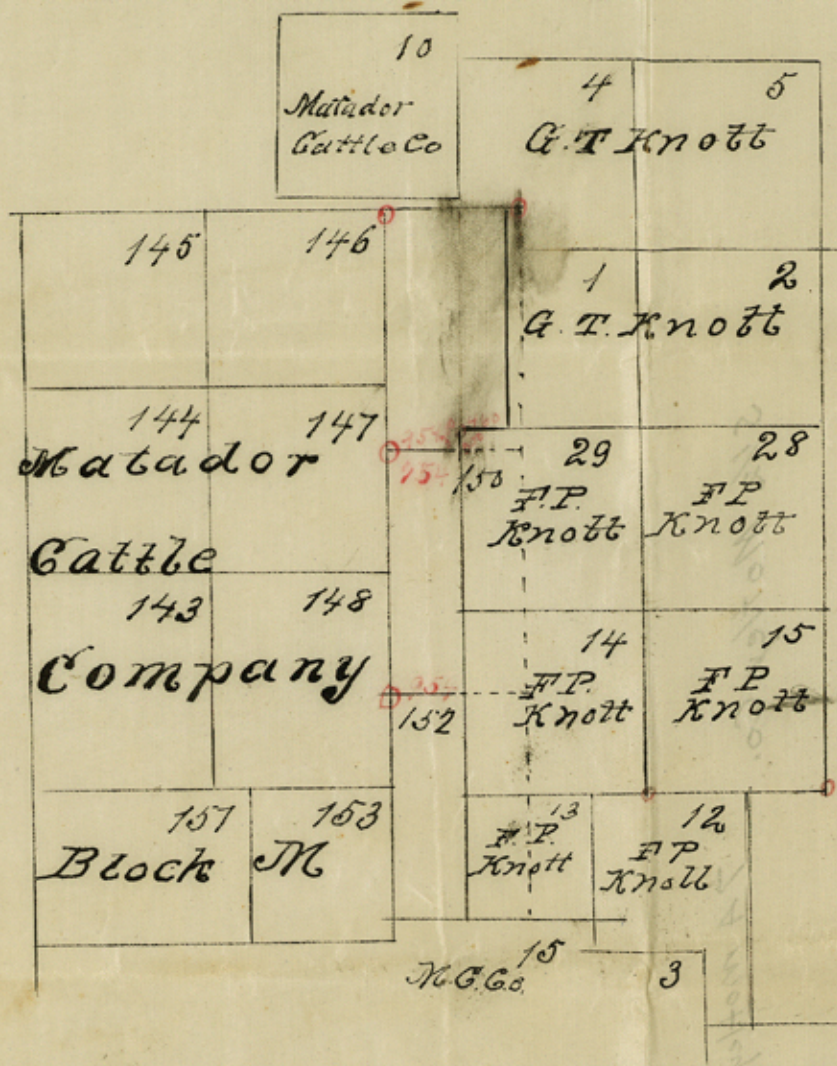

I Sam L. Chalk Surveyor of Molloy Co do hereby
 Certify that this sketch represents the true position
 of surveys nos 149, 150 & 152 Matador Cattle Co. as
 corrected by me. Corners & Distances marked in red
 are as found on the ground.

July 16th 1895
 Sam L. Chalk
 Sur Molloy County Tex