

1213.

North field Texas 8-24-1901  
Chas H Rogan Com Land Office  
Austin Texas

Dear Sir

I herewith send you a rather rough sketch to give you an idea of what follows below: There is a large body of school land not sectionised lying west of H.P. Knott Sec's. 49-380 and also west of G.P. Knott. Sec. 4.

Part of the above school land is surveyed and pt'd. and part is ~~not~~ known as the John Fuling in Cross is mineral land and I send you under another cover a sample of same marked Ex. A.

If the land is put on market please class same as mineral land and notify me in whatever is customary way for such notifications.

There is also a large tract situated on the South boundaries of Secs. 6 and 7. and <sup>of</sup> J. Pointavent you can see that has minerals of both kinds marked Ex. B. and Ex. C. Please send me any data you have regarding the application classification to which I am entitled if any.

The maps procurable are conflictory in many places on the above mentioned land and I cannot make you a satisfactory map of same.

Yours Truly  
J. P. Adamson  
per J. R. K.



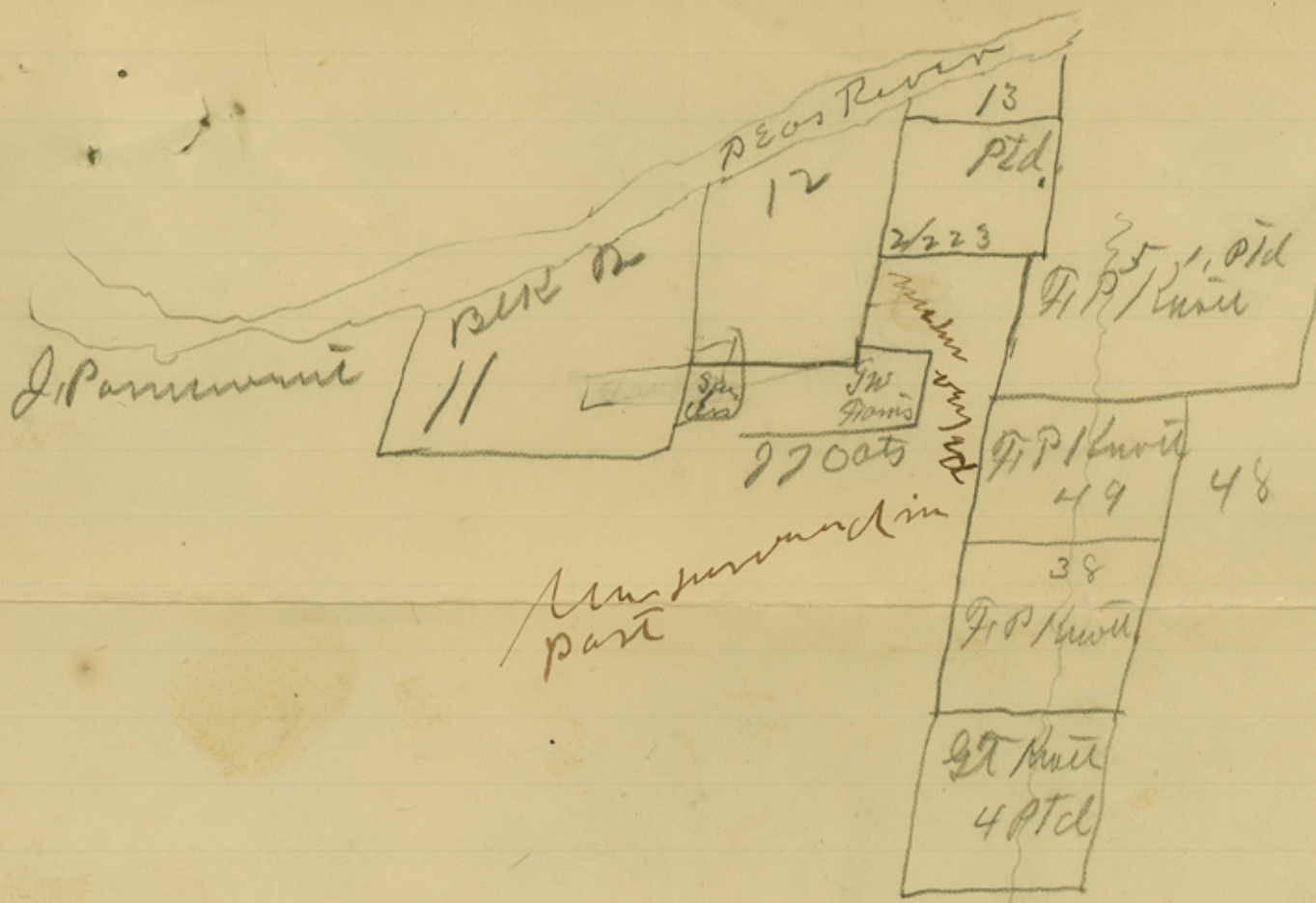

Boundary Co  
Cotton Co



17.8<sup>1</sup>/<sub>2</sub>

17

J.P. Adamson's letter & SK  
in re to vacancy in Motley  
Co.

Dated Aug. 24, 1901.

You

Can you say  
anything about  
this last

D.M.  
9/9/01

8/24/01-

counter 32191